SmartCast



Quick Start Guide

Connection

1. Plug SmartCast into the HDMI port of TV, monitor or projector.
2. Connect the SmartCast to power properly, you can use mobile phone's adapter or get power from USB port of TV set, and the current request 500MA to 1A..
3. Power on TV set and adjust signal resource of TV to the input channel. Eg.HDMI 1.
4. Then TV screen will show booting image.

Note:

1. Please put SmartCase face down as right side picture in order to get better wifi signal.
2. Please set cookie of your smart phone in “never block”, otherwise you may not open IP address in website.

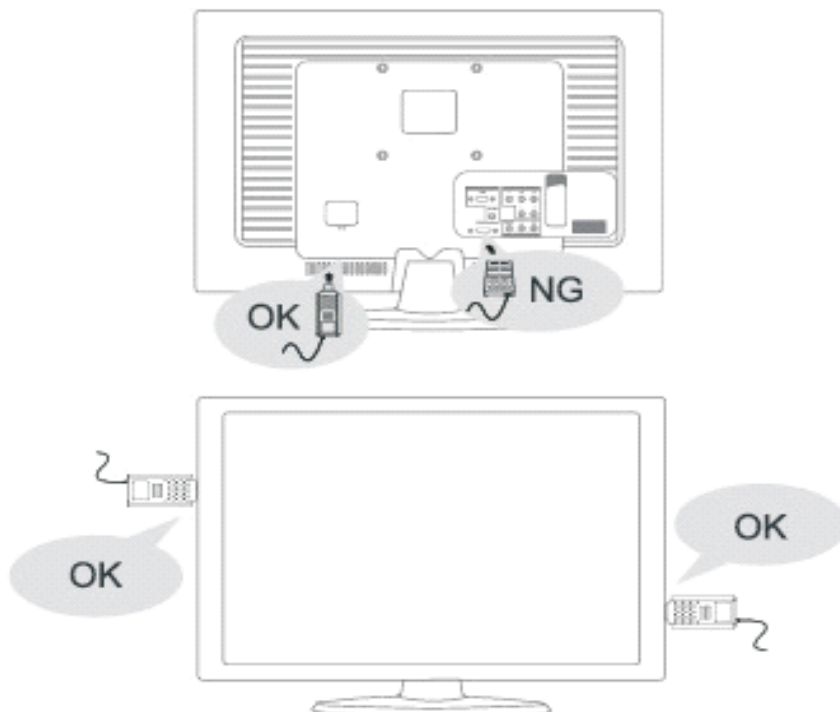

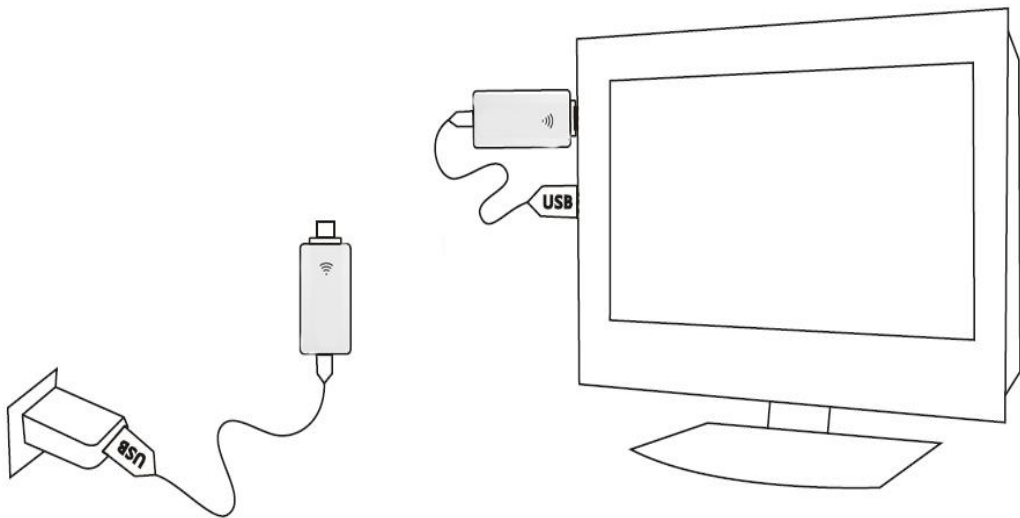

Operation Guide

The method to achieve mirror display by phone settings

iPad/iPhone:

1. Set the SmartCast to DLNA mode, press the button "M" to switch if not in this mode.
2. Then go to setting of your device and connect SmartCast in wifi list.
3. Continuous press the Home button twice quickly, until you can see Control Center, then turn to right until the Airplay icon appears.
(Swipe up from the bottom of your screen if your device is ios7,you will see airplay icon directly)
4. Click the Airplay icon, select SmartCast and open the mirror, the picture will be synchronized shows on TV after a few seconds

Note: The mirror display function of the iPad/iPhone need hardware support which is iPhone 4s/iPad2 or later.

Android mobile phone

1. Set the SmartCast to PBC mode, press the button "M" to switch if not in this mode.
 2. Below is the operation based on Samsung S4. For other brand phone, please check user manual of your smart phone.
- ①Swipe up from the top of your screen, then swipe function icon until you see "Screen Mirroring" or you can go to setting to find "Screen Mirroring".
- ②Click "Screen Mirroring" and choose SmartCast.

Note: Please make sure your smart phone is miracast certificated. Eg: Allshare cast for SamsungS3, screen mirror for SamsungS4, screen mirroring for Sony, miracast for LG.

The method to achieve mirror display by windows PC settings

Win7 system and above

1. Set the SmartCast to DLNA mode, press the button "M" to switch if not in this mode.
2. Install Mirrorop software on the computer, the software can be downloaded from www.mirrorop.com or you can get it from seller.
3. Open the computer WiFi, select and connect to SmartCast.

4. Open Mirrorop software, choose SmartCast for connection, it can be realized mirror display when the connection is successful

For the system which support WiDi3.5 or later

1. Set the SmartCast to PIN mode, if not in this mode, press the button "M" to switch
2. Open the WiDi3.5 applications
3. Search and connect SmartCast.
4. It can be realized mirror display when the connection is successful

SmartCast connected to the Internet

SmartCast can connection to the Internet by WiFi to achieve online video broadcast and product upgrading, the first time to connect the Internet need to connect the network first.

Setting ways as follows:

1. Set the SmartCast to DLNA mode. Note: only in this mode, the system can connect the network
2. Open WiFi and connection to the device name: SmartCast
3. Open a browser and enter the URL address which display at the the TV screen, such as: [http:// 192.168.59.254](http://192.168.59.254)
4. Click on the "Wifi Setup" and connect, then choose "Wifi Connection" option to enter the wireless network list
5. Here, you can chose WiFi name which can be connected to the outside network (e.g., your router)
6. After above, IP address will be reset and offered by your router. When the TV screen shows the WiFi name which connection the network, then the connection setup is completed, the system will be automatically saved to the connection Settings

7. Please recheck the setting of your smart phone and make sure wifi is connected with SmartCast. Otherwise, it may affect data transmission.

Wireless multimedia sharing

Play local multimedia

1. Install Joylink software on mobile phones and computers
Please download Joylink app from google/windows market. IOS device no need for it.
2. Set the SmartCast to DLNA mode
3. Open the WiFi, select and connection the SmartCast.
4. Open the Joylink software :
PC share: drag and drop the files which need to share onto Joylink output window can be projected on the TV or projection
Mobile phone sharing: only need to open the Joylink software

Play online video

After the online video broadcast, it can control to fast forward, pause through the phone, also can close, remove the phone or make calls, but the video are not affected. If you have other devices via DLNA output to SmartCast, it will close current video automatically, and start playing a new video. Specific operation method is shown below:

1. Set the SmartCast to DLNA mode, if not in this mode, press the button "M" to switch
2. Ensure that the product has connected to the network (this operation can be reference SmartCast connected to the Internet)

3. Through the third party application which support DLNA, such as PPTV, tencent video, through select SmartCast for broadcast equipment, the online radio which broadcast in the phone could wireless projected onto a large screen

Online upgrade

1. Set the SmartCast to DLNA mode, if not in this mode, press the button "M" to switch
- . Open a browser and enter the URL address which display at the TV screen, such as: [http:// 192.168.59.254 / remote](http://192.168.59.254/remote) , or open JoyLink software directly into the virtual remote control interface
3. In the main interface, click on the "Set up" button to enter setting
4. To the mobile phone as a remote control, select the "system" option
5. In the "system" option to choose "online update"
6. If have new update version, click "ok"
7. Enter the software download interface, you will see the prompt "download..." this process takes about 10 minutes, please wait patiently
8. When the download is complete, the system will automatically install, when prompted to 100% successful installation, the system will automatically restart
9. After back into the main interface, the system update is complete

Note:

1. Don't disconnect the power source or unplug the device during the upgrade process, otherwise the product will be damaged beyond use. When the upgrade is completed, the system will restart and return to the main interface, the whole upgrade process about 10 minutes.

2.Before upgrading, please connect to the Internet, the specific operation steps please refer to "SmartCast connected to the Internet".

The component of product



- ① Button M: Short press and long press for two functions
Short press: to convert the operating mode
Long Press: Recover to factory default setting. Press M button for

5 seconds until it appears "Factory Default" on the top left corner of the screen. Once the default setting is completed, SmartCast will restart.

Note: Resetting will delete all your saved network connection data, so this function is not suggested to use unless in need.

② Button R: To shut down and restart the application in the SmartCast.

Note: If errors occur during application, press R button to quit and restart.

③ Micro USB Port: For getting power from USB cable.

④ LED Indicator: Yellow led for active status.

⑤ HDMI connector: to connect to TV, projector and HDMI compatible display.

Long time running this product, it may cause product surface heating, this is a normal phenomenon. To prevent accident, do not let children touch!



Temperature warning

This device complies with Part 15 of the FCC Rules. Operation is subject to the following two conditions: (1) this device may not cause harmful interference, and (2) this device must accept any interference received, including interference that may cause undesired operation.

Changes or modifications not expressly approved by the party responsible for compliance could void the user's authority to operate the equipment.

NOTE: This equipment has been tested and found to comply with the limits for a Class B digital device, pursuant to Part 15 of the FCC Rules. These limits are designed to provide reasonable protection against harmful interference in a residential installation. This equipment generates, uses instructions, may cause harmful interference to radio communications. However, there is no guarantee that interference will not occur in a particular installation. If this equipment does cause harmful interference to radio or television reception, which can be determined by turning the equipment off and on, the user is encouraged to try to correct the interference by one or more of the following measures:

- Reorient or relocate the receiving antenna.
- Increase the separation between the equipment and receiver.
- Connect the equipment into an outlet on a circuit different from that to which the receiver is connected.
- Consult the dealer or an experienced radio/TV technician for help.