

ENGLISH

Thank you for choosing our product.  
Please read this manual and safety instruction before usage.  
Please keep the manual for future reference.

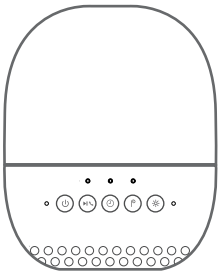

- A perfect combination of Bluetooth speaker, aroma diffuser and mood light.
- Playing music from Bluetooth enabled devices, like smart phones, tablet and computer.
- App control all functions, play music, turn on/off the diffuser and set operation time; turn on/off the LED light, set lighting time and change the light color.

Specifications

- Name: Smart Aroma Diffuser Lamp Speaker
- Input: DC24V 1000mA
- Frequency range: 70HZ – 18KHZ
- SNR: >60dB
- Product size: 110x136mm
- Weight : 355g
- The label is located on bottom of unit.

- Item No. H0035
- Wave Frequency: 2.4 MHz
- Distortion: <0.5%
- Bluetooth version: 4.0
- Speaker size: D40mm
- Material: ABS+PP

Components and Accessories

- Smart Aroma Diffuser Lamp Speaker x1
- AC Adapter x1
- Measuring cup x1

1

Illustration

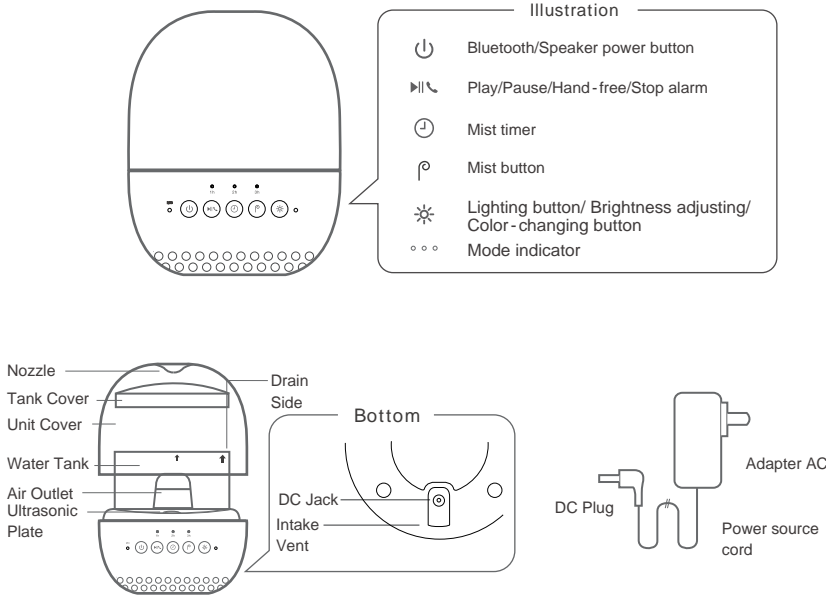

2

How to use

1. Connect the AC adapter provided to the DC jack on the bottom of the unit and place it in a stable, flat location. (Caution: Do not connect the AC adapter to power at this time.) ( Figure 1 )
2. Remove the unit cover and tank cover. ( Figure 2 )
3. Use the measuring cup provided to add tap water. ( Figure 3 )
4. Carefully pour water from the measuring cup into the water tank to avoid spilling. Ensure that the water level is between 50ml (minimum water level) and 100ml (maximum water level). Do not remove the unit cover to add water or essential oil during operation. If you want to do so, turn off the power first.
5. Add drops of essential oil to the water tank. Use 3 to 4 drops for a full tank of water (100ml) as a guide. ( Figure 4 )
6. Replace the tank cover and unit cover. ( Figure 5 )
7. Connect the AC adapter to a household power outlet. ( Figure 6 )

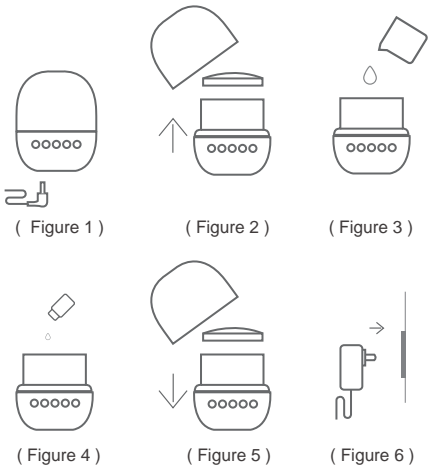

Play music

Play music from Bluetooth enabled devices, like smart phones, computer and etc.

1. Press and hold the power button for 2 seconds to turn on the unit and enter Bluetooth mode, indicator flashing with white light.
2. Search " emoi aroma diffuser lamp speaker " on your devices ' Bluetooth list, and select it to pair with the speaker. When paired successfully, there is a sound prompt and the mode indicator will stay white.
3. After paired, please select and play songs from the Bluetooth enabled device, any songs of your choice.

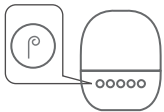

3

Hands free calling

- Short press the hands free button to answer the call.
- Long press the hands free button to reject the call, a beep will prompt.
- If your want to end the talk during the call, short press the hands free button, a beep will prompt.

Enjoy your Aroma Diffuser Lamp

Operation

Short press the mist button to enter mist mode.

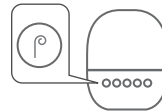

Operation Time

- When the mist function is turned on, the 1 hour timer will be selected. Press the mist timer button, mist time will switch from 1 hour to 2 hours and 3 hours.
- Caution: Make sure the water level in the tank is higher than the minimum level before misting. If the mist time expires, the unit will stop misting and the LED light also goes out.

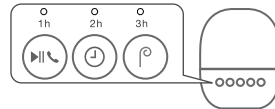

Stop operation

- Press the mist button to stop misting.
- Caution: if there is no water in the tank, the unit will stop misting automatically.

Normal light

- Press the lighting button for 1.5 second to get light with normal intensity. (In the Bluetooth mode, short press the lighting button to get soft light.)
- Short press the lighting button for the second time to decrease the light intensity.
- Short press the lighting button for the third time to turn off light.

4

Color light

- When the lamp is turned off, long press the lighting button for 3 seconds to enter color -light mode, the light will be red. Or you can press the button for 1.5 seconds to enter color -light mode when the white light is on.
- Short press the lighting button to change the light color. The alternative light color is red, orange, yellow, green, blue, purple and flashing color light. (flashing with the above 6 colors in turn).
- Long press the lighting button for 1 second to quit color -light mode.

After use

1. Remove the AC adapter from the household power outlet or power off the outlet.
2. Do not tilt the unit in order to open and close the unit cover while it contains water. Always place the unit on a desk or flat surface. Ensure that water droplets on the bottom of inner cover do not drip.
3. Clean the inside water from the drain side. Dry thoroughly and store.

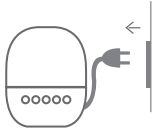

Remark

If crash or other abnormal occurs, please remove the AC adapter from the power outlet and reconnect after a while to restart the product.

APP

Apple smart devices user can download emoi smart APP from APP store.  
Android user can download and install the app from emoi official website (<http://www.emoi.com/support/>).  
You can also search " emoi smart " APP in Google Play Store to download.

This equipment complies with Part 15 of the FCC Rules. Operation is subject to the following two conditions:

- This device may not cause harmful interference, and
- This device must accept any interference received, including interference that may cause undesired operation.

5

FCC Statement:

This device complies with part 15 of the FCC Rules. Operation is subject to the following two conditions: (1) This device may not cause harmful interference, and (2) this device must accept any interference received, including interference that may cause undesired operation.

This equipment has been tested and found to comply with the limits for a Class B digital device, pursuant to part 15 of the FCC Rules. These limits are designed to provide reasonable protection against harmful interference in a residential installation. This equipment generates, uses and can radiate radio frequency energy and, if not installed and used in accordance with the instructions, may cause harmful interference to radio communications. However, there is no guarantee that interference will not occur in a particular installation. If this equipment does cause harmful interference to radio or television reception, which can be determined by turning the equipment off and on, the user is encouraged to try to correct the interference by one or more of the following measures:

- Reorient or relocate the receiving antenna.
- Increase the separation between the equipment and receiver.
- Connect the equipment into an outlet on a circuit different from that to which the receiver is connected.
- Consult the dealer or an experienced radio/TV technician for help.

Caution: Any changes or modifications not expressly approved by the party responsible for compliance could void the user's authority to operate the equipment.

This equipment complies with FCC radiation exposure limits set forth for an uncontrolled environment.

This transmitter must not be co-located or operating in conjunction with any other antenna or transmitter.