

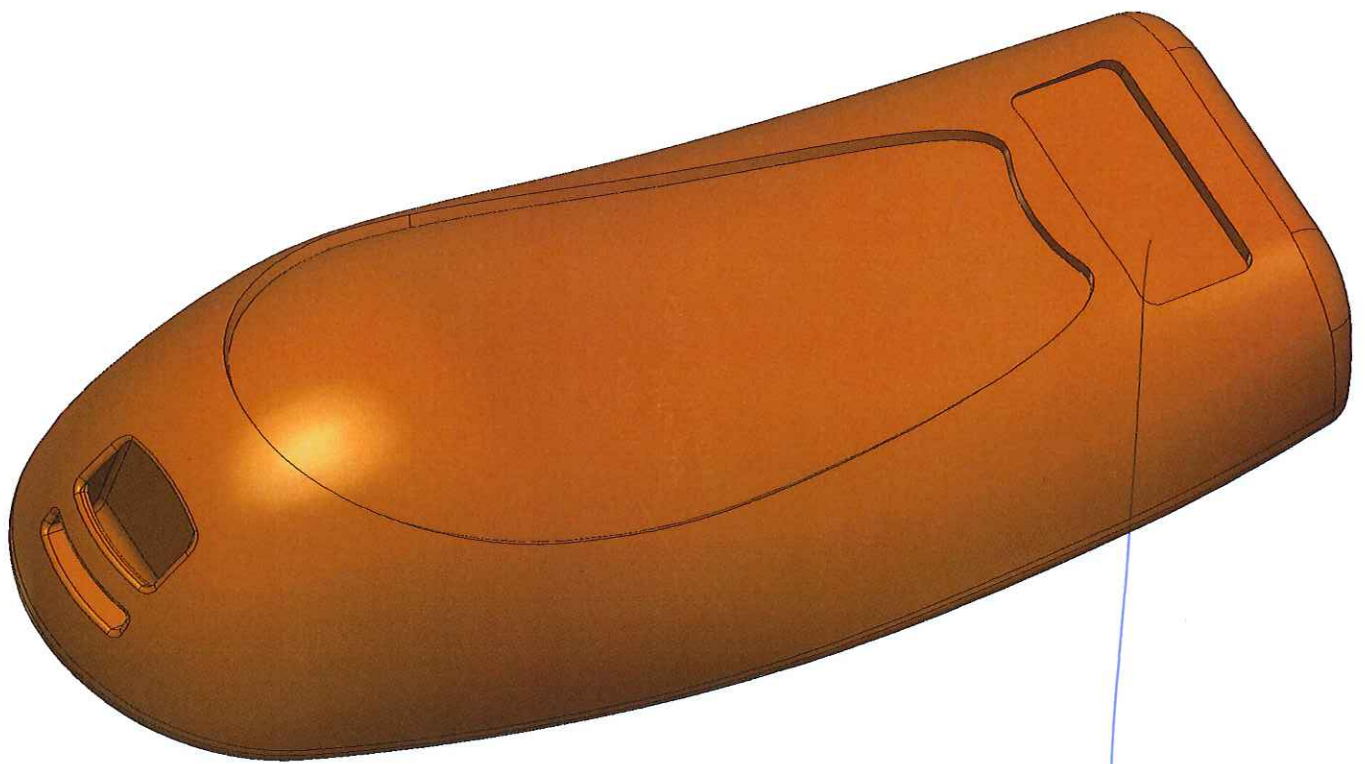

REMOTE CONTROL



FCC LABEL POSITION

LIMITED WARRANTY ON THE STROBE LIGHT

The warranty on the strobe light is limited to 12 months from the date of purchase. The warranty covers the repair or replacement of faulty parts due to faulty workmanship or materials. The warranty does not cover normal wear and tear from use. Brand Developers retains the right to determine whether to repair or replace the faulty part. The warranty does not cover damage caused by water entering the strobe light. This is caused by the bulb not being screwed on tight against the seal.

LIMITED WARRANTY ON THE BATTERIES

The warranty on the batteries is limited to 12 months from the date of purchase. The warranty covers the repair or replacement of faulty parts due to faulty workmanship or materials. The warranty does not cover normal wear and tear from use. Batteries should last 2 or more years before you notice any significant drop in performance. Battery failure is generally caused by leaving the batteries discharged, or by overcharging.

This warranty does not replace but is in addition to your statutory rights.

This warranty does not apply to accessories supplied with the item.

This warranty applies only to the original purchaser and may not be transferred.

Replacement items will be covered by the limited warranty for the balance of the warranty period from the date of the original purchase.

Please note: Only the defective product or parts returned to the place of purchase will be replaced under this warranty.

Australia Contact

461 Plummer Street,
Port Melbourne, VIC 3207, AUSTRALIA
AUST Customer Care: 1800 890 840

New Zealand Contact

Unit H, 686 Rosebank Road,
Avondale, 1026 Auckland, NEW ZEALAND
NZ Customer Care: 0800 002 999

This device complies with part 15 of the FCC rules. Operation is subject to the following two conditions: (1) This device may not cause harmful interference, and (2) this device must accept any interference received, including interference that may cause undesired operation.