

MANUAL

YK-5000

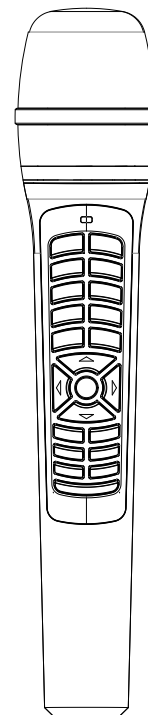

Safety Precautions	p.02
Precaution Before Connection	p.06
Basic Items	p.07
Setup Method	p.08
* How to setup to TV (Composite / SD)	
* How to setup to TV (Component / HD)	
* How to setup to TV & Sound system (Composite / SD)	
* How to setup to TV & Sound system (Component / HD)	
Select Song	p.12
Name & Function of Button	p.13
Troubleshooting	p.16
Specification	p.17
Product Storage and Maintenance	p.18
After Service	p.18
Option	p.19
* Additional songpack & Sub Mic	
300 Song List of Karaoke Ichiban	p.20

Safety precaution

Make sure read out “safety precaution” for correct way before used YK5000.



WARNING

Ignore and mishandling for this symbol, show to possible in regard to human has death or serious injury.



CAUTION

Ignore and mishandling for this symbol, shows what is expected to be a possible cause human injury and material damage has occurred.



Precaution



If it happened abnormal(smoke, smell, noise and so on..) status during operation, Immediately power off of YK5000 and unplug, contact to service center.



Do not disassemble the parts of the YK5000, it is possible cause of fire & electric shock.



If any solid object or liquid gets inside YK5000, Immediately unplug it and have it checked by our service center.



Incase of drop YK5000, Happened any external or internal damage, Immediately unplug it and have it checked by our service center. If continue to use, it is possible cause of fire & electric shock.



If power cable shake , power is replete on/off or abnormal heat on AC adaptor body, Immediately unplug it and have it checked by our service center. If continue to use, it is possible cause of fire & electric shock.



Do not placed power cable under heavy solid object, If it happened scratch on power cable, it is possible cause of fire & electric shock.

Safety Precaution



If the power cord is damaged (exposure of the core, disconnection, etc.), Please request to replacement to dealer, continue to use, it is possible cause of fire & electric shock,



Do not damage the power cord or process, or forcibly bend, twist, pull, or heat. If the cord is damaged, it may cause fire or electric shock,



Do not touch the power plug, When a lightning hit a thunder-storm, It may cause an electric shock,



Do not use except of power supply voltage shown. It may cause fire or electric shock,



Do not place on an unstable place such as a wobbly table top or sloping, Take a fall or impact can cause damage or malfunction,



Please note that this product water or humid. It may cause a fire or electric shock. Especially be careful used near the snow, rain, or the beach,



Do not touch the power plug with wet hands. It may cause an electric shock,



Use the specified batteries. When using unqualified batteries can cause fire, equipment failure,



Do not use rechargeable batteries. The cause of the equipment failure,



Please use the provided AC Adaptor. When using unqualified AC adaptor can cause fire, equipment failure,



Caution



Do not place a lot of moisture or dust. It may cause fire or electric shock,



Do not place cooking table, humidifier, exposed to water vapor. It may cause fire or electric shock,

Safety Precaution



Well-ventilated place and avoid the following way.

- To keep with the product upside down or sideways
- To hold such a narrow place stuffy, closet, bookshelf



Do not place in direct sunlight or near a heater. May cause deformation, discoloration or malfunction.



This may cause a fire if you keep using the dust and dirt deposited on the power plug state. Unplug it, remove the dust periodically. Also, make sure the power cord is connected properly sometimes.



Do not use the distorted sound for a long time. This may cause a fire to heat the speaker.



Do not place heavy objects on this product or other. This may cause a malfunction.



When you move the main station, First of all Make sure the power off and unplug.

Do not place near a heater. It may cause fire or electric shock.



When you unplug the power cord, do not pull on the power cord. This may cause a fire, electric shock, damage the cord. Unplug by grasping the plug.



Make sure plug to outlet directly. If use extension outlet, avoid octopus wiring. It may cause fire or electric shock.



When you cleaning the power plug, Make sure unplug the power plug from the outlet for safety purposes during cleaning.

Safety Precaution



When the unit is not used for a long time and travel, For your safety, make sure to disconnect the power plug from the wall outlet.



Keep the battery separately when not in use a long time. Battery leakage may occur.



Please use the distance to the other wireless device.

Precaution Before Connect

Make sure read out well before connect.

- 1** Additional song pack plug /unplug
Insert : - YK5000 should be turned off first,
 - insert new song pack to pack slot of main station
 - turned on the power of main station.
remove : -YK5000 should be turned off first,
 - remove song pack from pack slot of main station,
 - turned on the power of main station.
* First, Turn OFF the power, this is very important turn off main station before removing or inserting a song pack.
- 2** Make sure turn off the power of other equipment and YK5000, when you connect between YK5000 and other equipment. Please carefully read the operating instructions of the other equipment of combination.
- 3** To avoid inflow of connection terminal and connector types, such as oil or dust debris.
Do not connect by force which is more than necessary force, it may cause poor contact or broken.
- 4** Do not disassemble or modify YK5000.
It may cause a malfunction, failure, fire, or electric shock.
- 5** Do not use near microwave oven.
The cause of the noise and audio feedback.

Basic Items

Check the Basic items in the packing.
Insufficient item or damaged items,
please contact your dealer or our service center.

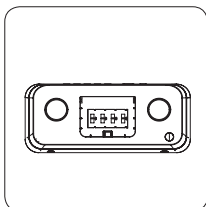

YK5000 Main Station

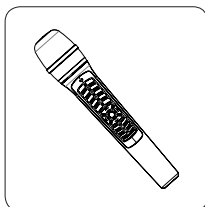

Wireless Karaoke MIC

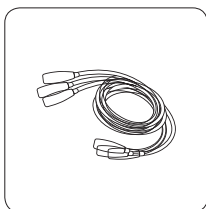

AV Cable

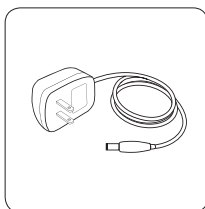

AC/DC Adaptor

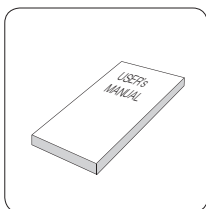

User's Manual

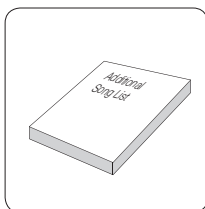

Karaoke Song Handbook

How to Setup to TV (Composite / SD)

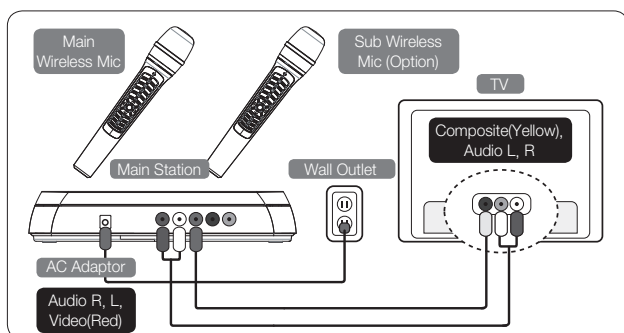

- 1 HD/SD Switch in main station located "SD" direction.
- 2 Connect the Audio/ Video cable to the RCA Jack terminal on your TV, Such as shown above Picture.
 - ※ Caution 1: composite connector color of TV is Yellow, Red color plug of cable connect to TV composite (Yellow color connector)
 - ※ Caution 2: If unstable connected cable, Video is poor quality.
 - If there are only one audio RCA jack terminals on your TV(mono TV), connect the white(male) to the other RCA jack terminal of your TV.
- 3 AC adaptor plug wall outlet and plug to main station.
- 4 Turn on the your TV and correct select input source, refer to your TV manual for detail operation.
- 5 turn on the your YK5000.
- 6 Karaoke Ichiban Logo Display on your TV with sound.
- 7 Battery install to Mic.
- 8 Turn on the MIC.

How to Setup to TV (Component / HD)

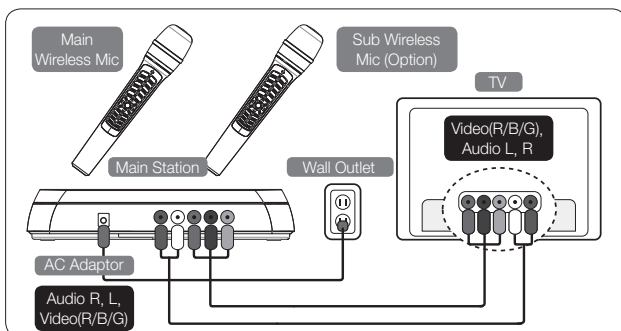

- 1 HD/SD Switch in main station located "HD" direction.
- 2 Connect the Audio/ Component cable to the Audio / Component Terminal on your TV, Such as shown above Picture.
 - ※ Caution 1: Component connector color of TV is Red, Blue, Green. Red, Blue, Green color plug of cable connect to TV component.
 - ※ Caution 2: If unstable connected cable, Video is poor quality.
 - If there are only one audio RCA jack terminals on your TV(mono TV), connect the white(male) to the other RCA jack terminal of your TV.
- 3 AC adaptor plug wall outlet and plug to main station.
- 4 Turn on the your TV and correct select input source, refer to your TV manual for detail connection.
- 5 turn on the your YK5000.
- 6 Karaoke Ichiban Logo Display on your TV with sound.
- 7 Battery install to Mic.
- 8 Turn on the MIC.

How to Setup to TV & AUDIO (Composite / SD)

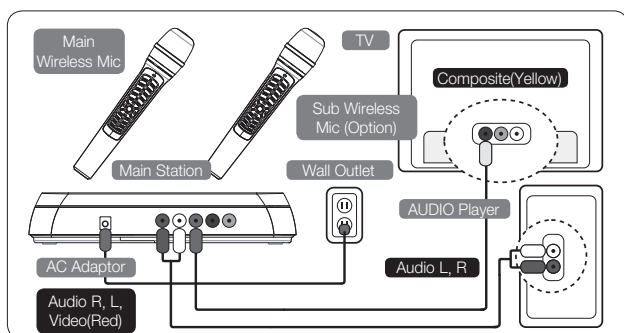

- 1 HD/SD Switch in main station located "SD" direction.
- 2 Connect the Audio/ Video cable to the RCA Jack terminal on your TV & AUDIO player, Such as shown above Picture.
 - ※ Caution 1: composite connector color of TV is Yellow, Red color plug of cable connect to TV composite (Yellow color connector)
 - ※ Caution 2: If unstable connected cable, Video is poor quality.
- 3 Connect the red and white jack to jack terminals on your stereo (sound system).
 - You might need an extension cable if your stereo(sound system) is placed far away from your TV.
 - If your stereo(sound system) has audio line-in or AUX, you can connect via audio cable for better sound quality.
- 4 AC adaptor plug wall outlet and plug to main station.
- 5 Turn on the your TV and correct select input source. refer to your TV manual for detail connection.
- 6 turn on the your YK5000.
- 7 Karaoke Ichiban Logo Display on your TV with sound.
- 8 Battery install to Mic.
- 9 Turn on the MIC.

How to Setup to TV & AUDIO (Component / HD)

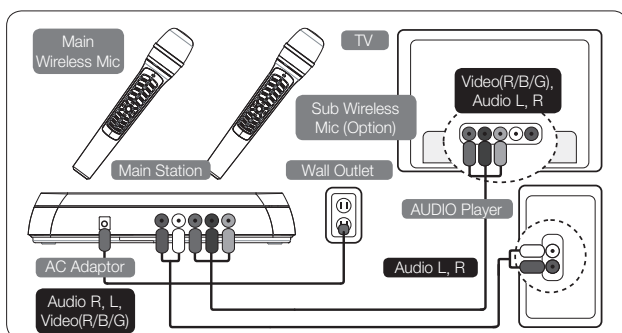

- 1 HD/SD Switch in main station located "HD" direction.
- 2 Connect the Audio/ Component cable to the Audio / Component Terminal on your TV & AUDIO player, Such as shown above Picture.
 - ※ Caution 1: Component connector color of TV is Red, Blue, Green, Red, Blue, Green color plug of cable connect to TV component.
 - ※ Caution 2: If unstable connected cable, Video is poor quality.
- 3 Connect the red and white jack to jack terminals on your stereo (sound system).
 - You might need an extension cable if your stereo(sound system) is placed far away from your TV.
 - If your stereo(sound system) has audio line-in or AUX, you can connect via audio cable for better sound quality.
- 4 AC adaptor plug wall outlet and plug to main station.
- 5 Turn on the your TV and correct select input source, refer to your TV manual for detail connection.
- 6 turn on the your YK5000.
- 7 Karaoke Ichiban Logo Display on your TV with sound.
- 8 Battery install to Mic.
- 9 Turn on the MIC.

Select Song

Find song used navigation key or enter song number and press ►/|| button.
repeat press ►/|| button for pause function.
If you want stop, you can press “stop” button.

- Make sure ALC function disable on your TV has this function.
If enable this function on your TV, You can hear small Volume.
- Different description ALC(Automatic Level Control) function by manufacture, Refer you TV user's manual.

※ What is ALC (Automatic level control)?
If Suddenly happened big sound, Ear protected function by decrease some level.

Name & Function of Button

Front side of Main Station

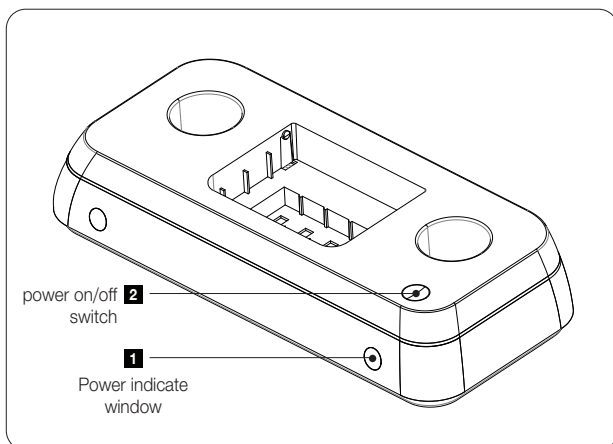

1 Power Indicate Window

A steady green light indicates that the power on.
No light means that power off.

2 Power On / Off Switch

Turn on or off the main station.

※ 2sec press for power on, 2sec press for power off.

Back side of Main Station

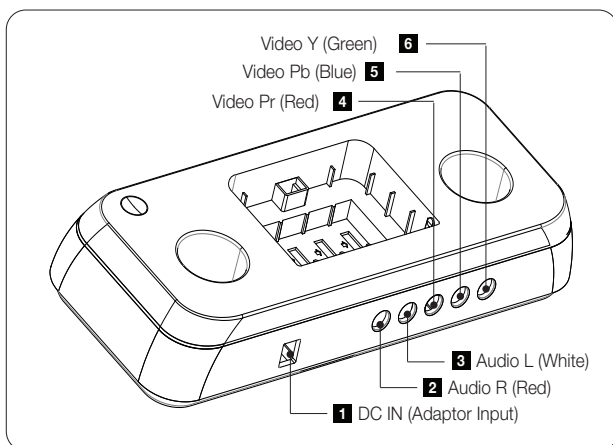

Name & Function of Button

Front of MIC

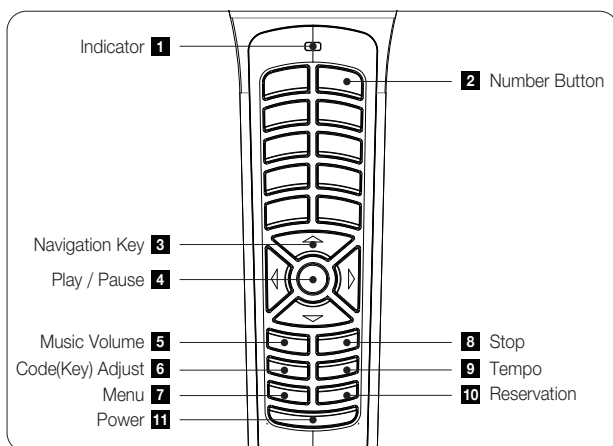

1 Indicator

- A steady green light indicates that the wireless mic is ready and Battery enough for use,
- A steady Red light indicates that the wireless mic is ready and Battery poor for use, recommended to battery change,
- green light blinking that the wireless mic try to connection to main station,
- No light means that the wireless mic is turned off

2 Number Button

Used song select or song find from song subject,

3 Navigation Button (up/down/left/right)

Show to song list, When press any navigation key in YK5000 ready status, pop up the song list on your TV and you can move each line by up/down key (▼/▲) and move page by left/right key (◀/▶).

4 Play / Pause Button

Song play or pause,
if you want pause music during playing Karaoke, press this key for activated pause function, one more press for deactivated pause function,

Name & Function of Button

5 Music Volume Button

Music volume control, Pressed this function key and used up/down navigation key for volume control.(+/-7 level)

6 Code(Key) Adjust Button

Code(Key) adjust function of select song, Pressed this function key and Used Up/ Down navigation key for code(key) adjust. (+/-7 level)

7 Menu Button

Mic , Melody, Echo Volume adjust,

8 Stop Button

Complete stop the song or exit from menu function,

9 Temp (play speed) Button

Temp(Play speed) adjust function for selected song, Pressed this function key and Used Up/Down navigation key for play speed adjust,

10 Reservation Button

When you use song reservation,

- 1) You can found favorite song number from song book,
- 2) Pressed this function key and press song number used number key,
- 3) Pop up the reservation song title with singer on your TV display,
- 4) If you want cancel reservation song, press song number and press reservation button,

11 Power Button

Turn on or off the wireless mic,
2sec press for power on, 2sec press for power off,

Troubleshooting

1 If YK5000 doesn't power up

- YK5000 main station

Make sure the adaptor is correctly plugged into the power outlet, check that the male plug is properly inserted into the female jack.

- Wireless Mic

check if the battery type is AA or LR6. If the battery low, YK5000 may not work properly.

2 If power on the Main station and can't hear sound

your TV volume check and increase the volume of YK5000.

3 If the TV does not show pictures or emit sound

Make sure all the AV connectors are properly connected according to the correct colors. Check if the TV is in the video mode.

4 If selected or reservation song doesn't display on TV

Make sure correct song number input, Retry.

5 YK5000's main station power off

If MIC didn't press any key during 10 minute, YK5000 main station is auto power off function for power saving.

6 MIC can't Power on

Make sure correctly install battery.
Check the battery level.

7 If the User's voice can not be heard

Power off the main station / MIC and wait few minute.

Specification

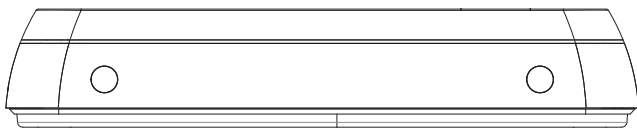

YK-5000 MAIN UNIT

VIDEO	NTSC/PAL(720x480i,720x576i), 1024x720p HD Supported Composite: 1.0Vp-p, 75Ω Component: Y (1.0Vp-p) Pb, Pr(0.7Vp-p)
AUDIO	Sound Engine: YMG2000 R/L Stereo, 2Vrms
RF	2.4G ISM Band (2400 ~ 2483.5Mhz), 18Ch.
POWER SUPPLY	DC 9V/500mA (AC110~240V, 50~60Hz)
POWER CONSUMPTION	2W (MAX)
OPERATION TEMPERATURE	0 ~ 70°C
DIMENSIONS	240(W) x 110(D) x 48(H) (mm)
WEIGHT	340g (NET)

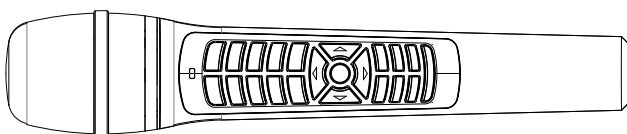

YK-5000 MICROPHONE

RF	2.4G ISM Band (2400 ~ 2483.5Mhz), 18Ch.
POWER SUPPLY	DC 3V (1.5V AA Battery x 2)
POWER CONSUMPTION	150mW (MAX)
OPERATION TEMPERATURE	0 ~ 70°C
DIMENSIONS	46(W) x 240(H) (mm)
WEIGHT	200g (NET)

Product Storage and Maintenance

PRECAUTION

Use the adaptor that comes with YK5000 only. There are many adaptors that are plug-compatible with YK5000, but have different electrical specification. These adaptor would work only for a short period of time but would very soon damage YK5000.

USE THE RECOMMENDED ACCESSORIES ONLY (DC 9V / 500mA)

Wipe only the outside of the product with a dry cloth.

Do not use alcohol-based products for clean or disassemble for clean.

1 When it smudge by benzene or chemical.

To avoid damaging the product, wipe with a dry cloth.
If the damage is severe, contact to service center.

2 In case of any carbonate water or liquid spill on YK5000,

Make sure to wipe with a dry cloth, wipe again with a moisture cloth, if you spill outside only of YK5000. If you don't know spill inside, contact to service center.

3 When the deforming by external shock,

Any external or internal damage due to dropping or bump is not covered and stop operation, contact to our service center.

4 When storing

Avoid high temperature and high humidity.
Keep in a well-ventilated place.
Keep the batteries separate from the microphone.

After Service

First, Contact to dealer office.

Please contact dealer for the service or inquiry about the product.

Hotline (General consultation about product)

YUME GROUP Co., Ltd.

Postal Code : 112-0013

5FL, Autowa NS B/D, 2-10-2, Autowa , MunkyingGu, Tokyo, Japan.

Tel. : 03-5395-5261

Fax : 03-5395-5694

1 Additional Song Pack

You can add to songpack find your favorite songs in the additional song book. It also released a popular song genre.

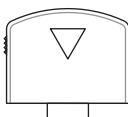

※ 3,150 yen (including tax) / 1 song 210 yen / approx. 70 songs available

How to install additional songpack

Please turn the power off during removal of the additional songpack sure this product.

- ① Press the top lid to open the lid of this product.
- ② Connect firmly facing up additional songpack arrow.
(You can add up to 4)
- ③ When insert songpack close the lid.

2 Sub Wireless Mic

Two people can sing along with.

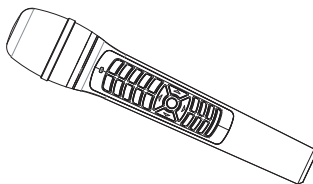

How to use the Sub Wireless microphone

Turn on the sub microphone while the power of the main station.
You can use when the microphone status indicate light the red color.

FCC Caution

This equipment has been tested and found to comply with the limits for a Class B digital device, pursuant to Part 15 of the FCC Rules. These limits are designed to provide reasonable protection against harmful interference in a residential installation.

This equipment generates uses and can radiate radio frequency energy and, if not installed and used in accordance with the instructions, may cause harmful interference to radio communications.

However, there is no guarantee that interference will not occur in a particular installation. If this equipment does cause harmful interference to radio or television reception, which can be determined by turning the equipment off and on, the user is encouraged to try to correct the interference by one or more of the following measures:

- Reorient or relocate the receiving antenna.
- Increase the separation between the equipment and receiver.
- Connect the equipment into an outlet on a circuit different from that to which the receiver is connected.
- Consult the dealer or an experienced radio/TV technical for help.
- Reorient or relocate the receiving antenna.
- Increase the separation between the equipment and receiver.
- Connect the equipment into an outlet on a circuit different from that to which the receiver is connected.
- Consult the dealer or an experienced radio/TV technical for help.

WARNING: This equipment may generate or use radio frequency energy. Changes or modifications to this equipment may cause harmful interference unless the modifications are expressly approved in the instruction manual. The user could lose the authority to operate this equipment if an unauthorized change or modification is made.

This device complies with Part 15 of the FCC's Rules. Operation is subject to the following two Conditions:

1. This device may not cause harmful interference, and
2. This device must accept and interfere not received, including interference that may cause undesirable operation.

This equipment complies with FCC radiation exposure limits set forth for an uncontrolled environment. This equipment should be installed and operated with minimum distance 20cm between the radiator & your body. This transmitter must not be co-located or operating in conjunction with any other antenna or transmitter.