

Federal Communications Commission (FCC) Statement
15.21

You are cautioned that changes or modifications not expressly approved by the part responsible for compliance could void the user's authority to operate the equipment.

15.105(b)

This equipment has been tested and found to comply with the limits for a Class B digital device, pursuant to part 15 of the FCC rules. These limits are designed to provide reasonable protection against harmful interference in a residential installation. This equipment generates, uses and can radiate radio frequency energy and, if not installed and used in accordance with the instructions, may cause harmful interference to radio communications. However, there is no guarantee that interference will not occur in a particular installation. If this equipment does cause harmful interference to radio or television reception, which can be determined by turning the equipment off and on, the user is encouraged to try to correct the

- Reorient or relocate the receiving antenna.
- Increase the separation between the equipment and receiver.
- Connect the equipment into an outlet on a circuit different from that to which the receiver is connected.
- Consult the dealer or an experienced radio/TV technician for help.

This device complies with Part 15 of the FCC Rules. Operation is subject to the following two conditions:

- 1) this device may not cause harmful interference and
- 2) this device must accept any interference received, including interference that may cause undesired operation of the device



Rechargeable Wireless Remote Controller

INSTRUCTION MANUAL

Model No.: SPE-005



PETATECH INTERNATIONAL CO., LTD.

Tel: +886-2-8751-9998 / FAX: +886-2-8751-6887

Info@thermalution.com / www.thermalution.com

How to wear the Forearm Strap:

Forearm Strap

Model No.: COC-011-C

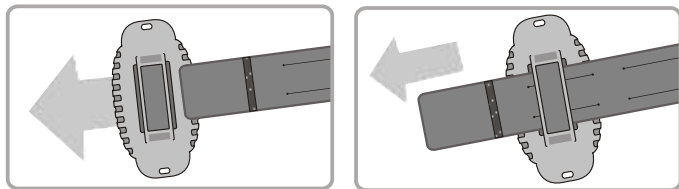

Insert the forearm strap through the tunnel of the controller with the velcro hook side facing out as shown in the diagram.

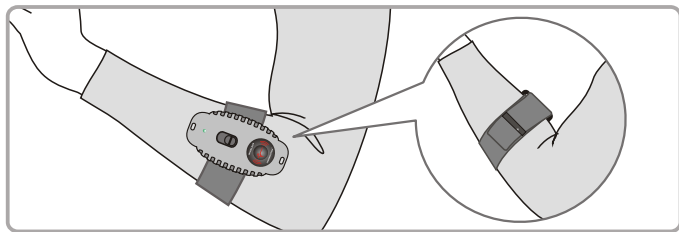
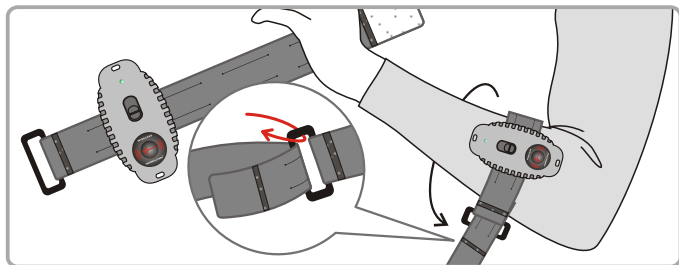

Affix the strap around your forearm and adjust the controller to a comfortable position.

How to Operate the Controller:

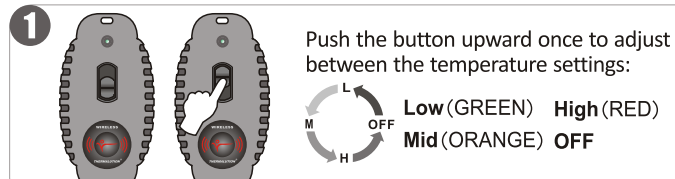

Please note that the battery life of the wireless controller is approximately 1 - 1.5 years.

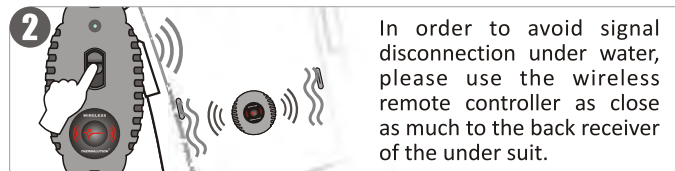

When the setting is on “**Low**” the light indicator on the controller is **green**, it will flash every second and the receiver will vibrate once then stop.

When the setting is on “**Mid**” the light indicator on the controller is **orange**, it will flash every second and the receiver will vibrate twice then stop.

When the setting is on “**High**” the light indicator on the controller is **red**, it will flash every second and the receiver will vibrate three times then stop.

When the setting is on “**OFF**” the light indicator will be off. The receiver will emit an extended vibration then stop.



Please adjust the wireless controller to OFF status when you are not using the gear.

The receiver on your back will vibrate frequently when the battery of the undersuit is low.