

Sensi-Fire Operating Instructions

For Model: 41-500-190

CAUTION This appliance should only be used by children aged 8 years and older. Persons with reduced physical, sensory or mental capabilities can operate the device if they are supervised or instructions concerning the safe use of the appliance and its hazards have been understood by them.

* Children should not play with the appliance.

* Cleaning/maintenance should not be undertaken by children without appropriate supervision.

Sensi-Fire Wireless is a safety device that automatically raises shutters around a building in the event of fire or smoke, allowing occupants to exit through windows or doorways that are fitted with shutters when required.

The device monitors for an alarm sound emitted from any smoke alarm that is mounted within 1 metre. Once an alarm sound is detected, the device sends an UP command to all roller shutters programmed to the device. The Sensi-Fire Wireless unit will continuously send the UP command every 15 seconds whilst an alarm sound is detected.

CONTENTS OF SENSI-FIRE UNIT BOX 41-500-190

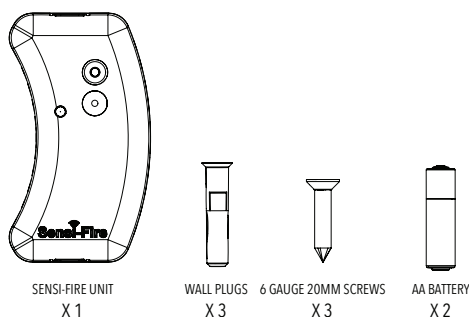

1) Sensi-Fire Installation

1. Remove the Sensi-Fire cover to expose the base.
2. Locate the Sensi-Fire base to within 1 metre from the centre of the smoke alarm.
3. Use the three mounting holes in the Sensi-Fire base as a template to mark the mounting holes with a pencil.
4. Remove the Sensi-Fire base and drill the marked holes with a 5mm drill bit.
5. Insert the wall plugs in the holes and attach the Sensi-Fire base using the three x 6 gauge screws provided.

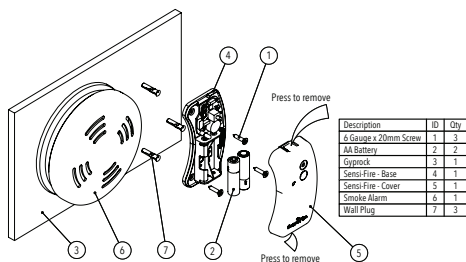

2) Programming The Device To SolarSmart & PowerSmart Shutters

For PowerSmart applications with a remote follow the instructions below. If you do not have a remote please refer to section 3) PowerSmart Programming With No Remote.

1. Using a remote control already programmed to the shutter press and hold the STOP button for 5 seconds until the LED stops flashing and stays on continuously. Then release the STOP button.
2. Press the UP button for half a second and release (the motor in the shutter will perform a short up and down movement).
3. Press the PROGRAM (red) button on the Sensi-Fire Wireless device for 1 second (the motor performs another short up down movement) then release the PROGRAM button.

3) PowerSmart Programming With No Remote

After inserting the battery into the receiver, follow the steps below:

1. REMOVE the battery for 3 seconds.
2. INSERT the battery for 3 seconds.
3. REMOVE the battery for 3 seconds.
4. INSERT the battery.
5. Press the STOP button on the wall unit.
6. Press the PROGRAM (red) button on the Sensi-Fire Wireless device for 1 second (the motor performs another short up down movement) then release the PROGRAM button.

4) Operation, Battery & Beeper Testing

The device can be tested to ensure that it is programmed to the shutter and that the shutter will be raised.

Long press of the PROGRAM (red) button: The device will send an UP command to all shutters programmed.

The Sensi-Fire Wireless device is fitted with 2 x AA Batteries. The device self monitors the batteries every 15 minutes. If the batteries are good the LED will flash once only. If the batteries are low the LED on the device will flash 3 times and sound a beep for 1 second, warning the occupants that the batteries need changing.

The batteries, LED and beeper can be checked at any time.

Single click on the PROGRAM (red) button: Tests the batteries and LED.

Double click on the PROGRAM (red) button: Tests the beeper.

5) Specifications

Unit	
Power Supply	3V
Batteries	2 x AA 1.5V cells
Frequency	433.4MHz
Range	200m in free field

6) FCC Statement

This equipment has been tested and found to comply with the limits for a Class B digital device, pursuant to part 15 of the FCC Rules. These limits are designed to provide reasonable protection against harmful interference in a residential installation. This equipment generates, uses and can radiate radio frequency energy and, if not installed and used in accordance with the instructions, may cause harmful interference to radio communications.

However, there is no guarantee that interference will not occur in a particular installation. If this equipment does cause harmful interference to radio or television reception, which can be determined by turning the equipment off and on, the user is encouraged to try to correct the interference by one or more of the following measures:

1. Reorient or relocate the receiving antenna.
2. Increase the separation between the equipment and receiver.
3. Connect the equipment to an outlet on a circuit different from that to which the receiver is connected.

This device complies with part 15 of the FCC rules. Operation is subject to the following two conditions: (1) This device may not cause harmful interference, and (2) this device must accept any interference received, including interference that may cause undesired operation.

Note: Modifications to this product will void the user's authority to operate this equipment.

For further technical assistance please contact
CW Products on +61 8 8341 0120 or email
info@cwproducts.com.au

Exclusively Distributed
In Australia By
CW Products



CW PRODUCTS
HOME AUTOMATION & ROLLER SHUTTERS