

YN600L II
Pro LED Video Light
User Manual

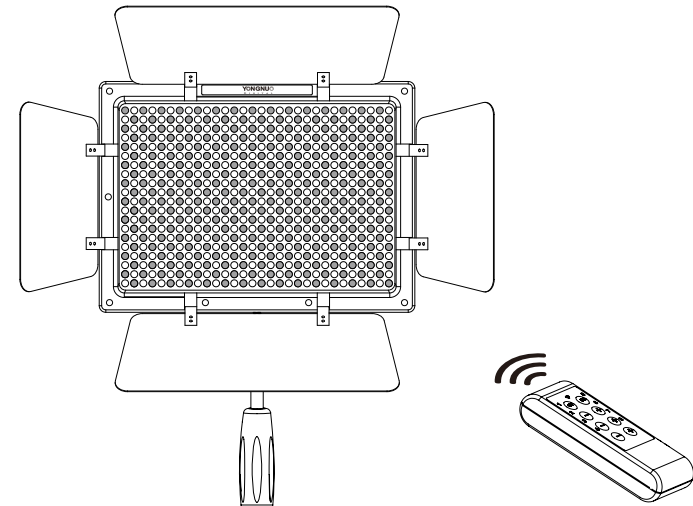

Before using this product, please read this user manual carefully and keep it properly for reference.

Overview
First of all, thank you for using the YONGNUO YN600L II LED video light. This video light is formed by 300 lamp beads with 3200K color temperature and another 300 lamp beads with 5600K color temperature. The lamp beads of extra-large luminous chips,with higher brightness in same energy consumption; The color temperature can be adjusted from 3200k to 5600K,with more practical use; in addition,it adopts the latest LED driving technology, definitely not appear the corrugated,stroboscopic and other negative phenomena when shooting; it adopts the encoder digital dimming mode, thus the video light can be dimmed accurately and reliable;built-in 2.4G wireless remote control system; equipped with 8 channels grouping function;besides, it can be remote controlled or mobile wireless remote control,group control the brightness and other powerful function of the LED video light.

I.Product Structure

1. Reflector
2. 5600K color temperature LED lamp beads
3. 3200K color temperature LED lamp beads
4. Hand grip
5. Battery lock
6. DC supply hub
7. Heat abstractor
- 8.Power switch/ Luminance adjusting knob
9. LED digital display screen
10. Fine/Coarse button
11. Electric quantity testing button (Batt button)
12. 3200K/5600K color temperature button
- 13.Pilot lamp

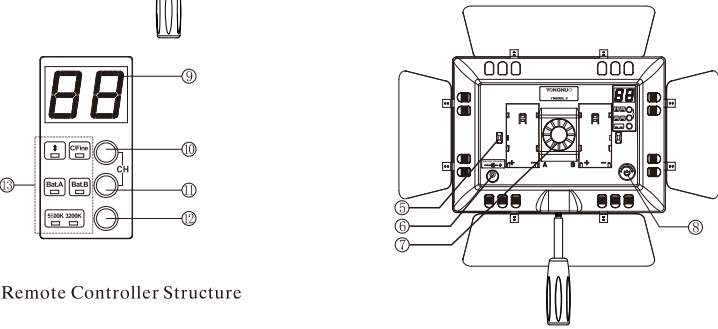

Remote Controller Structure

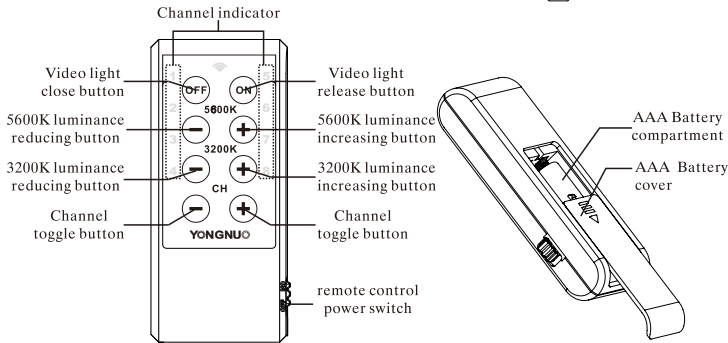

II. Function Introduction

1. YN600L II is equipped with multi channel wireless remote controller which is used to adjust the luminous intensity and control the switch of YN600L II. Furthermore, it is very convenient to use this controller to control the luminous intensity and the switches of 8 groups of video lights.
2. A mobile APP is provided on our official website. With this mobile APP, you can control this LED video light with your mobile phone, read the current parameter of the luminous intensity and channel, and, control the luminous intensity and the switches of 8 groups of video lights individually. You can control your LED video light as needed.
3. YN600L II is formed by 300 lamp beads with 3200K color temperature and another 300 lamp beads of extra-large luminous area with 5600K color temperature. In the same energy consumption, the luminous intensity of the lamp beads of YN600L II is greater. For the color temperature can be adjusted from 3200K to 5600K, YN600L II is more practical.
4. YN600L II adopts YONGNUO proprietary LED driving technology which does great help to effectively avoid corrugation and stroboscopic flash.
5. YN600L II adopts encoder digital dimming system, including coarse tuning mode and fine tuning mode.
6. On the LED digital display screen of YN600L II, the parameter of the power output is intuitional.
7. Shooting for long time is possible because YN600L II supports external DC power input (power adapter is optional).
8. The fan forced heat dissipation YN600L II adopts solves the heating problem after the long use of LED video light.
9. YN600L II equipped with 2 pieces of color temperature filters, can be used under different circumstances.

III. Method of Application

1. Battery Installation
a. When the lithium battery is mounted, the battery should be mounted to the card groove according to the arrow direction; when installed a battery,300 LED lamp beads can be lighted, other functions can be normally used; when installed two batteries,600 LED lamp beads can be lighted.(Note:install one battery can not adjust the color temperature, can only separate light the 3200K color temperature of lamp bead or the 5600K color temperature of lamp bead)
Note: NP-F series battery is applicable, please remove the battery when not in use.

- b. When removing the lithium batteries, please press the battery lock and then take out the lithium batteries.

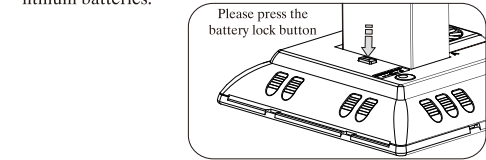

2. Fasten Video Light As Follow As Needed:
a.Fasten the video light to the tripod directly

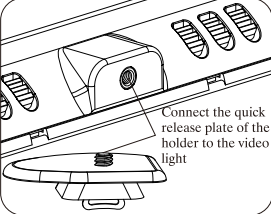
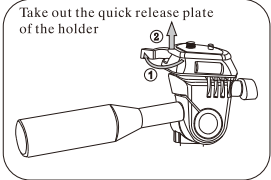

- b.Multifunctional Type-D lamp holder is an optional choice for fixing the vedio light to the film studio, light stand, tripod.

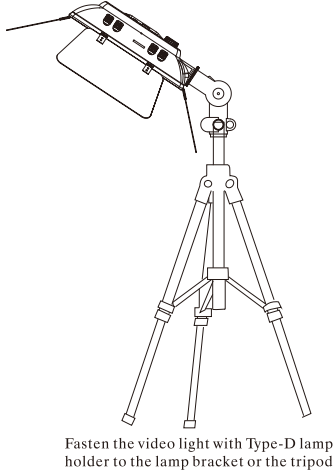
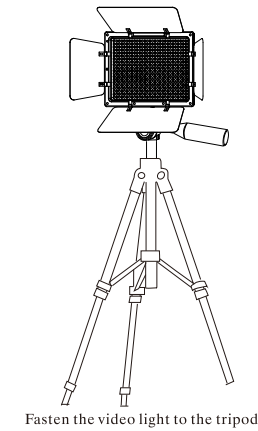
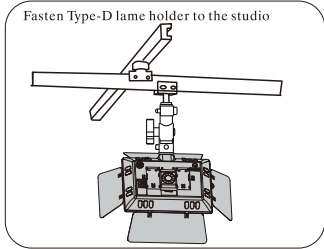
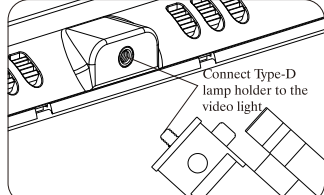

- c.Fasten the video light to the handle attached

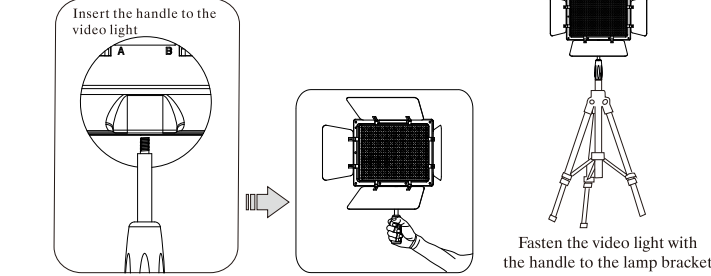

3. Start up & Shut down and Brightness adjustment
a. When pressing the power switch button, the LED video light will light up; rotate this button rightwards the brightness of the LED video light will increase while leftwards will reduce.

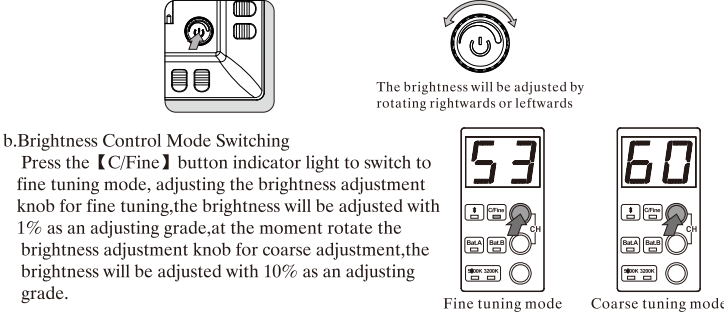

- b.Brightness Control Mode Switching
Press the 【C/Fine】 button indicator light to switch to fine tuning mode, adjusting the brightness adjustment knob for fine tuning,the brightness will be adjusted with 1% as an adjusting grade,at the moment rotate the brightness adjustment knob for coarse adjustment,the brightness will be adjusted with 10% as an adjusting grade.
4. Color Temperature Adjustment
Press 3200K/5600K button to adjust color temperature and acquire the color temperature between 3200K and 5600K by changing the proportion of the intensity. The indicator light lights up at 3200K by pressing 3200K/5600K button, and the light of 3200K can be adjusted by rotating the intensity adjusting knob. By pressing 3200K/5600K button again, the indicator light will lights up at 5600K, and the light of 5600K can be adjusted by rotating the intensity.

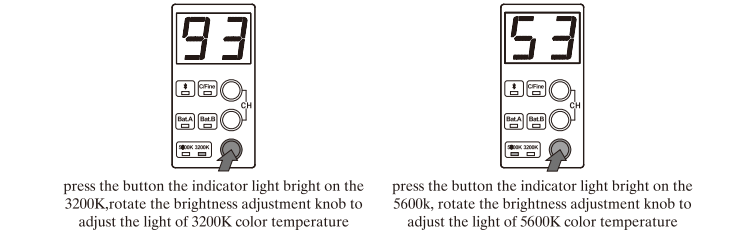

- 5.Battery Electricity Quantity Test
Press the battery electricity quantity test button to test the electric quantity, when the pilot lamp of Bat.A light up,the LED display screen shows the battery level for battery A. Press the battery electricity quantity test button again when the pilot lamp of Bat.B light up,the LED display screen shows the battery level for battery B. The power readings between P0-P9 means 0%-90% of the battery level.For example,the battery level is 30% as the right picture battery A shown, the battery level of battery B is 90% (Note: the rest electric quantity of test when the brightness is low is different from that of the test when the brightness is high, the service life is tested under the current brightness).

- 6.Channel Switch
Press the coarse/fine tuning switching buttons and battery test button at the same time can switch the remote receiving channel,the display screen appears H1 to H8,the channel of LED video light is H2 as the picture shown. Switch the remote control channel to CH2,then the remote controller can adjust the LED video light. If you have multiple this type of the LED video light,it could be grouped control the brightness and switch,maximum can be divided into 8 groups.

- 7.External Power Supply
It is recommended to use YONGNUO power adapter with YN600L II to obtain lasting service time. When using external power supply, the video light will stop the battery power supply automatically and will not get the battery charged. The external power supply interface outside is positive and the interface inside is negative. The input voltage is 12V and the electric current is 5A. Note: If YN600L II defective when it is used with power adapter of other brands, YN600L II will no longer be guaranteed for repair.

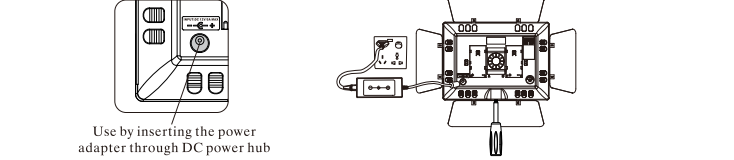

8. Fan Heat Dissipation
YN600L II adopts intelligent fan heat dissipation, which is effective to emit the heat of LED video light after long time use, reduce lumens depreciation and extend service life. The fan runs automatically. To ensure the service life of YN600L II, please do not force the fan stop running, and keep the way between the air intake and the heat dissipation hole clear and unblocked.

IV.Color Temperature Filters

YN600L II comes with two pieces of CT filters. Simply insert the CT filters into the side slot to meet your requirement in different circumstances.

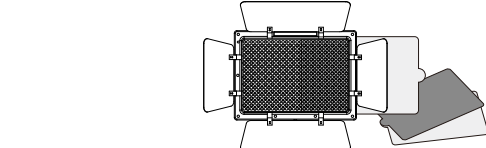

V.Remote Dimming Mode

The wireless remote controller attached can adjust the luminous intensity and control the switches of YN600L II. The maximum remote controlling distance is up to 15 meters.

VI. Mobile APP Remote Control

The product supports mobile remote control , the APP can be downloaded from the YONGNUO official website or download through scanning the two-dimension code on the gift box , Mobile phone APP will be updated continuously. Please pay attention to YONGNUO official website for latest version of APP to get better remote control experience.

VII. Product Specification

Light Source	600 LED beads	Luminance Angle	55°
Color Temperature	3200K-5600K	Control distance	<15M
Output power	36W	Remote control	2. 4G
Lumen	4650LM	Mobile control	Bluetooth 4.0
Average Service Life	50000H	Compatible batteries	Two NP-F750 series lithium batteries
Weight	1326g	External power source	12V 5A DC power supply
		Size	260*188*40MM
Contents: Video light(1), Remote controller(1), Bracket(1),User manual(1), Color plates(2), Note: Should anything missing please contact your dealer			

VIII. Failure Analysis and Troubleshooting

When using this product, you may encounter the following problems:

Description	Cause	Troubleshooting
No reaction after power on	Low Battery Damaged circuit board	Install new batteries or connect external power supply Depot repair
Inadequate or low luminance at the greatest luminous intensity	Low battery	Install new batteries or re-charge the batteries
Inaccurate battery capacity test; low battery in high luminance and full battery in low luminance.	The battery capacity indicates the length of time available for the use in the current luminance. Higher luminance required more power and the length of time available for use will be shortened, so the battery capacity shown gets lower	Normal phenomenon and no measure needed
The video light can't be controlled remotely.	Too far away Remote control and LED light are on different channels	Ensure the remote control distance is no more than 15 meters pls refer to User Manual to reset channel
The cooling fan sometimes works and sometimes stops working.	The cooling fan is automatically controlled by the LED video light, which cannot be manually turned on and off.	Normal phenomenon
The pilot lamp on the remote controller is dimming	Low battery	Replace two AAA batteries
Screen display E1	The external power supply voltage is too high.	Please use the external power properly because the high voltage will permanently damage the video light and unable to get guarantee repair. The video light supports input voltage of 12V,the electric current of greater than or equal to 5. Recommend for using the optional special power adapter for the video light, which can be purchased from the dealers.

FCC Statement

This device complies with part 15 of the FCC Rules. Operation is subject to the following two conditions:
(1) This device may not cause harmful interference, and
(2) this device must accept any interference received, including interference that may cause undesired operation.

Class B device
NOTE: This equipment has been tested and found to comply with the limits for a Class B digital device, pursuant to part 15 of the FCC Rules. These limits are designed to provide reasonable protection against harmful interference in a residential installation. This equipment generates, uses and can radiate radio frequency energy and, if not installed and used in accordance with the instructions, may cause harmful interference to radio communications. However, there is no guarantee that interference will not occur in a particular installation. If this equipment does cause harmful interference to radio or television reception, which can be determined by turning the equipment off and on, the user is encouraged to try to correct the interference by one or more of the following measures:
—Reorient or relocate the receiving antenna.
—Increase the separation between the equipment and receiver.
—Connect the equipment into an outlet on a circuit different from that to which the receiver is connected.
—Consult the dealer or an experienced radio/TV technician for help.
Warning: Changes or modifications not expressly approved by the party responsible for compliance could void the user's authority to operate the equipment.

The functions in this manual are based on the test conditions our company. Further notice will not be given if the design and specifications change.