

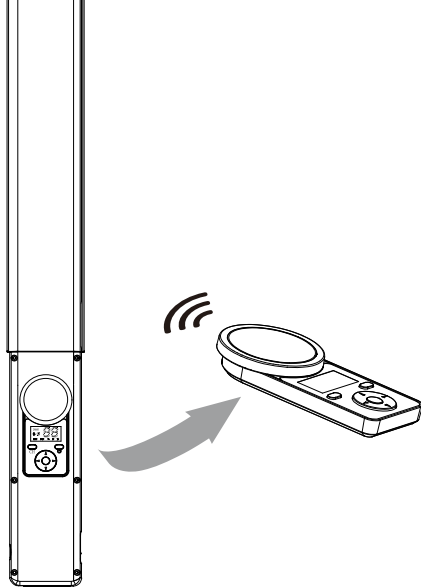

YN360 III YN360 III PRO Pro LED Video Light User Manual



Thank you for using the YN360 III LED video light. Please read the manual carefully and keep this user manual properly for reference.

Function Introduction

- 1.YN360 III is YONGNUO brand new LED video light which brings you a more powerful fill light brightness and more wider fill light range, with easier RGB mode adjustment to meet your various fill light needs.
- 2.YN360 III uses a combination of 360 high-definition lamp beads and 60 RGB full-color patch lights.
- 3.The YN360 III is equipped with a proprietary multi-channel wireless remote control that easily adjusts the RGB mode via the remote control touch screen, making RGB mode adjustment easier. At the same time, it supports the frequency division control of 8 groups of video lights.
- 4.YN360 III supports mobile phone APP to control the LED video light, reads the brightness and group channel of the current LED video light, can control the switch and brightness of 8 groups of video lights separately, and easily complete the photography needs.
- 5.YN360 III supports dual power input, supports NP-F series battery and external DC power supply, to meet the needs of your various environments.
- 6.YN360III adopts YONGNUO proprietary LED constant-current drive technology, will not appear ripples or stroboscopic phenomena during the shooting.

precautions

- 1.This product should be used under the ventilated environment. Please make sure the heat emission hole won't be blocked when you are using this speed-lite.
- 2.Do not disassemble the product, maintenance or repair of this product should be carried through by technical maintenance personnel of our company or technical maintenance personnel authorized.
- 3.When the equipment is running, do not look into the light directly and closely.
- 4.Do not use this product in flammable and explosive place, or where it can be exposed to moisture.
- 5.Please keep this product away from the children.

Product Specificaion

*5600K color temperature **YN360 III**

Light Source	360 LED lamp beads and 60 RGB SMD lamps		
Color Temperature	5600K and RGB full color		
Output power	21.6W and 10.8W	Control distance	<15M
Average Service Life	50000H	Luminance Angle	55°and 110°
Weight	805G		
Compatible batteries	One NP-F series lithium batteries		
External power source	12V2A DC power supply		
Size	583*48*24mm		
Light Intensity (Full Power)	Light Distance	5600K	RGB full color
	0.3M	10830Lux	1810Lux
	0.5M	6230Lux	930Lux
	1M	1970Lux	335Lux

Contents : Video light (1)、User Manual (1)、CT Filters (1)、Storage Bag(1)、Sling(1)、Remote Controller(1).
Note: Please contact your dealer if anything missing.

YN360 III

*3200K、5600K color temperature

Light Source	360 LED lamp beads and 60 RGB SMD lamps				
Color Temperature	3200K、5600K and RGB full color				
Output power	21.6W and 10.8W	Control distance	<15M		
Average Service Life	50000H	Luminance Angle	55°and 110°		
Weight	805G				
Compatible batteries	One NP-F series lithium batteries				
External power source	12V2A DC power supply				
Size	583*48*24mm				
Light Intensity (Full Power)	Light Distance	3200K and 5600K	3200K	5600K	RGB full color
	0.3M	10460Lux	5730Lux	5750Lux	1810Lux
	0.5M	5960Lux	3080Lux	3220Lux	930Lux
	1M	1997Lux	930Lux	1074Lux	335Lux

Contents : Video light (1)、User Manual (1)、CT Filters (1)、Storage Bag(1)、Sling(1)、Remote Controller(1).
Note: Please contact your dealer if anything missing.

*5600K color temperature**YN360 III PRO**

Light Source	360 LED lamp beads and 60 RGB SMD lamps		
Color Temperature	5600K and RGB full color		
Output power	21.6W and 20W	Control distance	<15M
Average Service Life	50000H	Luminance Angle	55°and 110°
Weight	805G		
Compatible batteries	One NP-F series lithium batteries		
External power source	12V2A DC power supply		
Size	583*48*24mm		
Light Intensity (Full Power)	Light Distance	5600K	RGB full color
	0.3M	10830Lux	5430Lux
	0.5M	6230Lux	2590Lux
	1M	1970Lux	790Lux

Contents : Video light (1)、User Manual (1)、CT Filters (1)、Storage Bag(1)、Sling(1)、Remote Controller(1).
Note: Please contact your dealer if anything missing.

YN360 III PRO

*3200K、5600K color temperature

Light Source	360 LED lamp beads and 60 RGB SMD lamps				
Color Temperature	3200K、5600K and RGB full color				
Output power	21.6W and 20W	Control distance	<15M		
Average Service Life	50000H	Luminance Angle	55°and 110°		
Weight	805G				
Compatible batteries	One NP-F series lithium batteries				
External power source	12V2A DC power supply				
Size	583*48*24mm				
Light Intensity (Full Power)	Light Distance	3200K and 5600K	3200K	5600K	RGB full color
	0.3M	10460Lux	5730Lux	5750Lux	5430Lux
	0.5M	5960Lux	3080Lux	3220Lux	2590Lux
	1M	1997Lux	930Lux	1074Lux	790Lux

Contents : Video light (1)、User Manual (1)、CT Filters (1)、Storage Bag(1)、Sling(1)、Remote Controller(1).
Note: Please contact your dealer if anything missing.

Product Structure

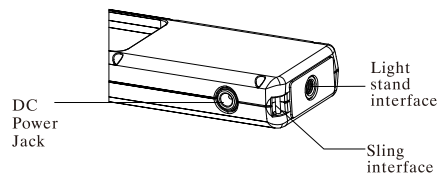
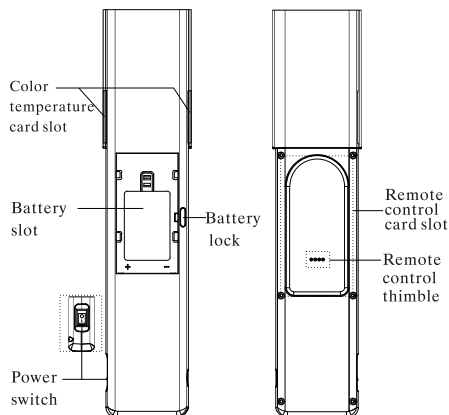

Remote Controller Structure

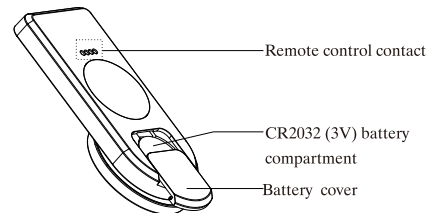
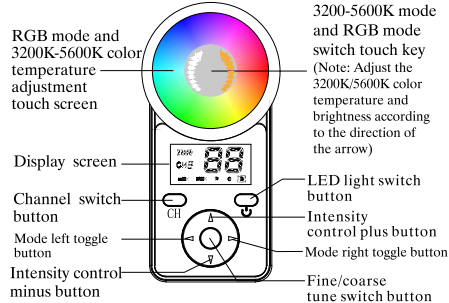

Installation and fixed

1.Battery Installation

When installing the lithium battery, please put the battery into the slot in the direction of the arrow.

Note: NP-F series battery is applicable, please remove the battery when not in use.

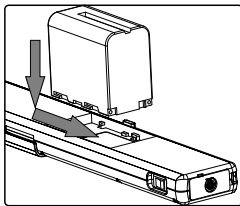

b. When removing the lithium batteries, please press the battery lock and then take out the lithium batteries.

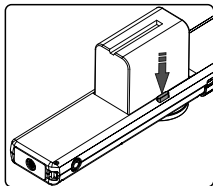

2.External power supply

It is recommended to use YONGNUO power adapter with YN360 III to obtain lasting service time. When using external power supply, the video light will stop the battery power supply automatically and will not get the battery charged. The external power supply inter face outside is negative and the interface inside is positive. The input voltage is 12V and the electric current is 2A.Note:If YN360 III defective when it is used with power adapter of other brands, YN360 III will no longer be guaranteed for repair.

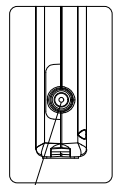

Use by inserting the power adapter through DC power hub

3. Put the remote control into the video light card slot to use.

When the remote-controller is not equipped with batteries, insert the remote-controller into the video card slot, you can use it when the remote control iron plate and the camera light magnet absorbed together. If remotely control the video light needed, install a CR2032 battery to the remote control.

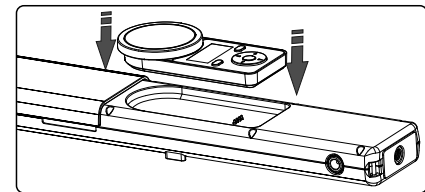

4. Fasten video light as follow as needed:
Fasten the video light to the tripod directly.

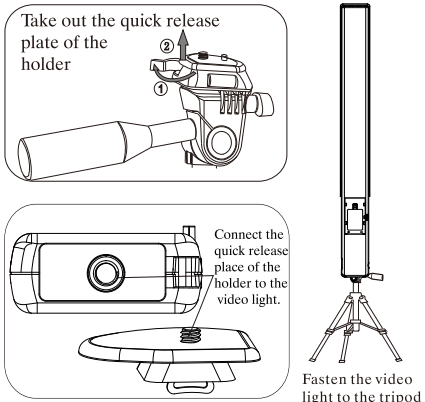

Method Application

1.Startup & Shutdown Button

Install the batteries or insert the DC power supply, and then press the power switch, the LED video light lights up. Put the remote controller into the LED video light and use it to adjust the brightness.

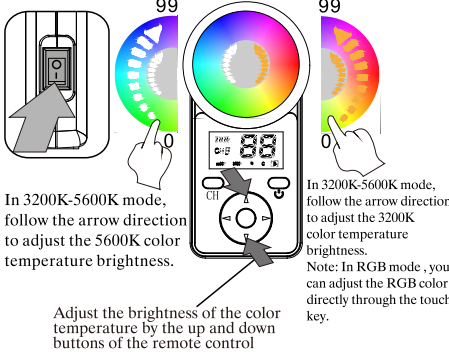

2. Power test

Insert the remote control into the video light card slot, the remote control displays the battery power for the video light. The battery power is 41% to 60% as shown below.

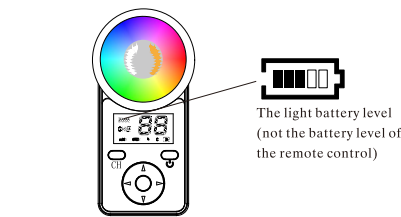

3.Coarse/Fine adjusting Switch Button

Fine/Coarse Tune Mode Press fine/coarse tune button on the remote cotroller to switch the tune mode. When the tune mode is switched to coarse tune mode, the adjusting unit of the brightness is 10%; when it's fine tune mode, the adjusting unit is 1%.

Note: Press and hold the 2 second coarse/fine button to lock the touch screen to avoid mistake touch; long press again to unlock.

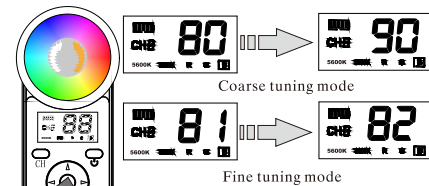

4.Switch color temperature mode

Press the left and right buttons of remote control to switch the color temperature mode.

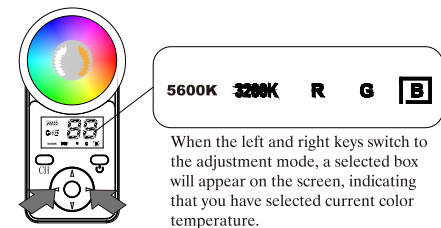

5.Channel switch button

A. Put the remote controller into the card slot of the video light, short press [CH] button on the controller, and the video light and the controller synchronously CH+, the controller will be switched to the channel needed. When you take the controller off, the channel of the video light and the channel of the controller is consistent.

B. For example, if the channel of the controller is switched to channel H2, the channel of the video light is CH2; when you take the controller off, the channel of the video light is as well CH2. To switch the channel of the video light, the remote controller should be inserted to the card slot of the video light.

C. If you possess several YN360 III, you can group control the brightness and switches; the groups at most is 8 groups. (The LCD screen of the remote control can display the number of CH1-8, each number corresponds to the corresponding channel, you can change the channel through the CH button.)

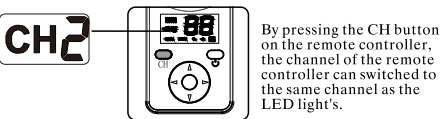

6.Color Temperature Filters

This product comes with a color temperature plate, take the color temperature film out from the back of the product and placed it in the front of the photographic lamp face, when it sucked by the top magnet and stick into the color temperature card slot, it ready to use.

Note: When using the video light for a long time, please remove the color temperature plate at the position of the heat dissipation hole to ensure the heat dissipation effect of the video light.

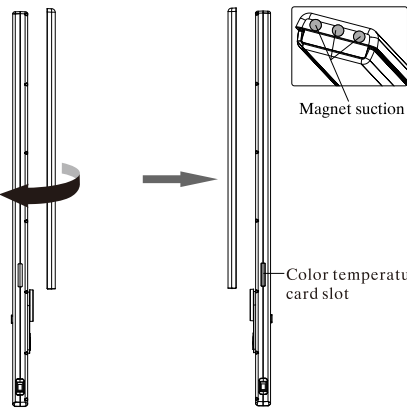

7.Mobile APP Remote Control

The product supports mobile remote control , the APP can be downloaded from the YONGNUO official website or download through scanning the two-dimension code on the gift box, Moible phone APP will be updated continuously. Please pay attention to YONGNUO official website for latest version of APP to get better remote control experience.

8.Special Scene Supplementary Lighting Mode

- 1,Long press CH button for 2 seconds to enter special scene mode ,F0 displays.
- 2,Short press CH button to switch F0-F9 (10 scenes) or left right button to switch 10 different scenes.
- 3,Short press coarse/fine tuning switch button to pause or start the special scene supplementary lighting.
- 4,Long press CH button to exit or power off and exit.

F0.Simulates lightning

- F1.Simulates movie screen reflect light
- F2.Simulates candlelight
- F3.Simulates sunrise
- F4.Simulates firework
- F5.Rapid cycle among red, green, blue
- F6.Slow cycle among red, green, blue
- F7.Simulates police car light
- F8.Simulates ambulance light
- F9.Simulates fire fighting truck light

FCC Statement

This device complies with part 15 of the FCC Rules. Operation is subject to the following two conditions: (1)This device may not cause harmful interference, and (2) this device must accept any interference received, including interference that may cause undesired operation.

Class B device

NOTE: This equipment has been tested and found to comply with the limits for a Class B digital device, pursuant to part 15 of the FCC Rules. These limits are designed to provide reasonable protection against harmful interference in a residential installation. This equipment generates, uses and can radiate radio frequency energy and, if not installed and used in accordance with the instructions, may cause harmful interference to radio communications. However, there is no guarantee that interference will not occur in a particular installation. If this equipment does cause harmful interference to radio or television reception, which can be determined by turning the equipment off and on, the user is encouraged to try to correct the

interference by one or more of the following measures:
—Reorient or relocate the receiving antenna.
—Increase the separation between the equipment and receiver.

—Connect the equipment into an outlet on a circuit different from that to which the receiver is connected.
—Consult the dealer or an experienced radio/TV technician for help.

Warning: Changes or modifications not expressly approved by the party responsible for compliance could void the user's authority to operate the equipment.

The functions in this manual are based on the test conditions our company. Further notice will not be given if the design and specifications change.