

# Wireless Charging Mouse Pad

## manual

### The diagram of installation

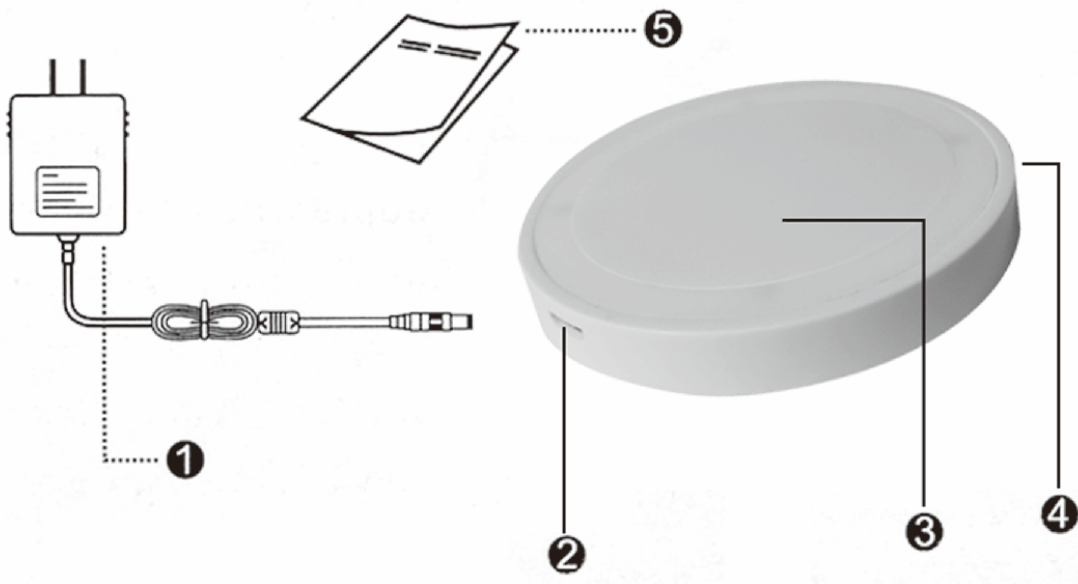

- ❶ Power supply
- ❷ Connector for power supply
- ❸ Charging area
- ❹ Indicator Light area
- ❺ Product description

### First of all ,thanks sincerely for buying this product

For your safety ,please read this manual carefully before using this product

**The first:**To protect people from harm and property loss,we make a clear explanation on what you do should obey:

A:Warning!Thereare concerning the possibilities of death and severs wound:People who use heart-birth -maker should consult your doctor before you use this product and please leave it at a Distance of 50cm form the place where you install your heart -birth Maker,the electromagnetic wave have influence on hard birth-maker's work.

B:Attention !it may led to heat fire and electric shock DO NOT put it into water or any other liquid

- 1) Donot put it into water or any other liquid,Do not make it wet
- 2) Do not pull the adapter out with wet hands ensure The safety and integrity of the adapter

- 3) Do not let the dust or other thing accumulate on the product and the AC adapter
- 4) Do not use the product outside the temperature -20℃ to 40℃
- 5) Do not charge in place where the sunshine directly or With high temperature
- 6) Do not use this product in places that are easy to fall,so as not to break
- 7) Do not lay the magnetic card,magnetic record media and precise machine too close to the protect
- 8) Do not decompose and remold
- 9) Do not lay the anything between the non-connect charging pad and the charging machine
- 10)Do not surpass the rated value when using the plug and other wiring layout
- 11)Do not your breakage on the AC adapter please make sure you connect the AC adapter fully and take the AC adapter off the plug when it not use
- 12)Do not use travel converter
- 13)Please touch your children ,the let them use

**The second** :Product advantages

- 1) The product is of high sensitivity,intelligent recognition ,put a charge ,after charging automatically enter Standby mode of the product
- 2) Charge for all Qi compliant product
- 3) Efficiency can reach more than 70%,less heat
- 4) In the process of charging can be free to pick up answer The phone ,freeing discharge or charge

**The third**:Wireless charge's charging method

- 1) Please connect the product the AC adapter or USB to the computer socket red light is on enters the standby status
- 2) Charge the device placed directly in charge of the product label instructions regional(no direction of attention )blue light red light at the same time entering the charge Electrical state  
need charging equipment ,charging is complete
- 3) Need charging equipment,charging is completed,the red light is on,take

**The fourth**:Product features

Product mode:

Main functions:wireless charging transmitter

Standard version:WPC-1.1;

Products applicable :all wireless charging equipment

Accorded with QI standard

Charging type:one--on-one charge corresponding area

The input voltage:DC5V

Launch distance:4 to 6mm;

Conversion efficiency  $\geq 70\%$

Charging methods: induction model

Working frequency: 125kHz

Accessories /component name :USB cable,wireless

Charging pad :packing box :Adapter (selective)

#### FCC Warning Statement

Changes or modifications not expressly approved by the party responsible for compliance could void the user's authority to operate the equipment. This equipment has been tested and found to comply with the limits for a Class B digital device, pursuant to Part 15 of the FCC Rules. These limits are designed to provide reasonable protection against harmful interference in a residential installation. This equipment generates uses and can radiate radio frequency energy and, if not installed and used in accordance with the instructions, may cause harmful interference to radio communications. However, there is no guarantee that interference will not occur in a particular installation. If this equipment does cause harmful interference to radio or television reception, which can be determined by turning the equipment off and on, the user is encouraged to try to correct the interference by one or more of the following measures:

- - Reorient or relocate the receiving antenna.
- - Increase the separation between the equipment and receiver.
- - Connect the equipment into an outlet on a circuit different from that to which the receiver is connected.
- - Consult the dealer or an experienced radio/TV technician for help.