

This product is recommended for ages 14+, but should always be used with adult supervision.

Thank you for purchasing our product. In order to safely enjoy this UFO, please read this manual carefully before using. Please keep it for future reference.



For Ages 14+
RECOMMENDED

GRAVITY UFO 2.0

4CH 2.4GHz REMOTE CONTROL QUADCOPTER

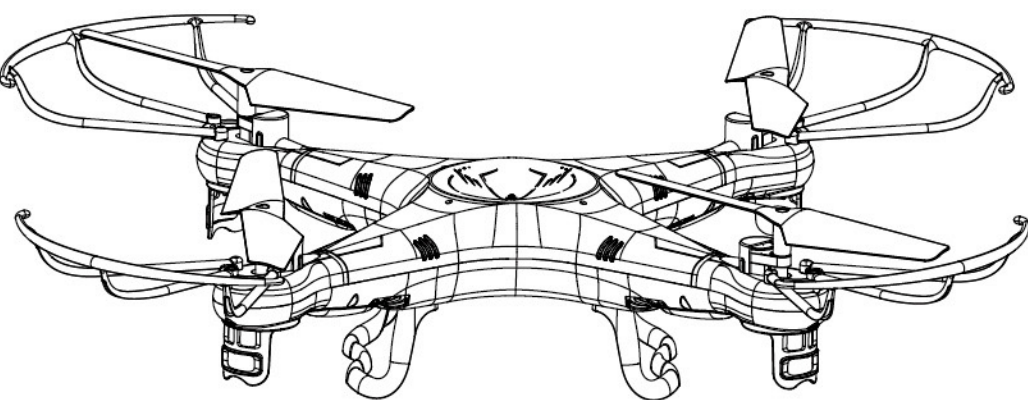

INSTRUCTION MANUAL

Key Features of Quadcopter

- Quadcopter design makes the aircraft more quick and agile when flying, while maintaining its speed. It is wind-resistant and can be flown both indoors and outdoors.
- Built-in 6-Axis gyroscope for precise hovering in the sky.
- Simple modular design makes it easy to change parts.
- Equipped with 360° 3D Eversion and throwing flight functionality.

GET TO KNOW YOUR TRANSMITTER

- This product is not a toy, but a detailed piece of equipment that integrates mechanics and electronics, and uses aerodynamics and high-frequency transmitting. This product requires correct assembly and debugging in order to prevent any unforeseen accidents from occurring. The product owner should always operate the aircraft in a safe manner. Please note that the manufacturer will not take responsibility for any unforeseen situations that may result in severe injury, or loss of property.
- This product is suited to be flown by users no younger than 14 years old, with sufficient experience in flying model devices and vehicles.
- Product should be flown in an area with adequate space, with no regulations or restrictions on remote-controlled flying devices.
- Once the product is sold, the manufacturer is not responsible for the safety of the user while operating or controlling this product.
- The suitable outside flying temperature of the product lies between minus ten, to forty degrees centigrade.

SAFETY & PRECAUTIONS

This R/C flying device is a highly dangerous product. It is the duty of the user to assess and consider all possible risks that may occur while operating this product.

- Keep the aircraft far away from any crowds or tall structures.
- Do not use the product in the rain, or any other forms of precipitation.
- Keep the aircraft away from strong heat sources.
- Always follow proper safety guidelines, and have proper supervision when using this product.
- Turn the product on and off through the use of the "ON/OFF" switch. Please refer to the diagram below, as the incorrect use of the product's electronics may put bystanders, and ultimately, the user at risk.

CONTENTS

- Quadcopter
- Transmitter
- Main blades
- Screw 4PCS
- USB Charging Cable
- Screwdriver
- Instruction manual



-1-

GET TO KNOW YOUR TRANSMITTER

Introduction of Transmitter

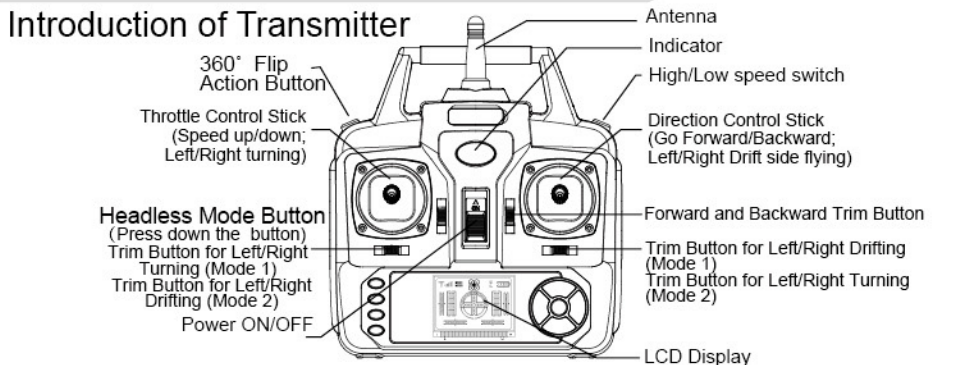

Remote control Installing the Battery

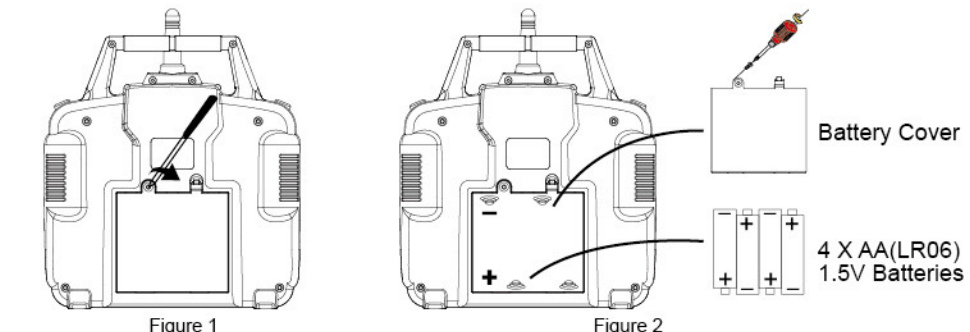

- Use a screwdriver to remove the screw on the back of transmitter then open the battery cover (Figure 1).
- Install 4 "AA" batteries (not included) into the back of transmitter, then replace battery cover and reinstall the screw (Figure 2).

- Install batteries with correct polarity.
- Do not mix old and new batteries.
- Do not mix different types of batteries.

REMOTE CONTROL KEYPAD AND LCD MANUAL

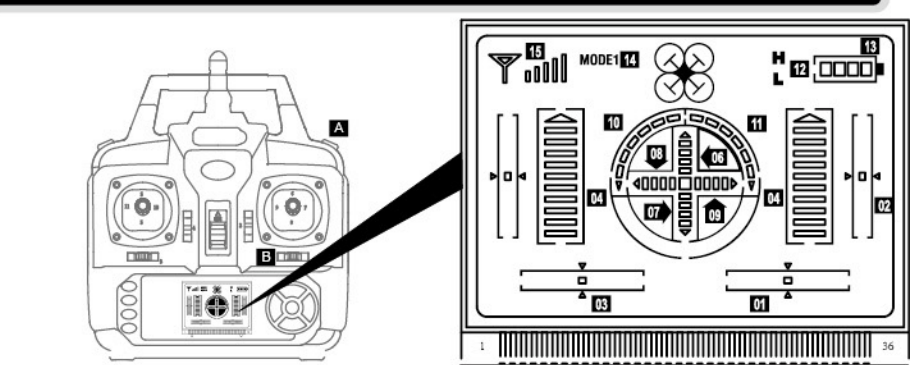

-2-

01. Drift Left/Right Flying Trim (Mode 1) / Turn Left/Right (Mode 2)
02. Forward/Backward Trim
03. Turn Left/Right Trim (Mode 1) / Drift Left/Right Flying Trim (Mode 2)
04. Throttle Speed
- 06/07/08/09. Direction Control Display
- 10/11. Turn Direction
12. High/Low speed
13. Battery Strength for Transmitter
14. MODE
15. Signal strength between quadcopter and transmitter

INSTALLING LANDING SKIDS & GUARDS



- Install the landing skids on the bottom of quadcopter (Figure 1).
- Install the blade guard to every corner and secure with screw as shown (Figure 2).

READY TO FLY YOUR QUADCOPTER

Step 1: Open the battery cover.

Slide the battery into the compartment, and connect the battery cable to the cable inside the quadcopter. Fit the connected cable fully inside the battery compartment, and slide the cover closed.

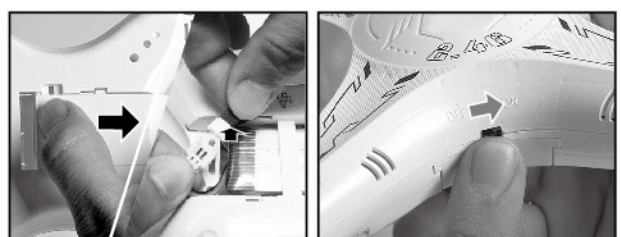

Step 2: Slide the switch on the quadcopter to the ON position.

Place the quadcopter on level ground with the GREEN lights facing forward and the user about 5 feet directly behind it.

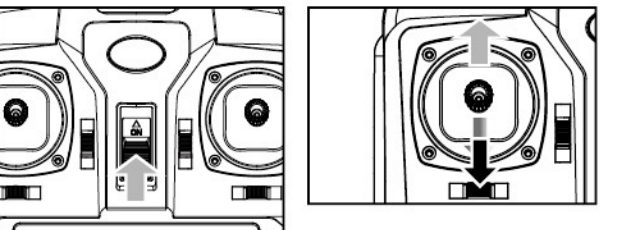

-3-

- Step 3: Turn on the transmitter by pushing the ON/OFF switch up. Push the throttle stick to the highest position, and then pull it back to the lowest position for frequency pairing. There will be one clear beep sound from the transmitter, the GREEN and RED lights will stop flashing and stay on. This shows that the quadcopter has entered into the pre-fly state.

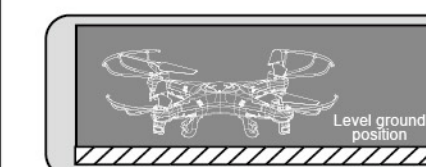

TIPS: When syncing your quadcopter, keep it on level ground.

CAUTIONS:

- When the indicator light of the transmitter is blinking slowly, this indicates that the signal pairing was unsuccessful. Please turn off the power of the transmitter and quadcopter, and then restart the transmitter and quadcopter.
- If the quadcopter is still flying on its side dramatically or spinning while hovering, please switch off the power of both the quadcopter and transmitter, and then repeat the pre-flying steps.
- When the indicator of the quadcopter keeps flashing slowly, it means that the quadcopter has entered into the low battery state. The quadcopter will need to be charged with the USB cable provided.

CHANGING THE BATTERY OF THE QUADCOPTER

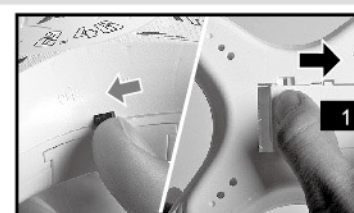

- Push the ON/OFF switch of the quadcopter to the OFF position, then open the battery cover.
- Open the battery cover, while carefully removing the battery. Connect the battery cable to the USB cable as shown.

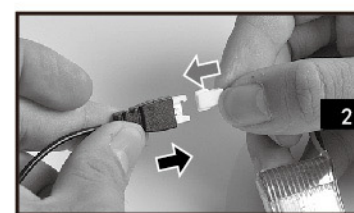

- Insert the other end of the USB charging cable into any available USB port on your computer, or to a USB wall charger. The indicator light on the USB charging cable will be OFF during charging, and will turn ON once charging is complete.

Charging time: about 60 min — Flying time: 6-8 min

-4-

CAUTIONS WHEN CHARGING

- When charging, please keep the product in a dry, ventilated area, far away from any heat sources or flammable items.
- When charging, please remove the batteries from the aircraft.
- Charging the product immediately following flying may result in a fire hazard. Please give the product's electronics time to cool down after flying.
- Please use the original USB charging cable provided. Replace batteries or cable when either is not functioning properly after an extended period of time.
- When not in use for an extended period of time, a battery will lose its charge automatically. Charging or discharging too often may reduce the lifespan of the battery.

BATTERY REPAIR & MAINTENANCE

- Please store the battery in a dry and well-ventilated area, with a recommended temperature of 18-25 degrees Celsius.
- In order to enhance the life of the battery, please avoid excessive charging or discharging.
- In the event that the battery needs to be stored for an extended period of time, please change the battery first.

CAUTIONS:

PRIOR TO FLYING, ALWAYS CHECK YOUR QUADCOPTER AND TRANSMITTER FOR ANY DAMAGE. DO NOT ATTEMPT TO FLY WITH A DAMAGED QUADCOPTER OR TRANSMITTER. KEEP YOUR QUADCOPTER IN VIEW AT ALL TIMES WHEN FLYING. STAY INFORMED ON THE RULES FOR FLYING REMOTE CONTROLLED ITEMS IN YOUR LOCAL AREA. START OUT SLOWLY AND PRACTICE YOUR SKILLS UNTIL YOU BECOME AN EXPERT. CHOOSE A WIDE OPEN AREA FOR FLYING, STAYING AWAY FROM PEOPLE, ANIMALS, AND OBSTACLES. ALWAYS USE GOOD JUDGEMENT. AS YOU ARE RESPONSIBLE FOR THE FLIGHT AND CONTROL OF YOUR QUADCOPTER.

CONTROLLER MODES & INSTRUCTIONS

The controller has two built-in modes. The controller will always be in MODE 1 when you turn it on. To switch to MODE 2, push button B to the right at the same time as you turn on the controller.

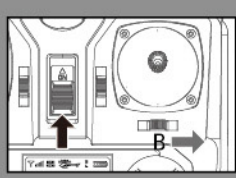

-5-

MODE 1

Operating direction

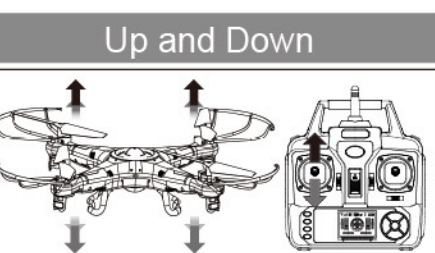

Push the throttle stick up or down, the quadcopter will ascend or descend.

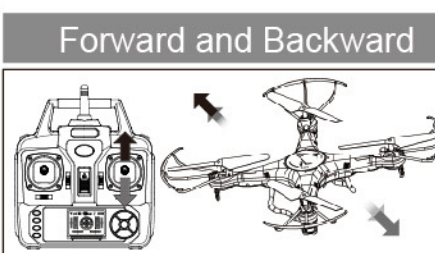

Push the direction stick up or down, the quadcopter will move forward or backward.

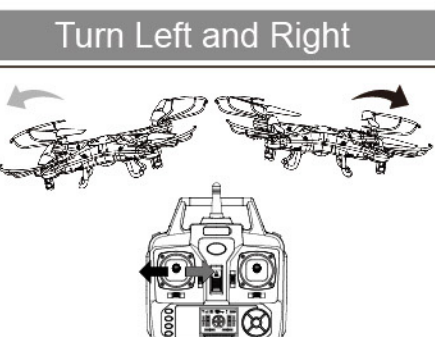

Push the throttle stick to the left or right, the quadcopter will turn to left or right.

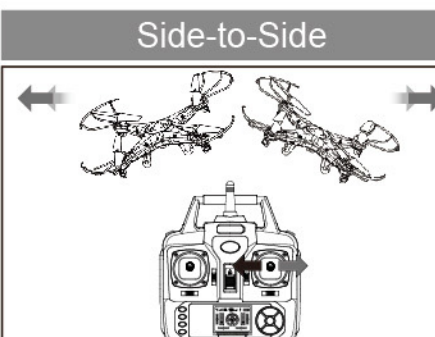

Push the direction stick to the left or right, the quadcopter will drift to left side or right side.

Trim Adjustment:

Forward/Backward Trim

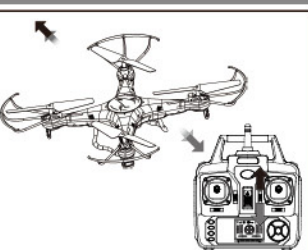

When the quadcopter keeps moving forward / backward by itself, you can correct it by pressing the Forward/Backward Trim Button down / up.

Drift Side-to-Side Trim

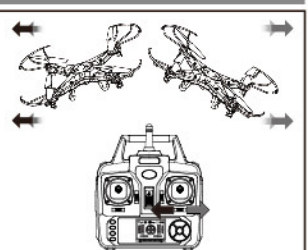

When the quadcopter keeps drifting to the left / right side by itself, you can correct it by pressing the Left/Right turning Trim Button right / left.

Left/Right Turning Trim

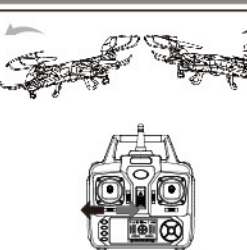

When the quadcopter keeps spinning counter clockwise / clockwise, you can correct it by pressing the Left/Right turning Trim Button to the right / left.

-6-

MODE 2

Operating direction

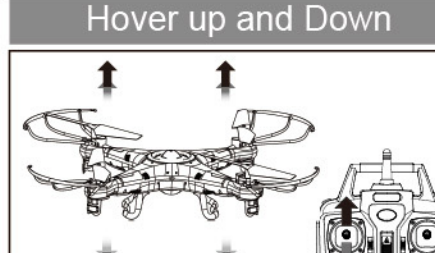

Push the throttle stick up or down, the quadcopter will ascend or descend.

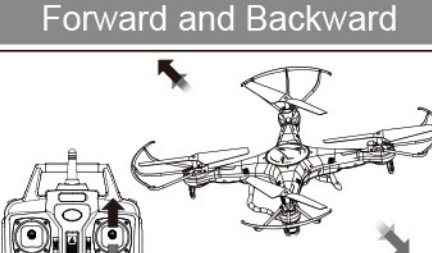

Push the direction stick up or down, the quadcopter will move forward or backward.

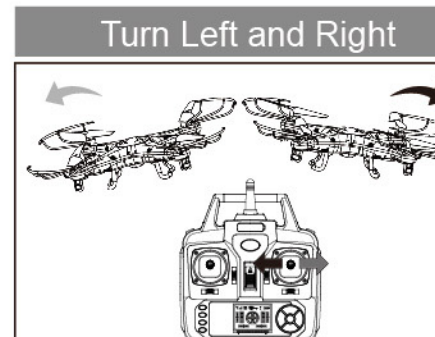

Push the direction stick to the left or right, the quadcopter will turn left or right.

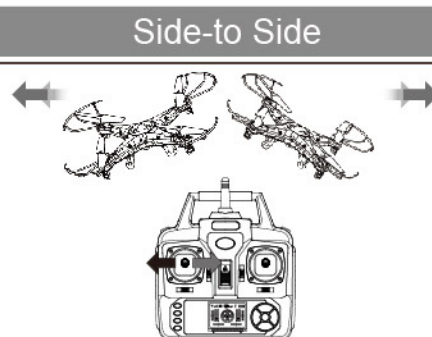

Push the throttle stick to the left or right, the quadcopter will drift to left side or right side.

Trim Adjustment:

Forward/Backward Fine-Tuning

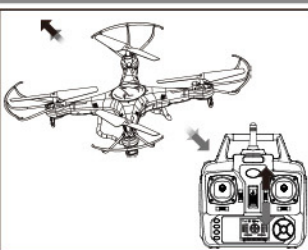

When the quadcopter keeps moving forward / backward by itself, you can correct it by pressing the Forward/Backward Trim Button down / up.

Drift Side-to-Side Trim

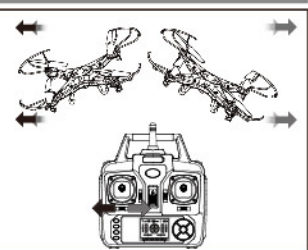

When the quadcopter keeps drifting to the left / right side by itself, you can correct it by pressing the Left/Right turning Trim Button right / left.

Left/Right Turning Trim

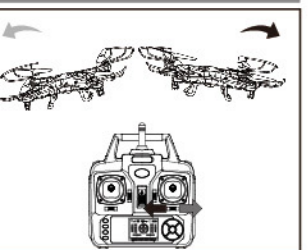

When the quadcopter keeps spinning counter clockwise / clockwise, you can correct it by pressing the Left/Right turning Trim Button to the right / left.

-7-

INTRODUCTION OF QUADCOPTER FUNCTIONS

3D EVERSION AND THROWING FLIGHT INSTRUCTIONS

Once the user is familiar with the basic flying techniques, they can then begin practicing exciting tricks and stunts! The device must be flown at a height higher than 3 meters. Once the required height has been achieved, press and hold the FLIP ACTION Button switch on the rear left side of the transmitter, and push the direction stick (in any direction) to make a 360-Degree flip.

Tips: 360° ACTION FLIP works best when the battery is at a full charge.

Thanks to the 6-Axis gyroscope, the aircraft has the ability to automatically correct itself, and hover smoothly in the air, no matter what direction the aircraft is flying in. You can simply throw the quadcopter into the air and push the throttle stick forward.

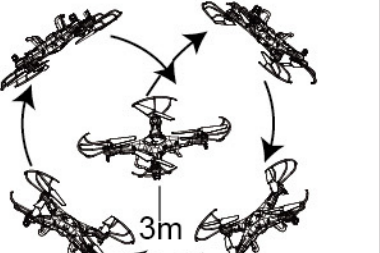

REGULAR MODE / HEADLESS MODE

① When flying in "Regular Mode", the lights on the quadcopter will be solid. The GREEN lights indicate the front of the aircraft, and the RED lights indicate the back of the aircraft. When flying in "Headless Mode", the lights will blink slowly. Regardless of the direction of the lights in relationship to the operator, the quadcopter will follow the direction of the control stick on the transmitter.

② When the controller and the quadcopter are synced, by default, the aircraft will be in "Regular Mode". To switch to "Headless Mode", press down on the button below the throttle stick until you hear a "beep". The lights will slowly blink to indicate that "Headless Mode" has been enabled. To return to "Regular Mode", press the button below the throttle stick until you hear a "beep" again. The lights will turn solid to indicate that the user has returned to "Regular Mode".

IMPORTANT: When turning on the quadcopter and controller to sync them, you must remember to place the quadcopter directly in front of you with the GREEN lights forward. Failure to do this will cause the quadcopter to not respond properly to the controller and will not allow you to switch to HEADLESS MODE.

-8-

RESTART FUNCTION:

In case of flight disorder or sideward flight, restore factory default settings by the following method:

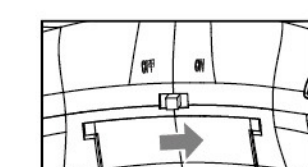

- Press the power switch to turn on the quadcopter, and place directly in front of you with the GREEN lights forward.

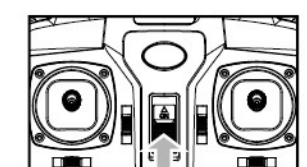

- Press the power switch to turn on the transmitter.

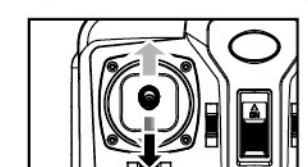

- When the aircraft's indicator lights begin flashing, please press the throttle stick to the highest position, and then back down to the lowest position. The indicator light should then stop flashing and return to normal.

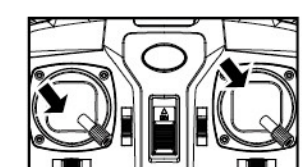

- Place the aircraft in a horizontal position, and push both sticks to the lowest right corner for about 2-3 seconds. The indicator light on the aircraft should begin flashing. After 2-3 seconds, the indicator should stop flashing, and the user should then push both sticks to the highest position, followed by pulling them back to the lowest position. Once the user hears a beep sound, the aircraft has successfully been reset.

ENVIRONMENT FOR FLIGHT:

- Fly on a sunny day, without wind.
- Do not fly in extreme temperatures; do not fly in temperatures above 113 degrees Fahrenheit/ 45 degrees Centigrade, or below 50 degrees Fahrenheit/ 10 degrees Centigrade. Fly in extreme heat and/or cold will affect performance and may damage model.
- Do not fly in strong winds; windy conditions will limit, or disturb flying control. In very windy conditions your helicopter may become lost and/or damaged.
- Select a large, wide open area for flying. Make sure there are no obstructions, water, animals or people nearby.
- Do not fly while it is raining.

-9-

MAINTENANCE PROGRAM:

PROBLEM	CAUSE	SOLUTION
Controller does not work	1. Controller's power switch is "OFF".	1. Turn power switch "ON".
	2. Batteries were not inserted properly.	2. Reinsert the batteries according to the correct polarity.
	3. Batteries lack power.	3. Insert new batteries.
Cannot control the UFO	1. Controller will not operate.	1. Turn controller power switch "ON".
	2. Controller will not operate UFO.	2. Turn UFO's power switch "ON".
	3. Winds are too strong for flight operation.	3. Do not operate in strong winds as controller will not function properly.
UFO will not rise	1. Main rotor blades rotate too slowly.	1. Pull up the throttle stick.
	2. UFO battery is not fully charged.	2. Recharge UFO battery completely.
UFO landing too fast	The throttle stick is being pulled down too fast.	Ensure the throttle stick is pulled down slowly until the UFO lands smoothly.

SAFETY WARNING:

WARNING:

- Not for children under 3 years of age due to small parts.
- Do not try to stop quadcopter while it is in motion.
- Keep hands, face and hair away from all moving parts.
- Exercise caution during use at all times.
- Do not allow children to disassemble the transmitter or controller by themselves.
- Do not operate quadcopter in the vicinity of other people, animals or other obstructions.
- If quadcopter is broken during use, it should be checked or repaired by an adult.
- Remove the batteries from the transmitter and controller when not in use for a longer battery life.
- All battery types must be recycled or disposed of properly.
- Please always read the instruction manual carefully before operating quadcopter.
- Specifications and colors of content may vary from illustrations.

BATTERY CAUTIONS:

- Non-rechargeable batteries are not to be recharged.
- Rechargeable batteries are only to be charged by an adult.
- Different types of batteries or a mix of new and used batteries are not to be used.
- Batteries to be inserted with correct polarity.
- The supply terminals are not to be short-circuited.
- Exhausted batteries are to be removed and properly discarded as they will hinder performance.
- Always use fresh and/or fully charged batteries.
- Please check the wire, plug, shell and other parts of charger periodically and if any damage, stop using until fully repaired.

-10-

The UFO is equipped with a Lithium-Ion rechargeable battery, please also pay attention to the following cautions for safety use:

- Do not use or leave the battery near a heat source.
- Do not dispose of the battery in fire or heat.
- Do not strike or throw the battery against hard surfaces.
- Do not immerse the battery in water, and keep battery in cool, dry environment.
- Do not leave the Li-Po battery in direct sunlight, in a hot car or storage area.
- When recharging, only use the battery charger specifically for that purpose.
- Do not short circuit the Li-Po battery.
- Do not leave the Li-Po battery unattended during the charging process.
- Do not disassemble or alter the battery. The outer casing is soft and can be damaged.
- Do not charge batteries near flammable materials.
- Always let the battery cool between uses and charging.
- Inspect the battery before each use for swelling or malformation. If damaged, discontinue use and discard properly.
- Please recycle after covering the Li-Po battery terminals with insulated tape or insert into an individual polybag.

Warning: Changes or modifications to this unit not expressly approved by the party responsible for compliance could void the user's authority to operate the equipment.

NOTE: This equipment has been tested and found to comply with the limits for a Class B digital device, pursuant to Part 15 of the FCC Rules. These limits are designed to provide reasonable protection against harmful interference in a residential installation. This equipment generates, uses and can radiate radio frequency energy and, if not installed and used in accordance with the instructions, may cause harmful interference to radio communications.

However, there is no guarantee that interference will not occur in a particular installation. If this equipment does cause harmful interference to radio or television reception, which can be determined by turning the equipment off and on, the user is encouraged to try to correct the interference by one or more of the following measures:

- Reorient or relocate the receiving antenna.
- Increase the separation between the equipment and receiver.
- Connect the equipment into an outlet on a circuit different from that to which the receiver is connected.
- Consult the dealer or an experienced radio/TV technician for help.

This device complies with Part 15 of the FCC Rules. Operation is subject to the following two conditions:

- (1) this device may not cause harmful interference, and
- (2) this device must accept any interference received, including interference that may cause undesired operation.

MANUFACTURED BY:
INA INTERNATIONAL LTD.
824 - 41st AVENUE NE
CALGARY, AB, CANADA T2E 3R3

CONFORMS TO THE SAFETY
REQUIREMENTS OF CCCSA TOY
REGULATIONS.

NOT INCLUDED
AAx4

Some replacement parts are available
for this Quadcopter. Please send an
email to ina_service@fgsports.com

LOT: 039EG



WARNING:
CHOKING HAZARD - small parts,
Not for children under 3 years.

-11-