

User’s manual



MA-100

Made for NFC

Made for

Power on/off



- ON** Press the power button for about 3 to 5 seconds.
- OFF** Press the power button for about 2 seconds.

**Note**  
When you turn on the power, the operating status LED indicator blinks for about 5 seconds. You can print it out when the blinking ends, and the LED is turned on white.

Charging the battery

This device has a built-in battery. Make sure that the battery is charged fully before use. Average charging time: About 1 hour and 30 minutes

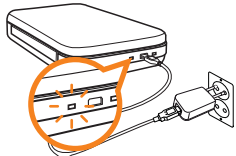

Checking charging status indicator	
Charging status indicator	Description of status
	Charging in progress
	Charging completed

Notice

- Use the standard charger provided by this device.
- The use of a non-standard charger can cause malfunction and exception from the subjects of warranty service.
- There may be the risk of electric shock during the process of charging, so please use with care.
- Do not give abnormal impacts.

Safety Precautions

This equipment has been tested and found to comply with the limits for a Class B digital device, pursuant to Part 15 of the FCC Rules. These limits are designed to provide reasonable protection against harmful interference in a residential installation.

This equipment generate, uses and can radiate radio frequency energy and, if not installed and used in accordance with the instructions, may cause harmful interference to radio communications. However, there is no guarantee that interference will not occur in a particular installation.

If this equipment does cause harmful interference to radio or television reception which can be determined by turning the equipment off and on, the user is encouraged to try to correct the interference by one or more of the following measures.

- Reorient or relocate the receiving antenna.
- Increase the separation between the equipment and receiver.
- Connect the equipment into an outlet on a circuit different from that to which the receiver is connected.
- Consult the dealer or an experienced radio, TV technical for help.
- Only shielded interface cable should be used.

Finally, any changes or modifications to the equipment by the user not expressly approved by the grantee or manufacturer could void the users authority to operate such equipment.

This device complies with Part 15 of the FCC Rules. Operation is subject to the following two conditions:  
(1) this device may not cause harmful interference, and

(2) this device must accept any interference received, including interference that may cause undesired operation of this device.

CAUTION

Any changes or modifications in construction of this device which are not expressly approved by the party responsible for compliance could void the user’s authority to operate the equipment.

CE WARNING

Changes and modifications not expressly approved by the party responsible for compliance could void the user’s authority to operate the equipment.

EN Test Regulations

ETSI EN 300 328 V1.8.1  
ETSI EN 301 489-1 V1.9.2  
ETSI EN 301 489-17 V2.2.1  
EN 60950-1:2006+A11: 2009+A1:2010+A12:2011

Safety Precautions

WARNING

A violation of labeling regulations can cause serious injury or death



Keep out of direct sunlight and away from a heat source.

Do not place heavy objects on the product.

Do not place containers of liquid on the product.

Do not spray water directly onto the product when cleaning.

Do not place the product in very low temperatures.

Do not attempt to disassemble, repair and remodel it for yourself.

Do not drop or give it impact.

Comply with rated (5V/1A) voltage and current.

NOTICE

A violation of labeling regulations causes minor injury or damage to the product



Do not place the product in a hot or humid place.

Keep out of the reach of children.

Keep away from magnetic interference.

Do not place the product in a place with humidity, dust and soot.

Wipe it with a dry cloth when cleaning.

3. Cover Open method

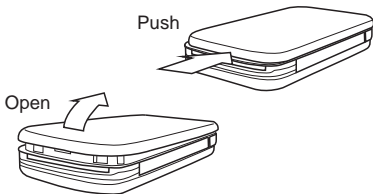

4. Inserting printing paper

- Prepare the blue Smart Sheet and white printing paper after unpacking the photo printing paper pack.
- Open the top cover and insert the Smart Sheet and printing paper as shown in the figure.

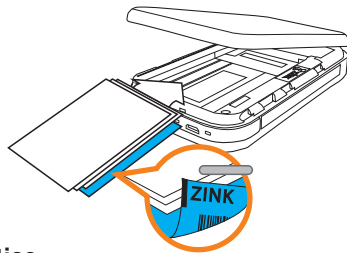

Notice

- Do not open the Cover while printing.
- Printing quality of output cannot be guaranteed in case of using Zink paper of other companies.

Operating Temperature

If the optimum operating temperature of (15~32°C) is not met when using this device, it may not print or lead to failure to provide the best print quality. (For stability of the product, refrain from using it at a low temperature in the winter.)

Table of Contents

1. Items confirmed before use	6
• Components check	
• Names of parts	
• Power on/off	
• Charging the battery	
2. Application installation	8
• Installation in Store	
• Installation with QR Code	
3. Cover Open method	10
4. Inserting printing paper	10
• Zink Smart Sheet	
5. Printing	12
• Android OS	
• iOS	
• Settings	
• Print Mode	
6. Checking LED indicators	20
7. Product specifications	21
8. Items to check before reporting a malfunction	22

1. Items confirmed before use

Components check

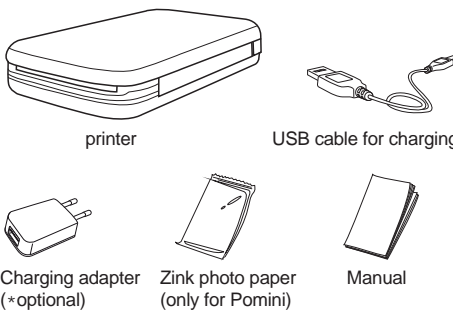

Names of parts

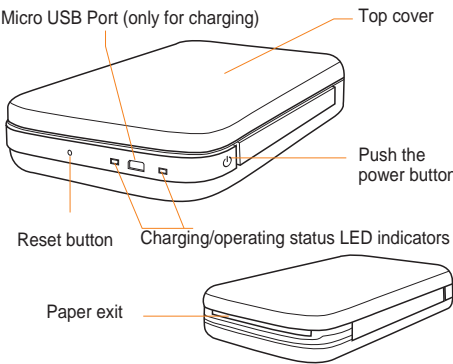

5. Printing

Android

1. Execute a dedicated App after turning on the power of the printer.
2. Select the desired photo from [Take a Picture / Photo Album] after selecting [Print] from the App’s main screen.



3. Select the Print button at the top right corner of the Edit screen.

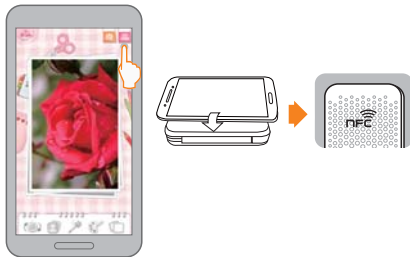

iOS

Search for “Pomini” in AppStore for installation.

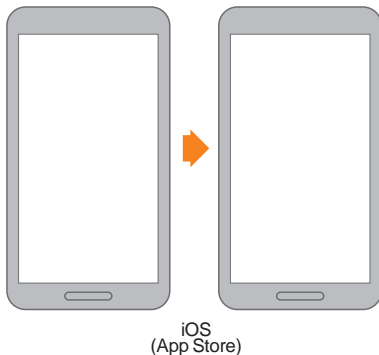

Installation with QR Code

Scan the QR Code in the product box and install the App.



Android™

iOS

2. Application installation

Android

Search for “Pomini” in Play Store for installation.



(※ Android phone that supports NFC function is connected to PlayStore Link when it comes in contact with the top cover.)

4. Begin searching for surrounding Pomini when selecting "Search for devices" after selecting "Yes" on the Bluetooth permission request window.  
(Permission request window doesn't come out when Bluetooth function is turned on.)

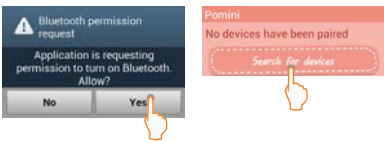

5. Select "Pomini(XX:XX)" from the Other Available Device list and select "OK" when "Bluetooth pairing request" pops up.  
(MAC Address can be checked in the label inside the device.)

• "Pairing request" window may not come out depending on the Phone type.

6. Upon completion of Pairing, it is added to the Paired Device list.  
(The process of NO. 4-6 is carried out one for the first time, but this process can be omitted in a Pairing state.)

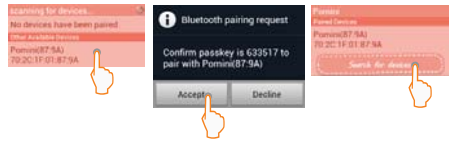

7. Tap the Print button at the bottom on the Print Preview screen.

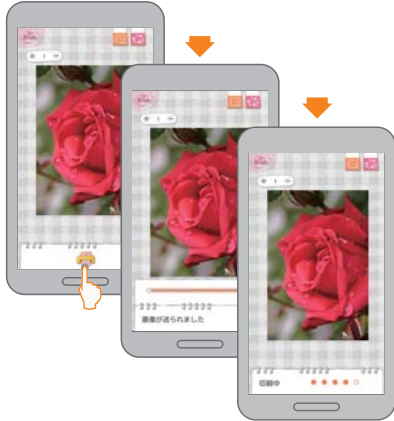

## iOS

1. Turn on the power of the device.
2. For Bluetooth connection, change the mode to "Turn on" [Bluetooth] from [Settings] of the device.
3. Connect "Pomini(XX:XX)" in the searched list.  
(MAC Address can be checked in the label inside the device.)

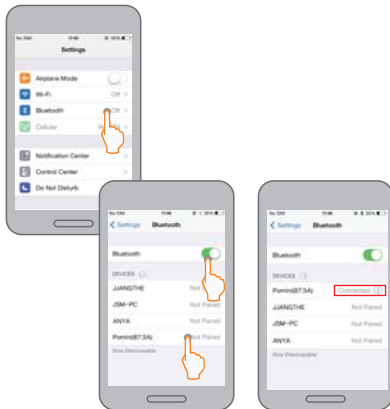

4. Execute a dedicated App.
5. Select the desired photo from [Take a picture / Photo Album].
6. Select the print image at the top right corner of the Edit screen.
7. Select the print image at the bottom of the Print Preview window.

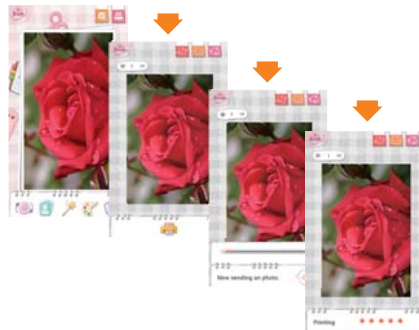

## Change in device settings Android & iOS (common)

1. Select [See More] in [Information] after selecting [Settings] at the top left corner of the main screen.



2. Set/check out each function on the Settings screen.



## Description of Settings Details

Function	Description
Auto Exposure	Automatic exposure settings
Print Mode	Print mode settings (Image Full, Paper Full)
Auto Power OFF	Auto power off setting (None, 3 minutes, 5 minutes, 10 minutes)
Device Status	Device status (Idle, Busy, Paper Empty, etc.)
Battery	Battery level
Number of page Printed	The total number of pages printed
MAC Address	Bluetooth MAC address
Update	Firmware and color correction data updates

## Print Mode

• Image Full  
As shown in the left side of the picture, the photo matches the printing paper so that the full image can appear in Image Full.

As the ratio of width to height (2:3) is greater, the white space is wider.



• Paper Full  
As shown in the left side of the picture, the photo matches the printing paper so that the image can be resized in Paper Full.

As the ratio of width to height (2:3) is greater, the original image is further severed.



## 6. Description of LED Status Indicators

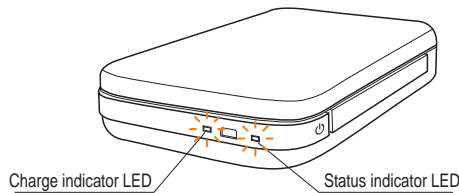

Charging status indicator	Operating status indicator	Current status	Details
		Off	Turn on the power to print.
		Standby/On	Wait for print command. Turn off automatically after the set time.
		Charging in progress	The battery is being charged.
		Charging in completed	The battery is fully charged.
		Operating/Flashing	Power off, image transmission, image processing, printing, cooling standby
		Error/Flashing	No paper, paper jam, cancel operation, cover open, low battery, image not supported, update failure, etc.

## 7. Product specifications

Type	Size
Paper size	50 x 76 (mm)
Type of supported image file/size	PNG(2550x3300)JPEG(baseline) Within a maximum of 10M Byte Progressive JPEG not supported
Paper used	ZINK Paper (for Pomini only)
Paper storage conditions	Temperature : 20 ~ 25°C Humidity : 40 ~ 55% RH
Product operating conditions	Temperature : 5 ~ 40°C Humidity : Less than 70% (35°C)
Optimal print conditions	Temperature : 15 ~ 32°C Humidity : Less than 70%(32°C)
LED display	Power on/Standby/Communication/Charge/Error/Print/Update
Communication	Bluetooth 4.0
External connection terminal	Micro USB port (charging only)
USB power supply	DC 5V / 1.0A adapter
Built-in battery	500mAh lithium polymer (rechargeable)
Power supply	Rated 5V 1.0A adapter
Proper image resolution	More than 1280 x 2448 pixel
Weight	186g
Support App version	Android : 4.0 or higher iOS : 5.1 or higher (Support may not be provided depending on the user's Smart phone version and environment.)

※ Product design and specifications are subject to change without notice.

## 8. Items to check before reporting a malfunction

Problems	Checklist
The power does not turn on.	Check to see if the battery is charged.
Bluetooth connection is not established.	Reboot the Bluetooth of the phone, or connect directly from the Settings menu. Try connecting in about 5 minutes after turning on the power to the device.
Printing paper seems to be jammed.	The paper is automatically ejected if you turn on the power after turning it off. Print it after printing out the Smart Sheet 2 to 3 times.
Stopped during printing operation.	The printing paper should be stored in an environment with low temperature/humidity. Do not fold or crumble the paper.
The power turns off automatically after a certain period of time.	Check the Auto Time Off value within "Settings" -> "see more" of the App.(None, 3 minutes, 5 minutes, 10 minutes) The operating status LED flickering Red indicates there is no power remaining on the battery. In this case, charge the battery with a dedicated adapter.
The printed photo shows a line. A slash mark appears in the middle of the photo.	Print it again after printing out the Smart Sheet 2 to 3 times. (A line may appear in case an impact is applied to the printer during the printing operation.)

Problems	Checklist
White LED flashes and printed paper does not come out.	This device requires the proper temperature of (15~32°C) to facilitate smooth printing operation. Thus, a greater warm-up time is required in temperatures that are lower than ideal, and cooling times are greater when the temperature is higher than ideal. Please wait a moment to reach the proper temperature.
Printed paper comes out too late.	The image quality is somewhat degraded when editing the image using Pomini App's Edit menu. Print it again after printing out the Smart Sheet 2 to 3 times. The Smart Sheet within the same pack with printing paper should be used.
The printed image quality differs greatly from the original image quality.	Check to see if the image has the proper resolution (1280x2448) or higher. The printed image quality cannot be guaranteed in case you use printing paper of other companies. Use the original printing paper.
The above methods do not resolve the problems.	Turn on the power after pressing the Reset Hole with a pointed object.

1718  
23/24

