

User Manual

Bluetooth Heart Rate Sensor

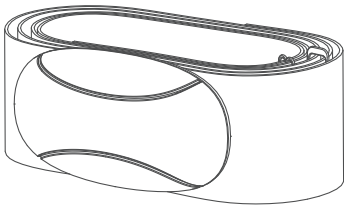

English Version NO: V2.3

Thank you for purchasing this Heart Rate Sensor. This device supports both Bluetooth, real-time monitoring heart rate, and data is transmitted wirelessly to your phone or sports watch. With MooFit App, records your every movement heart rate.

IMPORTANT: This product is for sport purposes only and it is not meant to replace any medical advice.

(Patients with cardiac pacing or other implantable devices should consult their doctors for recommendations)

Device Overview

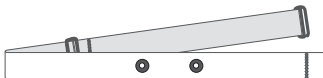

Chest Strap x1



Heart Rate Connector x1
(Installed CR2032)

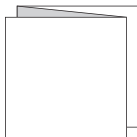

User Manual x1

How to use

Important note: When the heart rate Strap host is not worn, it will enter the shutdown sleep mode and cannot be searched for wireless connections. After the heart rate Strap host is worn correctly, it will automatically start to work.

- 1 Moisten the electrode areas of the chest strap;

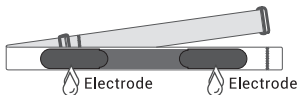

- 2 Attach the connector to the chest strap, marked 'L' towards left;

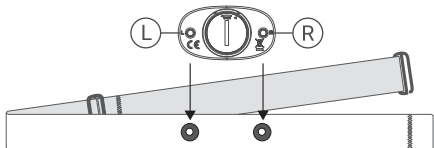

- 3 Adjust the strap length to fit tightly but comfortably. Check that the moist electrode areas are firmly against your skin.

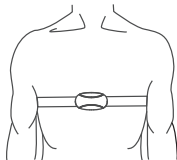

Compatible with most popular Apps

MooFit / Endomondo / Strava / Sports Tracker / Runtastic / Wahoo Fitness / Zwift
(If compatibility issues occur after the mobile phone system is updated or the App is updated, please contact customer service in time)

Caring for your device

This product is a high-tech electronic device. Following the maintenance instructions can ensure the stable performance of this product and prolong its service life.

Heart rate connector

Detach the connector from the strap after every use and dry the connector with a soft towel. Do not use cleaning chemicals.

Chest strap

Rinse the strap under running water after every use and hang to dry. Cleaning of strap in a washing machine or dryer is strongly prohibited.

- ★ Never use cleaning chemicals. (Cleaning chemicals may cause chest fast aging, shorten service life).
- ★ Do not stretch the strap or bend the electrode areas sharply.
- ★ Do not store the heart rate sensor wet in non-breathing material, to prevent snap oxidation. Dry and store the strap and the connector.

Batteries

This device uses the CR2032 battery, which has been installed in the heart rate connector. The battery life is 1200 hours.

Battery replacement

A. Use a coin to insert the battery door groove, turn the battery cover counter clockwise to open the battery door "▲" Turn to the left "▼" on the main chassis to open the battery door;

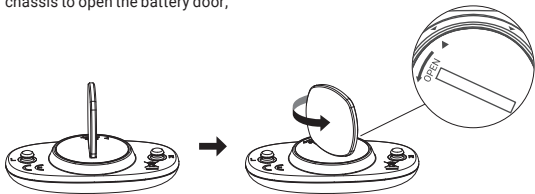

B. Prese the battery to take it out from the bettery cabin.

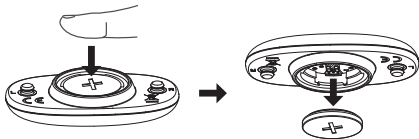

C. Insert the new battery with "+" side upwards.

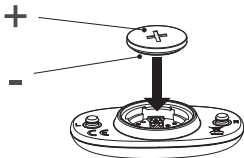

D. The battery door open aligns with the left side of the main machine case; "▼" close the battery door and use a coin to rotate the battery cover clockwise and align the open "▲" on the battery door with the "▼" on the right side of the main chassis to complete the battery replacement. Please dispose of the old batteries according to local regulations.

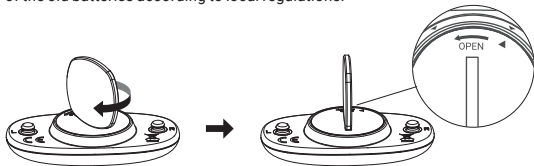

To avoid danger, keep the battery away from children

Heart Rate Sensor specifications

Weight	14.2 g	Battery Life	1200 Hours
Heart Rate Range	30~240 BPM	Water Proof	IP67
Wireless Transmission	Bluetooth	Size	60 X 34 X 12 mm
Transmission Distance	Bluetooth : 10 m	Strap Adjustable	L: 65~95 cm

All technology will be subject to actual.

Suitable model:



iOS 9.0 system version above, iPhone 4s or later.



Any Bluetooth 4.0 enabled Android device with Android 4.4 or later.

Disclaimer

- The product it describes are subject to change without prior notice, due to the manufacturer's continuous development program.
- Our company shall not be liable for any damages, losses, costs or expenses, direct, indirect or incidental, consequential or special, arising out of, or related to the use of this material or the products described herein.

NOTE: This equipment has been tested and found to comply with the limits for a Class B digital device, pursuant to part 15 of the FCC Rules. These limits are designed to provide reasonable protection against harmful interference in a residential installation. This equipment generates, uses and can radiate radio frequency energy and, if not installed and used in accordance with the instructions, may cause harmful interference to radio communications. However, there is no guarantee that interference will not occur in a particular installation. If this equipment does cause harmful interference to radio or television reception, which can be determined by turning the equipment off and on, the user is encouraged to try to correct the interference by one or more of the following measures:

- Reorient or relocate the receiving antenna.
- Increase the separation between the equipment and receiver.
- Connect the equipment into an outlet on a circuit different from that to which the receiver is connected.
- Consult the dealer or an experienced radio/TV technician for help.

Changes or modifications not expressly approved by the party responsible for compliance could void the user's authority to operate the equipment.

This device complies with Part 15 of the FCC Rules. Operation is subject to the following two conditions: (1) this device may not cause harmful interference, and (2) this device must accept any interference received, including interference that may cause undesired operation.