



EZIO BLE watch iPhone App User Guide

(Preliminary release – subject to change w/o prior notice)

Ref: Marketing sample

About BLE

Bluetooth low energy (BLE) is a feature of Bluetooth 4.0 wireless radio technology, aimed at new, principally low-power and low-latency, applications for wireless devices within a short range (up to approx.10 meters / 32 feet).

Features

- This app will allow the User to be alerted when there is an Incoming call or messages on the smart-phone through a flashing phone icon in the EZIO BLE watch.
- Bluetooth pairing of the iPhone and the EZIO BLE watch.

How to Pair the iPhone App and EZIO BLE watch

1. Go to Settings on your IOS phone and turn "ON" the Bluetooth as shown.



2. Open the EZIO App by tapping its icon on the Phone as shown. The EZIO main screen will appear.

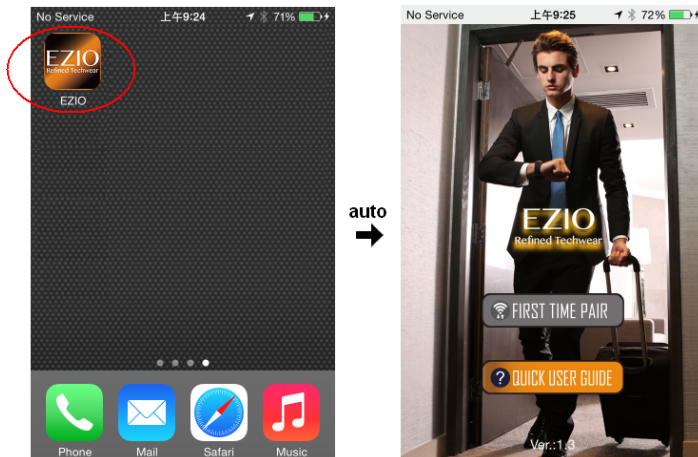

3. Press and hold the "Button" for 6 seconds to turn ON the EZIO watch until the phone and message icon of the dial will flash with a double beep sound. The watch is now sending pairing information to the Phone.



Note: Press and hold the "Button" for 3 seconds to turn OFF the EZIO watch. The phone and message icon will flash. You will also hear with a single beep sound.

4. Tap on the "FIRST TIME PAIR" on your Phone to start pairing

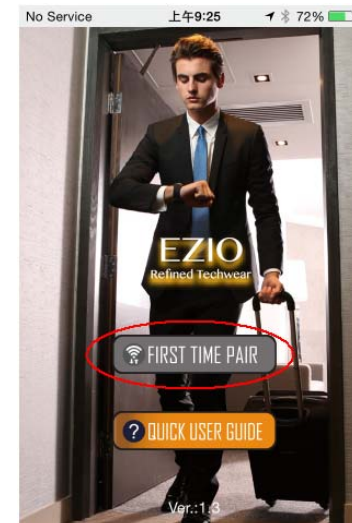



5. A Bluetooth pairing screen with “Start EZIO Techwear” screen will appear. Tap on the “**continue**” and the pairing process will begin.



6. Tap on the “**Pair**” and wait for few seconds.

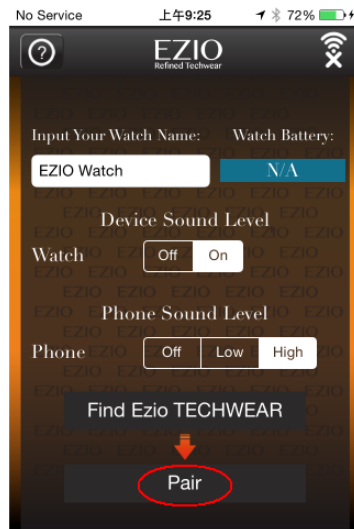

7. Tap “**Done**”.

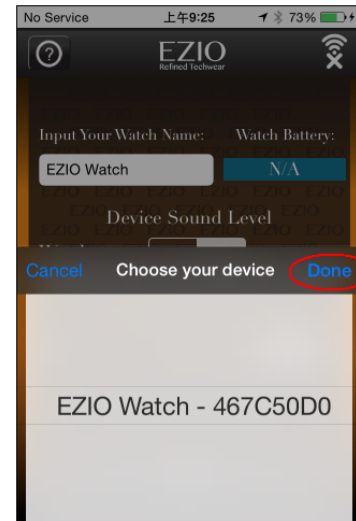

8. Tap “**Pair**”.

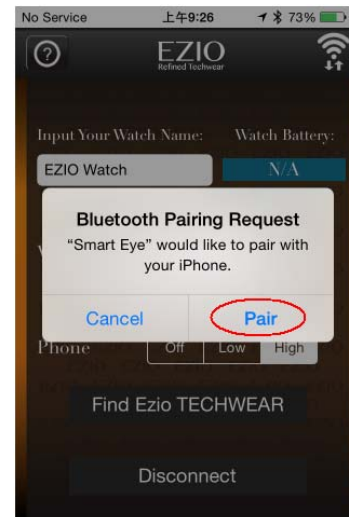



9. Tap “OK”.



- User may start dial the phone.

Notes:

- o The watch phone icon or message icon blinks when there is an incoming call or messages. You will also hear the watch with a beep sound.
- o Once pairing is successful, the watch will have a long beep sound.
- o If pairing is not successful, the phone will show “DEVICE NOT FOUND”.

How to verify if the watch is paired to smart phone

- You can verify if the watch is paired to the Phone by going into the Bluetooth setting of the iPhone. It should look like this screen (Smart Eye Connected).

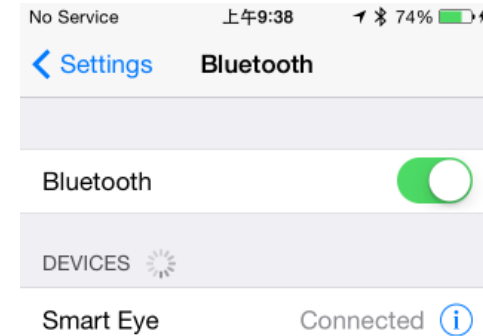

How it works

1. Make sure the **EZIO BLE watch** is paired with your iPhone.
2. When you have an incoming call in your iPhone. The Phone icon on the watch dial will blink until the call is answered.

Note: When the watch is out of range or Link loss, you will also hear a beep...beep sound.

How to Forget the Registry in the Phone Settings:

1. Press the Home button to go to Phone Settings.





2. Tap on the Settings icon in the phone.



3. Settings screen: Tap as shown.

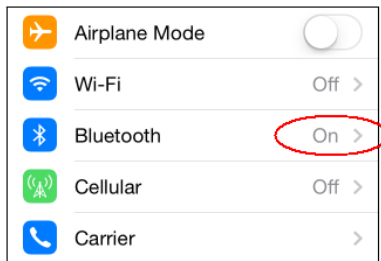

4. Settings Device screen: Tap as shown.

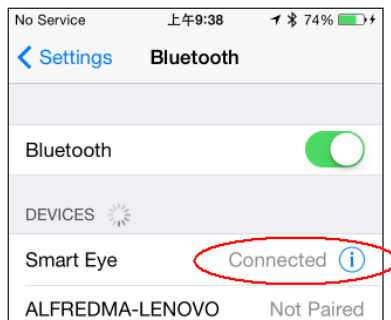

5. Forget Device screen: Tap on as shown.

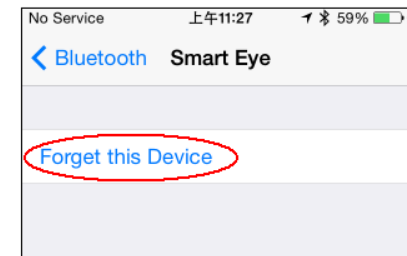

6. Forget Device screen: Tap to confirm.

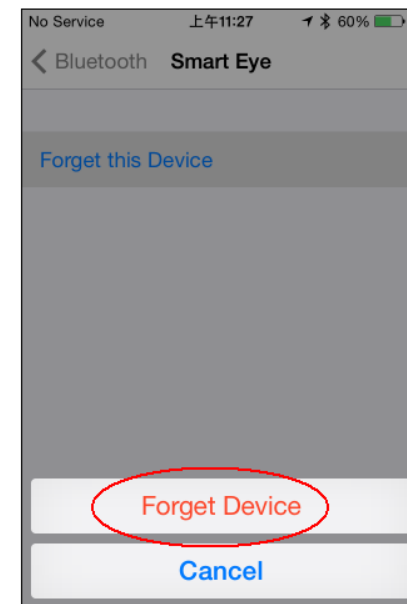

Note: You may press and hold button of the watch to stop the beep sound.

7. Tap to turn OFF the Bluetooth as shown.





8. Tap to turn back ON the Bluetooth as shown.



9. Press Home button to go back to Phone main screen.



Le présent appareil est conforme aux CNR d'Industrie Canada applicables aux appareils radio exempts de licence. L'exploitation est autorisée aux deux conditions suivantes : (1) l'appareil ne doit pas produire de brouillage, et (2) l'utilisateur de l'appareil doit accepter tout brouillage radioélectrique subi, même si le brouillage est susceptible d'en compromettre le fonctionnement.

Statement

This device complies with Industry Canada license-exempt RSS standard(s).

Operation is subject to the following two conditions:

- (1) This device may not cause interference and
- (2) This device must accept any interference including interference that may cause undesired operation of the device.

NOTE:

This equipment has been tested and found to comply with the limits for a Class B digital device, pursuant to Part 15 of the FCC Rules. These limits are designed to provide reasonable protection against harmful interference in a residential installation.

This equipment generates uses and can radiate radio frequency energy and, if not installed and used in accordance with the instructions, may cause harmful interference to radio communications. However, there is no guarantee that interference will not occur in a particular installation. If this equipment does cause harmful interference to radio or television reception, which can be determined by turning the equipment off and on, the user is encouraged to try to correct the interference by one or more of the following measures: Reorient or relocate the receiving antenna. Increase the separation between the equipment and receiver. Connect the equipment into an outlet on a circuit different from that to which the receiver is connected. Consult the dealer or an experienced radio/TV technician for help.

Compliance statement

1. This device complies with Part 15 of the FCC Rules. Operation is subject to the following two conditions:
 - (1) This device may not cause harmful interference.
 - (2) This device must accept any interference received, including interference that may cause undesired operation.
2. Changes or modifications not expressly approved by the party responsible for compliance could void the user's authority to operate the equipment.

Warning

Sound pressure:

- Battery Caution: Risk of explosion if battery is replaced by an incorrect type. Dispose of used batteries according to the instructions.
- The product shall only be connected to a USB interface of version USB 2.0
- Temperature: 35 °C

Hereby, **Faze In Limited**, declares that this **Bluetooth device** is in compliance with the essential requirements and other relevant provisions of Directive 1999/5/EC.