



Airpul LLC

Phone:1.603.766.1940 Fax:1.603.766.0401

Add: 8 Millstream Drive, Exeter, NH 03833

E-mail:sales@airpul.com

Web:www.airpul.com

Precautions for Use

Before using this product, it is important that you read this user manual to get important information and instructions regarding the transmitter and receiver.



Thank you for purchasing this quality product. Any defects in components or faulty workmanship occurring within one year will be rectified or repaired free of charge, but this warranty does not apply to the following cases:

Abuse, improper use: negligence, accident, modification, failure of the end-user to follow the operating procedures outlined in the user's manual, attempted repair by non-qualified personnel; operation of the product outside of the published environmental and electrical parameters, or if such product's original identification (trademark, serial number) markings have been defaced, altered, or removed.



Precautions for Use	02
Safety Warning	03
Declaration of Conformity	04
Special Notes	05
Cleaning	06
Product Overview	07
Product Specifications	07
Product Features	07
Hardware Introduction	08
Keypad & OLED Display Introduction	11
Indicator Lights	12
Product Specification	13
Assembly Instructions	14
Antenna Installation	14
Power Adaptor	14
Installation Instructions	15
AC6151Transmitter Installation	15
AC6182Receiver Installation	16
AC8262Receiver Installation	17
Pairing Instructions	19
Pairing the AC6151 transmitter to the AC6182 receiver	19
Pairing the AC6151 transmitter to the AC8262 receiver	20
Troubleshooting	22
FCC ID Warning	25

Safety Precautions

	WARNING! RISK OF ELECTRICAL SHOCK DO NOT OPEN	
WARNING! TO REDUCE THE RISK OF ELECTRICAL SHOCK. DO NOT REMOVE THE COVER. NO USER-SERVICEABLE PARTS ARE INSIDE. REFER SERVICING TO QUALIFIED PERSONNEL.		



Danger: Electricity Hazard

- Power must be switched off when not in use, and power to all connected devices should be disconnected.
- Power outlet: to prevent electrical shock, please check that the AC power cord used on the receiver and transmitter corresponded to the power outlet.
- AC Power Cord: stepping on or placing heavy items on the power cord is prohibited.
- Power overloading: do not overload the power outlets, otherwise electric shock or fire could happen. If the power is overly loaded, please extend the power cord.
- Lightning stroke: disconnect the power adaptor when the product is not used for a long period of time, or during a lightning storm.
- Switch off the power when product is not in use to prevent electric shock or fire.



WARNING

- Keep the product away from objects with liquids. Splashing or dripping on this product is strictly prohibited.
- Operate the product in a well-ventilated space.
- Do not expose the product to rain or moisture.

Declaration of Conformity

This product complies with Part 15E of FCC Rules.

Part 15: Subpart E---Unlicensed National Information Infrastructure Devices.

This device complies with relative criteria of CE Certification.

EN 60950-1:2006

Information Technology
Equipment --- Safety---
Part 1: General Requirements

EN 300440-01 (V1. 6. 1)

Electromagnetic Compatibility and Radio Spectrum Matters (ERM)
Short Range Devices.
Radio equipment to be used in the 1GHz TO 40 GHz frequency range.
Part 1: Technical Characteristics and Test Methods

EN 301489-03 (V1. 4. 1)

Electromagnetic Compatibility and Radio Spectrum Matters (ERM)
Part 3: Specific conditions for Short-Range Device(SRD)
Operating on frequency between 9 kHz and 40 GHz

EN 301489-17 (V2. 1. 1)

Electromagnetic Compatibility (EMC)
Standard for Radio Equipment and Services;
Part 17: Specific conditions for Broadband Data Transmission Systems

EN 301893 (V1. 5. 1)

Broadband Radio Access Network (BRAN)
5 GHz high performance RLAN
Harmonized EN covering the essential requirements of article 3.2 of
the R&TTE Directive

- This product has been manufactured and tested to comply with each country's safety regulations. However, it doesn't guarantee that interference would never happen in some specific environment. If interference does occur, please shorten the distance between the transmitter and receiver.
- This product may experience interference from other wireless devices operating within the 5GHz frequency range, such as a LAN router or wireless telephone. If you have an 802.11n LAN router, configure it for use in the 2.4GHz range rather than 5GHz.

Special Notes

Do not use this product near aircraft or medical facilities to prevent interference. Please handle this device carefully, otherwise radio frequencies may cause abnormal video and audio (noise blocked image...etc,)

Keep it away from refrigerator, washing machine or other metal furniture.

Do not place it in a dusty, humid environment, and also do not place it where the temperature is beyond the stated operational temperature range.

It is better to use our standard power adapter to avoid possible damage to the product. Do not cover it or place other heavy objects on top of the unit that may block the thermo vent. Good air circulation around the product is needed.

To save electricity consumption, turn off the power switch or unplug the power adapter from the power outlet when the units are not in use.

If the product does not work properly, please restart it; If it still does not work properly, turn off the power, and send it to professional technical personnel for repair or disposal. Please do not open and repair it by yourself.

Cleaning

Unplug the power adaptor before performing any cleaning. To clean the device, wipe with a soft and dry cloth or with a cloth moistened with alcohol.

To avoid the risk of electrical shock, do not dismount the device when connected to a power outlet.

Maintenance should be conducted only by an authorized technician.

Dripping or splashing of liquids onto the device is strictly prohibited.

Keep the device away from fire or any source of heat.

Don't let kids play with this device.

Product Overview

Product specifications

The AC6151 wirelessly transmits high definition audio and video data presented to its HDMI port. The AC6151 can be conveniently mounted to most camcorders via 1/4" x 20 tapped attachment screw hole. The supplied accessory shoe adapter can be attached to the unit utilizing this mounting point, allowing the AC6151 to be easily and sturdily fixed to a camera's accessory shoe.

Product Features

- Supports 1080P HD video transmission
- Supports HDMI 1.3 and HDCP1.2 encryption techniques
- Operating Frequency: 5.15GHz~5.25GHz and 5.725GHz~5.825GHz
- Small size transmitter with long transmission range
- Built-in 3000mAh high performance polymer Li-ion battery
- External omnidirectional antenna
- 1/4" x 20 mounting point makes it easily attachable to video cameras.
- This product works only indoor

Hardware Introduction

Transmitter AC6151

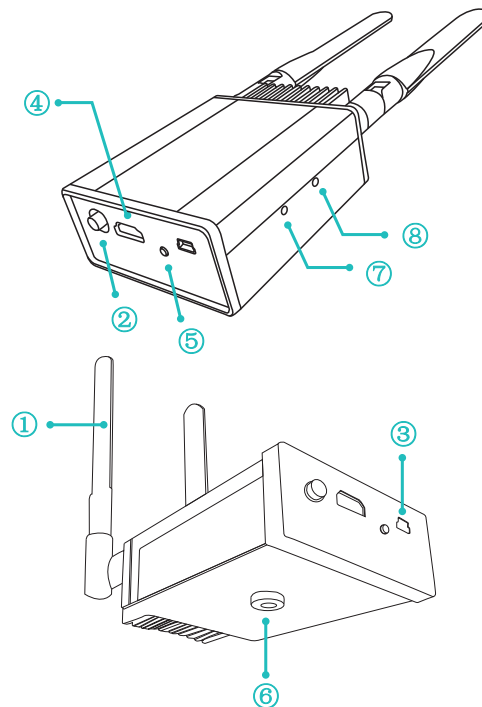

NO.	Name	Description
①	Transmitter Antenna	Transmitter Antenna
②	Power Switch	Power Switch
③	Mini USB Port	Used to connect supplied power adapter to operate unit, charge internal battery, and load firmware upgrades.
④	HDMI Port	Input audio and video signal via HDMI cable
⑤	Pair Button	Used to pair Transmitter with Receiver
⑥	1/4" x 20 attachment screw hole	Used to mount transmitter onto camera
⑦	Battery status indicator lamp	Show current battery status
⑧	System Indicator Lamp	Indicate Power on/off status

Receiver AC6182

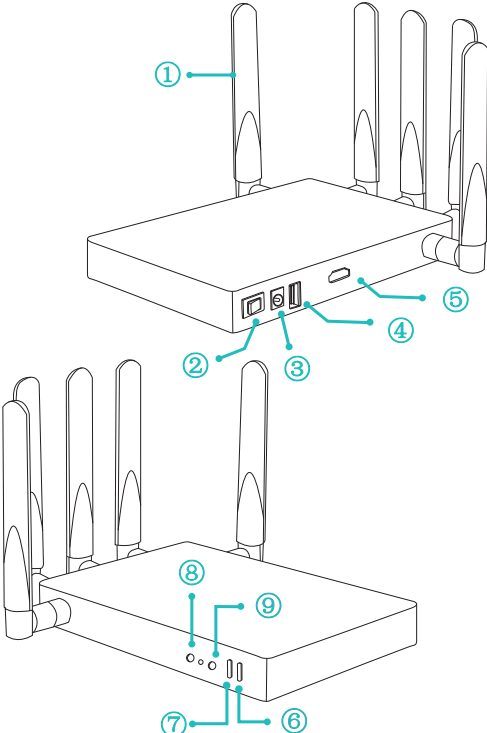

NO.	Name	Description
①	Receiver Antenna	Receiver Antennas
②	Power Switch	On/off button
③	PowerPort	For connection to included power adaptor
④	USB Port	For firmware upgrades
⑤	HDMI Port	Outputs HDMI A/V signals
⑥	Operating Frequency Selection Button	Operating frequency selection button
⑦	Pair Button	Used to pair Transmitter with Receiver
⑧	System Indicator Lamp	System Indicator Lamp
⑨	PowerIndicator Light	Power indicator light

Receiver AC8262

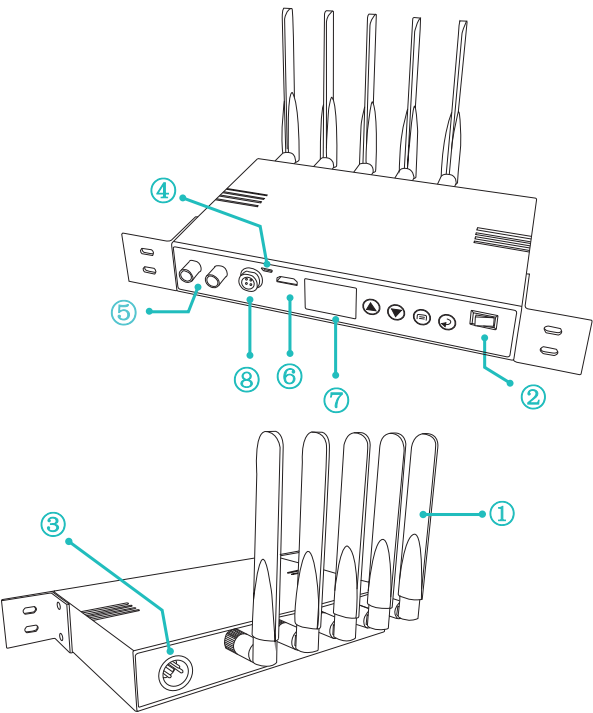

NO.	Name	Description
①	Receiver Antenna	Receiver Antennas
②	Power Switch	On/off button
③	PowerPort	For connection to included power adaptor
④	USB Port	For firmware upgrades
⑤	SDI BNCConnector	Outputs SDI A/V signal
⑥	HDMI Port	Outputs HDMI A/V signals
⑦	Display Screen	Shows current status and setup options
⑧	TALLY	Connect to TALLY connector of Video Switcher

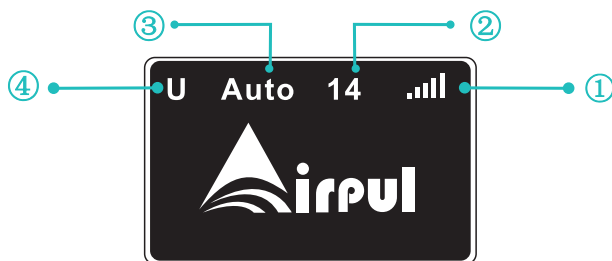

NO.	Name	Description
①	Signal Intensity	Shows the signal intensity of the receiver. When the connection between the transmitter and receiver fails, this turns into this image
②	Output capacity	Shows the output capacity of transmitter, unit = dBm
③	Operating frequency	Operating frequency
④	Connecting mode	Connecting mode

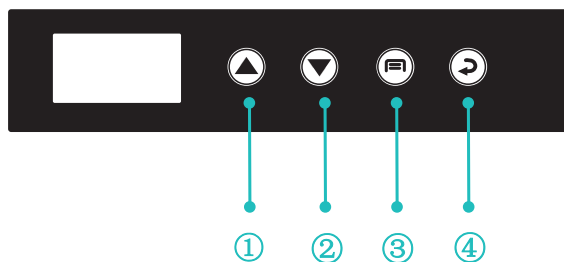

NO.	Name	Description
①	Up Key	Control function menu of display screen
②	Down Key	Control function menu of display screen
③	"Enter" Key	Enter function menu and confirmation
④	Return Key	Controls display screen function menu, return to previous interface, or cancel modification.

AC6151 Indicator Lights

System Status Lamp

- ☐ No connection
- ☒ Successful connection
- ☐ Connection attempt failed

Electricity Quantity Indicator Lamp

- ☐ Normal Battery Electricity Quantity
- ☒ The unit is charging
- ☐ Power at critical low level, connect to power supply immediately

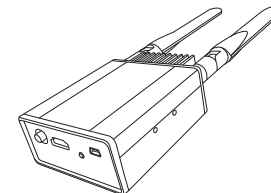

AC6182 Indicator Lights

Power Indicator Light

- ☐ Power off
- ☒ Power on

System Status Light

- ☐ No connection to transmitter
- ☒ Good Connection

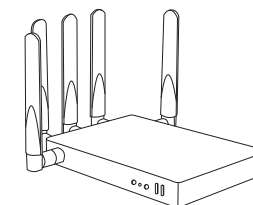

Product Specification

	Transmitter	Receiver	Receiver
Model	AC6151	AC6182	AC8262
Dimension	4.27 x 3.11 x 1.30 in	6.81*4.96*0.90 in	8.27*5.51*1.18 in
Working Environment	Indoor		
Working Temperature	14°F - 122°F		
Relative Humidity	10%-85%		
Working Frequency	5.15GHz~5.25GHz and 5.725GHz~5.825GHz		
Antennas	External Antenna x 2; can be positioned at 90 degrees	External Antenna x 5; can be positioned at 90 degrees	External Antenna x 5; can be positioned at 90 degrees
Power Supply	Mini USB Power supply 5VDC, 2.5ABuilt-in 3.7V, 3000mAh battery	DC12V2.5A	DC12V2.5A
Indicator Light	Power Indicator Light; System Status Light	Power Indicator Light; System Status Light	NO
Supported Video Resolutions	1080p/60Hz, 1080p/50Hz, 1080p/30Hz, 1080p/25Hz, 1080p/24Hz, 1080i/60Hz, 1080i/50Hz, 720p/60Hz, 720p/50Hz, 576p/60Hz, 576p/50Hz, 576i/50Hz, 480p/60Hz, 480p/50Hz, 480i/60Hz		
Supported Audio Formats	5.1 DTS, 5.1 Dolby, 5.1 PCM 7.1 DTS, 7.1 Dolby, 7.1 PCM 16/20/24bit, 48KHz Sampling rate audio formats		

Assembly Instructions

Antenna Installation

When using for the first time, the included antennas must be installed onto the unit as per the instructions below.

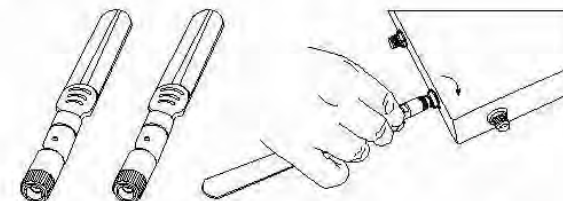

Power Adaptor

The included power adaptor is supplied with interchangeable heads so that it can be used with the appropriate American , European , UK and Australian standard power outlets .

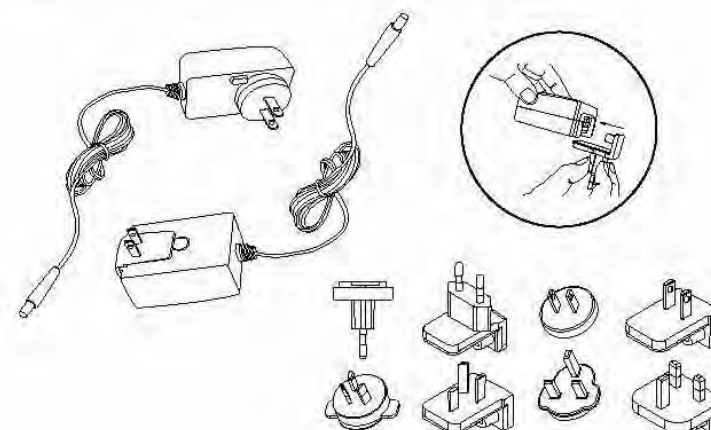

Installation Instructions

AC 6151 Transmitter Installation

Step 1: Attach the included Accessory Shoe Adaptor to the ¼" x 20 threaded screw hole on the bottom of the unit

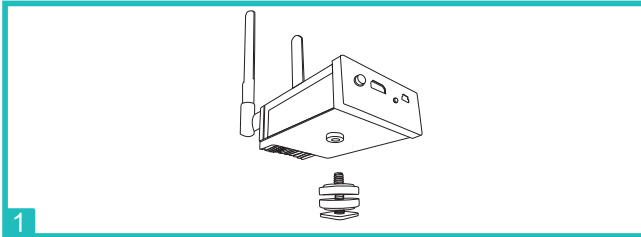

Step 2: Mount the accessory shoe adaptor to the camera's accessory shoe.

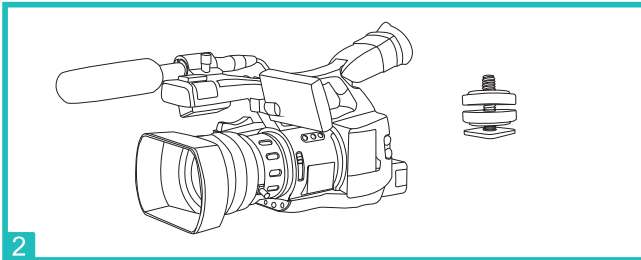

Step 3: After ensuring the unit's battery is fully charged, connect the camera's HDMI output to the transmitter's HDMI input using a standard HDMI cable.

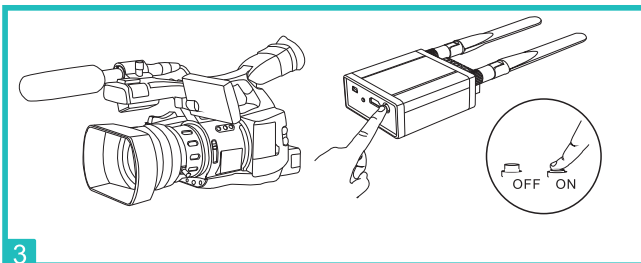

Step 4: When the battery runs low, you can connect the transmitter to the included power adaptor using the Mini USB cable. The battery will be charged while simultaneously powering the unit.

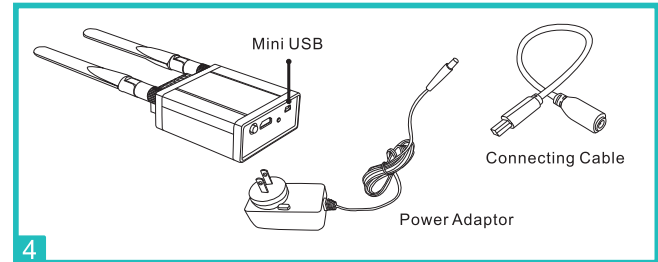

AC 6182 Receiver Installation

Step 1: Connect the Receiver to a Monitor using an HDMI cable

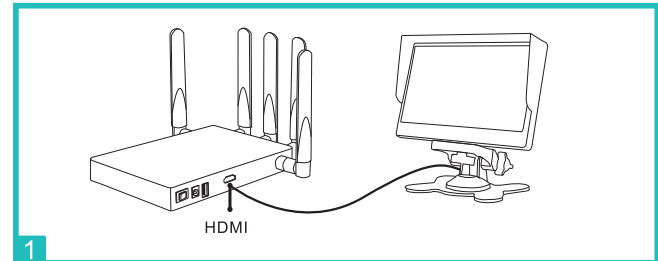

Step 2: Connect the Power Adaptor to the Receiver

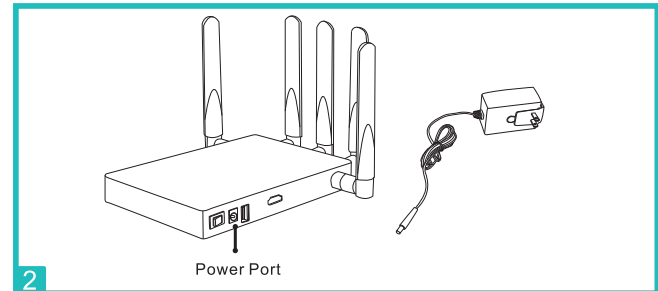

Step 3: After ensuring that the camera and monitor are operational, turn on the Receiver's power, at which point the system will connect automatically.

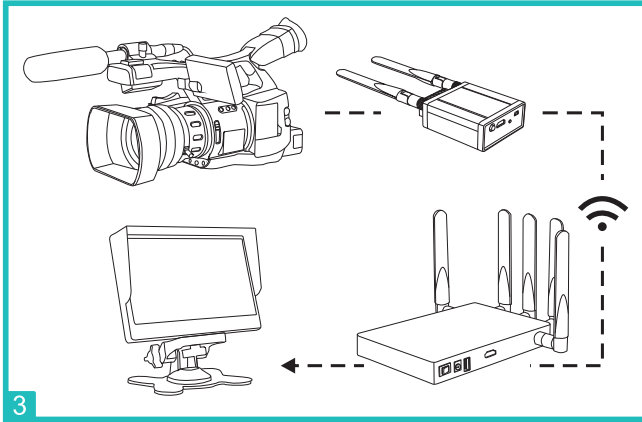

Step 2: Connect the Power Adaptor to the Receiver

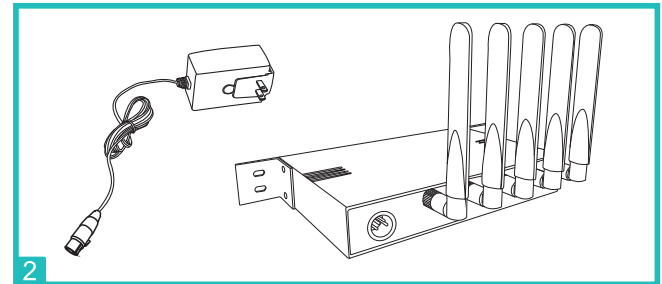

Step 3: Turn on the power

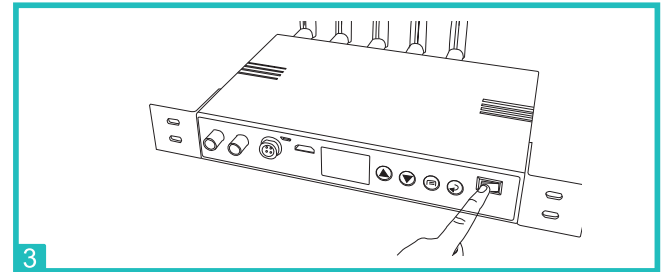

Step 4: After ensuring that the camera and monitor are operational, the system will connect automatically.

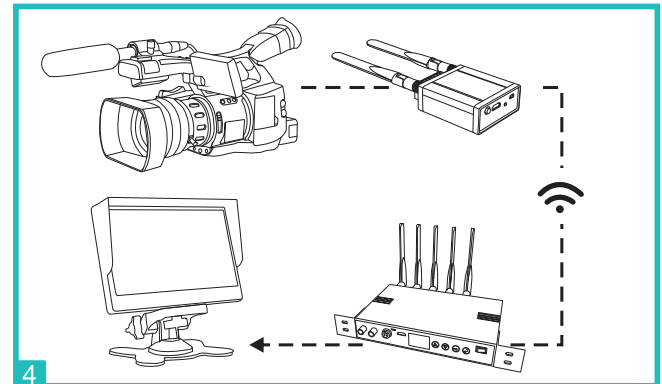

AC8262 Receiver Installation

Step 1: Connect the Receiver to a Monitor using an HDMI or SDI cable

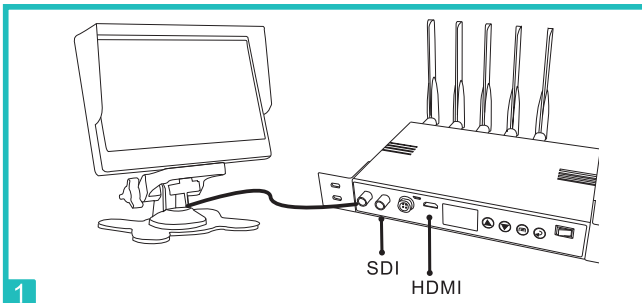

Pairing Instructions

The units are paired (TX to RX) at the factory prior to shipping. If the connection fails during usage, please try to pair the transmitter with the receiver again as per below instructions.

Pairing the AC6151 transmitter to the AC6182 receiver

Step1: Press the Pair button of the receiver, the connected monitor will show the following:

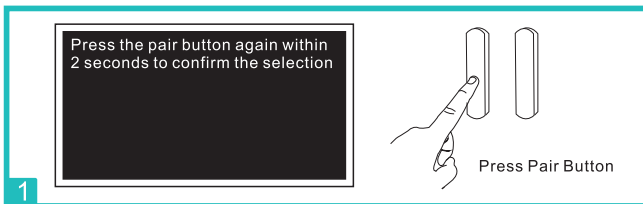

Step 2: Press the pair button again, the connected monitor screen will show the following:

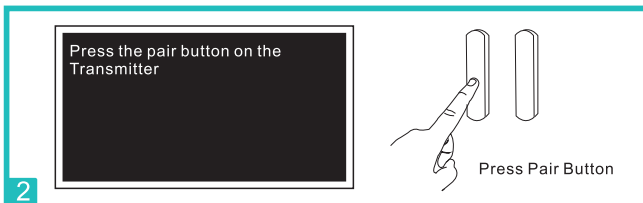

Step3: Press the Pair button on the transmitter

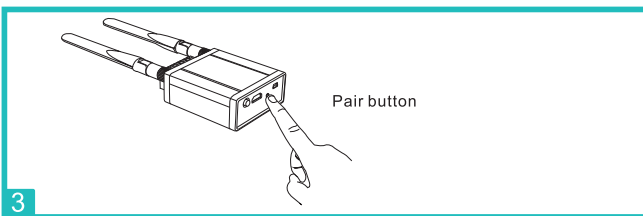

Step 4: When the monitor connected to the AC6182 receiver shows the below message on the screen, wait for a moment. When it plays the audio and video as that of the camera connected to the transmitter, the pair progress is finished.

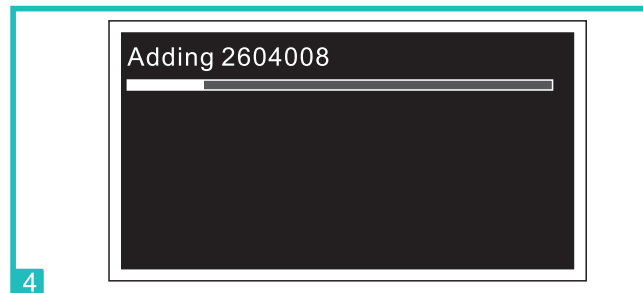

Pairing the AC6151 transmitter to the AC8262 receiver

Step 1: Press the "⏏" button of the AC8262 receiver, select the "make a pair" menu, and press the "⏏" button two more times.

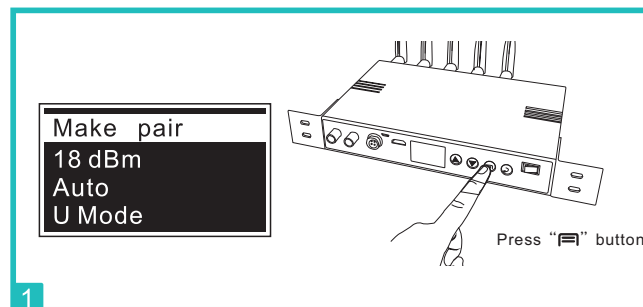

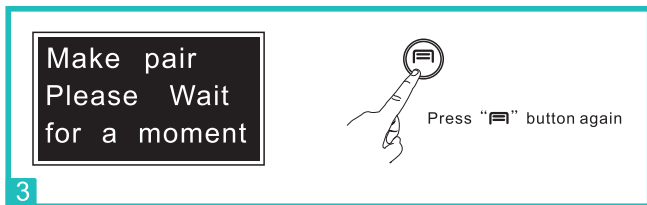
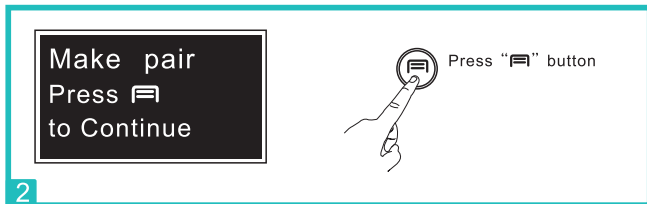

Step 2: Press the Pair button of the transmitter, The transmitter and receiver will begin to pair

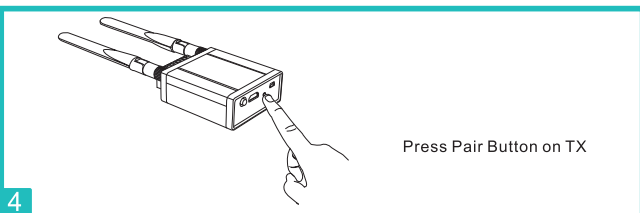

Step 3: The OLED display screen of the AC8262 receiver will show the message below. After a moment, when it shows "Pairing complete", pairing is complete.

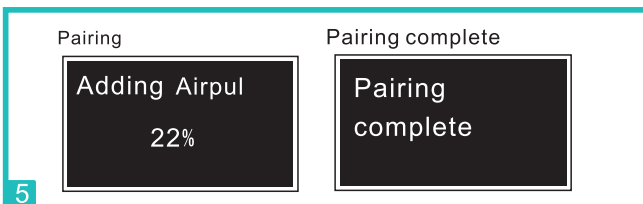

Troubleshooting

Please make sure all the devices are properly connected and the power is switched on before you follow the troubleshooting guide below.

Q1: Power indicator light off (AC6182).

- A1:**
- Please check that the power adaptor of the AC6182 is supplying power, and it is correctly connected.
 - Please check if the power adaptor is turned on.

Q2: OLED screen of AC 8262 is off.

- A2:**
- Please check that the power adaptor of the AC8262 is supplying power, and it is correctly connected.
 - Please check if the power adaptor is turned on.

Q3: Connection failure

- A3:**
- Please ensure the transmitter and receiver are powered on by checking that the system indicator light of the AC6151 and the power indicator light of the AC6182 are on.
 - Please ensure that the external antennas are mounted correctly.
 - Check if there are any obstructions between the transmitter and receiver, if so, please move the units to an open area and reconnect them.
 - Check if the operating frequency of the receiver is in AUTO-Frequency mode, if it is not, please set it to this mode.
 - Check if the output level of the AC8262 is too small or the distance between the transmitter and receiver is too far away. Please try to increase the output power level, or shorten the distance between the transmitter and receiver.
 - Check if the current connection mode is U Mode (AC8262). If it is not in this mode, please set it to U mode.
 - Please pair the transmitter with the receiver again.

Q4: The display device that is connected to the receiver has no video or audio.

- A4:**
- Please ensure that the external antennas are correctly installed.
 - Please try to shorten the distance between the receiver and the transmitter.
 - Check if there is an obstacle between the transmitter and the receiver. If so, please move the units to an open area and re-connect them.
 - If they connect normally, but there is no video and audio present at the receiver's connected monitor, please check if the wires and joints of the transmitter and the receiver are correctly connected with the device.
 - If connected correctly, and the wires are of good quality, please check that the camera outputs video and audio correctly.

Q5: Bad Picture(Bad Video)

- A5:**
- Check if the video's origin (i.e camera) outputs video and audio normally.
 - Please check that the external antennas are correctly mounted on.
 - Please check that the wires and connections of the transmitter and the receiver are suitably connected to the source device (camera).
 - Please try to shorten the distance between the receiver and the transmitter.
 - Check if there are any physical obstacles between the transmitter and the receiver. If so, please move the units to an open area and re-connect them.
 - If there is RF (radio frequency) interference present, this problem will also occur. Please turn off the device causing interference, or relocate it to another place.

Q6: Pairing failure

- A6:**
- Please check that the external antennas are correctly mounted.
 - Check for physical obstacles between the transmitter and the receiver. If it is, please move the units to an open area and re-connect them.
 - Please check that the connecting mode of the AC8262 is in U mode. When it is in B Mode, pairing is impossible.
 - Please check that the operating frequency of the receiver is in Auto-Frequency mode. If it is not, please set it to this mode.
 - Please ensure that the transmitter is not too far away from the receiver. If it is, please shorten the distance between the transmitter and receiver.

FCC ID Warning

This device complies with Part 15 of the FCC Rules. Operation is subject to the following two conditions:

- This device may not cause harmful interference
- this device must accept any interference received, including interference that may cause undesired operation.

The user manual or instruction manual for an intentional or unintentional radiator shall caution the user that changes or modifications not expressly approved by the party responsible for compliance could void the user's authority to operate the equipment. In cases where the manual is provided only in a form other than paper, such as on a computer disk or over the Internet, the information required by this section may be included in the manual in that alternative form, provided the user can reasonably be expected to have the capability to access information in that form.

For a Class B digital device or peripheral, the instructions furnished to the user shall include the following or similar statement, placed in a prominent location in the text of the manual:

For a Class B digital device or peripheral, the instructions furnished to the user shall include the following or similar statement, placed in a prominent location in the text of the manual:

FCC Caution: Any changes or modifications not expressly approved by the party Responsible for compliance could void the user's authority to operate this equipment.

RF exposure warning

This equipment must be installed and operated in accordance with provide instructions and the antenna used for this transmitter must be installed to provide a separation distance of at least 20 cm from all persons and must not be co-located or operation in conjunction with any other antenna or transmitter. End-users and installers must be provide with antenna installation instructions and transmitter operating

Conditions for satisfying RF exposure compliance

NOTE: This equipment has been tested and found to comply with the limits for a Class B digital device, pursuant to Part 15 of the FCC Rules. These limits are designed to provide reasonable protection against harmful interference in a residential installation. This equipment generates, uses, and can radiate radio frequency energy and, if not installed and used in accordance with the instructions, may cause harmful interference to radio communications. However, there is no guarantee that interference will not occur in a particular installation. If this equipment does cause harmful interference to radio or television reception, which can be determined by turning the equipment off and on, the user is encouraged to try to correct the interference by one or more of the following measures:

- Reorient or relocate the receiving antennas.
- Increase the separation distance between the equipment and receiver.
- Connect the equipment into an outlet on a circuit different from that to which the receiver is connected.
- Consult the dealer or an experienced radio/TV technician for help.