

Model:BLE001/FCC ID:2AC2HBLE001



Control Your Colours

APP Controlled Smart Lighting



1 Get the App

Download "Tikteck LED Light" from the App Store or Google play.



Tikteck LED Light



App Store



Google play

3 Control

Choose any color from the palette to change your bulbs color, and adjust brightness and color temperature below the palette. Slide left to enter into device management (#5), and click the setting icon in the top right corner to access the settings menu.

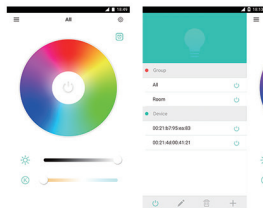

4 Timer

Timer setting can be saved to a specific bulb, which will work with multiple bulbs even if bluetooth is not connected. Please do not cut the power off.

5 Device Management

You can add, rename, or group bulbs in this interface.

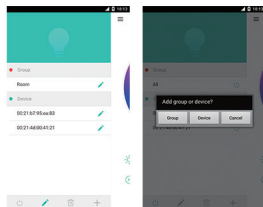

2 Connect Bulb

Screw in your Tikteck bulb and turn it on. Open the "Tikteck LED light" app on your smart device and turn on bluetooth if prompted, then select "add device" to connect.

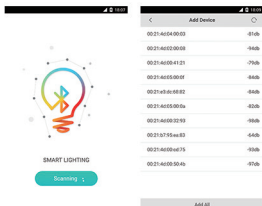

NOTE: This equipment has been tested and found to comply with the limits for a Class B digital device, pursuant to part 15 of the FCC Rules. These limits are designed to provide reasonable protection against harmful interference in a residential installation. This equipment generates, uses and can radiate radio frequency energy and, if not installed and used in accordance with the instructions, may cause harmful interference to radio communications. However, there is no guarantee that interference will not occur in a particular installation. If this equipment does cause harmful interference to radio or television reception, which can be determined by turning the equipment off and on, the user is encouraged to try to correct the interference by one or more of the following measures:

- Reorient or relocate the receiving antenna.
- Increase the separation between the equipment and receiver.
- Connect the equipment into an outlet on a circuit different from that to which the receiver is connected.
- Consult the dealer or an experienced radio/TV technician for help.

This device complies with part 15 of the FCC rules. Operation is subject to the following two conditions:

- (1) this device may not cause harmful interference, and
- (2) this device must accept any interference received, including interference that may cause undesired operation.

Changes or modifications to this unit not expressly approved by the party responsible for compliance could void the user's authority to operate the equipment.