



Smart LED Shoe Tracker - BT018
QUICK START GUIDE



MyWay Fit

Compatibility:
Required iOS 6 or aboveCompatibility:
Required Android 4.3
or above + Bluetooth 4.0

1 Features



BLE 4.0



Steps



Calories



Avg. speed



LED flashlight



Target



Distance



Activity time

※ Please full charging while using on the first time.

2 Operations

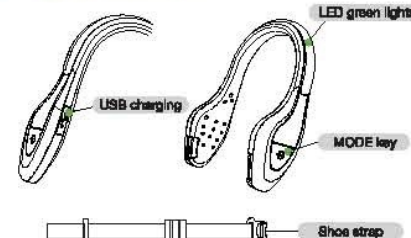

3 Bluetooth Connection Mode

- The shoe tracker will not be functioned until synchronized by smartphones. If it is the first time to use, it needs to activate the device, follow the below procedures.

1). Download and install [MyWay Fit], open the APP.



- 2). To check whether the smart phone Bluetooth status is on.
- 3). Press and hold the button for 3s to turn on the Bluetooth connecting (LED light beside the button will be flashing).
- 4). In Home page, select "Trip" icon.
- 5). Press "Settings" page. Then, Settings > Connection > Trip tracker.
- 6). If smartphone have found the device, it will show on the smartphone (named : BT018-0), connect the device with the smartphones.
- 7). If pair is successful, it will show status as "Connected" on the APP.

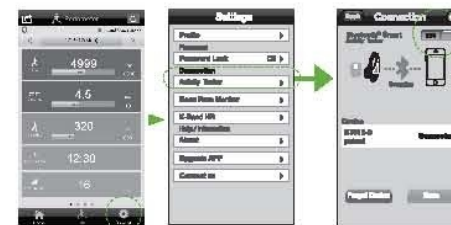

4 Data Synchronization

-To synchronize the data, it must to be connected between device and smartphone.

- 1). Make sure turn on the Bluetooth on the smartphone.
- 2). Make sure the device has been connected to the smartphone.
- 3). After connected, the refresh icon in the top right corner will change from gray to red. Tap the refresh icon to synchronize the data between the device and APP.



FCC ID :
2ABZ6-BT018



5 LED Lighting Mode

- 1). Light keep turning on after press the button by once;
- 2). Light keep flashing when running;
- 3). Flash light will be shut down after 10 mins resting; turning on the light manually to restart.
- 4). Light will be off after press the button by once again.



Light keep flashing
when running.



Auto power off after
10 mins not moving.

- 5). Press and hold for 3s to enter the bluetooth connection status:

Connecting: LED light beside the button will be flashing.

Connection failure: LED light beside the button will be off.

Connection: Switching to "lighting model" (LED lights for both sides will turn on), the LED light can be switched off manually.

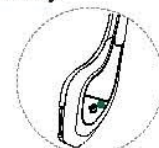

Press and hold for 3s
to enter the bluetooth
connection status

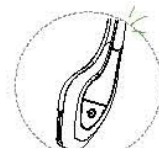

LED lights beside the
button will be flashing

- 6). Low battery reminder: two LED lights flash alternately;

- 7). Charging tip: Light keep turning on when charging; light off when charging is finished.

6 Low Battery Indicator & Charging

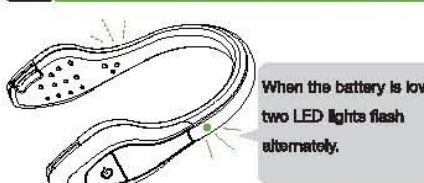

When the battery is low,
two LED lights flash
alternately.



APP reminder

USB charger

7 How to Wear

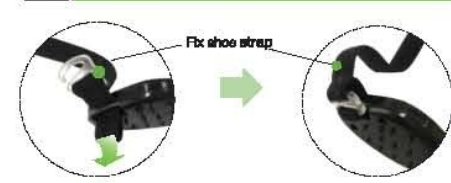

1 Tie the fixed strap to one side of the shoe tracker.

2 Put the shoe tracker on the shoe with the fixed strap.

Adjustable buckle

3 Buckle up the fixed strap and finish.

Fit for shoes of 60 - 85 mm wide

8 Specifications

BLE 4.0
Waterproof IPX4
Input voltage: 5V@500mA Input by USB micro port
Bluetooth connect: <10m

Battery capacity: 60mAh
Charging time: 1.5h-2.0h

Device Daily Range:

Step: 0-350,000 steps
Step Distance: 0-600km or 0-603miles
Travel Time: 00:00 - 24:00 (hr:mm)
Calories: 0-60000 kcal
Age: 6-99
Weight: 30-136kg (66lb-300 lb)
Height: 100cm-200cm (39 inches-79 inches)
Stride length: 30cm-150cm (12 inches - 59 inches)

APP Total Range:

Step: 0-99,999,999 steps
Step Distance: 0-300,000km or 0-181,181 miles
Travel time: 0-100,000 (hr:mm)
Calories: 0-99,999,999 kcal

FCC Statement

This equipment has been tested and found to comply with the limits for a Class B digital device, pursuant to part 15 of the FCC Rules. These limits are designed to provide reasonable protection against harmful interference in a residential installation. This equipment generates uses and can radiate radio frequency energy and, if not installed and used in accordance with the instructions, may cause harmful interference to radio communications. However, there is no guarantee that interference will not occur in a particular installation. If this equipment does cause harmful interference to radio or television reception, which can be determined by turning the equipment off and on, the user is encouraged to try to correct the interference by one or more of the following measures:

- Reorient or relocate the receiving antenna.
 - Increase the separation between the equipment and receiver.
 - Connect the equipment into an outlet on a circuit different from that to which the receiver is connected.
 - Consult the dealer or an experienced radio/TV technician for help.
- This device complies with FCC radiation exposure limits set forth for an uncontrolled environment. This device complies with Part 15 of the FCC Rules. Operation is subject to the following two conditions: (1) this device may not cause harmful interference, and (2) this device must accept any interference received, including interference that may cause undesired operation.

This equipment complies with FCC RF radiation exposure limits set forth for an uncontrolled environment.

Caution!

Any changes or modifications not expressly approved by the party responsible for compliance could void the user's authority to operate the equipment.