

KNOWLED P1200R Hard

诺力 LED 影视板灯
KNOWLED LED Light Panel

使用手册
Instruction Manual

- case or in a ventilated dry place.
16. Do not place equipment near flammable and volatile solvents such as alcohol and gasoline.
 17. Do not use accessories that are not recommended by our factory to avoid fire, electric shock or personal injury.
 18. When cleaning, do not wipe it with a damp cloth, please use a dry cloth or a soft cloth to wipe the dirt of the equipment.
 19. This product complies with ROHS, CE, and FCC certification, please refer to the relevant national standards for use and operation.
 20. The safety instructions are formulated according to the strict testing of the factory, and the design and specifications of the equipment are subject to change without prior notice. For latest product information, please check the GODOX website and view latest electronic instruction.
 21. One-year warranty period, accessories such as consumable batteries, adapters, power cords, etc. are not covered by this warranty.
 22. If it is found that the equipment is repaired without authorization, the one-year warranty period will be cancelled and relevant fees will be charged for maintenance.
 23. Machine failures caused by non-standard operation are not covered by the warranty.

keep these instructions!

Safety Instructions and Attentions

First of all, as the most basic principle: This product is a professional lighting set equipment and should be used by professional lighting engineers or under the guidance of professionals. Basic safety attentions must always be followed during use, as follows:

1. Before use, please read and understand these instructions and attentions.
2. Professional lighting is prohibited for children. When children are near, parents or accompanying persons must supervise closely to prevent children from personal injury due to collision with lamps or private use of lamps.
3. This lighting product is not ordinary lighting product and cannot be used for general lighting. Anyone who has suffered eye damage or has sensitive eyes should avoid using this product. When the lamp is on, it must be used with care. Do not touch high-temperature parts, such as LED lamp beads, to avoid burns.
4. When the lamp is on, it is forbidden to look directly at the lamp beads under any circumstances. Strong light should be used under the guidance of professional lighting engineers. Avoid prolonged exposure to strong light under any circumstances. If eye discomfort, please turn off the lamp in time, suspend use, and see a doctor immediately.
6. If the lamp bead is damaged or deformed by heat, stop using this equipment, and contact the manufacturer, service agent or qualified maintenance personnel to replace the lamp bead in time to avoid accidents.
7. This product is only suitable for use in -20°C to 45°C operating environment and normal humidity environment.
8. Do not use damaged equipment or accessories, and wait for professional maintenance personnel to check and repair to confirm being normal before use.
9. During using, if the casing of this product is broken due to being dropped, squeezed or subjected to strong impact, please do not use it, so as to avoid electric shock injury due to contact with internal electronic components.
10. If an extension cord is required, please use an extension cord with a current rating greater than or equal to that of the equipment. If an extension cord is rated less than the equipment, overheating may result.
11. Products have long power cords, please place the power cords properly and keep them in a safe place. Avoid contacting the power cord with overheating surfaces, avoid improper placement that could cause pulling damage, or trip on-site personnel. Please use the certified power cord from the original manufacturer. If the product is damaged by using a non-certified power cord, it will not be repaired by our factory.
12. Be sure to unplug equipment from the power outlet before cleaning and repairing. When not in use, do not pull the power cord to unplug the equipment. For normal power-off, please hold both ends of the plug of the equipment with your hands and pull the plug out of power outlet. This equipment needs to be connected to a grounded outlet.
13. This equipment is not waterproof, please keep it dry and do not immerse it in water or other liquids. The equipment should be installed in a dry and ventilated place, and avoid using it in rainy, humid, dusty or overheated environments. Do not place any objects on the lamp or let liquid flow into the lamp to avoid accidents.
14. Do not disassemble the product without permission. If the product fails, it must be checked and repaired by authorized maintenance personnel.
15. Before storing, make sure that the equipment has cooled down completely. For storage, unplug the power cord from the equipment. The equipment should be placed in the carrying

22

Foreword

Thank you for purchasing a Godox product.

Godox is proud to introduce the new P1200R Hard, a powerful KNOWLED LED light panel. With an output power of up to 1200W, it supports a voltage range of AC100V-240V, making it suitable for shooting scenarios worldwide. It features integrated light control, ultra-high brightness, precise brightness adjustment in increments, 4 dimming curves, a CCT range of 1800-10000K, 14 FX modes for different scenes, and various wireless control capabilities. It is perfect for large-scale studios, film and television bases, broadcasting rooms, outdoor shoots, and other shooting environments.

Main Features

- The built-in light control design not only saves space but also makes lighting more convenient.
- With its powerful 1200W output, it provides full power output across the entire CCT range.
- The light intensity can be smoothly adjusted from 100% to 0% in increments of one-thousandth, allowing for precise control.
- Built-in RGB mode, utilizing five-color blending technology, easily achieving full-color light.
- The P1200R Hard features four dimming curves: linear, S-curve, exponential, and logarithmic.
- The CCT range is wide, adjustable from 1800K to 10000K.
- There are multiple color modes available, including CCT mode, HSI mode, RGBW mode, GEL mode, and X-Y mode.
- The P1200R Hard offers a variety of intelligent controls, including DMX 512 control, support for RDM protocol, LumenRadio CRMX control, network settings, Bluetooth control, and light body control.
- The efficient cooling fan, combined with a new heat dissipation design, meets the heat dissipation needs of large lighting fixtures.
- The P1200R Hard features 14 FX modes, including flash, lightning, clouds, broken bulb, TV, candle, fire, fireworks, explosion, welding, police car, SOS, RGB cycle, party.



Warning

- ⚠ High-power LED light. Do not stare at the light source or shine it directly into someone's eyes.
- ⚠ Do not plug or unplug the power cord when the power is turned on, otherwise personal injuries may occur.
- ⚠ Do not cover the heat dissipation vent in working status.
- ⚠ Keep out of reach of children.
- ⚠ Please make sure to follow the instruction manual and correctly use this professional lighting device.



Don't stare at a bright light source

Name of Parts

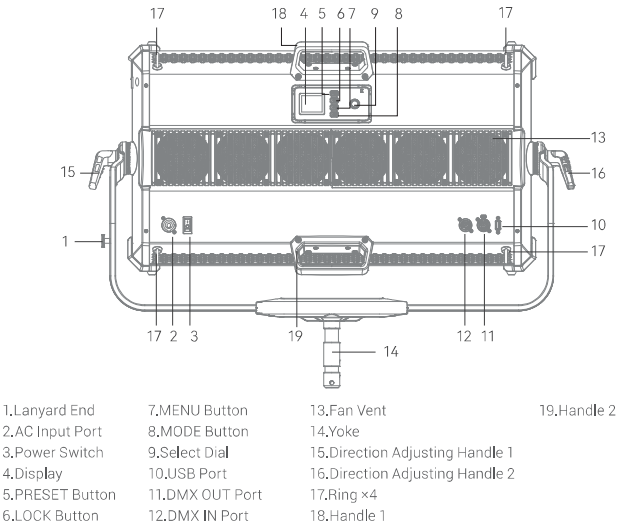

Installation Instructions for Yoke

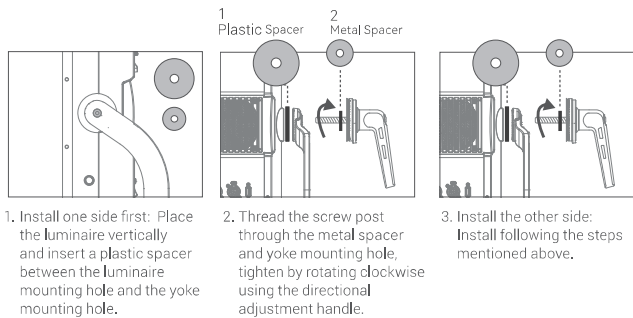

Item List of P1200R Hard

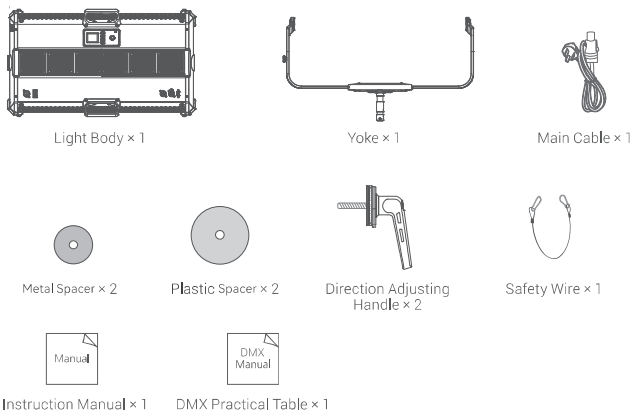

Item List of P1200R Hard K1

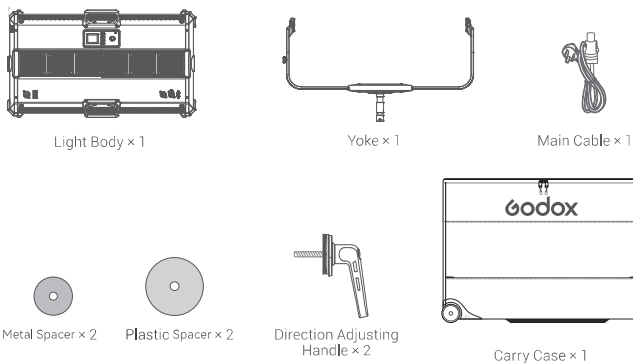

Connect to DMX Controller

Wireless DMX Connection

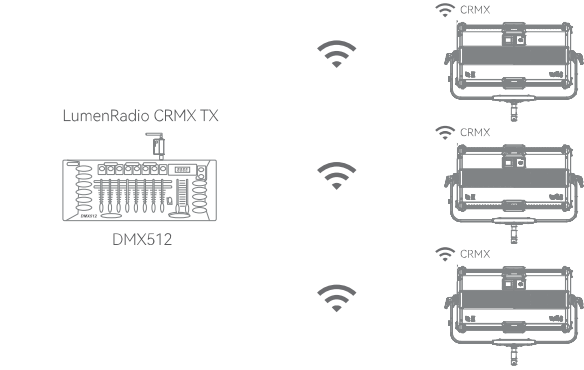

Wired DMX Connection

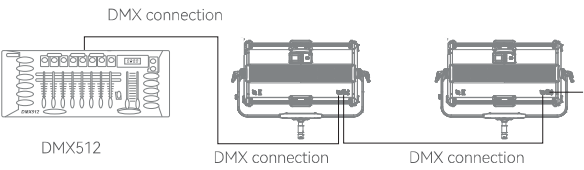

Note: DMX cable is sold separately.



Power Switch

To turn on or off the device, connect the power supply and toggle the power switch button to the 'I' position to turn it on or 'O' position to turn it off.

CCT Mode

To access the mode selection screen, press the MODE button briefly. Rotate the select dial to select the color temperature mode (CCT), and press the select dial briefly to enter the color temperature mode. Rotate the select dial to select brightness/CCT/ magenta-green adjustment. Press the select dial briefly to enter a specific setting. Rotate the dial counterclockwise to decrease the parameter value and clockwise to increase the parameter value.

The interface shows the following parameters:
Brightness: 0%~100% (in increments of 0.1%)
CCT: 1800K~10000K (in increments of 100K)
Magenta-green: -100%~100% (in increments of 1%)

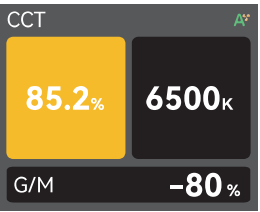

HSI Mode

Press the MODE button briefly to enter the mode selection interface. Rotate the select dial to select the HSI Mode, and press the select dial briefly to enter the HSI Mode. Rotating the select dial allows you to adjust brightness/hue/saturation. Press the select dial briefly to enter a specific setting. Turn the dial counterclockwise to decrease the parameter value and clockwise to increase the parameter value.

The interface displays the following parameters:
Brightness: 0%~100% (in increments of 0.1%)
Hue: 0°~360° (in increments of 1°)
Saturation: 0%~100% (in increments of 1%)

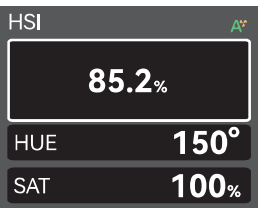

RGBW Mode

Press the MODE button briefly to enter the mode selection interface. Rotate the select dial to select RGBW, and press the select dial briefly to enter the RGBW Mode. Rotating the select dial allows you to adjust brightness/red/green/blue/white color. Press the select dial briefly to enter a specific setting. Turn the dial counter-clockwise to decrease the parameter value and clockwise to increase the parameter value.

The interface displays the following parameters:
Brightness: 0%~100% (in increments of 0.1%)
Red: 0%~100% (in increments of 0.1%)
Green: 0%~100% (in increments of 0.1%)
Blue: 0%~100% (in increments of 0.1%)
White: 0%~100% (in increments of 0.1%)

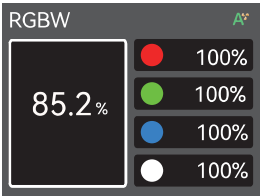

GEL Mode

Press the MODE button briefly to enter the mode selection interface. Rotate the select dial to select the GEL Mode, and press the select dial briefly to enter the GEL Mode. Rotating the select dial allows you to adjust brightness/gel type/gel group type/color /color temperature/hue/saturation. Press the select dial briefly to enter a specific setting. Turn the dial counter-clockwise to decrease the parameter value and clockwise to increase the parameter value.

The interface displays the following parameters:
Brightness: 0%~100% (in increments of 0.1%)
Gel Type: R-GEL/L-GEL
Gel Group Type: (R-GEL) COR./CAL./SPC./CINE. (L-GEL) COR./COLOR./600/COS./700
Color Temperature: 3200K or 5600K
Hue: -10°-10° (in increments of 1°)
Saturation: -20%~20% (in increments of 1%)

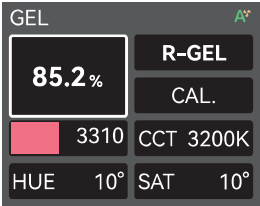

2. Lightning

This light effect simulates the lightning of thunder, often used to create a tense, terrifying, or mysterious atmosphere. Rotate the select dial to select a specific setting. Press the select dial briefly to select an option and then adjust the parameter by rotating the dial as needed. Once you have finished setting the parameters, press the MODE Button briefly to return to the previous level.

Brightness: 0%~100% (in increments of 0.1%)
On/Off: Turn the light on or off
Color Temperature: 1800K-10000K
Trigger: Auto/Manual
Flashes: Random/1-10
Frequency: Random/2-20

Note: If you select Manual mode, press the select dial briefly once to trigger the lightning effect.

3. Cloudy

This light effect simulates the obstructive effect of clouds and is often used to create a gloomy, oppressive, or sad atmosphere. Rotate the select dial to select a specific setting. Press the select dial briefly to select an option and then adjust the parameter by rotating the dial as needed. Once you have finished setting the parameters, press the MODE Button briefly to return to the previous level.

Brightness: 0%~100% (in increments of 0.1%)
On/Off: Turn the light on or off
Brightness Ratio: 10-90
Speed: Random/1-100

4. Broken Bulb

This light effect simulates a flash from a broken bulb and is often used to create a dim, yellowish atmosphere. Rotate the select dial to select a specific setting. Press the select dial briefly to select an option and then adjust the parameter by rotating the dial as needed. Once you have finished setting the parameters, press the MODE Button briefly to return to the previous level.

Brightness: 0%~100% (in increments of 0.1%)
On/Off: Turn the light on or off
Type: CCT/HSI
Color Temperature/Hue: 1800K-10000K/0°-360°
Speed: 1-100

5. TV

This light effect simulates the lighting effect of a TV or screen and is often used to create a cold, mechanical, or digitized atmosphere. Rotate the select dial to select a specific setting. Press the select dial briefly to select an option and then adjust the parameter by rotating the dial as needed. Once you have finished setting the parameters, press the MODE Button briefly to return to the previous level.

Brightness: 0%~100% (in increments of 0.1%)
On/Off: Turn the light on or off
Type: CCT/HSI
Speed: 1-100

X-Y Mode

Press the MODE button briefly to enter the mode selection interface. Rotate the select dial to select the X-Y Mode, and press the select dial briefly to enter the X-Y Mode. Rotating the select dial allows you to adjust brightness/X-coordinate/Y-coordinate. Press the select dial briefly to enter a specific setting and then rotate the select dial to adjust the parameter.

The interface displays the following parameters:
Brightness: 0%~100% (in increments of 0.1%)
X-coordinate: 0.0000~0.8500
Y-coordinate: 0.0000~0.9500

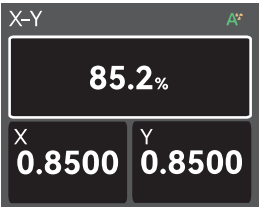

FX Mode

Press the MODE button briefly to enter the mode selection interface. Rotate the select dial to select the FX Mode, and press the select dial briefly to enter the FX Mode. Rotating the select dial allows you to select from the following light effects: flash/ lightning/cloudy/ broken bulb/TV/candle/fire/firework/explosion/ welding/police car/SOS/RGBW/RGB cycle/party. Press the select dial briefly to enter a specific setting.

To select the desired lighting effect, briefly press the select dial to enter the lighting effect settings interface. Once the lighting effect is set, press the MODE Button briefly to return to the previous level.



1. Flash

This light effect simulates the flash of a camera flash or a traditional flash bulb, often used to create a lively and dynamic atmosphere. Rotate the select dial to select a specific setting. Press the select dial briefly to select an option and then adjust the parameter by rotating the dial as needed. Once you have finished setting the parameters, press the MODE Button briefly to return to the previous level.

Brightness: 0%~100% (in increments of 0.1%)
On/Off: Turn the light on or off
Type: CCT/HSI
Color Temperature/Hue: 1800K-10000K/0°-360°
Trigger: Auto/Manual
Speed: 1-100
Mode: Camera Flash/Flash Bulb

Note: If you select Manual mode, press the select dial briefly once to trigger the flash light effect.

6. Candle

This light effect simulates the lighting effect of a candle and is often used to create a soft, warm, and flickering atmosphere. Rotate the select dial to select a specific setting. Press the select dial briefly to select an option and then adjust the parameter by rotating the dial as needed. Once you have finished setting the parameters, press the MODE Button briefly to return to the previous level.

Brightness: 0%~100% (in increments of 0.1%)
On/Off: Turn the light on or off
Speed: 1-100

7. Fire

This light effect simulates the lighting effect of a flame and is often used to create a bright, lively, and flickering atmosphere. Rotate the select dial to select a specific setting. Press the select dial briefly to select an option and then adjust the parameter by rotating the dial as needed. Once you have finished setting the parameters, press the MODE Button briefly to return to the previous level.

Brightness: 0%~100% (in increments of 0.1%)
On/Off: Turn the light on or off
Speed: 1-100

8. Firework

This light effect simulates the lighting effect of firework and is often used to create a splendid, colorful, and romantic atmosphere. Rotate the select dial to select a specific setting. Press the select dial briefly to enter an option and then adjust the parameter by rotating the dial as needed. Once you have finished setting the parameters, press the MODE Button briefly to return to the previous level.

Brightness: 0%~100% (in increments of 0.1%)
On/Off: Turn the light on or off
Speed: 1-100
Embers: 1-100

9. Explosion

This light effect simulates the lighting effect of an explosion and is often used to create a bright, intense, and flickering atmosphere. Rotate the select dial to select a specific setting. Press the select dial briefly to select an option and then adjust the parameter by rotating the dial as needed. Once you have finished setting the parameters, press the MODE Button briefly to return to the previous level.

Brightness: 0%~100% (in increments of 0.1%)
On/Off: Turn the light on or off
Type: CCT/HSI
Color Temperature/Hue: 1800K-10000K/0°-360°
Trigger: Auto/Manual
Speed: 1-100
Embers: 1-100

Note: If you select Manual mode, press the select dial briefly once to trigger the explosion effect.

10. Welding ⚡

This light effect simulates the lighting effect of welding and is often used to create a hot and mechanical atmosphere. Rotate the select dial to select a specific setting. Press the select dial briefly to select an option and then adjust the parameter by rotating the dial as needed. Once you have finished setting the parameters, press the MODE Button briefly to return to the previous level.

Brightness: 0%~100% (in increments of 0.1%)
On/Off: Turn the light on or off
Type: CCT/HSI
Color Temperature/Hue: 1800K-10000K/0°-360°
Speed: 1-100

11. Police Car 🚓

This light effect simulates the lighting effect of welding and is often used to create a hot and mechanical atmosphere. Rotate the select dial to select a specific setting. Press the select dial briefly to select an option and then adjust the parameter by rotating the dial as needed. Once you have finished setting the parameters, press the MODE Button briefly to return to the previous level.

Brightness: 0% to 100% (in increments of 0.1%)
On/Off: Turn the light on or off
Colors: Red+Blue, Red, Blue, White+Blue, Yellow+Blue, Yellow, Red+Blue+White, Red+Yellow+Blue
Speed: 1-5

12. SOS SOS

This lighting effect simulates the flashing of an SOS distress signal and is commonly used to create a dangerous, distressing, or emergency atmosphere. Rotate the select dial to select a specific setting. Press the select dial briefly to select an option and then adjust the parameter by rotating the dial as needed. Once you have finished setting the parameters, press the MODE Button briefly to return to the previous level.

Brightness: 0% to 100% (in increments of 0.1%)
On/Off: Turn the light on or off
Type: CCT/HSI
Color Temperature/Hue: 1800K-10000K/0°-360°

13. RGB Cycle 🔄

This lighting effect simulates the flashing of an SOS distress signal and is commonly used to create a dangerous, distressing, or emergency atmosphere. Rotate the select dial to select a specific setting. Press the select dial briefly to select an option and then adjust the parameter by rotating the dial as needed. Once you have finished setting the parameters, press the MODE Button briefly to return to the previous level.

Brightness: 0% to 100% (in increments of 0.1%)
On/Off: Turn the light on or off
Saturation: 0% to 100% (in increments of 1%)
Speed: 1-100

14. Party 🎉

This lighting effect simulates the effects of colorful lights, flash lights, and lasers, and is commonly used to create a festive, joyful, high-energy atmosphere. Rotate the select dial to select a specific setting. Press the select dial briefly to select an option and then adjust the parameter by rotating the dial as needed. Once you have finished setting the parameters, press the MODE Button briefly to return to the previous level.

Brightness: 0% to 100% (in increments of 0.1%)
On/Off: Turn the light on or off
Saturation: 0% to 100% (in increments of 1%)
Speed: 1-100

Menu Settings

Press the MENU button briefly to enter the menu settings. Rotate the select dial to choose from DMX, CRMX, Bluetooth, Dimming Curve, Control Mode, Color Space, Fan, Display, Language, Version & Upgrade, Factory Reset, and Fixture Info.

DMX	001
CRMX	Off
Bluetooth	
Dimming Curves	
Control Mode	
Color Space	
Fan	
Display	
Language	
Version&Upgrade	
Factory Reset	
Fixture Info	

1.DMX

Press the select dial briefly to enter the DMX settings interface. Rotate the dial to choose from Address/DMX Mode/RDM State/DMX Lost Status/Termination /Enhanced DMX Channel. Press the dial briefly to enter the option settings, and adjust the settings by rotating the dial as needed.

DMX	
Address	001
DMX Mode	01:CCT 8 Bit
RDM State	On
DMX Lost	
Hold Last Command	
Termination	On
Extend DMX Channels	On

Level 1 Option	Level 2 Option	Description
Address	001-512	Initial Address
DMX Mode	01: CCT 8 Bit	CCT 8 bit
	02: HSI 8 Bit	HSI 8 bit
	03: RGB 8 Bit	RGB 8 bit
	04: RGBW 8 Bit	RGBW 8 bit
	05: RGBWW 8 Bit	RGBWW 8 bit
	06: CCT+HSI 8 Bit	CCT+HSI 8 bit
	07: CCT+RGBW 8 Bit	CCT+RGBW 8 bit
	08: FX 8 Bit	FX 8 bit
	09: GEL 8 Bit	GEL 8 bit
	10: CCT 16 Bit	CCT 16 bit
	11: HSI 16 Bit	HSI 16 bit
	12: RGB 16 Bit	RGB :16 bit
	13: RGBW 16 Bit	RGBW 16 bit
	14: X-Y 16 Bit	X-Y 16 bit
	15: FX 16 Bit	FX 16 bit
	16: GEL 16 Bit	GEL 16 bit
	17: RGB Engine 8 Bit	RGB 8 bit(Pixel)
	18: RGBW Engine 8 Bit	RGBW 8 bit(Pixel)
	19:HSI Engine 8 Bit	HSI 8 bit(Pixel)
	20: CCT+RGBW Engine 8 Bit	CCT+RGBW 8 bit(Pixel)
RDM State	On	Turn on RDM, the ADD and DMX mode can be set by controller.
	Off	Turn off RDM
DMX Lost	Hold Last Command	After the DMX control signal is lost, continue to use the last received DMX control signal until power down or a valid DMX control signal is received again.
	Black Out	The light is off immediately.
	Black Out After 2 Min.	After the DMX control signal is lost, continue to use the last received DMX control signal for 2 minutes then black out. Note: If a valid DMX control signal is received within 2 minutes, then use the new DMX control signal.
Termination	On	Turn on DMX terminal
	Off	Turn off DMX terminal
Extended DMX Channels	On	Turn on extend DMX channels
	Off	Turn off extend DMX channels

Note: Please refer to the "P1200R Hard DMX Practical Table" to control the device by DMX/RDM. The electronic version can be downloaded from the official website <https://www.godox.com>.

2.CRMX

Press the select dial briefly to enter the CRMX settings interface, Rotate the dial to choose from CRMX On/Off and Reset. Press the dial briefly to enter a specific setting.

CRMX switch: Adjust the setting by rotating the select dial.
CRMX reset: Set the reset function by briefly pressing the select dial.
Once the settings are complete, press the MENU button briefly to return to the previous level.

Note: CRMX only has a receiving function.

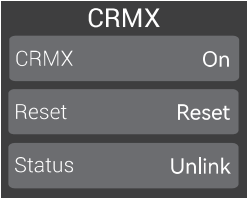

3.Bluetooth

Press the select dial briefly to enter the Bluetooth settings interface, Rotate the dial to choose from Bluetooth On/Off and Bluetooth Reset, then press the dial briefly to enter a specific setting.

Bluetooth On/Off: Adjust the setting by rotating the select dial.
Bluetooth Reset: Adjust the setting by rotating the select dial.
Bluetooth MAC Address: Located in the lower right corner of the interface, making it easy to find the Bluetooth of the fixture.
Once the settings are complete, press the MENU button briefly to return to the previous level.

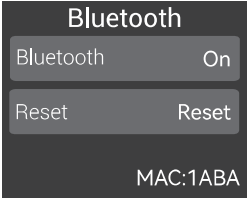

Download“GODOX Light”App

Scan the QR code to download the “Godox Light” smartphone App (can be used in Android and iOS).



Note: 1.The app can be used directly on the firstly installed device (smartphone or laptop). When change to other mobile device (smartphone or iPad), the light shall be reset before the normal connection of the app.
2.The app version should be 3.0 or above.

4.Dimming Curves

Press the select dial briefly to enter dimming curves setting interface. Rotate and press the select dial briefly to choose among linear, S-curve, exponential and logarithmic. Once the settings are complete, press the MENU button briefly to return to the previous menu.

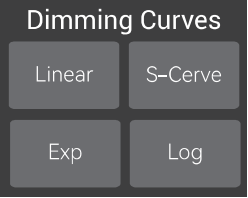

5.Control Mode

Press the select dial briefly to enter the control mode, Press the select dial briefly select the mode, rotate the select dial to choose the corresponding mode. Once the settings are complete, press the MENU button briefly to return to the previous menu.

Modes: Normal
Frequency: 1-11.

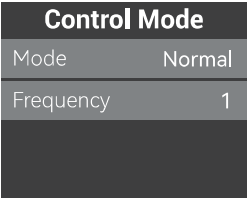

6.Color Space

Press the select dial briefly to enter the color space. Press the select dial briefly select the color space, rotate the select dial to choose the corresponding color space. Once the settings are complete, press the MENU button briefly to return to the previous menu.
Color Space: Original Gamut, Correction Gamut, REC 709, and DCI-P3.

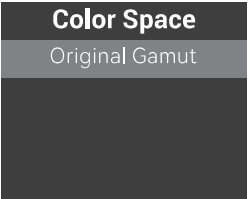

7.Fan

Press the select dial briefly to enter fan setting interface. Rotate and press the select dial briefly to choose among silent, auto, medium speed and high speed. Once the settings are complete, press the MENU button briefly to return to the previous menu.

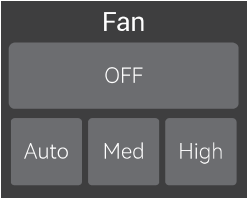

8. Display

Press the select dial to enter display setting interface. Rotate the select dial to select screen brightness/screen rotation. Press the select dial briefly to enter the settings. Rotate the dial to adjust the parameters. Once the settings are complete, press the MENU button briefly to return to the previous menu.

Display Brightness: 10-100
Display Rotation: Default, Inverted, Auto

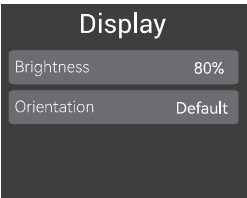

9. Language

Press the select dial to enter language setting interface. Rotate and press the select dial briefly to select between Chinese and English. Once the settings are complete, press the MENU button briefly to return to the previous menu.



10. Version & Upgrade

Press the select dial to enter version & upgrade setting interface to check the firmware version and upgrade instructions. Then, press the MENU button briefly to return to the previous menu.



Software Upgrade

1. Download the new firmware to the U disk from official website (<https://www.godox.com.cn/firmware-continuous-light>).
2. Turn off the device. Insert the U disk with new firmware into the USB Type-A port.
3. Turn on the device, and it will automatically enter the upgrade interface.
4. It will return to the main interface upon completion.

Notes: It is necessary to download the latest firmware from the official website and store it in the root directory of a USB flash drive. Only one BIN file should be present.
2. The USB-A port supports power supply with an output voltage and current of 5V/1.5A. Please do not connect high-power USB devices to it.

11. Factory Reset

Press the select dial briefly to enter factory reset setting interface. Rotate and press the select dial briefly to select apply or cancel. After selecting the factory reset, the brightness value will turn to 100%.



12. Fixture Info

Press the select dial briefly to enter fixture info setting interface to check model, UID NO., firmware version, light head temp., etc. Then, press the MENU button briefly to return to the previous menu.

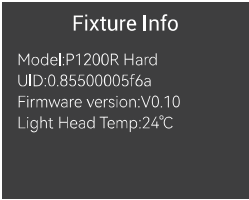

Lock Setting

Press the LOCK button briefly, the panel will be locked when is displayed on the panel, press the button briefly again to unlock the panel.



Preset Setting

Press the PRESET button briefly to enter preset effects interface. Rotate and press the select dial briefly to choose and enter preset effects 1~20, then press briefly to choose save or cancel. Once the settings are complete, press the select dial briefly to return to the previous menu and press the PRESET button briefly to exit.

Note: If a group of presets has not been preset with a light effect, the interface does not show the application options.

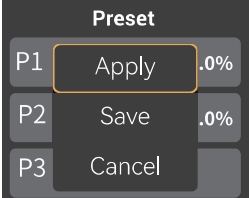

Technical Data

Model	P1200R Hard
Power Supply	100V~240V~50/60Hz
Max. Power	≈1500W
CCT	1800~10000K
GM Adjustment	~100%~100%
Brightness Range	0~100
Dimming Curves	linear, S-curve, exponential, logarithmic
CRI	≥96
TLCI	≥98
Controlling Methods	DMX 512 Control(support RDM protocol/LumenRadio(CRMX)/ Bluetooth Control/Light Body Control)
Bluetooth Controlling Distance	Max. 30m
USB Type-A Port	Firmware Upgrade/5V=1.5A Power Supply
Working Environment Temperature	-20 °C ~45°C
Dimension(including yoke)	32.83" × 23.86" × 6.69"
Netweight(Light body+Yoke)=	≈18,5kg

Specifications and data may subject to changes without notice.

Maintenance

This product, except consumables, is supported with a one-year warranty. Unauthorized service will void the warranty. Maintenance of the light must be performed by our authorized maintenance department which can provide original accessories. If the product had failures or got wet, do not use it until it is repaired by professionals. Shut down the device immediately should abnormal operation be detected.

Photometric Data

CCT	Testing Condition	Unit	1m	3m	5m	7m	9m
1800K	Bare Light	Lux	≈ 75900	≈9570	≈3740	≈2090	≈1300
		fc	≈ 7050	≈889	≈347	≈194	≈121
2800K		Lux	≈ 124000	≈15500	≈6090	≈3430	≈2170
		fc	≈ 11500	≈1440	≈566	≈319	≈201
3200K		Lux	≈ 123000	≈15400	≈6050	≈3400	≈2150
		fc	≈ 11400	≈1430	≈562	≈316	≈200
4300K		Lux	≈ 128000	≈15900	≈6240	≈3510	≈2220
		fc	≈ 11900	≈1480	≈579	≈326	≈206
5600K		Lux	≈ 136000	≈17100	≈6650	≈3760	≈2370
		fc	≈ 12600	≈1590	≈618	≈349	≈220
6500K		Lux	≈ 147000	≈18500	≈7160	≈4050	≈2550
		fc	≈ 13700	≈1720	≈665	≈376	≈237
8500K		Lux	≈ 137000	≈16900	≈6570	≈3710	≈2350
		fc	≈ 12700	≈1570	≈611	≈344	≈218
10000K		Lux	≈ 125000	≈15600	≈6040	≈3420	≈2160
		fc	≈ 11700	≈1450	≈561	≈317	≈201

The above data is not absolute and represents average values. All the above tests are based on the condition of 100% brightness.

FCC Statement

This device complies with part 15 of the FCC Rules. Operation is subject to the following two conditions:
(1) This device may not cause harmful interference, and
(2) this device must accept any interference received, including interference that may cause undesired operation.

Any Changes or modifications not expressly approved by the party responsible for compliance could void the user's authority to operate the equipment.

Note: This equipment has been tested and found to comply with the limits for a Class B digital device, pursuant to part 15 of the FCC Rules. These limits are designed to provide reasonable protection against harmful interference in a residential installation. This equipment generates uses and can radiate radio frequency energy and, if not installed and used in accordance with the instructions, may cause harmful interference to radio communications. However, there is no guarantee that interference will not occur in a particular installation. If this equipment does cause harmful interference to radio or television reception, which can be determined by turning the equipment off and on, the user is encouraged to try to correct the interference by one or more of the following measures:
-Reorient or relocate the receiving antenna.
-Increase the separation between the equipment and receiver.
-Connect the equipment into an outlet on a circuit different from that to which the receiver is connected.
-Consult the dealer or an experienced radio/TV technician for help.
The device has been evaluated to meet general RF exposure requirement. The device can be used in portable exposure condition without restriction.

Warning

Operating frequency: 2402MHz – 2480MHz (BT)
Maximum EIRP Power: 5dBm

Declaration of Conformity

GODOX Photo Equipment Co., Ltd, hereby declares that this equipment are in compliance with the essential requirements and other relevant provisions of Directive 2014/53/EU. In accordance with Article 10(2) and Article 10(10), this product is allowed to be used in all EU member states. For more information of DoC, Please click this web link: <https://www.godox.com/eu-declaration-of-conformity/>
The device complies with RF specifications when the device used at 0mm from your body.

Warranty

Dear customers, as this warranty card is an important certificate to apply for our maintenance service, please fill in the following form in coordination with the seller and safe-keep it. Thank you!

Product Information	Model	Product Code Number
Customer Information	Name	Contact Number
	Address	
Seller Information	Name	
	Contact Number	
	Address	
	Date of Sale	
Note		

Note: This form shall be sealed by the seller.

Applicable Products

Applicable ProductsThe document applies to the products listed on the Product Maintenance Information (see below for further information). Other products or accessories (e.g. promotional items,giveaways and additional accessories attached,etc.) are not included in this warranty scope.

Warranty Period

The warranty period of products and accessories isimplemented according to the relevant Product Maintenance Information. The warranty period is calculated from the day(purchase date) when the product is bought for the first time.And the purchase date is considered as the date registered onthe warranty card when buying the product.

How to Get the Maintenance Service

If maintenance service is needed, you can directly contact the product distributor or authorized service institutions. You can also contact the Godox after-sale service call and we will offer you service. When applying for maintenance service, you should provide valid warranty card. If you cannot provide valid warranty card, we may offer you maintenance service once confirmed that the product or accessory is involved in the maintenance scope, but that shall not be considered as our obligation.

Inapplicable Cases

The guarantee and service offered by this document are not applicable in the following cases:
① The product or accessory has expired its warranty period; ② Breakage or damage caused by inappropriate usage, maintenance or preservation, such as improper packing, improper usage, improper plugging in/out external equipment, falling off or squeezing by external force, contacting or exposing to the improper temperature, solvent, acid, base, flooding and damp environments, etc;
③ Breakage or damage caused by non-authorized institution or staff in the process of installation, maintenance, alternation, addition and detachment; ④ The original identifying information of product or accessory is modified, alternated, or removed; ⑤ No valid warranty card; ⑥ Breakage or damage caused by using illegally authorized, nonstandard or non-public released software; ⑦ Breakage or damage caused by force majeure or accident; ⑧ Breakage or damage that could not be attributed to the product itself. Once met these situations above, you should seek solutions from the related responsible parties and Godox assumes no responsibility. The damage caused by parts, accessories and software that beyond the warranty period or scope is not included in our maintenance scope. The normal discoloration, abrasion and consumption are not the breakage within the maintenance scope.

Maintenance and Service Support Information

The warranty period and service types of products are implemented according to the following Product Maintenance Information:

Product Type	Name	Maintenance Period(month)	Warranty Service Type
Parts	Circuit board	12	Customer sends the product to designated site
	Battery	3	Customer sends the product to designated site
	Electrical parts e.g.battery charger, etc.	3	Customer sends the product to designated site
Other Items	Lamp body, lamp cover, locking device, package, etc.	No	Without warranty

Godox After-sale Service Call +86-755-29609320(8062)