

Easy One Touch 4 Wireless

Dash & Windshield Mount • Support pour tableau de bord et pare-brise
• Supporto telefono per parabrezza e cruscotto • Armaturenbrett und
Windschutzscheibenhalterung • Montaje de tablero y parabrisas

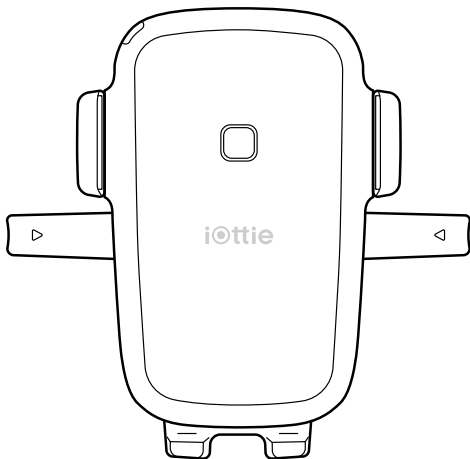

Manual • Guide • Manuale • Handbuch • Manual



iottie

Getting Started

For optimal mounting and charging, please follow the detailed instructions within this manual when using the Easy One Touch Wireless Charging Mount. iOttie is not liable for possible damages due to product misuse.

Critical Information

Compatibility

Before using product, make sure your device is Qi Wireless compatible. Compatible devices include iPhone X, iPhone Xs, iPhone XR, Samsung Galaxy Note S9, S9+, and S8.

Qi Wireless Charging

Use the included iOttie Charger and Micro USB Cable. If you do use a third party charger, use a Qualcomm Quick Charge 2.0 or equivalent adapter to receive a wireless charge (with compatible devices).

- Telescopic Arm extends from 5 inches to 7 inches.
- Universal design, fits smartphones and cases from 2.3" - 3.1" wide.
- Air vents on back allow air flow to keep mount cool.



At a Glance

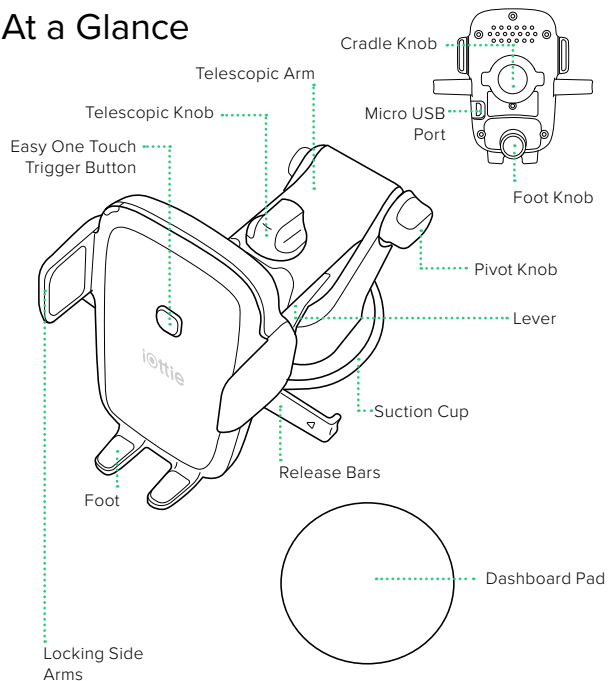

Inside:
Qi Wireless
Charging Coil

Wireless Charger Specifications

INPUT	5V/2A, 9V/2A, 12V/1.5A
CHARGING PORT	MICRO USB
LENGTH	6.0"
WIDTH	4.4"
HEIGHT	4.3"
WEIGHT	6.4oz

Charging Indicator

Solid Green Light	Smartphone charging.
Blinking Red Light	Smartphone not charging. Foreign object detected or overheating of mount or smartphone.

Qi Alignment Guide

The Qi Receiver Coil is usually located in the center area of the phone. Check with your phone's manufacturer for Qi coil location. Below are some examples for commonly used phones.

! For optimal wireless charging, please make sure your smartphone and mount's Qi coils are aligned.

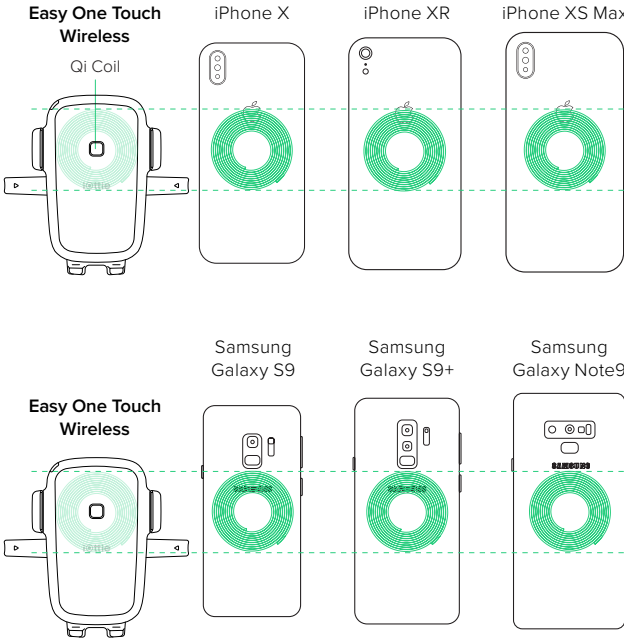

Installation

1. Assembling the Mount

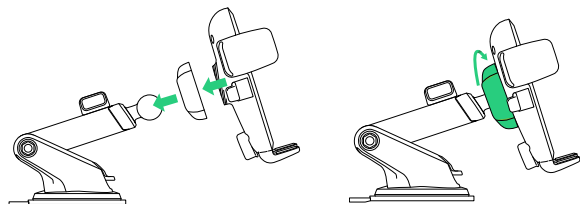

A. Connect the Mount Cradle with the Ball Joint.

B. Then, tighten the Cradle Knob.

2. Selecting a Location

Choose an installation method: Dashboard/Flat Surface (A) or Windshield/Curved Glass (B).

Option A

Dashboard or Flat Surface Installation

Choose an area on a flat surface and wipe any dust or debris from the surface.



1. Peel off the film on the dashboard pad & stick on the desired installation location.

2. Peel off the protective film on the Suction Cup and press mount firmly onto the dashboard pad.

3. Push Locking Lever down to engage suction.

Option B

Windshield Installation or Curved Glass Installation

Choose a location on the windshield and wipe any dust or debris from the surface.

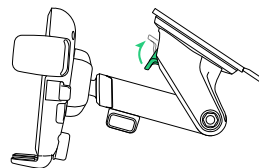

1. Peel off the protective film on the Suction Cup and press firmly onto the windshield.

2. Push Locking Lever down to engage suction.

Connecting Power

! The Easy One Touch Wireless is powered via a micro-USB cable. There is no on/off switch on the device.

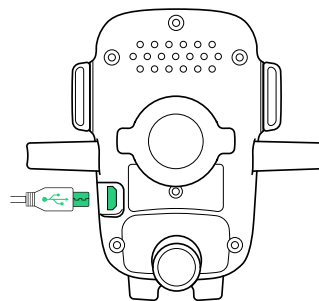

Using the Easy One Touch Mechanism

The Easy One Touch lock and release mechanism makes it simple to mount & retrieve smartphones in seconds.

Mounting

1. Press the locking side arms in.

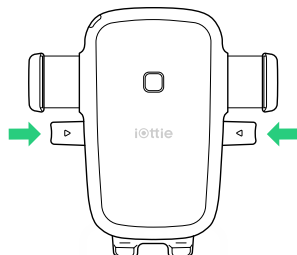

2. Press your device against the Easy One Touch trigger button. The mount's arms will automatically close on contact and hold the device during the driving journey.

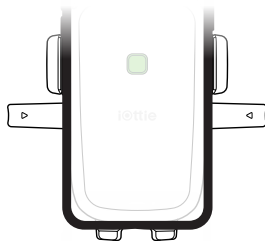

Releasing

Press the locking side arms with one hand and retrieve the device.

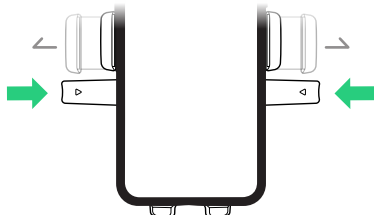

Adjusting the Mount

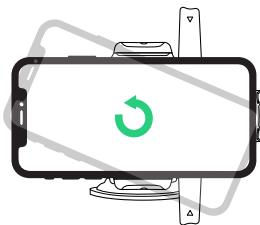

1. Cradle Knob

When mounting in landscape mode, loosen to rotate the Cradle. Tighten to lock in desired position.

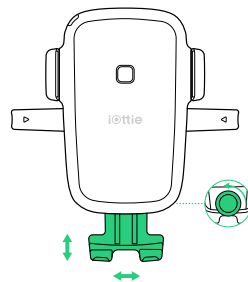

2. Foot Knob

Located on the lower back of Cradle. Loosen to re-position mount's foot. The Foot can be adjusted up & down or side-to-side.

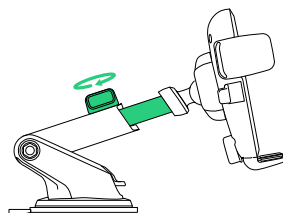

3. Telescopic Knob

Located on top of Telescopic Arm, loosen to extend the arm, and tighten to secure distance.

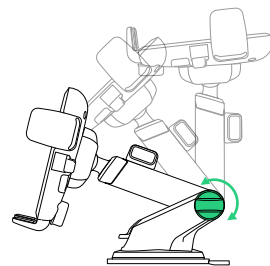

4. Pivot Knob

Located on the side of the Mount Base, turning allows you to pivot telescopic arm. Tighten to secure position.

Declaration of Conformity (FCC)

Changes or modifications not expressly approved by the party responsible for compliance could void the user's authority to operate the equipment. You can refer to the following completed FCC warnings.

This device complies with Part 15 of the FCC Rules.

Operation is subject to the following two conditions:

- 1) This device may not cause harmful interference.
- 2) This device must accept any interference received, including interference that may cause undesired operation.

Note

This equipment has been tested and found to comply with the limits for a Class B digital device, pursuant to Part 15 of the FCC Rules. These limits are designed to provide reasonable protection against harmful interference in a residential installation. This equipment generates, uses and can radiate radio frequency energy and, if not installed and used in accordance with the instructions, may cause harmful interference to radio communications.

However, there is no guarantee that interference will not occur in a particular installation. If this equipment does cause harmful interference to radio or television reception, which can be determined by turning the equipment off and on, the user is encouraged to try to correct the interference by one or more of the following measures:

- Reorient or relocate the receiving antenna.
- Increase the separation between the equipment and receiver.
- Connect the equipment into an outlet on a circuit different from that to which the receiver is connected.
- Consult the dealer or an experienced radio/TV technician for help.

Operational Warnings

- ⚠ During the charging process, the transfer of electricity gives off heat. Your device may become warm, but should not become exceedingly hot.
- ⚠ If the device gets wet, please cease charging immediately. Remove all plugs and dry the product completely. Device is only to be operated in a dry, indoor environment.
- ⚠ Please be careful of excessive drops, dents, punctures, or deformities on the device. If you are concerned, please unplug the device and contact the manufacturer.
- ⚠ Changes or modifications not expressly approved by the party responsible for compliance could void the user's authority to operate the equipment.
- ⚠ Operating this device in a hot environment or in direct sunlight for a long period of time may cause malfunctions. We recommend keeping the product in cooler temperatures.
- ⚠ Please use included components for an optimal experience. To support Qi wireless charge when using a third party car charger or a USB Power Adapter use a minimum output of both "9.0V-1.67A or 5.0V-2.0A" and at least QC 2.0.
- ⚠ The product's signal could possibly interfere with you TPMS (tire pressure monitoring system). If you notice that your TPMS light turns on, please try using your mount in different locations to avoid the signals from interfering with each other.
- ⚠ California Proposition 65 this product contains chemicals known to the state of California to cause cancer and birth defects or other reproductive harm.



CAUTION

OLD ELECTRICAL APPLIANCES MUST NOT BE DISPOSED OF TOGETHER WITH THE RESIDUAL WASTE, BUT HAVE TO BE DISPOSED OF SEPARATELY.



EN If you love your iOttie product, let us know by leaving a review online, or connect with us on our social platforms.

FR Si vous aimez votre produit iOttie, merci de nous le faire savoir en laissant un commentaire en ligne ou nous rejoindre sur nos réseaux sociaux.

IT Se ami il tuo prodotto iOttie, faccelo sapere lasciando una recensione online o sulle nostre piattaforme social.

DE Wenn Sie von Ihrem iOttie-Produkt begeistert sind, lassen Sie es uns bitte wissen, indem Sie eine Bewertung online abgeben oder sich mit uns auf unseren sozialen Plattformen verbinden.

ES Si le gusta su producto iOttie, háganos saber dejando una reseña en línea, o conéctese con nosotros en nuestras plataformas sociales.

Hiermit erklärt iOttie, dass sich diese in Übereinstimmung mit den grundlegenden Anforderungen und den übrigen einschlägigen Bestimmungen der Richtlinie 2014/53/EU befindet. Die EG-Konformitätserklärung kann hier heruntergeladen werden: <https://www.iottie.com/support/doc>

iottie



20 W 37th St
New York, NY 10018
U.S.A.

 www.iottie.com

 cs@iottie.com