

# Wireless Water Resistant Speaker

User's Guide for Model ISBW246



## FCC WARNINGS

Warning: Changes or modifications to this unit not expressly approved by the party responsible for compliance could void the user's authority to operate the equipment.

NOTE: This equipment has been tested and found to comply with the limits for a Class B digital device, pursuant to Part 15 of the FCC Rules. These limits are designed to provide reasonable protection against harmful interference in a residential installation. This equipment generates, uses, and can radiate radio frequency energy and, if not installed and used in accordance with the instructions, may cause harmful interference to radio communications. However, there is no guarantee that interference will not occur in a particular installation. If this equipment does cause harmful interference to radio or television reception, which can be determined by turning the equipment off and on, the user is encouraged to try to correct the interference by one or more of the following measures:

- Reorient or relocate the receiving antenna.
- Increase the separation between the equipment and receiver.
- Connect the equipment into an outlet on a circuit different from that to which the receiver is connected.
- Consult the dealer or an experienced radio/TV technician for help.

## ADDITIONAL WARNINGS AND PRECAUTIONS

- To avoid hearing damage, make sure that the volume on your music player is turned down before connecting your headphones. After placing headphones in/on your ears, gradually turn up the volume until you reach a comfortable listening level.
- Lithium batteries, like all rechargeable batteries, are recyclable and should be recycled or disposed of according to state and local guidelines. They should never be disposed of in normal household waste, and they should never be incinerated, as they might explode. Contact your local government for disposal or recycling practices in your area.
- WARNING: This product may contain chemicals known to the State of California to cause birth defects, or other reproductive harm (California Prop 65). Wash hands after handling.
- This product meets and complies with all Federal regulations.

This device complies with part 15 of the FCC rules. Operation is subject to the following two conditions:

- (1) this device may not cause harmful interference, and
- (2) this device must accept any interference received, including interference that may cause undesired operation.

## Overview

### Features

- IPX4 water resistant
- Built-in speaker
- Supports Bluetooth
- Wireless range: 60 feet
- Built-in microphone for speakerphone
- LED flashlight
- Micro-SD memory card reader
- Aux in (3.5mm audio input)
- DC battery power: built-in 2200mAh rechargeable lithium ion battery
- Battery life: approx. 7 hours at 50% volume

### Includes

- Micro-USB to USB charging cable
- Handlebar bracket
- Wrist strap
- User's Guide

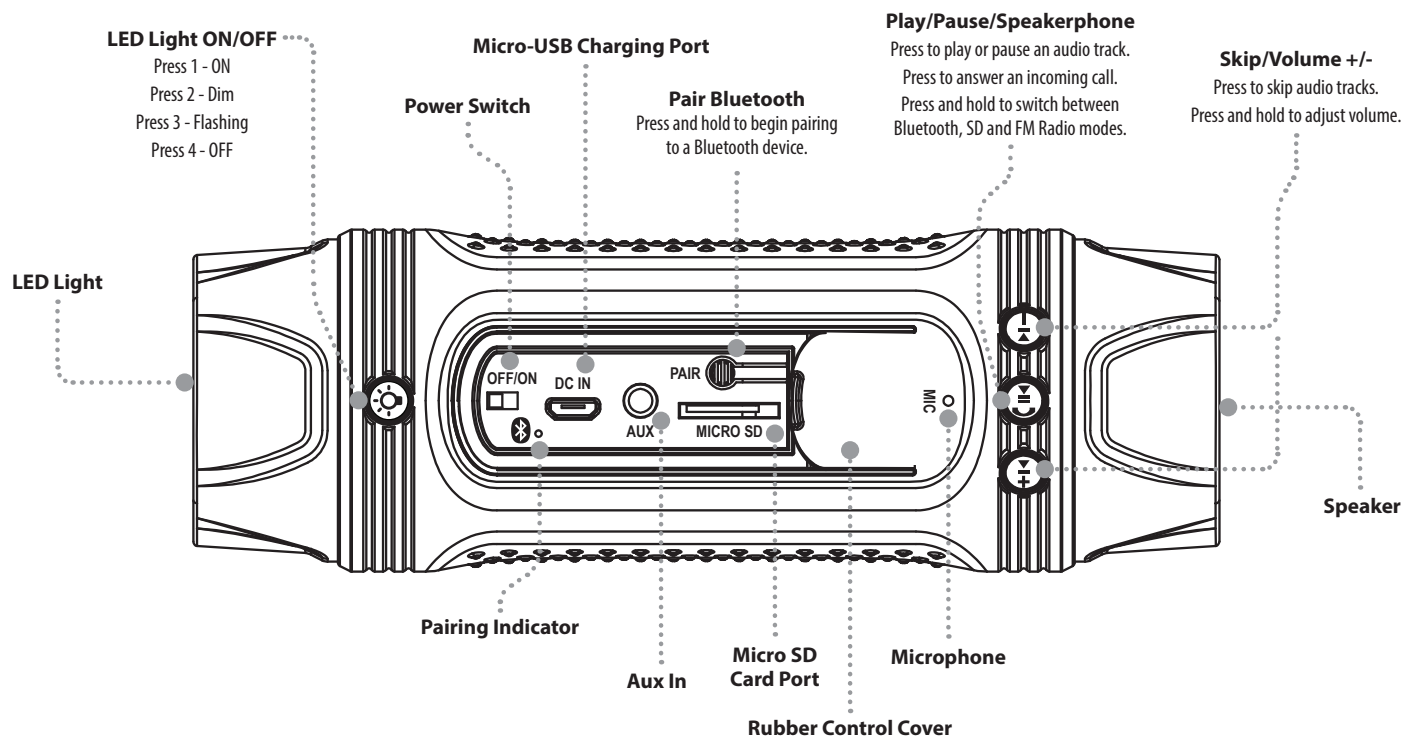

## Attach Handstrap

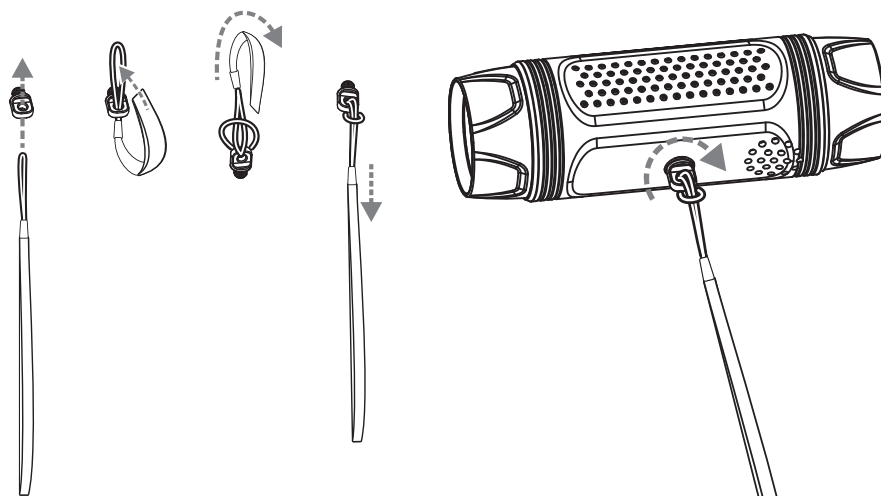

## Attach to Bicycle Handlebar

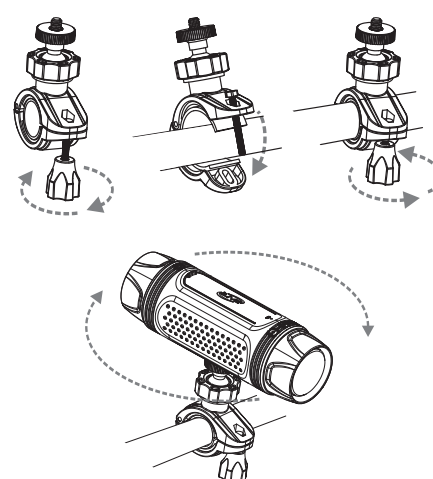

## Water Resistance

This unit has a water resistance rating of IPX4. This rating is suitable for indoor and outdoor use in the presence of incidental or light exposure to splashing water, rain, or snow. Water splashing against the enclosure from any angle should have no harmful effects. It is not recommended to submerge this speaker in water for any amount of time.

**IMPORTANT:** To ensure your speaker is prepared for use in a wet environment, disconnect and remove any power cables, and tightly close the cover on the top of the unit. If the cover is not properly closed, water resistance will be compromised and could result in damage to the speaker or personal injury.

## Charging the Battery

Requires a Micro-USB to USB cable (included).

1. Using a **Micro-USB to USB** cable (included), connect to the USB port of a powered on computer or USB power adaptor to charge the unit. Charge fully before use.

| INDICATOR LIGHT    | STATUS                   |
|--------------------|--------------------------|
| Red light ON       | Charging battery         |
| Red light OFF      | Charging complete        |
| Red light flashing | Low Battery, charge soon |

## Bluetooth Wireless Audio

### Pairing to a Device & Playing Audio

After initial pairing, the unit will stay paired unless unpaired manually by the user or erased due to a reset of the device. If your device should become unpaired or you find it is unable to connect, repeat the steps listed here.

1. Power on the unit by sliding the **POWER Switch** to the **ON** position, then press and hold the **Pair button** to begin pairing. The **pairing indicator** will begin quickly flashing blue. When pairing, remain within 3 feet of the unit.
2. Using the controls on your Bluetooth device, scan for and select **ISBW246** in your Bluetooth settings to pair. If your device requests a password, enter the default password **0000**. Refer to the user's manual for your specific device for instructions on pairing and connecting Bluetooth devices.
3. When successfully paired, the **pairing indicator** will turn solid blue and an audible chime will sound from the speaker.
4. Use the controls on the connected device to select and begin playing audio. Audio played through the connected Bluetooth device will now be heard through the speaker.
5. Use the controls on the unit or the connected device to play, pause, and adjust volume.

## Aux In

Requires a 3.5mm audio cable (not included).

1. Connect a 3.5mm audio cable to the **Aux In** on the unit and the **audio output/headphone jack** on a media player or smartphone.
2. Power on the unit by sliding the **POWER Switch** to the **ON** position. The Aux input will be detected and the unit will automatically switch to Aux In mode.
3. Use the controls on the connected device to select and play audio.

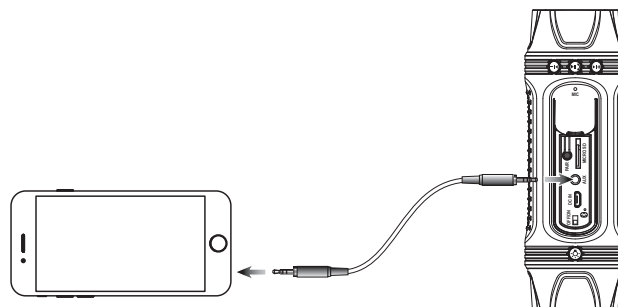

## FM Radio

1. Press and hold the **Play/Pause button** to switch to FM mode.
2. Press the **Play/Pause button** again to automatically scan for FM stations. When the scan is complete available stations will be saved as presets.
3. **Press the Skip buttons** to cycle through saved stations. **Press and hold the Skip buttons** to adjust the volume.

## Micro-SD Card

1. Insert a Micro-SD card in the card slot. The speaker will begin playing automatically.
2. Use the controls on the unit to play, pause, and adjust volume.
3. **Press and hold the Play/Pause button** to switch to a different mode.

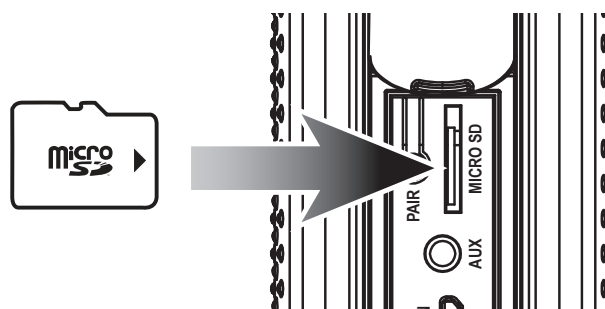

## International Support

To download this User's Guide in English, Spanish, or French, or to get answers to frequently asked questions, visit the support section at: [www.iLiveElectronics.com](http://www.iLiveElectronics.com)

Para descargar este Manual del Usuario en inglés, español y francés, o para obtener respuestas a preguntas frecuentes, visite la sección de apoyo en: [www.iLiveElectronics.com](http://www.iLiveElectronics.com)

Pour télécharger ce guide de l'utilisateur en anglais, espagnol ou français, ou pour obtenir des réponses à des questions fréquemment posées, consultez la rubrique d'assistance sur: [www.iLiveElectronics.com](http://www.iLiveElectronics.com)

For Warranty Information and the most up-to-date version of this User's Guide, go to [www.iLiveElectronics.com](http://www.iLiveElectronics.com)

**Customer Service:** 1-888-999-4215 | **Email Support:** [prodinfo@dpiinc.com](mailto:prodinfo@dpiinc.com) | **Email Parts:** [partsinfo@dpiinc.com](mailto:partsinfo@dpiinc.com)

Copyright © 2016 Digital Products International (DPI, Inc.) All other trademarks appearing herein are the property of their respective owners. Specifications are subject to change without notice.

