

Points for Attention

1. Do not use the player in exceptionally cold or hot, dusty, damp or dry environments.
2. Do not allow the player to fall down while using it.
3. Please charge your battery when
 - A. Battery power icon shows an empty icon;
 - B. The system automatically shuts down and the power is soon off when you switch on the unit once again;
 - C. There is no response if you operate on any key
4. Please do not disconnect power abruptly when the player is being formatted or in the process of uploading or downloading. Otherwise it may lead to the error in the program.
5. When this unit is used as a moving disk, the user shall store or export files in the proper file management operation method. Any improper operation method may lead to the loss of files, for which this company will be held no liable.
6. Please do not dismantle this unit by yourself. If there is any inquiry, please contact the dealer.
7. There will be no separate notice in the case of any change in the functions and performance of this product.

Basic Operation

Power on

In the shutdown state, long press "⏻" button boots

Power off

In the power on state, long press the "⏻" key 3 seconds then pop-up device options, select "Power off" to shut down.

Sleep

The machine under normal operating conditions, Short press the power button, Into hibernation, Now, Screen will close. Short press the power button again, Be able to resume normal mode. When the time being use this MID can enable this feature when, To reduce power consumption.

Power reset

If there is shutdown to the player in the process of operation, you can turn off and restart the player by pressing "reset" key.

Screen time out

If you do not contact the player within the set time, and do no operate by the button, the contact screen will be automatically turns off.

In any state, short press "⏻" button and for activation; Then skid the lock upwards to the green of spotted which will accomplish to access to the upper interface.

If it is necessary to deactivate the contact screen time out function, you can set the [Screen time out] option under [display] function into "Never".

Using the Micro SD card

After this unit is connected with the computer, you will find two moving disks. The first one is the built-in memory disk for this unit and the other is the disk for the Micro SD card. If no card is inserted, the second disk can not be opened. This unit supports the extension of the Micro SD card from 4GB to 32GB.

Inserting and Pulling out the Micro SD card

Inserting:

Put the Micro SD card face up (side with words), and slightly force the card into the socket of the card, i.e. connecting the unit. Under this state, you can play the content in the Micro SD card.

Pulling:

Slightly push the Micro SD, and it will bounce by a section, and then you can take it out.

Caution:

Please perform inserting and pulling operation when power is off! Otherwise, it will lead to the loss or damage to the files within the unit! If no card is inserted, the computer will be unable to perform read and write operation for the disk notes of the later removable disk (Micro SD card).

Battery:

High capacity Polymer battery is used for this unit.

The duration available of the battery power depends on volume, types of playing files and operation of batteries. The player can be set up by the user as "user define power off time" or "display setup" to save batteries.

Charging:

This unit can be recharged by USB port, please charge the device only by equipped USB cable and Charger. Other Charger might damage the machine.

Warnings for charging:

- 1. A new battery may be empty and not charged before you get the device.*
- 2. If the device is not used for long time, it is better to charge it to full capacity every 2 or 3 months during storage.*

Power adapter is a key component of the portable player, which play a crucial role in keeping the portable player's normal work and protecting your security when using the player, a long-term customer surveys and after-sales service Practice shows that the

malfunction of the portable player In many cases were caused by using inappropriate accessories, in particular the power adapter.

Use the substandard power adapter will shorten the life of the portable player by considerably, the voltage instability will seriously affected the normal work of the portable player and bring permanent damage on the player's performance and reliability, Use the substandard power adapter will also reduced the vocal quality of the players, shutdown the player when you using it, In addition, Use the substandard power adapter will cause combustion and explosion which will disserves the safety of the consumers.

Setting up your tablet

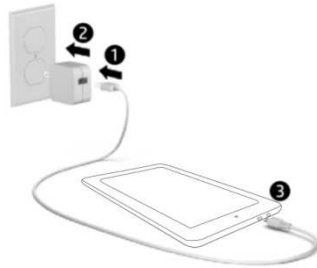

After charging the battery, press and hold the power button for up to 5 seconds until the pattern was displayed.

IMPORTANT: If the battery image is not displayed on the screen, press the power button briefly to display the image, and then press and hold the power button until the logo is displayed.

Follow the on-screen instructions to select a language and a wireless network.



All apps—Display a list of all apps installed.



Setting —Set the WLAN, BT, Brightness etc.

The  button moves back one step to the previous menu/page.

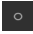
The  button returns immediately to the main screen.

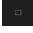
The  button displays a menu of recently opened applications.

(This interface adds a “CLEAR ALL” button)

NOTE: The appearance of the Home screen may vary.

Google Search—Allow you to type one or more keywords to search.



Voice search—Allow you to speak one or more keywords to search with the installed search app.

*The search feature varies by model and country.

. SETTINGS MENU

The settings menu allows you to adjust Tablet cellphone System Configuration.

To Change Settings:

1. Touch the “Settings”  menu icon on the Application menu. The Settings menu will open.
2. Touch a category title to view further options on the right side of the screen.

- Wi-Fi – Connect to/disconnect from wireless networks, view connection status
- Bluetooth – Connect or disconnect Bluetooth devices
- Display – Adjust display settings.
- Prompt & Notifications – Adjust different notification settings.
- Audio Profiles – Adjust the different audio settings such as ringtones.
- Apps – A list of all apps downloaded and running.
- Storage & USB – View your phone's internal and external storage settings.

(Note: the operation system software occupied some part of capacity).

- Battery – View the status of your battery and make adjustments to power consumption.
- Memory – View the total memory capacity and free memory capacity.

(Note: this is for RAM memory, if it's 1GB ram, the displayed total memory will be around 0.90-0.93GB).

- Users - Switch between Owner and Guest
- Location – Change approximate location detection, improve search results, GPS satellites
- Security – Adjust phone's security settings; the screen lock;

- Accounts – Add or remove email and Google™ accounts such as Gmail, Google
- Google – Location, security, Ads, Nearby, Set up nearby device.
- Language and input – add to the dictionary, edit on-screen keyboard settings, vocal search, etc.
- Backup and reset – Backup and restore data, perform factory reset, etc.
- Date & time – Set date, time zone, time, clock format etc.
- Accessibility – Set up large text, auto-rotate screen, speak password etc.
- About Phone – Displays information about your phone
- "Settings" added the hamburger menu, in the two level settings in the upper left corner of the interface, you will see this hamburger menu.
click to see all the settings, easy to quickly jump.

With the installed search app.

Use gestures

The following gestures can be used with your tablet:

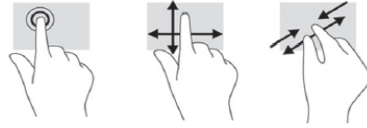



Organize the Home screen

- To add an app or a widget to the Home screen, touch the **Apps** tab or the **Widgets** tab, and then tap and hold an app or widget until it is added to the Home screen.
- To remove an app or widget from the Home screen, drag it to the X at the top of the screen.

Change your tablet's view

The Auto-rotate feature allows you to change your tablet's view. For landscape view, hold the tablet horizontally. For portrait view, hold the tablet vertically.

NOTE: Some apps do not rotate automatically.

To change the Auto-rotate setting, swipe down from the top of the screen to display notifications, and then touch the Screen rotation icon to lock  or unlock  the screen rotation.

Return to the Home screen

To quickly return to the Home screen, touch .

Display apps, widgets, and notification

Apps—Touch , and then touch the Apps tab to see a list of all apps.

Widgets—Touch , and then touch the Widgets tab to see a list of all widgets.

Notification—Swipe down from the top of the screen to see your notifications.

Back up your data

Strongly encourages that you periodically back up your personal data and media on your tablet to another computer, a dedicated storage device, or to the cloud using one of several commercially available solutions.

Specification

Memory	Flash Memory	8GB
General	Main Chip	ROCKCHIP RK3126C Quad Core
	Display	7" 1024*600TN
	PMU	Mali-400MP2
	Operation system	Android™ 8.1 (Go edition)
	DDR	1GB
	Built-in WLAN	WLAN 802.11 b/g/n
	3G Bands	N/A
	TP	P+G
	RTC(Real-time clock)	Yes
	G-sensor	Yes
	Power Charger	5V 1.5A US Plug
	Camera	2.0MP+5.0MP FF
	Bluetooth	Support
	Speaker	Yes
Dimensions	Approx. 192*109.7*11.5mm	
Operational Temperature	-5-40 degree	
Language	Multi-language	Spanish, English, etc.
Power supply	Battery	2400mah
Compatible format	Video	Supports AVI, MOV, VOB, RM/RMVB, FLV, DAT, MKV, MPG, MPE etc.
	Music	Supports MP3, WMA,APE, FLAC etc.
	Photo	Supports JPG, BMP, GIF and PNG photos
	E-book	Support PDF, TXT, EPUB etc. e-book format
Application software		Google Maps/e-mail/MSN/SKPYE/GTALK/INETBOOKS

Google, Android and other marks are trademarks of Google LLC.

FCC Statement

1. This device complies with Part 15 of the FCC Rules. Operation is subject to the following two conditions:

(1) This device may not cause harmful interference.

(2) This device must accept any interference received, including interference that may cause undesired operation.

2. Changes or modifications not expressly approved by the party responsible for compliance could void the user's authority to operate the equipment.

NOTE:

This equipment has been tested and found to comply with the limits for a Class B digital device, pursuant to Part 15 of the FCC Rules. These limits are designed to provide reasonable protection against harmful interference in a residential installation.

This equipment generates uses and can radiate radio frequency energy and, if not installed and used in accordance with the instructions, may cause harmful interference to radio communications. However, there is no guarantee that interference will not occur in a particular installation. If this equipment does cause harmful interference to radio or television reception, which can be determined by turning the equipment off and on, the user is encouraged to try to correct the interference by one or more of the following measures:

Reorient or relocate the receiving antenna.

Increase the separation between the equipment and receiver.

Connect the equipment into an outlet on a circuit different from that to which the receiver is connected.

Consult the dealer or an experienced radio/TV technician for help.

SAR Information Statement

Your wireless phone is a radio transmitter and receiver. It is designed and manufactured not to exceed the emission limits for exposure to radiofrequency (RF) energy set by the Federal Communications Commission of the U.S.

Government. These limits are part of comprehensive guidelines and establish permitted levels of RF energy for the general population. The guidelines are based on standards that were developed by independent scientific organizations through periodic and thorough evaluation of scientific studies. The standards include a substantial safety margin designed to assure the safety of all persons, regardless of age and health. The exposure standard for wireless mobile phones employs a unit of measurement known as the Specific Absorption Rate, or SAR. The SAR limit set by the FCC is 1.6 W/kg. * Tests for SAR are conducted with the phone transmitting at its highest certified power level in all tested frequency bands. Although the SAR is determined at the highest certified power level, the actual SAR level of the phone while operating can be well below the maximum value. This is because the phone is designed to operate at multiple power levels so as to use only the power required to reach the network. In general, the closer you are to a wireless base station antenna, the lower the power output. Before a phone model is available for sale to the public, it must be tested and certified to the FCC that it does not exceed the limit established by the government adopted requirement for safe exposure. The tests are performed in positions and locations (e.g., at the ear and worn on the body) as required by the FCC for each model, as described in this user guide, is 0.987W/Kg(Body-worn measurements differ among phone models, depending upon available accessories and FCC requirements). While there may be differences between the SAR levels of various phones and at various positions, they all meet the government requirement for safe exposure. The FCC has granted an Equipment Authorization for this model phone with all reported SAR levels evaluated as in compliance with the FCC RFexposure guidelines. SAR information on this model phone is on file with the FCC and can be found under the Display Grant section of <http://www.fcc.gov/oet/fccid> after searching on

FCC ID: 2ABOSSKYVISION2 Additional information on Specific Absorption Rates (SAR) can be found on the Cellular Telecommunications Industry Association (CTIA) web-site at <http://www.wow-com.com>. * In the United States and Canada, the SAR limit for mobile phones used by the public is 1.6 watts/kg (W/kg) averaged over one gram of tissue. The standard incorporates a sub-stancial margin of safety to give additional protection for the public and to account for any variations in measurements.

Body-worn Operation

This device was tested for typical body-worn operations. To comply with RF exposure requirements, a minimum separation distance of 15mm must be

maintained between the user's body and the handset, including the antenna. Third-party belt-clips, holsters, and similar accessories used by this device should not contain any metallic components. Body-worn accessories that do not meet these requirements may not comply with RF exposure requirements and should be avoided. Use only the supplied or an approved antenna.