

neon[®]

Instruction Manual

SPEAKER SYSTEM

CD MICRO SYSTEM

MCB1536

EN



Some Dos And Don't On The Safe Use Of Equipment

This equipment has been designed and manufactured to meet international safety standards but, like any electrical equipment, care must be taken if you are to obtain the best results and safety is to be assured.

DO read the operating instructions before you attempt to use the equipment.

DO ensure that all electrical connections (including the mains plug, extension leads and interconnections between the pieces of equipment) are properly made and in accordance with the manufacturer's instructions. Switch off and withdraw the mains plug before making or changing connections.

DO consult your dealer if you are ever in doubt about the installation, operation or safety of your equipment.

DO be careful with glass panels or doors on equipment.

DO route the mains lead so that it is not likely to be walked on, crushed, chafed, or subjected to excessive wear and tear or heat.

DON'T remove any fixed cover as this may expose dangerous voltages.

DON'T obstruct the ventilation openings of the equipment with items such as newspaper, tablecloths, curtains, etc. Overheating will cause damage and shorten the life of the equipment.

DON'T allow electrical equipment to be exposed to dripping or splashing, or objects filled with liquids, such as vases, to be placed on the equipment.

DON'T place hot object or naked flame sources such as lighted candles or nightlights on, or close to equipment. High temperatures can melt plastic and lead to fires.

DON'T use makeshift stands and NEVER fix legs with wood screws. To ensure complete safety always fit the manufacturer's approved stand or legs with the fixings provided according to the instructions.

DON'T use equipment such as personal stereos or radios so that you are distracted from the requirements of traffic safety. It is illegal to watch television whilst driving.

DON'T adjust the volume of the headphones to be too high and use that for an extended period, it can damage hearing.

DON'T leave equipment switched on when it is unattended unless it is specifically stated that it is designed for unattended operation or has a stand-by mode. Switch off using the switch on the equipment and make sure that your family know how to do this. Special arrangements may need to be made for infirm or handicapped people.

DON'T continue to operate the equipment if you are in any doubt about it working normally, or if it is damaged in any way - switch off, withdraw the mains plug and consult your dealer.

ABOVE ALL,

- **NEVER** let anyone especially children push anything into holes, slots or any other opening in the case - this could result in a fatal electrical shock;
- **NEVER** guess or take chances with electrical equipment of any kind. It is better to be safe than sorry!

FCC

This equipment has been tested and found to comply with the limits for a Class B digital device, pursuant to Part 15 of the FCC Rules. These limits are designed to provide reasonable protection against harmful interference in a residential installation. This equipment generates uses and can radiate radio frequency energy and, if not installed and used in accordance with the instructions, may cause harmful interference to radio communications. However, there is no guarantee that interference will not occur in a particular installation. If this equipment does cause harmful interference to radio or television reception, which can be determined by turning the equipment off and on, the user is encouraged to try to correct the interference by one of the following measures:

- Reorient or relocate the receiving antenna.
- Increase the separation between the equipment and receiver.
- Connect the equipment into an outlet on a circuit different from that to which the receiver is connected.

- Consult the dealer or an experienced radio/TV technician for help.

This device complies with Part 15 of the FCC Rules. Operation is subject to the following two conditions: [1] This device may not cause harmful interference, and [2] this device must accept any interference received, including interference that may cause undesired operation.

Any changes or modifications not expressly approved by the party responsible for compliance could void the user's authority to operate this equipment.

Safety Warnings

- Read all the instructions carefully before using the unit and keep them for future reference.
- Retain the manual. If you pass the unit onto a third party make sure to include this manual.
- Check that the voltage marked on the rating label matches your mains voltage.

Damage

- Please inspect the unit for damage after unpacking.
- Do not continue to operate the unit if you are in any doubt about it working normally, or if it is damaged in any way - switch off, withdraw the mains plug and consult your dealer.

Location of Unit

- The unit must be placed on a flat stable surface and should not be subjected to vibrations.
- Do not place the unit on sloped or unstable surfaces as the unit may fall off or tip over.
- The mains socket must be located near the unit and should be easily accessible.

Temperature

- Avoid extreme degrees of temperature, either hot or cold. Place the unit well away from heat sources such as radiators or gas/electric fires.
- Avoid exposure to direct sunlight and other sources of heat.

Naked Flames

- Never place any type of candle or naked flame on the top of or near the unit.

Moisture

- To reduce the risk of fire, electric shock or product damage, do not expose this unit to rain, moisture, dripping or splashing. No objects filled with liquids, such as vases, should be placed on the unit.
- If you spill any liquid into the unit, it can cause serious damages. Switch it off at the mains immediately. Withdraw the mains plug and consult your dealer.

Ventilation

- To prevent the risk of electric shock or fire hazard due to overheating, ensure that curtains and other materials do not obstruct the ventilation vents.
- A minimum distance of 5cm around the unit should be maintained to allow for sufficient ventilation.
- Do not install or place this unit in a bookcase, built-in cabinet or in another confined space. Ensure the unit is well ventilated.

Safety

- Always disconnect the unit from the mains supply before connecting/disconnecting other devices or moving the unit.
- Unplug the unit from the mains socket before a lightning storm.
- In the interests of safety and to avoid unnecessary energy consumption, never leave the unit switched on while unattended for long periods of time, e.g. overnight, while on holiday or while out of the house. Switch it off and disconnect the mains plug from the mains socket.

Mains Cable

- Make sure the unit or the unit stand is not resting on top mains cable, as the weight of the unit may damage the cable and create a safety hazard.

- Where the MAINS plug or an appliance coupler is used as the disconnect device, the disconnect device shall remain readily operable.

Interference

- Do not place the unit on or near appliances which may cause electromagnetic interference.
If you do, it may adversely affect the operating performance of the unit, and cause a distorted picture or sound.

Batteries

- Batteries used in the remote control for this unit are easily swallowed by young children and this is dangerous.
- Keep loose batteries away from young children and make sure that the battery holder tray is secure in the remote control. Seek medical advice if you believe a cell has been swallowed.
- Please dispose of batteries correctly by following the guidance in this manual.
- Batteries (battery pack or batteries installed) shall not be exposed to excessive heat such as sunshine, fire or the like.

Supervision

- Children should be supervised to ensure that they do not play with the unit.
- Never let anyone especially children push anything into the holes, slots or any other openings in the case - this could result in a fatal electric shock.

Service

- To reduce the risk of electric shock, do not remove screws. The unit does not contain any user-serviceable parts. Please leave all maintenance work to qualified personnel.
- Do not open any fixed covers as this may expose dangerous voltages.

Maintenance

- Ensure the unit is fully unplugged from the power supply before cleaning.
- Do not use any type of abrasive pad or abrasive cleaning solutions as these may damage the unit's surface.
- Do not use liquids to clean the unit.

Class 1 Laser Product

- This unit utilises a laser. Use of controls, adjustments or performance of procedures other than those specified herein may result in hazardous radiation exposure.
- Before moving the unit, ensure the disc tray is empty.
- Always remove the disc when the unit is not in use.
- Failure to do so will risk severely damaging the disc and the unit.
- Do not stack devices, heat from other devices may affect the performance of the unit.

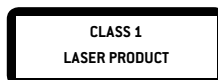

The lightning flash with arrowhead symbol, within an equilateral triangle, is intended to alert the user to the presence of uninsulated "dangerous voltage" within the unit's enclosure that may be sufficient magnitude to constitute a risk of electric shock.



The exclamation point within an equilateral triangle is intended to alert the user to the presence of important operating and maintenance (servicing) instructions in the manual accompanying the unit.



In case of using the headphones, be reminded that excessive sound pressure or volumes from headphones or earphones can lead to damage to the hearing. Always adjust the volume to a pleasant, not too loud level. If you have adjusted the volume of the headphones to be too high and use that for an extended period, it can damage the listener's hearing.

Battery Safety Guidelines

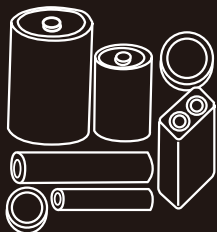

BATTERY SAFETY GUIDELINES

Used correctly, domestic batteries are a safe and dependable source of portable power. Problems can occur if they are misused or abused — resulting in leakage or, in extreme cases, fire or explosion. Here are some simple guidelines to safe battery use designed to eliminate any such problems.



Take care to fit your batteries correctly, observing the plus and minus marks on the battery and appliance. Incorrect fitting can cause leakage or, in extreme cases, fire or even an explosion.

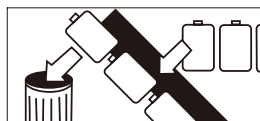

Replace the whole set of batteries at one time, taking care not to mix old and new batteries or batteries of different types, since this can result in leakage or, in extreme cases, fire or even an explosion.



Store unused batteries in their packaging and away from metal objects which may cause a short-circuit resulting in leakage or, in extreme cases, fire or even an explosion.



Remove dead batteries from equipment and all batteries from equipment you know you are not going to use for a long time. Otherwise the batteries may leak and cause damage.



Never dispose of batteries in fire as this can cause them to explode. Please recycle dead batteries; do not put with the normal household waste.



Never attempt to recharge ordinary batteries, either in a charger or by applying heat to them. They may leak, cause fire or even explode. There are special rechargeable batteries which are clearly marked as such.



Supervise children if they are replacing batteries themselves in order to ensure these guidelines are followed.



Remember that small button cell batteries such as used in some hearing aids, toys, games and other appliances, are easily swallowed by young children and this can be dangerous.



Keep loose button cells away from young children.



Make sure battery compartments are secure.



Seek medical advice if you believe a cell has been swallowed.

Table of Contents

Some Dos And Don't On The Safe Use Of Equipment.....	1
Safety Warnings	2
Battery Safety Guidelines.....	4
Table of Contents.....	5
Unpacking.....	7
Product Overview	8
Remote Control Overview.....	9
Battery Installation for the Remote Control	10
Handling the Remote Contro.....	10
Remote Control Operation Range	11
Connections	12
Connecting the Speakers.....	12
Connecting Auxiliary Equipment	12
Connecting the Antenna.....	12
ECO Power/Clock mode Features.....	13
Powering ON/OFF.....	13
Switching the system to ECO Power/Clock mode.....	13
Setting the Clock.....	13
Setting the Clock Manually.....	13
Setting the Clock Automatically.....	13
Display the clock.....	13
Adjust the brightness of the display	13
Sound Quality	14
Adjusting the Volume.....	14
Adjusting the Super Bass	14
Adjusting the Bass.....	14
Adjusting the Treble.....	14
Controlling the Loudness.....	14
Presetting Equalizer.....	14
Mute Sound	14
Listening to Radio Broadcasts	15
FM Radio.....	15
Presetting Stations	15
To change the FM Reception Mode	15
FM Display Modes.....	16

CD Operation.....	17
CD Playing	17
To Skip Search and Play.....	17
To Search	17
Text Display During Playback.....	17
Programme Play	17
Playing Repeatedly (CD)	17
MP3/WMA Disc Playing.....	18
Playing Repeatedly (MP3 disc).....	18
Using the USB	19
For devices with USB Cables	19
For memory Cards	19
USB Storage Device Data Protection	19
Playing from a Bluetooth device	20
Disconnect the accessory	20
Set the alarm timer	21
Activate / deactivate alarm timer.....	21
Set sleep timer	21
Disc Handling	22
Troubleshooting.....	23
Specifications	24
Notes for battery disposal	25

Unpacking

Remove all packaging from the unit. Retain the packaging. If you dispose of it please do so according to local regulations.

The following items are included:

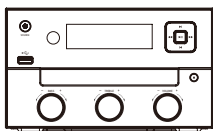

The Unit

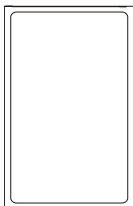

Speakers x 2



Remote Control



Speaker Cable x 2

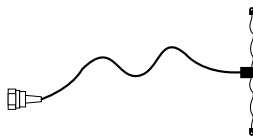

FM Antenna

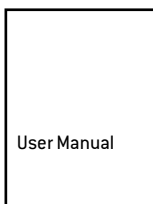

Instruction Manual

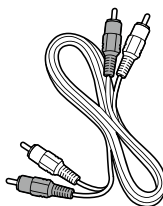

Audio L/R Cable x 1

Product Overview

Front view

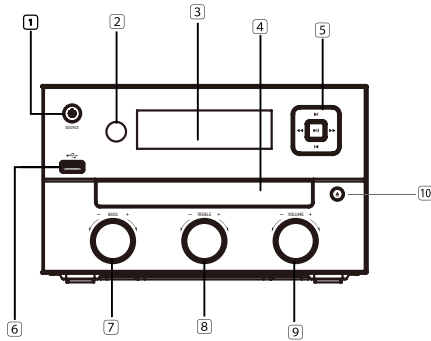

1. Standby/Source Button
2. Remote Sensor
3. Vacuum Fluorescent Display (VFD) Display Lens
4. Disc Tray
5. Fast Forward Button ►►
6. Tuning Forward Button
7. Reverse Button ◀◀
8. Tuning Backward Button
9. Next Button ►|
10. Preset Up Switch
11. Previous Button ►|
12. Preset Down Switch
13. Play/Pause Button ►||
14. USB socket
15. Bass Control
16. Treble Control
17. Volume Control
18. Open/Close Button ▲

Rear view

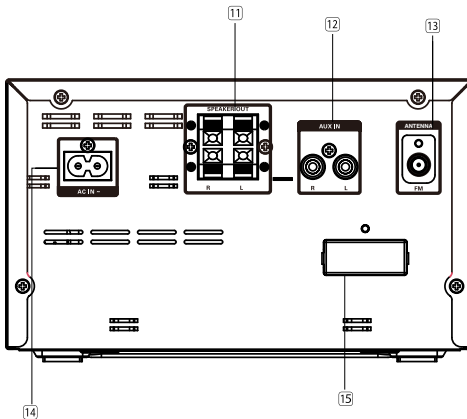

11. Speaker Output Terminals (L&R)
12. AUX Input Terminals (L&R)
13. AC Power Cable
14. FM Antenna
15. Built-in Bluetooth Antenna

Remote Control Overview

Remote control

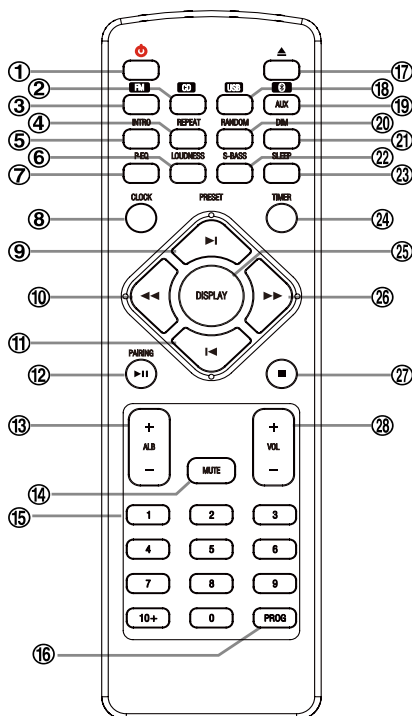

1. Standby Button
2. CD Function Button
3. FM Button
4. REPEAT Button
5. INTRO Button
6. LOUDNESS Button
7. P-EQ Button
8. Clock Button
9. Next Button ▶
10. Fast Backward Button ◀◀
11. Tuning Forward Button ▶▶
12. Previous Button ◀◀
13. PRESET DOWN Button
14. PAIRING Button
15. Play/Pause Button ▶||
16. Album Up Button (ALB +)
17. Album Down Button (ALB -)
18. Mute Button (MUTE)
19. Number Button (0-9, 10+)
20. Program Button (PROG)
21. Memory Button (PROG)
22. Open/Close Button ▲
23. USB Function Button (USB)
24. Bluetooth Function Button (Bluetooth)
25. AUX Function Button (AUX)
26. Random Button
27. Dimmer Button (DIM)
28. Super Bass Button (S-BASS)
29. Sleep Button (SLEEP)
30. Timer Button (TIMER)
31. DISPLAY Button
32. Search Forward Button ▶▶
33. Tuning Forward Button
34. SCAN Button
35. Stop Button ■
36. Cleared Button
37. Volume Up Button (VOL +)
38. Volume Down Button (VOL -)

Battery Installation for the Remote Control

1. Remove the insulating mylar strip from the battery if the battery is being used for the first time. It is located at the bottom back side of the remote control.

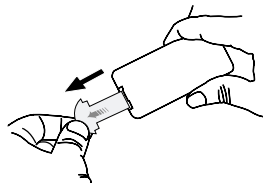

2. Unwind the screw and slide open the battery compartment of the remote control.

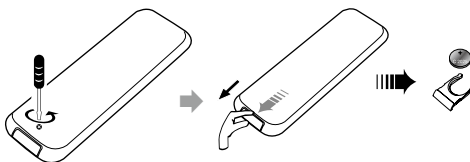

3. Unwind the screw and slide open the battery compartment of the remote control. Close the battery compartment cover and wind the screw back on.

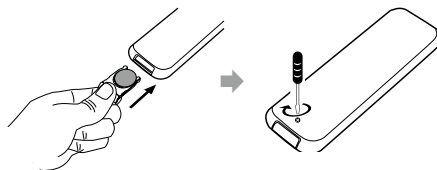

Handling the Remote Control

- Take care of your fingernails when you press and hold the battery release tab.
- Do not drop or cause impact to the remote control.
- Do not spill water or any liquid on the remote control.
- Do not place the remote control on a wet object.
- Do not place the remote control under direct sunlight or near sources of excessive heat.
- Remove the battery from the remote control when not in use for a long period of time, as it could cause corrosion or battery leakage and may result in physical injury and/or property damage including fire.

Remote Control Operation Range

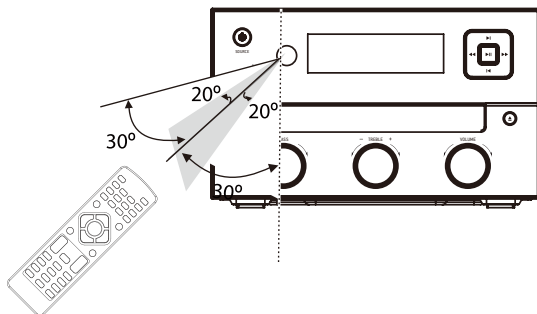

Point the remote control to the unit no more than 5 metres from the remote control sensor and within 60° horizontally and 40° vertically of the front of the unit. The operating distance may vary according to the brightness of the room.

Note:

- Make sure that there is no obstacle between the infrared remote sensor of the unit and remote control. If you install the unit on a rack, etc., the remote control range may decrease depending on the thickness or colour of the glass door of the rack.
- Do not expose the infrared remote sensor to direct sunlight or other strong light, such as inverter fluorescent light.

Connections

Connecting the Speakers

Connect the speaker cables between the terminals as shown below.

Connect the cables with the silver line to the [-] terminals and cables with the golden line to the [+] terminals.

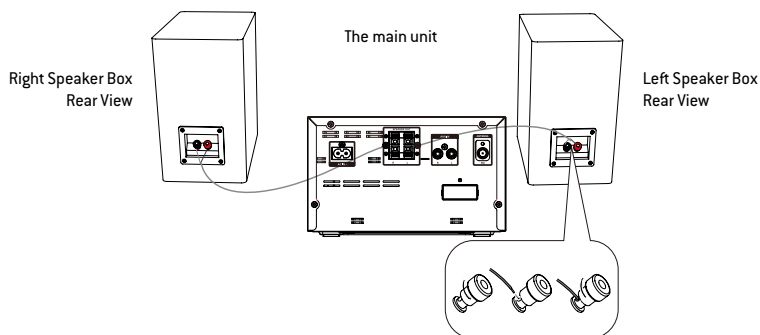

Connecting Auxiliary Equipment

Connect the AUX IN terminals on the rear of the unit to the line output terminals on the auxiliary equipment with an audio cable(not supplied) as illustrated below.

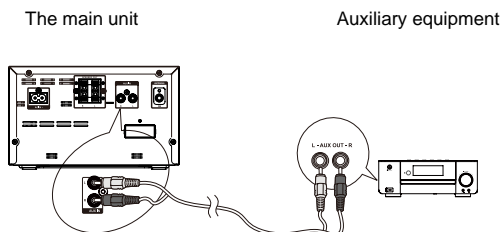

Connecting the Antenna

Caution: Make all connections before plugging the unit into the AC Power outlet.

Connect to the FM Antenna

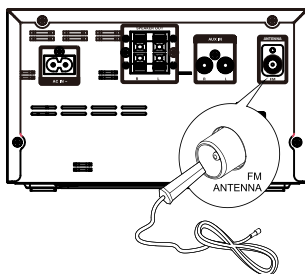

Connect the supplied FM Antenna to the FM Antenna socket on the rear of the unit.



ECO Power/Clock mode Features

Powering ON/OFF

When you insert the AC Power cable into a wall outlet, the unit will be in clock mode.

- Press the Standby  button to switch the unit on. The word "HELLO" be displayed on the display.
- Press the Standby  button to switch the unit back to clock mode. The word "GOOD BYE" will scroll across the display.
- Press the Standby button to switch the unit back to ECO POWER mode. the word "ECO POWER" will scroll across the display.

Switching the unit to ECO Power/Clock mode

Press and hold the Standby  button for 2 seconds or more to switch to ECO Power Standby or normal clock mode.

* ECO Power clock mode

The clock will not be displayed. Press the CLOCK button to display the clock on the display.

* Normal clock mode

The clock will display on the display.

Note:

1. If the unit is idle for more than 90 seconds in clock mode, it will automatically switch to Standby mode.
2. If the unit is idle for more than 15 minutes in normal mode, it will automatically switch to ECO-Power mode.

Setting the Clock

* Setting the Clock Manually

1. Set the unit in standby mode.
2. Press and hold the Clock button on the remote control, the display will display CLOCK SET and CLOCK 12 begins to blink.
3. Press the VOL+/- button on the remote control or on the front panel of unit to select 12/24 mode (time format), then press the Clock button to confirm, the hour digits begin to blink.
4. Press the VOL+/- button on the remote control on the front panel control of unit to set the hour, press the Clock button to confirm.
5. Set the minute with the VOL+/- button
6. Press the Clock button, the built-in clock starts operating.

Note:

- If the clock setting is idle for more than 90 seconds, the clock setting mode will be cancelled.
- If a power failure occurs or the unit is disconnected from the mains socket, the clock setting will be lost.

* Setting the Clock Automatically

When the RDS station displays the time, press and hold the "DISPLAY" button on the remote control, and the clock will automatically synchronise time with the RDS station.

*Display the Clock

In ECO power mode, press the Clock button.

*Adjust the Brightness of Display

Press DIM button on the remote control repeatedly to select different level of brightness of display.

Sound Quality

Adjusting the Volume

To increase or decrease the volume, rotate the - VOLUME + control on the unit or press the VOL +/- buttons on the remote control.

Adjusting the Super Bass

You can reinforce the bass sound to maintain rich, full bass at low volume. Press the S-BASS button on the remote control to get the effect. "DBB ON" will be shown on the display. Press the S-BASS button again to cancel the effect.

Adjusting the Bass

Rotate the BASS control clockwise or counter clockwise on the unit to adjust the intensity of the bass output sound.

Adjusting the Treble

Rotate the TREBLE control clockwise or counter clockwise on the unit to adjust the intensity of the treble output sound.

Controlling the Loudness

This unit has a loudness function, which can automatically increase the bass sound effect at low volume. It can also increase the bass sound effect at high volume, but it will be relatively less when it is at high volume. Press the loudness button (LOUDNESS) on the remote control to obtain the loudness function, the "🔊" will be shown on the display, press this button again to cancel the function.

Presetting Equalizer

You can adjust the sound reproduced simply by choosing from 5 preset equalizers. Press the P-EQ button repeatedly to scroll through the following options:

BALANCED → CLEAR → POWERFUL → WARM → BRIGHT



Mute sound

Press MUTE button on the remote control to turn on or off the sound during play.

FM Radio

You can listen to FM stations. Stations can be tuned in manually, automatically, or from a preset memory storage.

Caution: Before listening to the radio, please check that the FM antenna is correctly connected and adjusted for length and direction.

♦ Tuning in a Station

1. Repeatedly press the **SOURCE** button on the front panel of the unit "TUNER" is displayed on the display, or press the **FM** button on the remote control.
2. Tune in a station using one of the following methods:

♦ Auto Tuning

If you press and hold the **PROG** button on the remote control, the display will show "AUTO" and the auto tuning will start.

♦ Manual Tuning

Repeatedly press the Tuning Backward/Forward ◀◀/▶▶ buttons on the unit or press the ▶/◀ buttons on the remote control to change the frequency until you find the station you want.

♦ Preset Tuning (Available only after the stations are preset)

Repeatedly press the Preset ▶/◀ buttons on the remote control or press the ◀◀/▶▶ buttons on the unit to select the desired preset number. Its band and frequency are displayed on the display.

Presetting Stations

You can manually preset up to 20 FM stations.

Tune in the desired station:

1. Press the **PROG** button on the remote control, the preset number will be displayed.
2. Press the Preset ▶/◀ buttons on the remote control or press the ◀◀/▶▶ buttons on the unit to select the preset number.
PRESET ▶/1 Increases the preset number by 1
PRESET ◀/1 Decreases the preset number by 1

Note: If you select more than 20, the preset number will automatically change to "1".

3. Press the **PROG** button again to store the station. The display will return to the broadcast frequency displayed.
4. Repeat the above steps 1 to 3 for each station you want to store in the memory with a preset number.

Note: If the unit is unplugged or if a power failure occurs, the preset stations will not be erased.

To change the FM Reception Mode

Press the **REPEAT** button to select the Stereo or Mono channel to receive the best FM reception mode.

FM Display Modes

Every time you press the **Display** button, the display will cycle through the following display modes:

Station Name, Programme Type, Date / Clock, Radio Text, Frequency.

The information is displayed on the lower segment of the display.

Station Name

When an RDS station is received, the name of that station will be displayed.

Programme Type

Programme type identification signal. (Example: News, Rock, Classical music.)

Date / Clock

The RDS CLOCK system may not properly operate in areas where RDS CLOCK service is not available. Once RDS CLOCK service is available, the RDS CLOCK system will commence operation.

Radio Text

This displays a station description.

Frequency

This shows the frequency of the current station, e.g. 89.80 MHz.

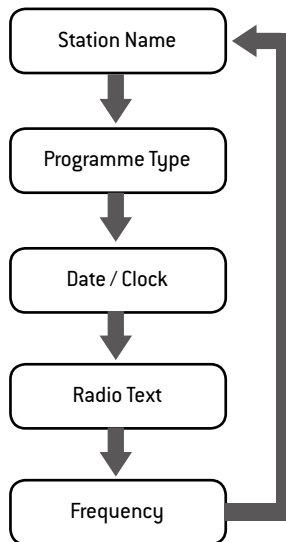

CD Operation

CD Playing

1. Repeatedly press the **SOURCE** button on the front panel of the unit or press the **CD** button on the remote control. "DISC" will be shown on the display.
2. Press the **▲** button on the unit to open the disc door and place the disc on the disc tray (with the printed side up).
3. Press the **K** button to close the disc door, the unit will read the disc and play it automatically.

Note: If in stop mode, please press the **▶||** button to start playing the disc.

4. Press the **▶||** button to pause the playing, press again to continue play.
5. Press the **■** button to stop the disc playing.

To Skip Search and Play

- Press the **▶|** button once or more to skip previous one or more tracks on the disc.
- Press the **|◀** button once or more to skip forward one or more tracks on the disc.

To Search

Press and hold the **◀◀** or **▶▶** button to search for the position that you intend to start playing.

Text Display During Playback

Press the **DISPLAY** button to select display information during play.

Programme Play

You can programme up to 20 tracks to play in any desired order. The unit must be in STOP mode only with a CD inserted.

1. Insert a disc and press the **■** button when it starts playing.
2. Press the **PROG** button, "001 P-01" will be displayed on the display.
3. Press the **▶|/|◀** buttons on the remote control to select the desired track number.
4. Press the **PROG** button to confirm the track number to be stored.
5. Repeat steps 3-4 to select and store all desired tracks.
6. Press the **▶||** button to start programme play.
7. Press the **■** button once to stop the programme play. Press the **■** button twice to clear the programme.

Note: Random play will not shuffle the programmed music list.

• Playing Repeatedly (CD)

- ONE, ALL repeat play can be set by pressing the REPEAT button.
- First press :To repeat the same track, "REP" will be displayed on the display.
- Second press :To repeat playing all tracks on a disc, "REP ALL" will be displayed on the display.
- Third Press :Returns to the normal playback state.

• Press the (RANDOM)

- First Press :To play tracks randomly, "SHUF" will be displayed on the display.
- Second Press: To cancel the repeat playing, "SHUF" will be disappeared on the display.

MP3/WMA Disc Playing

Note: MP3/WMA music playback from a CD maybe be affected due to the type and format of the disc or condition of the recording. If you are having trouble playing a certain disc, it is recommended to use the USB input instead for best MP3/WMA playback.

1. Press the **SOURCE** button on the unit or press the **CD** button on the remote control. "DISC" will be shown on the display.
2. Press the **▲** button to open the disc door and place the MP3/WMA disc on the disc tray.
3. Press the Display button on the remote control, ID3 information (song title and artist) will be displayed or "NO ID3" if there is no ID3 information. Press this button again, the title, artist, or album will be displayed if available.
4. When playing MP3/WMA discs, the current album and track will be displayed.
5. Press the **▶/◀** buttons to select the previous/next track. When pressing the **◀◀/▶▶** buttons for a few seconds, it will search backward or search forward.
6. Press the **ALBUM UP** button or **ALBUM DOWN** button on the remote control to select the next/previous album, and play the first track of this album. If the playing has ended, press the **ALBUM UP** button or **ALBUM DOWN** button on the remote control to select the next/previous album. Then choose the track with the **▶|** button or **|◀** button.
7. Press the **▶||** button to start playing the disc.
8. Press the **■** button to stop playback.

Note: Play will continue to the final track when the selected tracks have been played. The first 2 digits of the display is the album number, the next 3 digits is the track number and the remaining digits display the minutes and seconds.

Playing Repeatedly (MP3 disc)

- ONE, ALB and ALL repeat play can be set by pressing the **REPEAT** button.
- First press :To repeat the same track, "REP" will be displayed on the display.
- Second press :To repeat playing album, "REP ALB" will be displayed on the display.
- Third press :To repeat playing all tracks on a disc, the words "REP ALL" will be displayed on the display.
- Fourth Press :return to the normal playback state.

• Press the (RANDOM)

- First Press :To play tracks randomly, "SHUF" will be displayed on the display.
- Second Press: To cancel the repeat playing, "SHUF" will be disappeared on the display.

Using the USB

By connecting an USB mass storage device (including USB flash memory, USB flash players or memory cards) to this unit, you can enjoy the device's stored music through the unit.

1. Insert the USB device's USB plug into the  socket on the front of unit.
2. Press the USB button on remote control or press the **SOURCE** button on the main unit repeatedly to select the USB function. "USB" will be shown on the display.
3. The device's stored music will be played automatically.
4. When you store more than one folder in the USB flash, use the **ALBUM UP** button or **ALBUM DOWN** button on the remote control to select the next/previous folder. Then choose the track with the **▶|** or **◀|** buttons to play the folder.
5. The unit only supports MP3 and WMA music file formats.

For devices with USB Cables:

1. Insert one plug of the USB cable (not supplied) to the  socket on the unit.
2. Insert the other plug of the USB cable to the USB output terminal of the USB device.

For memory Cards:

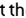
1. Insert the memory card into a card reader (not supplied).
2. Use a USB cable (not supplied) to connect the card reader to the  socket on the unit.

USB Storage Device Data Protection

- Always insert the USB device in the correct direction. Failure to do so may result in damage to the USB device and the unit.
- Do not remove the USB device while it is being accessed.
- Electrical interference and electrostatic discharges may cause the USB device to malfunction and suffer damage, resulting in data loss. It is strongly recommended that any important data is backed up on a PC to protect against corruption, data loss or device malfunction.

Note:

1. USB connection is not compatible with all hard drive models.

Charge your device

You can charge your device through the USB socket on this unit with a USB cable (not supplied).

- The maximum current for USB charging is 1A.
- All devices for USB charging are not guaranteed.

Playing from a Bluetooth device

With this unit, you can listen to audio files from a player via Bluetooth if the connection is available.

Pairing bluetooth-enabled devices

To connect your Bluetooth device to the unit, you need to pair the device to the unit. Pairing needs only to be done once.

Note:

- * The operational range between this unit and a Bluetooth device is approximately 8 metres.
- * Before you connect a Bluetooth device to this unit, familiarise yourself with the Bluetooth capabilities of the device.
- * Compatibility with all Bluetooth devices is not guaranteed.
- * Any obstacle between this unit and a Bluetooth device can reduce the operational range.
- * Keep this unit away from any other electronic device that may cause interference.

1. Press the  button on the remote control or press the SOURCE button repeatedly on the unit to select the Bluetooth mode
2. Turn on the Bluetooth function on your device.
3. Search for other Bluetooth devices with your device.
4. Select "MCB1536" in the pairing list.
5. Enter default password "0000" if necessary.
6. Press and hold the PAIR button more than 2 seconds to clear pairing history.

Note:

- The device will be disconnected if it is moved beyond the operation range.
- If you want to reconnect the device to the unit, place it within the operational range.
- The device will already be connected to the Bluetooth device. Other Bluetooth devices can be searched for connecting or pairing.
- When the unit is disconnected from the Bluetooth device, it will enter pairing mode automatically, and other Bluetooth devices can be searched for connecting or pairing.

Listening to music from a Bluetooth device

If the connected Bluetooth device supports Advanced Audio Distribution Profile (A2DP), you can listen to the music stored on the device through the unit.

1. Pair the device with the unit.
2. Start playing music via device.

Playing music from an external device

You can listen to an audio device through this unit.

1. Make sure that the external audio device is connected to the unit.
2. Press the AUX/BT button to select the audio input through the AUX IN (L and R) sockets.
3. Start to play the device (see the device's user manual). If you are having a problem with your unit, check this list for a possible solution before calling for the service.

Setting the Daily on Timer

You can use the setting timer to make the unit automatically turn on at a certain time everyday from standby. When the setting timer is on, the timer indicator "⌚" will be displayed. The clock must be correctly set for the timer to operate correctly.

1. In standby mode, press and hold the timer button **[TIMER]** on the remote control, until [TIMER SET] scrolls on the display.
- Then the source is displayed, e.g. DISC.
2. Press the **FM**, or **DISC**, or **USB** button or **VOL+/-** button to select a source.
3. Press the **TIMER** button, the hour indicator will blink.
4. Set the hour with the **VOL+/-** button.
5. Press the **TIMER** button, the minute indicator will blink.
6. Set the minute with the **VOL+/-** button.
7. Press the **TIMER** button, the volume indicator will blink.
8. Adjust volume with the **VOL+/-** button.
9. Press the **TIMER** button, the timer is set and activated, and "⌚" is displayed.

To deactivate or re-activate an alarm timer

In standby mode, press the **TIMER** button to activate or deactivate the timer.

- If the timer is activated, "⌚" will be displayed on the display.
- If the timer is deactivated, "⌚" will disappear on the display.

Caution:

*If disc/USB source is selected and the audio cannot be played, TUNER is automatically activated.

Set sleep timer

This unit can switch to clock mode automatically after a set period of time.

1. When the unit is turned on, press the **SLEEP** button repeatedly to select a preset period (in minutes).

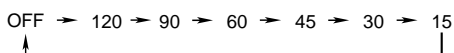

When the sleep timer is activated, SLEEP icon "zzZ" is displayed.

- * To deactivate the sleep timer, press the **SLEEP** button repeatedly until **[OFF]** (sleep off) is displayed.

Disc Handling

Handling Precautions

- Hold the disc by the edges so the surface will not be soiled with fingerprints. (A)
Fingerprints, dirt and scratches can cause skipping and distortion.
- Do not write on the label side with a ball-point pen or other writing implements.
- Do not use record cleaning sprays, benzine, thinner, static electricity prevention liquids or any other solvent.
- Be careful not to drop or bend the disc.
- Do not install more than 1 disc on the disc tray.
- Do not try to close the disc tray when the disc is not installed properly.
- Be sure to store the disc in its exclusive case when not in use.

If the surface is soiled (B)

- Wipe gently with a soft, damp (water only) cloth.
- When wiping discs, always move the cloth from the center hole toward the outer edge.
(If you wipe the discs using a circular motion, circular scratches are likely to occur, which will cause noise.)
- If the disc is brought from a cold to a warm environment, moisture may form on the disc. Wipe the moisture off with a soft, dry, lint-free cloth before using the disc.

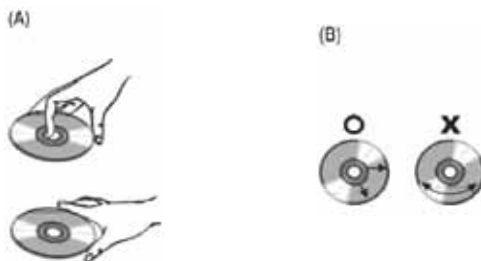

Improper disc storage

You can damage discs if you store them in the following places:

- Areas exposed to direct sunlight.
- Humid or dusty areas.
- Areas directly exposed to a heat outlet or heating appliance.

Troubleshooting

If you are having a problem with your unit, check this list for a possible solution before calling for service.

If you cannot solve the problem from the hints given here, or the unit has been physically damaged, call a qualified person, such as your dealer, for service.

Symptom	Possible Cause	Action
No sound is heard	Connections are incorrect, or loose	Check all connections and make corrections
Poor radio reception	The Antenna is disconnected The Antenna is not properly extended and positioned	Reconnect the Antenna securely and reposition it to the best reception position
The disc skips	The disc is dirty or scratched	Clean or replace the disc
The disc does not play	The disc is upside down The disc is dirty	Put the disc in with the label side up Remove disc from player, wipe with a clean cloth and re-insert.
Unable to operate the remote control	The path between the remote control and the sensor on the unit is blocked The batteries have lost their charge	Remove the obstruction Replace the batteries
Operations are disabled	The built-in microprocessor has malfunctioned due to external electrical interference	Unplug the unit then plug it back in
The Bluetooth device cannot play	The audio quality is poor after connection. The Bluetooth reception is poor	Move the device closer to the unit or remove any obstacle between the device and the unit
The Bluetooth cannot connect with the unit	The device does not support the profiles required for the unit. The Bluetooth function of the device is not enabled. The unit is not in the pairing mode. The unit is already connected with another Bluetooth-enabled device.	Refer to the user manual of the device for how to enable the function Disconnect that device or all other connected devices and then try again.

Specifications

Power Requirements	:	100-240V ~ 50/60Hz
FM Tuning Range	:	87.5~108 MHz
Power Consumption	:	28W (ECO Standby \leq 0.5W)
USB port	:	5V $\overline{=}$ 1A
Output Power	:	35W x 2
THD	:	\leq 1%
Dimensions	:	W200 XH120 X D 250 MM

Speaker Specification

Impedance	:	6 Ω
Input Power	:	35W
Dimensions	:	W140 XH232 X D 158 MM

Bluetooth Specification

Communication system	:	Bluetooth Standard version 4.0 and EDR specification
Output	:	Bluetooth Standard Power Class 2
Maximum communication Range	:	approx. 10m
Frequency band	:	2.4 GHz Band (2.4000 GHz - 2.4835 GHz)
Compatible Bluetooth profiles	:	Advanced Audio Distribution Profile (A2DP)
Supported Multi devices pairing	:	up to 8 devices
Supported codecs (Receive)	:	SBC (Sub Band Codec)
(Transmit)	:	SBC (Sub Band Codec)

Note: Product information is subject to change without prior notice.

Notes for battery disposal

The batteries used with this product contain chemicals that are harmful to the environment. To preserve our environment, dispose of used batteries according to your local laws or regulations. Do not dispose of batteries with normal household waste.



This symbol on the product or in the instructions means that your electrical and electronic equipment should be disposed at the end of its life separately from your household waste.

There are separate collection systems for recycling in the in EU.

For more information, please contact the local authority or your retailer where you purchased the product.

We continually strive to improve our products, specifications may change without prior notice. For advice on where to purchase accessories, please contact the store where you purchased your equipment.

Imported and Exclusively marketed by:

Expert AS

PO Box 43,

N-1483 Hagan

Customer helpline number Norge: 815 48 100

Customer helpline number Finland: 020 7100 670

Customer helpline number Danmark +45 70 70 17 07

Email Norge: kundesenter@expert.no

Email Finland: asiakaspalvelu@expert.fi

Email Danmark: kundeservice@expert.dk