



Instruction Manual

MCB1533

Bluetooth CD Micro system

机图后补

Table of Contents

Safety Warnings	3
Battery Safety Guidelines	6
Pack Contents	7
Product Overview	8
Remote Control Overview	9
Installation of Battery	10
Handling the Remote Control	10
Remote Control Operation Range	11
Connections	12
Connecting the Speakers	13
Connect to the FM Antenna	13
Connecting Auxiliary Equipment	13
Connecting the AC Adaptor	14
ECO-Power/Standby Features	14
Switching ON / OFF	14
Switching the system to ECO Power/Standby mode	14
Setting the Clock	14
Setting the Clock Manually	14
Setting the Clock Automatically	15
Display the Clock	15
Sound Quality	15
Adjusting the Volume	15
Adjusting the Super Bass	15
Controlling the Loudness	15
Presetting Equalizer	15
Changing the Front Panel Darkness	15
Listening to Radio Broadcasts	16
Tuning in to a Station	16
Program radio stations	16
To change the FM Reception Mode	16
RDS (Radio Data System) Reception	17
CD Operation	17
CD Playing	17
To Skip Search and Play	17
To Search	17
Text Display During Playback	18

Programme Play	18
Playing the Beginning (Intro) of each Track.....	18
Playing Repeatedly (CD disc).....	18
MP3/WMA Disc Playing.....	19
Text Display During Playback	19
To Skip Search or Search and Play.....	19
To Select Album	19
Playing Repeatedly (MP3 disc).....	19
Use the USB	20
Play from Bluetooth device.....	21
Setting the Sleep Timer	21
Setting the Daily on Timer	22
Specifications	22
Disc Handling	23
Handling Precautions.....	23
If the surface is soiled (B).....	23
Improper disc storage.....	23
Troubleshooting	24

Safety Warnings

- Read all the instructions carefully before using the unit and keep them for future reference.
- Retain the manual. If you pass the unit onto a third party make sure to include this manual.
- Check that the voltage marked on the rating label matches your mains voltage.
- The marking information is located at the bottom of apparatus.
- Use only with the cart, stand, tripod, bracket, or table specified by the manufacturer, or sold with the apparatus. When a cart is used, use caution when moving the cart/apparatus combination to avoid injury from tip-over.

Damage

- Please inspect the unit for damage after unpacking.
- Do not continue to operate the unit if you are in any doubt about it working normally, or if it is damaged in any way - switch off, withdraw the mains plug and consult your dealer.

Location of Unit

- The unit must be placed on a flat stable surface and should not be subjected to vibrations.
- Do not place the unit on sloped or unstable surfaces as the unit may fall off or tip over.
- The mains socket must be located near the unit and should be easily accessible.

Temperature

- Avoid extreme degrees of temperature, either hot or cold. Place the unit well away from heat sources such as radiators or gas/electric fires.
- Avoid exposure to direct sunlight and other sources of heat.

Naked Flames

- Never place any type of candle or naked flame on the top of or near the unit.

Moisture

- To reduce the risk of fire, electric shock or product damage, do not expose this unit to rain, moisture, dripping or splashing. No objects filled with liquids, such as vases, should be placed on the unit.
- If you spill any liquid into the unit, it can cause serious damages. Switch it off at the mains immediately. Withdraw the mains plug and consult your dealer.

Ventilation

- To prevent the risk of electric shock or fire hazard due to overheating, ensure that curtains and other materials do not obstruct the ventilation vents.
- A minimum distance of 5cm around the unit should be maintained to allow for sufficient ventilation.
- Do not install or place this unit in a bookcase, built-in cabinet or in another confined space. Ensure the unit is well ventilated.

Safety

- Always disconnect the unit from the mains supply before connecting/disconnecting other devices or moving the unit.
- Unplug the unit from the mains socket before a lightning storm.
- In the interests of safety and to avoid unnecessary energy consumption, never leave the unit switched on while unattended for long periods of time, e.g. overnight, while on holiday or while out of the house. Switch it off and disconnect the mains plug from the mains socket.

Mains Adapter Cable

- Make sure the unit or the unit stand is not resting on top of the mains adapter cable, as the weight of the unit may damage the cable and create a safety hazard.
- Where the plug of the Direct Plug-in Adapter coupler is used as the disconnect device, the disconnect device shall remain readily operable.

Mains Adapter

- Unplug this apparatus during lightning storms or when unused for long periods of time.

Interference

- Do not place the unit on or near appliances which may cause electromagnetic interference. If you do, it may adversely affect the operating performance of the unit, and cause a distorted picture or sound.

Batteries

- Batteries used in the remote control for this unit are easily swallowed by young children and this is dangerous.
- Keep loose batteries away from young children and make sure that the battery holder tray is secure in the remote control. Seek medical advice if you believe a cell has been swallowed.
- Please dispose of batteries correctly by following the guidance in this manual.
- Batteries (battery pack or batteries installed) shall not be exposed to excessive heat such as sunshine, fire or the like.

Supervision

- Children should be supervised to ensure that they do not play with the unit.
- Never let anyone especially children push anything into the holes, slots or any other openings in the case - this could result in a fatal electric shock.

Service

- To reduce the risk of electric shock, do not remove screws. The unit does not contain any user-serviceable parts. Please leave all maintenance work to qualified personnel.
- Do not open any fixed covers as this may expose dangerous voltages.

Maintenance

- Ensure the unit is fully unplugged from the power supply before cleaning.
- Do not use any type of abrasive pad or abrasive cleaning solutions as these may damage the unit's surface.
- Do not use liquids to clean the unit.

FCC NOTE:

This equipment has been tested and found to comply with the limits for a Class B digital device, pursuant to Part 15 of the FCC Rules. These limits are designed to provide reasonable protection against harmful interference in a residential installation. This equipment generates uses and can radiate radio frequency energy and, if not installed and used in accordance with the instructions, may cause harmful interference to radio communications. However, there is no guarantee that interference will not occur in a particular installation. If this equipment does cause harmful interference to radio or television reception, which can be determined by turning the equipment off and on, the user is encouraged to try to correct the interference by one of the following measures:

- Reorient or relocate the receiving antenna.
- Increase the separation between the equipment and receiver.

- Connect the equipment into an outlet on a circuit different from that to which the receiver is connected.
- Consult the dealer or an experienced radio/TV technician for help.

This device complies with Part 15 of the FCC Rules. Operation is subject to the following two conditions: (1) This device may not cause harmful interference, and (2) this device must accept any interference received, including interference that may cause undesired operation.

Warning:

Any changes or modifications not expressly approved by the party responsible for compliance could void the user's authority to operate this equipment.

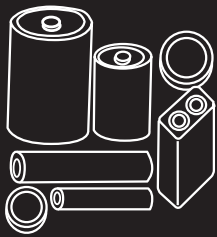

BATTERY SAFETY GUIDELINES

Used correctly, domestic batteries are a safe and dependable source of portable power. Problems can occur if they are misused or abused — resulting in leakage or, in extreme cases, fire or explosion.

Here are some simple guidelines to safe battery use designed to eliminate any such problems.



Take care to fit your batteries correctly, observing the plus and minus marks on the battery and appliance. Incorrect fitting can cause leakage or, in extreme cases, fire or even an explosion.

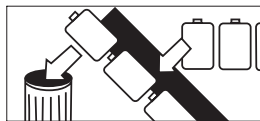

Replace the whole set of batteries at one time, taking care not to mix old and new batteries or batteries of different types, since this can result in leakage or, in extreme cases, fire or even an explosion.



Store unused batteries in their packaging and away from metal objects which may cause a short-circuit resulting in leakage or, in extreme cases, fire or even an explosion.



Remove dead batteries from equipment and all batteries from equipment you know you are not going to use for a long time. Otherwise the batteries may leak and cause damage.

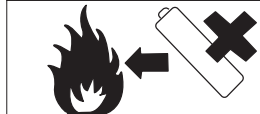

Never dispose of batteries in fire as this can cause them to explode. Please recycle dead batteries; do not put with the normal household waste.



Never attempt to recharge ordinary batteries, either in a charger or by applying heat to them. They may leak, cause fire or even explode. There are special rechargeable batteries which are clearly marked as such.



Supervise children if they are replacing batteries themselves in order to ensure these guidelines are followed.



Remember that small button cell batteries such as used in some hearing aids, toys, games and other appliances, are easily swallowed by young children and this can be dangerous.



Keep loose button cells away from young children.



Make sure battery compartments are secure.

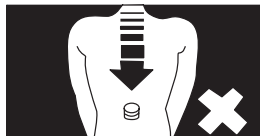

Seek medical advice if you believe a cell has been swallowed.

Pack Contents

Make sure all of the following contents are included.

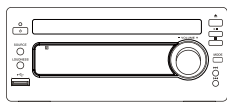

The Unit

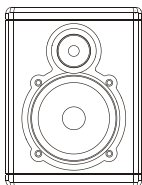

Speakers x 2



Remote Control
(battery included)

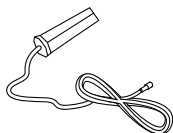

FM Antenna

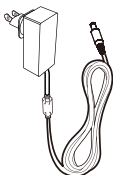

AC Adaptor

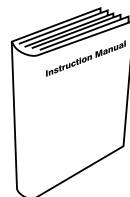

Instruction Manual

Product Overview

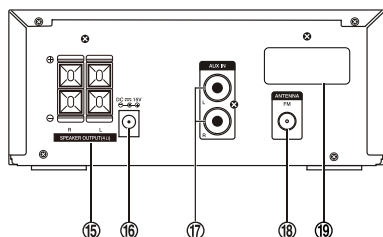
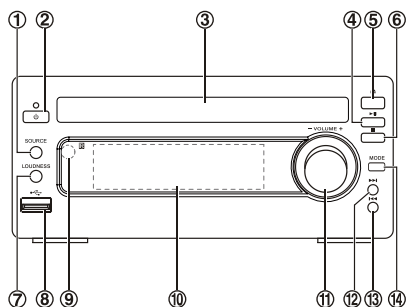

1. Source Button (**SOURCE**)
2. Standby Button (⏻)
3. Disc Tray
4. Play/Pause Button (▶||)
5. Tuning Forward Button (▶|||)
5. Open/Close Button(⏏)
6. Stop Button(■)
6. Tuning Backward Button (◀■)
7. Loudness Button (**LOUDNESS**)
8. USB Jack (🔌)
9. Remote Sensor
10. LCD Display Lens
11. Volume Control Knob (- **VOLUME** +)
12. Next Button (▶▶|)
12. Preset Up Button (▶▶|)
13. Previous Button (◀◀|)
13. Preset Down Button (◀◀|)
14. Mode Button (**MODE**)
15. Speaker Output Terminals (L&R)
16. DC Jack
17. AUX Input Terminals (L&R) (AUX IN)
18. FM Antenna Socket
19. Bluetooth Antenna

Remote Control Overview

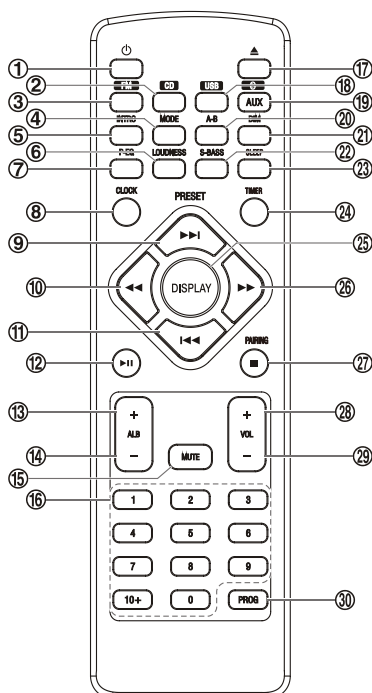

1. Standby Button (ψ)
2. CD Function Button (**CD**)
3. Tuner Function Button (**FM**)
4. Mode Button (**MODE**)
Stereo/mono Select Button (**MODE**)
5. Intro Button (**INTRO**)
6. Loudness Button (**LOUDNESS**)
7. Preset Equalizer Button (**P-EQ**)
8. Clock Button (**CLOCK**)
9. Next Button (**►►I**)
Preset Up Button (**PRESET +**)
10. Search Backward Button (**◀◀**)
Tuning Backward Button (**◀◀**)
11. Previous Button (**I◀◀**)
Preset Down Button (**PRESET -**)
12. Play/Pause Button (**►► II**)
13. Album Up Button (**ALB +**)
14. Album Down Button (**ALB -**)
15. Mute Button (**MUTE**)
16. Number Button (**0-9, 10+**)
17. Open/Close Button (**▲**)
18. USB Function Button (**USB**)
19. Bluetooth Function Button (**BT**)
AUX Function Button (**AUX**)
20. Repeat A-B Button (**A-B**)
21. Dimmer Button (**DIM**)
22. Super Bass Button (**S-BASS**)
23. Sleep Button (**SLEEP**)
24. Timer Button (**TIMER**)
25. CD Display Button (**DISPLAY**)
RDS Display Button (**DISPLAY**)
26. Search Forward Button (**►►**)
Tuning Forward Button (**►►**)
27. Stop Button (**■**)
Pairing Cleared Button (**PAIRING**)
28. Volume Up Button (**VOL +**)
29. Volume Down Button (**VOL -**)
30. Program Button (**PROG**)
Memory Button (**PROG**)

Installation of Battery

1. Remove the insulating mylar strip from the battery. It is located at the bottom back side of the remote control.

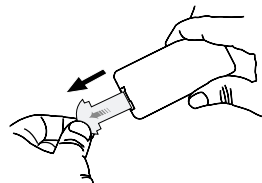

2. Loosen the screw on the battery compartment cover with a screwdriver. Pull out the battery compartment with your fingernails.

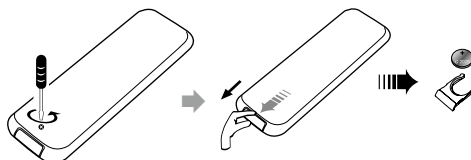

3. Replace a new battery (size 2025) correctly and fully insert the battery compartment back to the original position. Tighten the screw with a screwdriver.

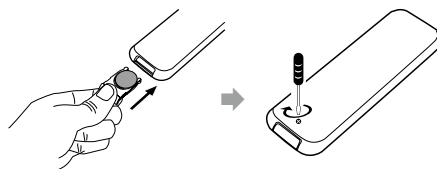

Handling the Remote Control

- Remove the batteries if the remote control is not going to be used for an extended period of time.
- To avoid possible failure, read the following instructions and handle the remote control properly.
- Do not drop or cause impact to the remote control.
- Do not spill water or any liquid on the remote control.
- Do not place the remote control on a wet object.
- Do not place the remote control under the direct sunlight or near sources of excessive heat.
- Do not use caustic cleaners (porcelain, stainless steel, toilet, or oven cleaner etc.) on the remote, as it may suffer damage.

Note:

Remove the battery from remote control handset when it is not to be used for a long period. Otherwise it can be damaged due to leakage of battery.

Remote Control Operation Range

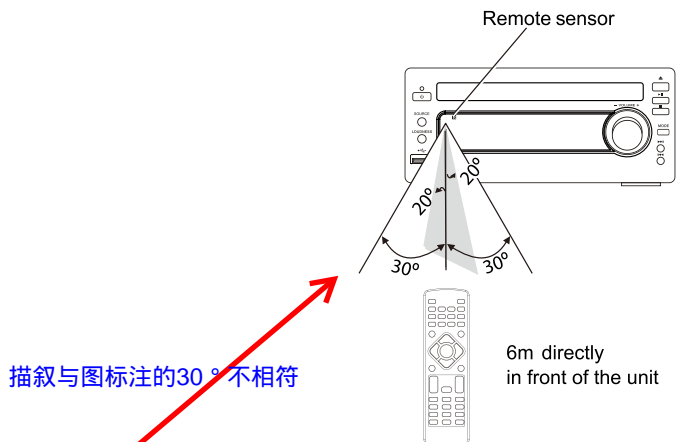

Point the remote control to the unit no more than 6 meters from the remote control sensor and within 60° horizontally and 40° vertically of the front of the unit. The operating distance may vary according to the brightness of the room.

Note:

- Make sure that there is no obstacle between the infrared remote sensor of the unit and remote control. If you install the unit on rack, etc., the remote controllable range may decrease depending on the thickness or colour of glass door of rack.
- Do not expose the infrared remote sensor to direct sunlight or other strong light, such as inverter fluorescent light.

Connections

Caution: Make all connections before plugging the unit into the AC Power outlet.

Please read these additional installation notes before use.

If the following steps are not followed correctly the unit may become damaged.

Please note the correct steps for setting up the unit are as follows:

1. The speaker wires between CD player and speaker are to be connected first.
2. After the above cables are correctly connected, the AC power cord can then be connected to power outlet.

Caution:

- i) Reversing the steps by connecting the AC power cord first will cause malfunction of the unit.
- ii) During operation, if the control cable requires to be reconnected, the AC power supply must be disconnected first. Otherwise, damage to the unit may be caused.

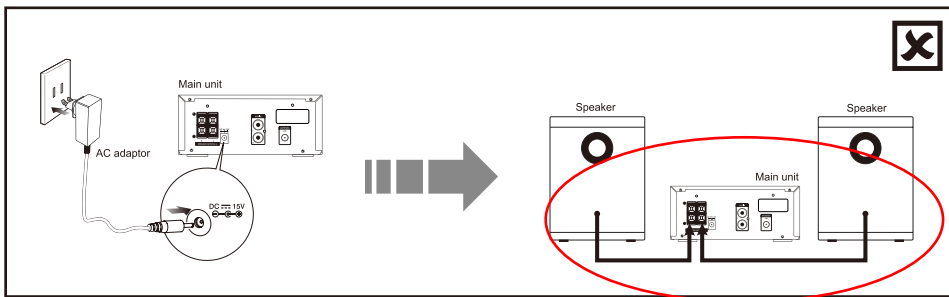
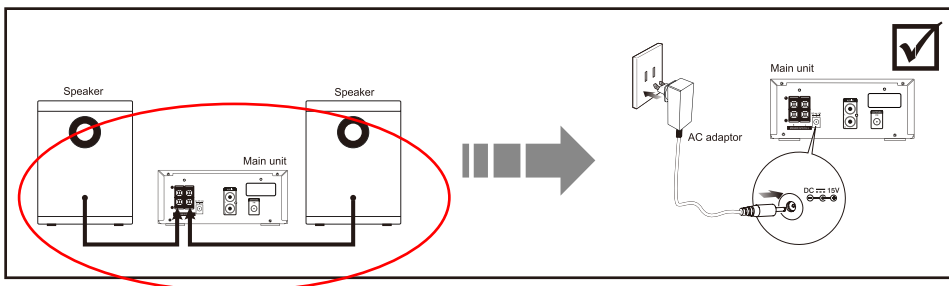

Connecting the Speakers

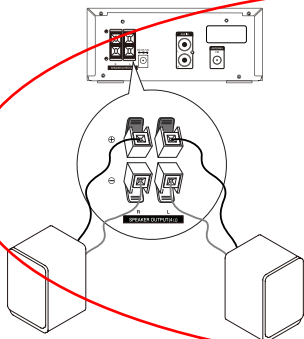

Connect the cable with a black head to the (-) terminals and cable with a red head to the (+) terminals.

Connect to the FM Antenna

1. Connect the supplied FM Antenna to the FM Antenna socket on the rear of the unit.

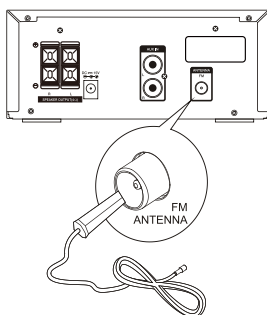

2. If reception is poor, connect the outside antenna.

Note: Before attaching a 75 ohm **coaxial lead** (the kind with a round wire going to an outside antenna), disconnect the supplied FM wire antenna.

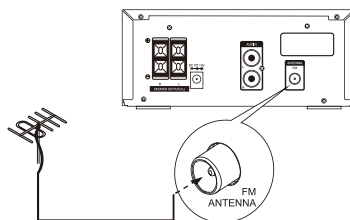

Caution:

To avoid noise, keep antennas away from the system, the connecting cord and the AC power cord.

Connecting Auxiliary Equipment

Connect the AUX Input terminals on the rear of the unit to the line output terminals on the auxiliary equipment with an audio cable (not supplied) illustrated below.

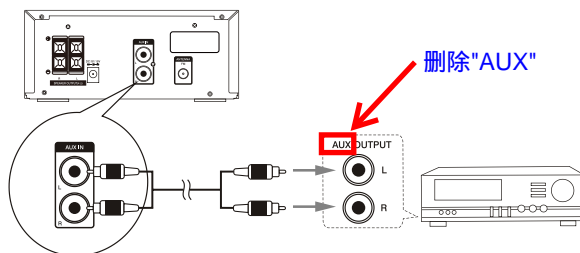

Connecting the AC Adaptor

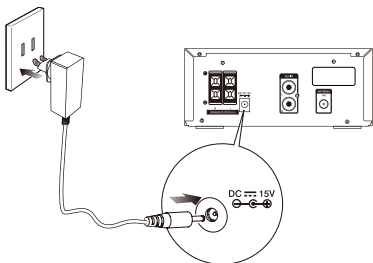

Insert the AC adapter cord into unit and other side into a wall outlet, then your unit is ready to use.

Caution:

- * Be sure to unplug the AC adapter plug from the outlet when going out or when the unit is not in use for an extended period of time.

ECO-Power/Standby Features

Switching ON / OFF

When you first connect the unit to the DC Jack, the unit will be in standby mode.

- Press the standby \cup button to switch the unit on. The word "HELLO" will show in the display.
- Press the standby \cup button to switch the unit back to standby mode. The words "BYE BYE" will scroll across the display.

Switching the system to ECO Power/Standby mode

Press and hold the standby \cup button for 2 seconds or more to switch to ECO Power Standby or normal standby.

* ECO Power standby mode

The clock will not be displayed. Press the **CLOCK** button to display the clock on the LCD.

* Normal standby mode

The clock display on the LCD.

Setting the Clock

Setting the Clock Manually

Caution: You can set the clock in standby mode only.

1. In standby mode, press and hold the **CLOCK** button, the VFD will display CLOCK SET and CLOCK 12 begins to blink.
2. Set the 12/24 hour format with the **VOL-** or **VOL+** button.
3. Press the **CLOCK** button, hour indicator will blink.
4. Set the hour with the **VOL-** or **VOL+** button.
5. Press the **CLOCK** button, minute indicator will blink.
6. Set the minute with the **VOL-** or **VOL+** button.
7. Press the **CLOCK** button, the built-in clock starts operating.

Note:

- To exit clock setting mode without storing, press the \blacksquare button.
- If no button is pressed in 90 seconds, the unit exits clock setting mode automatically.

- If a power failure occurs or the unit is disconnected from the mains, the clock setting will be lost.

Setting the Clock Automatically

Tune into a RDS station, press and hold the **DISPLAY** button. The clock will automatically update.

Display the Clock

In any source mode, the built-in clock shows the time on the display by press the **CLOCK** button.

Sound Quality

Adjusting the Volume

To increase or decrease the volume, rotate the - **VOLUME +** knob on the unit or press the **VOL +/-** buttons on the remote control.

Adjusting the Super Bass

You can reinforce the bass sound to maintain rich, full bass at low volume.

Press the **S-BASS** button on the remote control to get the effect, the “**BBB**” will lit on the front panel. Press the **S-BASS** button again to cancel the effect.

Controlling the Loudness

This unit has a loudness function, which can automatically increase the bass sound effect at low volume. It can also increase the bass sound effect at high volume, but it will be relatively less when it is at high volume. Press the **LOUDNESS** button to obtain the loudness function, the “” will display on the front panel, press again will disappear.

Presetting Equalizer

You can adjust the sound reproduced simply by choosing from 5 preset equalizers.

During play, press the **P-EQ** button on the remote control repeatedly to select:

- [FLAT] (FLAT)
- [POP] (pop)
- [JAZZ] (jazz)
- [ROCK] (rock)
- [CLASSIC] (classic)

Changing the Front Panel Darkness

This unit has three brightness levels for you to adjust the clock display. Press the **DIM** button on the front panel or the remote control repeatedly to choose the desired brightness.

主机面板上无此按钮

Listening to Radio Broadcasts

Caution: Before listening to the radio, please check that the FM Antenna is correctly connected and adjusted for length and direction.

Tuning in to a Station [Source](#)

1. Repeatedly press the **FUNCTION** button on the unit or directly press the **FM** button on the remote control to select tuner source.
 - The word "TUNER" will be displayed on the front panel.
2. Select a station using one of the following methods.
 - ♦ **Auto Tuning**
Press and hold the **■/▶||** button on the unit or **◀◀/▶▶** button on the remote control for one second or more, the frequency changes down or up automatically until a station is found.
 - ♦ **Manual Tuning**
Repeatedly press the **■/▶||** button on the unit or **◀◀/▶▶** button on the remote control to change the frequency until you find the station you want.
 - ♦ **Preset Tuning (Available only after the stations are preset)**
Repeatedly press the **◀◀/▶▶|** button to select the desired preset number. Its band and frequency are displayed on the front panel.

Program radio stations

You can program a maximum of 20 preset radio stations (FM).

- ♦ **Automatically**
Press and hold the **PROG** button on the remote control for two second or more to activate automatic program mode.
 - [AUTO] is displayed.
 - All available stations are programmed.
 - The first programmed radio station is broadcast automatically.
- ♦ **Manually**
 1. Tune to a radio station.
 2. Press the **PROG** button on the remote control to activate program mode.
 - The preset number will blink.
 3. Press the **◀◀/▶▶|** button to allocate a number to this radio station.
Note: If you select more than 20, the preset number will be changed to "1" automatically.
 4. Press the **PROG** button on the remote control again to store the station.
 5. Repeat above steps 1 to 4 for each station you want to store in memory with a preset number.

Note: If the system is unplugged or if a power failure occurs, the preset stations will not be erased.

To change the FM Reception Mode

Press the **MODE** button on the remote control to select the Stereo or Mono channel to receive the best FM reception mode.

RDS (Radio Data System) Reception

Many FM stations are broadcasting added data compatible with RDS (Radio Data System). This radio set offers convenient functions using such data.

Press the **DISPLAY** button on the remote control repeatedly to select the information that displayed as follows.

- **Station Name**

When an RDS station is received, the "RDS" and the name of that station will be displayed.

- **PTY (Programme Type)**

This describes the "Style" or "genre" of music that is being broadcast e.g. "Rock" or "Classical".

- **Time**

The broadcaster (Radio station) provides clock and date information automatically so there's no need to manually set this information.

- **Text**

The broadcaster can include a scrolling text that displays information about the current program.

- **Frequency**

This shows the frequency of the current station e.g. 95.30MHz.

CD Operation

CD Playing

1. Repeatedly press the **FUNCTION** button on the unit or directly press the CD function button (**CD**) on the remote control to select the disc source.
 - The word "DISC" will be displayed on the front panel.
2. Press the **▲** button to open the disc door and place the disc on the disc tray (with the printed side up).
3. Press the **▲** button to close the disc door, the unit will read the disc and play it automatically.
Note: If in stop mode, please press the **▶||** button to start playing the disc.
4. Press the **▶||** button to temporarily stop the playing, press the button again, it will continue to play.
5. Press the **■** button to stop the disc playing.

To Skip Search and Play

- Press the **◀◀** button once or more to skip previous one or more tracks on the disc.
- Press the **▶▶** button once or more to skip forward one or more tracks on the disc.

To Search

Press and hold the **◀◀** or **▶▶** button on the remote control to search for the position that you intend to start playing.

Text Display During Playback

Repeatedly press the **DISPLAY** button on the remote control to show the current track number and single remain time, the current track number and single elapsed time or total track number and total remain time .

Programme Play

You can programme up to 20 tracks to play in any desired order. The player must be in stop mode only with a CD inserted.

1. Insert a disc and press the **■** button when it starts playing.
2. Press the **PROG** button on the remote control, the VFD will display "O1 P-- O1" and "PROG" begins to blink.
3. Press the **0-9, +10** buttons on the remote control to select the desired track number.
4. Press the **PROG** button on the remote control to confirm the track number to be stored.
5. Repeat steps 3-4 to select and store all desired tracks.
6. Press the **▶ ||** button to start programme play.
7. Press the **■** button once to stop the programme play. Press the **■** button twice to clear programme.

Playing the Beginning (Intro) of each Track

Press the **INTRO** button on the remote control to play the beginning of each track consecutively. The playing time of each track is 10 seconds.

When you hear the desired track, press the **▶ ||** button twice.

Playing Repeatedly (CD disc)

- ♦ ONE and ALL Repeat Play can be set by pressing the **MODE** button.
 - First press : To repeat the same track, the words "**TRK**" and "**REP**" will blink.
 - Second press : To repeat playing all tracks on a disc, the words "**TRK**" will stay lit and "**REP ALL**" will blink.
 - Third press : To play tracks randomly, the words "**TRK**" will stay lit and "**SHUF**" will blink.
 - Fourth press : To cancel the repeat playing, the word "**SHUF**" will disappear.
- ♦ Repeat A-B can be set by pressing the **A-B** button.
 - First press : Select the start point, the words "**A-**" will stay lit.
 - Second press : Select the end point, the words "**A-B**" will stay lit.
 - Third press : To cancel repeat play, the word "**A-B**" will disappear.

Note: The section A and B can be set only within the same track.

MP3/WMA Disc Playing

Note:

* MP3/WMA music playback from CD maybe be affected due to the type and format of disc or condition of the recording. If you are having trouble playing a certain disc, it is recommended to use USB input instead for best MP3/WMA playback.

1. Repeatedly press the **FUNCTION** button on the unit or directly press the **CD** button on the remote control to select the disc source.
 - The word "DISC" will be displayed on the front panel.
2. Press the **▲** button to open the disc door and place the MP3/WMA disc on the disc tray (with the printed side up).
3. Press the **▲** button to close the disc door, the unit will read the disc and play it automatically.
Note: If in stop mode, please press the **▶||** button to start playing the disc.
4. Press the **▶||** button to temporarily stop the playing, press the button again, it will continue to play.
5. Press the **■** button to stop the disc playing.

Text Display During Playback

Press the **DISPLAY** button on the remote control, ID3 information (song title and artist) will be displayed or "NO TTL / NO ALB / NO ART" if there is no ID3 information. Press this button again, album, track and playing time will be displayed.

To Skip Search or Search and Play

- Press the **◀◀/▶▶** button to select the previous/next track.
- Press and hold the **◀◀/▶▶** button on the remote control to search for the position that you intend to start playing.

To Select Album

- Press the **ALB+/-** button on the remote control to select the next/previous album, and play the first track of this album.
- If the playing has ended, press the **ALB+/-** button on the remote control to select the next/previous album.

Playing Repeatedly (MP3 disc)

- ♦ ONE and ALL Repeat Play can be set by pressing the **MODE** button.
 - First press : To repeat the same track, the words "**TRK**" and "**REP**" will blink.
 - Second press : To repeat playing album, the words "**TRK**" will stay lit and "**REP ALB**" will blink.
 - Third press : To repeat playing all tracks on a disc, the words "**TRK**" will stay lit and "**REP ALL**" will blink.
 - Fourth press : To play tracks randomly, the words "**TRK**" will stay lit and "**SHUF**" will blink.
 - Fifth press : To cancel the repeat playing, the word "**SHUF**" will disappear.

- ◆ Repeat A-B can be set by pressing the **A-B** button.
 - First press : Select the start point, the words “**A-**” will stay lit.
 - Second press : Select the end point, the words “**A-B**” will stay lit.
 - Third press : To cancel repeat play, the word “**A-B**” will disappear.

Note: The section A and B can be set only within the same track.

Use the USB

Caution:

Do not use a high-capacity USB hard disks. Only USB flash memory can be used.

By connecting an USB mass storage device (including USB flash memory, USB flash players or memory cards) to this unit, you can enjoy the device's stored music through the unit.

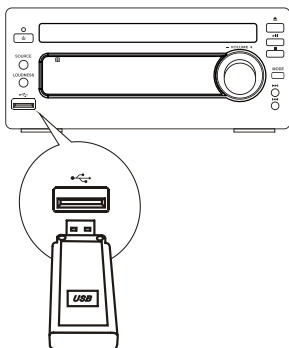

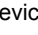
1. Insert the USB device's USB plug into the  socket on the unit.
2. Repeatedly press the **FUNCTION** button on the unit or directly press the **USB** button on the remote control to select the USB source.
 - The word “USB” will be displayed on the front panel.
3. The device's stored music will be played automatically.
4. When you store more than one folder in the USB flash, use the **ALB+/-** button on the remote control to select the next/previous folder. Then choose the track with the **◀◀/▶▶** button to play the folder.
5. The player support the USB music file format of MP3, WMA only.

For devices with USB Cables:

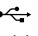
1. Insert one plug of the USB cable (not supplied) to the  socket on the unit.
2. Insert the other plug of the USB cable to the USB output terminal of the USB device.

For memory Cards:

1. Insert the memory card into a card reader (not supplied).
2. Use a USB cable (not supplied) to connect the card reader into the  socket on the unit.

Play from Bluetooth device

The unit has a Bluetooth function that can receive a signal within 10 metres.

Pairing the unit with a Bluetooth device to listen to music:

1. Repeatedly press the **FUNCTION** button on the unit or directly press the **9** button on the remote control to select the bluetooth source.
 - The word "BT" will be displayed on the front panel.
2. Activate your Bluetooth device and select the search mode.
3. "MCB1533" will appear on your Bluetooth device.
4. Select "MCB1533" and enter "0000" for the password if necessary.
5. To disconnect the Bluetooth function, press and hold the **PAIRING** button on the remote control or disable the function from your Bluetooth device.

Note:

- If the signal strength is weak, your Bluetooth receiver may disconnect, but it will re-enter pairing mode automatically.
- This unit supports A2DP (Advanced Audio Distribution Profile).

Setting the Sleep Timer

Use the sleep timer to turn the unit off after a certain number of minutes when in play mode. By setting the sleep timer, you can fall asleep to music and know that your unit will turn off by itself rather than play all night.

- ♦ When the unit is turned on, press **SLEEP** button repeatedly to select a set period of time (in minutes):
 - [SLEEP 120]
 - [SLEEP 90]
 - [SLEEP 60]
 - [SLEEP 45]
 - [SLEEP 30]
 - [SLEEP 15]

When sleep timer is activated, the "zZ" is displayed.

To deactivate sleep timer

Press the **SLEEP** button repeatedly until [SLEEP OFF] is displayed.

When sleep timer is deactivated, the "zZ" is disappears.

Setting the Daily on Timer

You can use the setting timer to make the unit automatically turn on at a certain time everyday from standby. When the setting timer is on, the timer indicator "⌚" will be displayed. But the clock must be correctly set for the timer to operate correctly.

1. In standby mode, press and hold the **TIMER** button on the remote control, until [TIMER SET] scrolls on the display.
 - Then the source is displayed, e.g. DISC.
2. Press the **FM**, or **CD**, or **USB** button or **VOL+/-** button to select a source.
3. Press the **TIMER** button, the hour indicator will blink.
4. Set the hour with the **VOL+/-** button.
5. Press the **TIMER** button, the minute indicator will blink.
6. Set the minute with the **VOL+/-** button.
7. Press the **TIMER** button, the volume indicator will blink.
8. Adjust volume with the **VOL+/-** button.
9. Press the **TIMER** button, the timer is set and activated, and "⌚" is displayed.

To deactivate or re-activate an alarm timer

In standby mode, press the **TIMER** button to activate or deactivate timer.

- If timer is activated, "⌚" is displayed.
- If timer is deactivated, "⌚" is disappeared.

Caution:

- * If disc/USB source is selected and the audio cannot be played, TUNER is activated automatically.

Specifications

Main adaptor

Model No.	GFP451-1530BX-1
Vendor	GME
Input.....	AC 100-240V 50/60Hz 1.2A
Output.....	DC 15V, 3A

Main Unit

FM Tuning Range	87.5~108 MHz
Power Consumption	35W
Output Power.....	25W x 2
THD	≤ 1%
Dimensions.....	222(W) x 90(H) x 255(D) mm

Speaker

Impedance.....	4Ω
Input Power.....	25W
Dimensions.....	115(W) x 204(H) x 152(D) mm

是否确认不
更改???

Disc Handling

Handling Precautions

- Hold the disc by the edges so the surface will not be soiled with fingerprints. (A) Fingerprints, dirt and scratches can cause skipping and distortion.
- Do not write on the label side with a ball-point pen or other writing implements.
- Do not use record cleaning sprays, benzine, thinner, static electricity prevention liquids or any other solvent.
- Be careful not to drop or bend the disc.
- Do not install more than 1 disc on the disc tray.
- Do not try to close the disc tray when the disc is not installed properly.
- Be sure to store the disc in its exclusive case when not in use.

If the surface is soiled (B)

- Wipe gently with a soft, damp (water only) cloth.
- When wiping discs, always move the cloth from the center hole toward the outer edge. (If you wipe the discs using a circular motion, circular scratches are likely to occur, which will cause noise.)
- If the disc is brought from a cold to a warm environment, moisture may form on the disc. Wipe the moisture off with a soft, dry, lint-free cloth before using the disc.

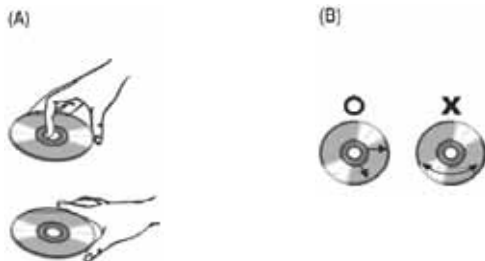

Improper disc storage

You can damage discs if you store them in the following places:

- Areas exposed to direct sunlight.
- Humid or dusty areas.
- Areas directly exposed to a heat outlet or heating appliance.

Troubleshooting

If you are having a problem with your unit, check this list for a possible solution before calling for service.

If you cannot solve the problem from the hints given here, or the unit has been physically damaged, call a qualified person, such as your dealer, for service.

No power

- Ensure that the AC adaptor plug of the unit is connected properly.
- Ensure that there is power at the AC outlet.
- To save power, the unit switches to standby automatically 15 minutes after a play reaches the end and no control is operated.

No sound

- Adjust the volume.

No response from the unit

- Disconnect and reconnect the AC adaptor plug, then turn on the unit again.

Remote control does not work

- Before pressing any function button, first select the correct source with the remote control instead of the main unit.
- Reduce the distance between the remote control and the unit.
- Insert the battery with its polarities (+/- signs) aligned as indicated.
- Replace the batteries.
- Aim the remote control directly at the sensor on the front of the unit.

No disc detected

- Insert a disc.
- Check if the disc is inserted with the print side facing inward.
- Wait until the moisture condensation at the lens has cleared.
- Replace or clean the disc.
- Use a finalized CD or correct format disc.

Cannot display some files in USB device

- The number of folders or files in the USB device has exceeded a certain limit. This phenomenon is not a malfunction.
- The formats of these files are not supported.

USB device not supported

- The USB device is incompatible with the unit. Try another one.

Poor radio reception

- Increase the distance between the unit and your TV or VCR.
- Fully extend and adjust the FM antenna.

Timer does not work

- Set the clock correctly.
- Switch on the timer.

Clock/timer setting erased

- Power has been interrupted or the power cord has been disconnected.
- Reset the clock/timer.



The symbol on the product or its packaging indicates that this product must not be disposed of with your other household waste. Instead, it is your responsibility to dispose of your waste equipment by handing it over to a designated collection point for the recycling of waste electrical and electronic equipment. The separate collection and recycling of your waste equipment at the time of disposal will help conserve natural resources and ensure that it is recycled in a manner that protects human health and the environment.

For more information about where you can drop off your waste for recycling, please contact your local authority, or where you purchased your product.

Notes for battery disposal

The batteries used with this product contain chemicals that are harmful to the environment. To preserve our environment, dispose of used batteries according to your local laws or regulations. Do not dispose of batteries with normal household waste.

For more information, please contact the local authority or your retailer where you purchased the product.

