



# INSTRUCTION MANUAL

## HFX-50 CD HIFI SYSTEM

机图后补

# Table of Contents

---

Safety Warnings .....	3
Battery Safety Guidelines .....	5
Pack Contents.....	6
Product Overview .....	7
Remote Control Overview .....	8
Installation of Battery .....	9
Handling the Remote Control.....	9
Remote Control Operation Range.....	10
Connections.....	10
Connect to the FM Antenna.....	10
Connecting the Headphone.....	11
Connecting the AC/DC Adaptor .....	11
ECO Power/Standby Features .....	12
Switching ON / OFF.....	12
Switching the system to ECO Power/Standby mode.....	12
Power-saving automatic standby .....	12
Setting the Clock .....	12
Setting the Clock Manually.....	12
Display the Clock .....	12
Sound Quality .....	13
Adjusting the Volume.....	13
Mute sound.....	13
Adjusting the Super Bass.....	13
Controlling the Loudness .....	13
Presetting Equalizer .....	13
Changing the Front Panel Darkness.....	13
Listening to Radio Broadcasts.....	14
Tuning in to a Station.....	14
Program radio stations.....	14
To change the FM Reception Mode .....	15
CD Operation .....	15
CD Playing.....	15
To Skip Search and Play .....	15
To Search and Play.....	15
Programme Play .....	15
Playing the Beginning (Intro) of each Track.....	16
Random Play.....	16

To Select Album (For MP3/WMA discs) .....	16
Playing Repeatedly .....	16
Text Display During Playback .....	16
Use the USB .....	17
Access a folder.....	17
Charge your device.....	17
About NFC.....	18
Play from Bluetooth device.....	18
Setting the Daily on Timer .....	19
Setting the Sleep Timer.....	19
Activate the sleep timer .....	19
To deactivate sleep timer .....	19
Listen to an external device .....	20
Listen to a digital device .....	20
Specifications.....	21
Maintenance .....	22
Cleaning the Unit .....	22
Handling Discs.....	22
Cleaning Discs.....	22
Storing Discs.....	22
Troubleshooting.....	23

## **Safety Warnings**

---

- Read all the instructions carefully before using the unit and keep them for future reference.
- Retain the manual. If you pass the unit onto a third party make sure to include this manual.

### **Damage**

- Please inspect the unit for damage after unpacking.
- Do not continue to operate the unit if you are in any doubt about it working normally, or if it is damaged in any way - switch off, withdraw the mains plug and consult your dealer.

### **Location of Unit**

- The unit must be placed on a flat stable surface and should not be subjected to vibrations.
- Do not place the unit on sloped or unstable surfaces as the unit may fall off or tip over.
- The mains socket must be located near the unit and should be easily accessible.

### **Temperature**

- Avoid extreme degrees of temperature, either hot or cold. Place the unit well away from heat sources such as radiators or gas/electric fires.
- Avoid exposure to direct sunlight and other sources of heat.

### **Naked Flames**

- Never place any type of candle or naked flame on the top of or near the unit.

### **Moisture**

- To reduce the risk of fire, electric shock or product damage, do not expose this unit to rain, moisture, dripping or splashing. No objects filled with liquids, such as vases, should be placed on the unit.
- If you spill any liquid into the unit, it can cause serious damages. Switch it off at the mains immediately. Withdraw the mains plug and consult your dealer.

### **Ventilation**

- To prevent the risk of electric shock or fire hazard due to overheating, ensure that curtains and other materials do not obstruct the ventilation vents.
- Do not install or place this unit in a bookcase, built-in cabinet or in another confined space. Ensure the unit is well ventilated.

### **Safety**

- Always disconnect the unit from the mains supply before connecting/ disconnecting other devices or moving the unit.
- Unplug the unit from the mains socket before a lightning storm.

### **Mains Cable**

- Make sure the unit or the unit stand is not resting on top of the mains adaptor cable, as the weight of the unit may damage the cable and create a safety hazard.
- The direct plug-in adaptor is used as disconnect device, the disconnect device shall remain readily operable.

### **Interference**

- Do not place the unit on or near appliances which may cause electromagnetic interference. If you do, it may adversely affect the operating performance of the unit, and cause a distorted picture or sound.

## **Batteries**

- Batteries used in the remote control for this unit are easily swallowed by young children and this is dangerous.
- Keep loose batteries away from young children and make sure that the battery holder tray is secure in the remote control. Seek medical advice if you believe a cell has been swallowed.
- Please dispose of batteries correctly by following the guidance in this manual.
- Batteries (battery pack or batteries installed) shall not be exposed to excessive heat such as sunshine, fire or the like.

## **Supervision**

- Children should be supervised to ensure that they do not play with the unit and the remote control.
- Never let anyone especially children push anything into the holes, slots or any other openings in the case - this could result in a fatal electric shock.

## **Class I Laser Product**

- This unit utilises a laser. Use of controls, adjustments or performance of procedures other than those specified herein may result in hazardous radiation exposure.
- Before moving the unit, ensure the disc tray is empty.
- Always remove the disc when the unit is not in use.
- Failure to do so will risk severely damaging the disc and the unit.
- Do not stack devices, heat from other devices may affect the performance of the unit.

## **Service**

- To reduce the risk of electric shock, do not remove screws. The unit does not contain any user-serviceable parts. Please leave all maintenance work to qualified personnel.
- Do not open any fixed covers as this may expose dangerous voltages.

## **Maintenance**

- Ensure the unit is fully unplugged from the power supply before cleaning.
- Do not use any type of abrasive pad or abrasive cleaning solutions as these may damage the unit's surface.
- Do not use liquids to clean the unit.

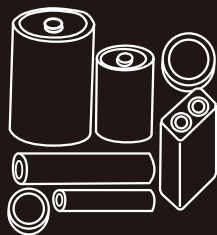

## Battery Safety Guidelines

Used correctly, domestic batteries are a safe and dependable source of portable power. Problems can occur if they are misused or abused — resulting in leakage or, in extreme cases, fire or explosion. Here are some simple guidelines to safe battery use designed to eliminate any such problems.



Take care to fit your batteries correctly, observing the plus and minus marks on the battery and appliance. Incorrect fitting can cause leakage or, in extreme cases, fire or even an explosion.

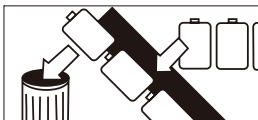

Replace the whole set of batteries at one time, taking care not to mix old and new batteries or batteries of different types, since this can result in leakage or, in extreme cases, fire or even an explosion.



Store unused batteries in their packaging and away from metal objects which may cause a short-circuit resulting in leakage or, in extreme cases, fire or even an explosion.



Remove dead batteries from equipment and all batteries from equipment you know you are not going to use for a long time. Otherwise the batteries may leak and cause damage.



Never dispose of batteries in fire as this can cause them to explode. Please recycle dead batteries; do not put with the normal household waste.



Never attempt to recharge ordinary batteries, either in a charger or by applying heat to them. They may leak, cause fire or even explode. There are special rechargeable batteries which are clearly marked as such.



Supervise children if they are replacing batteries themselves in order to ensure these guidelines are followed.



Remember that small button cell batteries such as used in some hearing aids, toys, games and other appliances, are easily swallowed by young children and this can be dangerous.



Keep loose button cells away from young children.



Make sure battery compartments are secure.



Seek medical advice if you believe a cell has been swallowed.

## Pack Contents

---

Make sure all of the following contents are included.

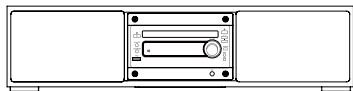

The Unit



Remote Control  
(battery included)

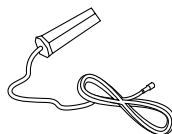

FM Antenna



Audio Cable

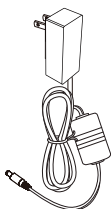

AC/DC Adaptor

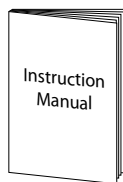

Instruction Manual

## Product Overview

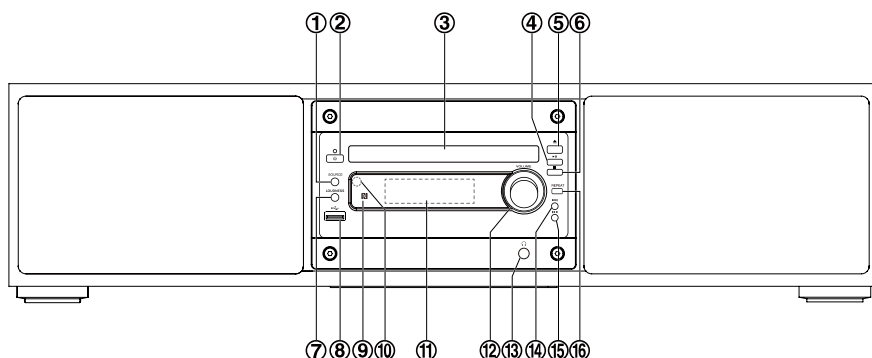

- |  |   |
|--|---|
| 1. Source Button                           | 10. Remote Sensor                           |
| 2. Standby Button                          | 11. LCD Display Lens                        |
| 3. Disc Tray                               | 12. Volume Control Knob ( <b>VOLUME</b> )   |
| 4. Play/Pause Button (▶  )                 | 13. Headphone Jack (🔊)                      |
| Tuning Forward Button (▶  )                | 14. Next Button (▶▶)                        |
| Paring Button (▶  )                        | Long press: Search Forward Button (▶▶)      |
| 5. Open/Close Button(▲)                    | Preset Up Button (▶▶)                       |
| 6. Stop Button(■)                          | 15. Previous Button (◀◀)                    |
| Tuning Backward Button (■)                 | Long press: Search Backward Button (◀◀)     |
| Disconnect Bluetooth Connection Button (■) | Preset Down Button (◀◀)                     |
| 7. Loudness Button ( <b>LOUDNESS</b> )     | 16. Repeat Button ( <b>REPEAT</b> )         |
| 8. USB Jack (🔌)                            | Stereo/mono Select Button ( <b>REPEAT</b> ) |
| 9. NFC Area (📶)                            |   |

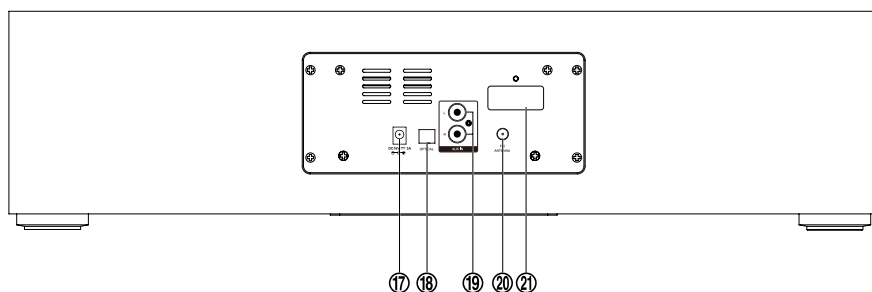

- |   |                       |
|---|-----------------------|
| 17. DC Jack                                     | 20. FM Antenna Socket |
| 18. Optical Input Terminal ( <b>OPTICAL</b> )   | 21. Bluetooth Antenna |
| 19. AUX Input Terminals (L&R) ( <b>AUX IN</b> ) |                       |



## Remote Control Overview

1. Standby Button (⏻)
2. CD Function Button (CD)
3. Tuner Function Button (FM)
4. Repeat Button (REPEAT)
- Stereo/mono Select Button (REPEAT)

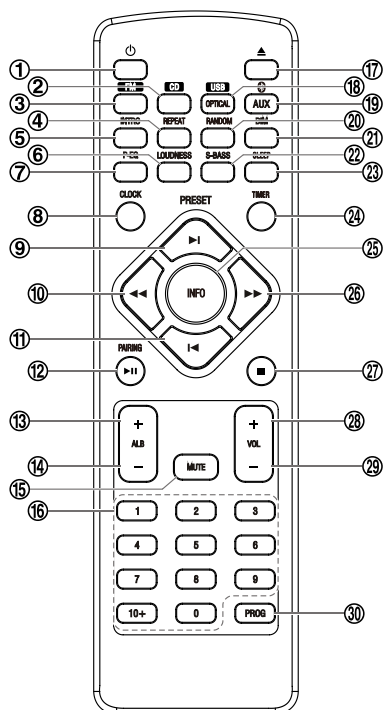

5. Intro Button (INTRO)
6. Loudness Button (LOUDNESS)
7. Preset Equalizer Button (P-EQ)
8. Clock Button (CLOCK)
9. Next Button (▶|)
- Preset Up Button (PRESET +)
10. Long press: Search Backward Button (◀◀)
- Tuning Backward Button (◀◀)
11. Previous Button (◀|)
- Preset Down Button (PRESET -)
12. Play/Pause Button (▶||)
- Pairing Button (PAIRING)
13. Album Up Button (ALB +)
14. Album Down Button (ALB -)
15. Mute Button (MUTE)
16. Number Button (0-9, 10+)
17. Open/Close Button (▲)
18. USB Function Button (USB)
- Optical Button (OPTICAL)
19. Bluetooth Function Button (📶)
- AUX Function Button (AUX)
20. Random Button
21. Dimmer Button (DIM)
22. Super Bass Button (S-BASS)
23. Sleep Button (SLEEP)
24. Timer Button (TIMER)
25. Information Button (INFO)
26. Long press: Search Forward Button (▶▶)
- Tuning Forward Button (▶▶)
27. Stop Button (■)
- Disconnect Bluetooth Connection Button (■)
- Check TOC Button (■)
28. Volume Up Button (VOL +)
29. Volume Down Button (VOL -)
30. Program Button (PROG)
- Long press: Auto Scan Button (PROG)
- Memory Button (PROG)

## Installation of Battery

The first use of remote control, remote control to activate the battery piece remove protection! It is located at the bottom back side of the remote control.

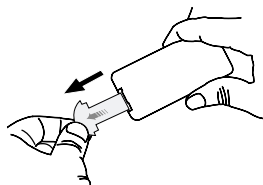

## Replace remote control battery

1. Loosen the screw on the battery compartment cover with a screwdriver. Pull out the battery compartment with your fingernails.

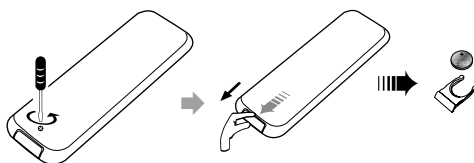

2. Replace a new battery (size 2025) correctly and fully insert the battery compartment back to the original position. Tighten the screw with a screwdriver.

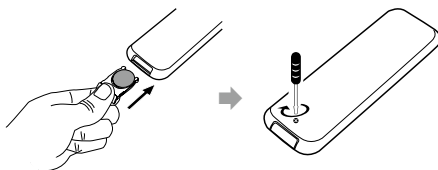

## Handling the Remote Control

- Remove the batteries if the remote control is not going to be used for an extended period of time.
- To avoid possible failure, read the following instructions and handle the remote control properly.
- Do not drop or cause impact to the remote control.
- Do not spill water or any liquid on the remote control.
- Do not place the remote control on a wet object.
- Do not place the remote control under the direct sunlight or near sources of excessive heat.
- Do not use caustic cleaners ( porcelain, stainless steel, toilet, or oven cleaner etc. ) on the remote, as it may suffer damage.

### Note:

Remove the battery from remote control handset when it is not to be used for a long period. Otherwise it can be damaged due to leakage of battery.

## Remote Control Operation Range

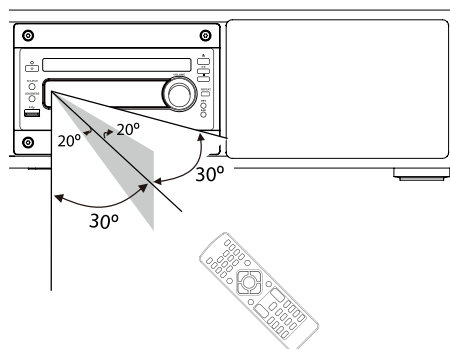

Point the remote control to the unit no more than 6 meters from the remote control sensor and within 60° horizontally and 40° vertically of the front of the unit. The operating distance may vary according to the brightness of the room.

### Note:

- Make sure that there is no obstacle between the infrared remote sensor of the unit and remote control. If you install the unit on rack, etc., the remote controllable range may decrease depending on the thickness or colour of glass door of rack.
- Do not expose the infrared remote sensor to direct sunlight or other strong light, such as inverter fluorescent light.

## Connections

---

Caution: Make all connections before plugging the unit into the AC Power outlet.

### Connect to the FM Antenna

- I. Connect the supplied FM Antenna to the FM Antenna socket on the rear of the unit.

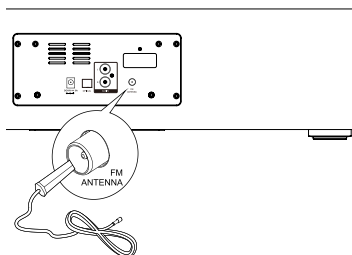

2. If reception is poor, connect the outside antenna.

**Note:** Before attaching a 75 ohm coaxial lead (the kind with a round wire going to an outside antenna), disconnect the supplied FM wire antenna.

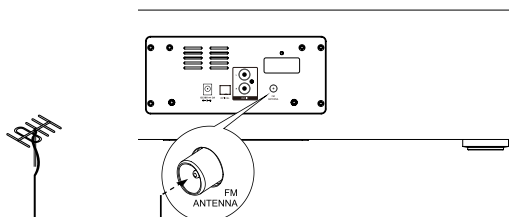

**Caution:** To avoid noise, keep antennas away from the system, the connecting cord and the AC power cord.

## Connecting the Headphone

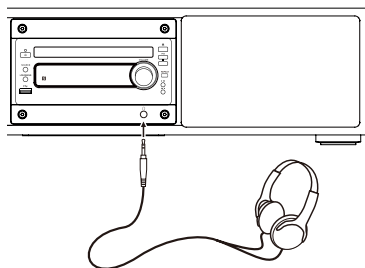

Connect a pair of headphones to the phone jack. No sound comes out of the speakers.

**Note:** Be sure to turn down the volume before connecting or putting on headphones. Excessive sound pressure from earphones and headphones can cause hearing loss.

## Connecting the AC/DC Adaptor

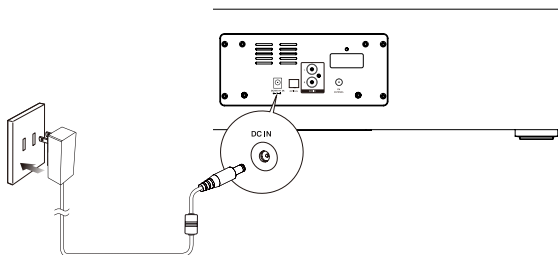

Insert the AC/DC adaptor's DC plug into the unit, then insert one side of AC plug into a wall outlet, and your system is at your command!.

**Caution:**



- \* Be sure to unplug the power plug from the outlet when going out or when the unit is not in use for an extended period of time.
- \* The mains plug is used as the disconnect device and it shall remain readily operable.

## ECO Power/Standby Features

---

### Switching ON / OFF

When you first connect the unit to the DC Jack, the unit will be in standby mode.

- Press the  button to switch the unit on. The "HELLO" will show in the display.
- Press the  button to switch the unit back to standby mode. The "BYE BYE" will scroll across the display.

### Switching the system to ECO Power/Standby mode

Long pressing the  button for 2 seconds or more to switch to ECO Power Standby or normal standby.

#### \* ECO Power standby mode

The clock will not be displayed. Red led on. Press the **CLOCK** button to display the clock on the LCD.

#### \* Normal standby mode

The clock display on the LCD. Red led off.

### Power-saving automatic standby

As a power-saving feature, the unit will automatically switch to Standby mode if you do not press any buttons within 15 minutes after playback is stopped.

## Setting the Clock

---

### Setting the Clock Manually

**Caution:** You can set the clock in standby mode only.

1. In standby mode, long pressing the **CLOCK** button on the remote control for 2 seconds or more, the LCD will display CLOCK SET and CLOCK 24 begins to blink.
2. Use the **VOLUME** knob, **◀◀**, **▶▶** buttons on the unit or **VOL+**, **VOL-**, **▶**, **◀** buttons on the remote control to set the 12/24 hour format.
3. Press the **CLOCK** button to store the setting, hour indicator will blink.
4. Repeat above steps 2-3 to set the hour and minute.

#### **Note:**

- To exit clock setting mode without storing, press the **■** button.
- If no button is pressed in 90 seconds, the unit exits clock setting mode automatically.
- If a power failure occurs or the unit is disconnected from the mains, the clock setting will be lost.

### Display the Clock

In any source mode, the built-in clock shows the time on the LCD by press the **CLOCK** button.

## Sound Quality

---

### Adjusting the Volume

To increase or decrease the volume, rotate the **VOLUME** knob on the unit or press the **VOL +/-** buttons on the remote control.

### Mute sound

You can mute the sound temporarily.

During play, press the **MUTE** button to mute or unmute sound.

Note: If you change the volume or source when the sound is muted, muting is cancelled.

### Adjusting the Super Bass

You can reinforce the bass sound to maintain rich, full bass at low volume.

Press the **S-BASS** button on the remote control to get the effect, the “” will lit on the LCD.

Press the **S-BASS** button again to cancel the effect.

### Controlling the Loudness

This unit has a loudness function, which can automatically increase the bass sound effect at low volume. It can also increase the bass sound effect at high volume, but it will be relatively less when it is at high volume. Press the **LOUDNESS** button to obtain the loudness function, the “” will displayed on the LCD, press again will disappear.

### Presetting Equalizer

You can adjust the sound reproduced simply by choosing from 5 preset equalizers.

During play, press the **P-EQ** button on the remote control repeatedly to select:

- FLAT
- POP
- JAZZ
- ROCK
- CLASSIC

### Changing the Front Panel Darkness

This unit has three brightness levels for you to adjust the clock display. Press the **DIM** button on the remote control repeatedly to choose the desired brightness.

## Listening to Radio Broadcasts

---

**Caution:** Before listening to the radio, please check that the FM Antenna is correctly connected and adjusted for length and direction.

### Tuning in to a Station

1. Repeatedly press the **SOURCE** button on the unit or directly press the **FM** button on the remote control to select tuner source.
  - The word "TUNER" will be displayed on the LCD.
2. Select a station using one of the following methods.
  - ♦ **Auto Tuning**  
Long pressing the **■/▶||** button on the unit or **◀◀/▶▶** button on the remote control for 2 seconds or more, the frequency changes down or up automatically until a station is found.
  - ♦ **Manual Tuning**  
Repeatedly press the **■/▶||** button on the unit or **◀◀/▶▶** button on the remote control to change the frequency until you find the station you want.
  - ♦ **Preset Tuning (Available only after the stations are preset)**
    - Repeatedly press the **▶▶/|◀◀** buttons on the unit or **▶/|◀** buttons on the remote control to select the desired preset number. Its band and frequency are displayed on the LCD.
    - Directly press the **0-9** buttons on the remote control to input a number directly and tune to the band and frequency with this number.

### Program radio stations

You can program a maximum of 20 preset radio stations (FM).

- ♦ **Automatically**  
Long pressing the **PROG** button on the remote control for 2 seconds or more to activate automatic program mode.
  - [AUTO] is displayed.
  - All available stations are programmed.
  - The first programmed radio station is broadcast automatically.
- ♦ **Manually**
  1. Tune to a radio station.
  2. Press the **PROG** button on the remote control to activate program mode.
    - The preset number will blink.
  3. Press the **▶▶/|◀◀** buttons on the unit or **0-9, ▶/|◀** buttons on the remote control to allocate a number to this radio station.

**Note:** If you select more than 20, the preset number will be changed to "1" automatically.
  4. Press the **PROG** button on the remote control again to store the station.
  5. Repeat above steps 1 to 4 for each station you want to store in memory with a preset number.

**Note:** If the system is unplugged or if a power failure occurs, the preset stations will not be erased.

## To change the FM Reception Mode

Press the **REPEAT** button to select the Stereo or Mono channel to receive the best FM reception mode.

## CD Operation

---

### CD Playing

1. Repeatedly press the **SOURCE** button on the unit or directly press the **CD** button on the remote control to select the disc source.
  - The "DISC" will be displayed on the LCD.
2. Press the **▲** button to open the disc door and place the disc on the disc tray (with the printed side up).
3. Press the **▲** button to close the disc door, the unit will read the disc and play it automatically.  
**Note:** If in stop mode, please press the **▶||** button to start playing the disc.
4. Press the **▶||** button to temporarily stop the playing, press the button again, it will continue to play.
5. Press the **■** button once to pre-stop the disc playing. Press the button twice to stop the disc playing.

### To Skip Search and Play

- ♦ Press the **◀◀** button on the unit or **◀** button on the remote control once or more to skip previous one or more tracks on the disc.
- ♦ Press the **▶▶** button on the unit or **▶** button on the remote control once or more to skip next one or more tracks on the disc.

### To Search and Play

Long pressing the **▶▶/◀◀** buttons on the unit or **◀◀/▶▶** buttons on the remote control to search for the position that you intend to start playing.

### Programme Play

You can programme up to 20 tracks to play in any desired order. The player must be in stop mode only with a CD inserted.

1. Insert a disc and press the **■** button when it starts playing.
2. Press the **PROG** button on the remote control, the LCD will display "001 P--01" and "PROG".
3. Press the **▶▶/◀◀** buttons on the unit or **0-9, ▶/◀** buttons on the remote control to select the desired track number.
4. Press the **PROG** button on the remote control to confirm the track number to be stored.
5. Repeat steps 3-4 to select and store all desired tracks.



6. Press the ►|| button to start programme play.
7. Press the ■ button once to stop the programme play. Press the ■ button twice to clear programme.

## Playing the Beginning (Intro) of each Track

Press the **INTRO** button on the remote control to play the beginning of each track consecutively. The playing time of each track is 10 seconds, then the first track is playing automatically. When you hear the desired track, press the ►|| button.

## Random Play

All tracks are played in a random sequence by pressing the **RANDOM** button on the remote control, "SHUF" is blink on the LCD. Press this button again to return to normal play.

## To Select Album (For MP3/WMA discs)

- Press the **ALB+/-** button on the remote control to select the next/previous album, and play the first track of this album.
- If the playing has ended, press the **ALB+/-** button on the remote control to select the next/previous album.

## Playing Repeatedly

ONE, ALB and ALL repeat play can be set by pressing the **REPEAT** button.

### ◆ For audio CD

- First press : To repeat the same track, the "TRK" and "REP" will blink.
- Second press : To repeat playing all tracks on a disc, the "REP ALL" will blink.
- Third Press : Return to the normal playback state.

### ◆ For MP3/WMA Disc

- First press : To repeat the same track, the "TRK" and "REP" will blink.
- Second press : To repeat playing album, the "REP" and "ALB" will blink.
- Third press : To repeat playing all tracks on a disc, the "REP ALL" will blink.
- Fourth Press : Return to the normal playback state.

## Text Display During Playback

### ◆ For audio CD

Repeatedly press the **INFO** button on the remote control to show the current track number and single elapsed time, the current track number and single remain time, the current track number and total elapsed time or the current track number and total remain time.

### ◆ For MP3/WMA Disc

Press the **INFO** button on the remote control, ID3 information (song title and artist) will be displayed. Press this button again, album, track and playing time will be displayed.

## Use the USB

---

1. Insert the USB device's USB plug into the  socket on the unit.

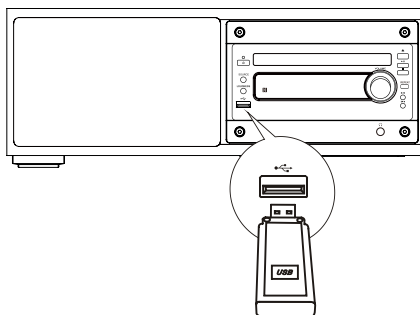

2. Repeatedly press the **SOURCE** button on the unit or **USB /OPTICAL** button on the remote control to select the USB source. The word “USB” will be displayed on the LCD.
3. In stop mode, press the **▶||** button to start playing.  
During playing, press the **▶||** button to temporarily stop the playing, press the button again, it will continue to play.
4. Press the **■** button once to pre-stop the disc playing. Press the button twice to stop the disc playing.

**Note:** The player support the USB music file format of MP3/WMA only.

### Access a folder

- During playing, press the **ALB+/-** buttons on the remote control to select a folder.
- In stop mode, press the **ALB+/-** buttons on the remote control to select a folder and press the **▶|/|◀** buttons on the unit or **▶|/|◀** buttons on the remote control to select a file, and then press the **▶||** button to start play.

### Charge your device

You can charge your device through the  socket on the rear of the unit with a USB cable.

#### **NOTE:**

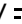
- The maximum current for USB charging is 5V  1A.
- Not all devices for USB charging are guaranteed.

## About NFC

---

Pair your NFC(Near Field Communication)-enabled mobile device directly with this unit by just a single tap.

1. Activate NFC on your mobile device.
2. Tap the mobile device on the NFC area  of the unit.
3. Operate your mobile device directly for playback features.
4. Tap again on the NFC area of the unit to disconnect.

**Note:** This function only works with mobile devices that support NFC technology.

## Play from Bluetooth device

---

1. Repeatedly press the **SOURCE** button on the unit or /**AUX** button on the remote control to select the bluetooth source. The word "BT" will display on the LCD.
2. Long pressing the **▶ II** button on the unit or **PAIRING** button on the remote control for 2 seconds or more to searching pairing device.
3. Activate the Bluetooth function in your Bluetooth device (see the device user manual).
4. Select "HFX-50" on your device for pairing.
  - For elder devices, you need to input "0000" as pairing password.
5. Start music play on your Bluetooth device, you can use this unit to control the function to your Bluetooth device.
  - To pause/resume play, press **▶ II**.
  - To skip to a track, press **▶ I / I ◀** buttons on the unit or **▶ I / I ◀** buttons on the remote control.
  - To increase or decrease the volume, press **VOL +/-**.
6. Long pressing the **■** button for 2 seconds or more to disconnect the Bluetooth connection from your Bluetooth device and clear Bluetooth pairing history for this unit.

### **Note:**

- \* The operational range is approximately 10 meters.
- \* Any obstacle can reduce the operational range.
- \* The device will also be disconnected when the device is moved beyond the operation range.
- \* If you want to reconnect the device to the unit, place it within the operational range.
- \* Compatibility with all Bluetooth devices is not guaranteed.

## Setting the Daily on Timer

---

**Caution:** Make sure that you have set the clock correctly.

1. In standby mode, long pressing the **TIMER** button on the remote control, until [TIMER SET] scrolls on the LCD. Then the source is displayed, e.g. DISC.

**Note:** If the clock is not set, the "SET CLOCK FIRST" will be displayed.

2. Use the **VOLUME** knob, **I◀◀**, **▶▶I** buttons on the unit or **VOL+**, **VOL-**, **▶I**, **I◀** buttons on the remote control to select a source.
3. Press the **TIMER** button to store the setting, the hour indicator will blink.
4. Repeat above steps 2-3 to set the hour, minute and adjust volume.

**Note:**

- To exit clock setting mode without storing, press the **■** button.
- If no button is pressed in 90 seconds, the unit exits clock setting mode automatically.
- If DISC/USB source is selected and the audio cannot be played, TUNER is activated automatically.

### To deactivate or re-activate an alarm timer

Repeatedly press the **TIMER** button to activate or deactivate timer; if timer is activated, "⌚" is displayed.

## Setting the Sleep Timer

---

### Activate the sleep timer

When the unit is turned on, repeatedly press the **SLEEP** button on the remote control to select a set period of time (in minutes: 120, 90, 60, 45, 30, 15), the "zzz" is displayed.

### To deactivate sleep timer

Repeatedly press the **SLEEP** button until [SLEEP OFF] is displayed, the "zzz" is disappears.

## Listen to an external device

---

1. Connect the AUX IN terminals on the rear of the unit to the line output terminals on the auxiliary equipment with an audio cable.

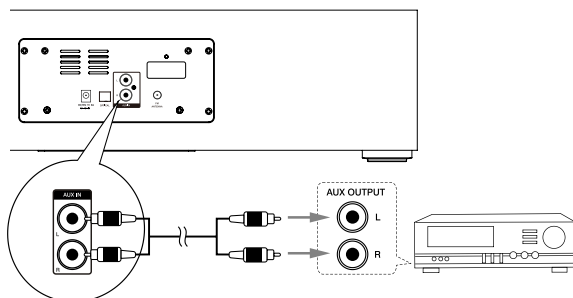

2. Repeatedly press the **SOURCE** button on the unit or **Bluetooth/AUX** button on the remote control to select AUX IN source. The word “AUX IN” will be displayed on the LCD.
3. Start to play on the device (see the user manual of the external device).

## Listen to a digital device

---

1. Connect the OPTICAL (input) jack on the rear of the unit to the optical out jack on a digital recording device with the singal cable.

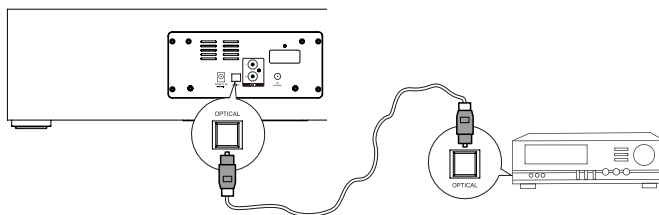

2. Repeatedly press the **SOURCE** button on the unit or **USB/OPTICAL** button on the remote control to select OPTICAL source. The word “OPTICAL” will be displayed on the LCD.
3. Start to play on a digital device (see the user manual of the digital device).

**Note:** In receiving OPTICAL signals, the setting menu of TV or other connected devices, please changed Digital Audio Output into PCM.

## Specifications

---

### Main unit

Power requirements.....	100-240V~ 50/60Hz 1.5A Max.
Adaptor Model No.....	S060A1603000U
Adaptor Vendor .....	BP
Adaptor Output.....	16V $\equiv$ 3A
Output power (@10% THD).....	25 W x 2 RMS
Frequency Response .....	20-20000Hz
Tweeter Speaker Impedance .....	8 $\Omega$ x 2
Woofer Speaker Impedance.....	4 $\Omega$ x 2
Rated Power.....	25W x 2
Input Sensitivity .....	1000mV
S/N.....	$\geq$ 70dB
FM Tuning Range.....	87.5-108 MHz
Dimensions.....	W580 X D275 X H140 mm
USB Port.....	5V $\equiv$ 1A
Bluetooth version .....	4.2
Hardware version .....	V1.0
Software version .....	V2.0
Frequency range.....	2402 - 2480 MHz
Maximum power transmitted.....	4dBm
Maximum communication range .....	approx. 10m
NFC Frequency operation.....	13.56 MHz
NFC Communication technique .....	NFC passive tag

### Remote Control

Distance .....	6 m
Angle.....	$\pm$ 30°(Horizontal), $\pm$ 20°(Vertical)

**Note:** Design and specifications are subject to change without prior notice.

## Maintenance

---

### Cleaning the Unit

**Note:** Ensure the unit is fully unplugged from the mains socket before cleaning.

- To clean the unit, wipe the case with a slightly moist, lint-free cloth.
- Do not use any cleaning fluids containing alcohol, ammonia or abrasives.
- Do not spray an aerosol at or near the unit.

### Handling Discs

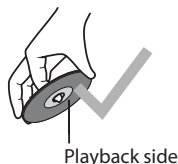

- Do not touch the playback side of the disc.
- Do not attach paper or tape to the disc.

### Cleaning Discs



- Fingerprints and dust on the disc cause picture and sound deterioration. Wipe the disc from the centre outwards with a soft cloth. Always keep the disc clean.
- If you cannot wipe off the dust with a soft cloth, wipe the disc lightly with a slightly moistened cloth and finish with a dry cloth.
- Do not use any type of solvent such as thinner, benzene, commercially available cleaners or antistatic spray. They may damage the disc.

### Storing Discs

- Do not store discs in places subjected to direct sunlight or near heat sources.
- Do not store discs in places subjected to moisture and dust such as a bathroom or near a humidifier.
- Storing discs vertically in a case, stacking discs or placing objects on discs outside of their cases may cause warping.

## Troubleshooting

---

If you are having a problem with your unit, check this list for a possible solution before calling for service.

If you cannot solve the problem from the hints given here, or the unit has been physically damaged, call a qualified person, such as your dealer, for service.

### No power

- Ensure that the AC/DC adaptor plug of the unit is connected properly.
- Ensure that there is power at the AC outlet.
- To save power, the unit switches to standby automatically 15 minutes after a play reaches the end and no control is operated.

### Remote control does not work

- Before pressing any function button, first select the correct source with the remote control instead of the main unit.
- Reduce the distance between the remote control and the unit.
- Insert the battery with its polarities (+/- signs) aligned as indicated.
- Replace the batteries.
- Aim the remote control directly at the sensor on the front of the unit.

### No disc detected

- Insert a disc.
- Check if the disc is inserted with the print side facing inward.
- Wait until the moisture condensation at the lens has cleared.
- Replace or clean the disc.
- Use a finalized CD or correct format disc.

### No sound or poor sound

- Adjust the volume.

- Check that the speakers are connected correctly.
- Check if the stripped speaker wires are clamped.

### Disc does not play

- Insert a readable disc and ensure that the label side faces up.
- Check for any scratches or smudges on the disc.
- Moisture has condensed inside the system. Remove the disc and leave the system turned on for about an hour. Disconnect and reconnect the AC/DC adaptor plug, and then turn on the system again.
- As a power-saving feature, the system turns off automatically 15 minutes after disc play reaches the end and no control is operated.

### Poor radio reception

- Fully extend and adjust the FM aerial.

### Cannot display some files in USB device

- The number of folders or files in the USB device has exceeded a certain limit. This phenomenon is not a malfunction.
- The formats of these files are not supported.

### USB device not supported

- The USB device is incompatible with the unit. Try another one.



**Music playback is unavailable on this unit even after successful Bluetooth connection.**

- The device cannot be used to play music through this unit wirelessly.

**The audio quality is poor after connection with a Bluetooth-enabled device.**

- The Bluetooth reception is poor. Move the device closer to this unit or remove any obstacle between them.

**Cannot connect with this unit.**

- The device does not support the profiles required for this unit.
- The Bluetooth function of the device is not enabled. Refer to the user manual of

the device to find out how to enable the function.

- This unit is not in pairing mode.
- This unit is already connected with another Bluetooth-enabled device. Disconnect that device and then try again.

**Timer does not work**

- Set the clock correctly.
- Switch on the timer.

**Clock/timer setting erased**

- Power has been interrupted or the AC/DC adaptor cord has been disconnected.
- Reset the clock/timer.



Use only power supplies listed in the user manual.



This product complies with the requirement of the 2014/30/EU, 2014/35/EU, 2014/53/EU directive.



The symbol on the product or its packaging indicates that this product must not be disposed of with your other household waste. Instead, it is your responsibility to dispose of your waste equipment by handing it over to a designated collection point for the recycling of waste electrical and electronic equipment. The separate collection and recycling of your waste equipment at the time of disposal will help conserve natural resources and ensure that it is recycled in a manner that protects human health and the environment.

For more information about where you can drop off your waste for recycling, please contact your local authority, or where you purchased your product.

Caution: The user is cautioned that changes or modifications not expressly approved by the party responsible for compliance could void the user's authority to operate the equipment.

This device complies with Part 15 of the FCC Rules. Operation is subject to the following two conditions: (1) this device may not cause harmful interference, and (2) this device must accept any interference received, including interference that may cause undesired operation.

NOTE: This equipment has been tested and found to comply with the limits for a Class B digital device, pursuant to Part 15 of the FCC Rules. These limits are designed to provide reasonable protection against harmful interference in a residential installation. This equipment generates, uses and can radiate radio frequency energy and, if not installed and used in accordance with the instructions, may cause harmful interference to radio communications. However, there is no guarantee that interference will not occur in a particular installation.

If this equipment does cause harmful interference to radio or television reception, which can be determined by turning the equipment off and on, the user is encouraged to try to correct the interference by one or more of the following measures:

- Reorient or relocate the receiving antenna.
- Increase the separation between the equipment and receiver.
- Connect the equipment into an outlet on a circuit different from that to which the receiver is connected.
- Consult the dealer or an experienced radio/TV technician for help.

#### FCC Radiation Exposure Statement:

This equipment complies with FCC radiation exposure limits set forth for an uncontrolled environment. This equipment should be installed and operated with a minimum distance of 20cm between the radiator and your body.

This transmitter must not be co-located or operating in conjunction with any other antenna or transmitter.

#### **Manufacturer:**

Zhongshan City LI TAI Electronic Industrial Co. Ltd.  
3rd Industrial district, Wuguishan, Zhongshan City, Guangdong, China (528458)

P/N: 41016603