

User manual
Outdoor wireless lighting speaker



what's in the box?



Wireless speaker*1



Charging cable*1



Instruction*1



Product figure

- 1.Light key
- 2.Volume"+" / Next song
- 3.On/Off
- 4.Volume-" / Last song
- 5.Play/Pause

- 6.Reset key
- 7.TF card
- 8.Aux port
- 9.Charging port
- 10.Charging indicator

① *

② ►/Volume"+"

③ /Audio

④ ◀/Volume"-"

⑤ ►

⑥

⑦

⑧

⑨

⑩

1.Wireless connection

Turn on the speaker and Enter pairing mode



Long press

Lighting is running fast if wireless device not connected , use the wireless device to search for "UQ21101" and click to connect.



Short press x1

Audio switch mode



Long press

disconnect wireless device

2.Light mode



Short press x1

Lighting effect switch

3.Music control



►/Volume"+"

◀/Volume"-"

►

►

②/③ Short press x1 Volume"-" / "+"

②/③ Long press Last/Next song

⑤ Short press x1 Play/Pause

4.Answer the phone

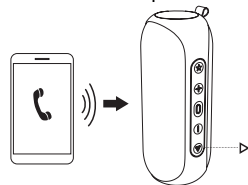

⑤ Short press x1 Answer/Hang up

⑤ Long press Reject call

⑤ Short press x2 Dial the last call



Audio connection

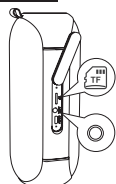

⑧ Short press x1 Audio switch mode

When inserting audio devices , it will play the last insert one first.



Product charge

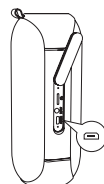

Red light on The battery is charging

Red light off Fully charged

To preserve battery lifespan , fully charge at least once every 45days

Specifications

Model	CT02049
Item number	UQ21101
Wireless distance	≥10m (open distance)
Play time	Volume100% 7H Volume50% 15H
Play mode	BT/AUX/TF
Battery	4000mAh/3.7V
Charging input	DC 5V-1A
Charging time	4H
Frequency response	20Hz-20KHz



Charging and battery information :

1.This product has a built-in non-removable and rechargeable battery. Please use the equipped micro USB cable to charge the battery.

2.The charging current voltage is 5V/1A , and the product can not be recharged with a charger of more than 5V/1A.

3.Please choose the charger that passes the regular manufacturer's safety certification.

4.Repeated charging on the speaker will cause battery performance degradation overtime , which is a normal phenomenon for all rechargeable batteries.



Warning :

Do not drop, disassemble, deform, modify or insert any objects into this product as operating damage may result.

Do not attempt to repair, modify or disassemble the product yourself. This product does not contain any user-serviceable components and may void the warranty.

Do not clean the product with alcohol, ammonia based cleaners and abrasive cleaners.

Do not place this product in to contact with any sharp objects as this may cause scratches and operating damage.

Do not attempt to replace the product battery, it is built-in and is not user changeable.

Observe all signs and displays that require an electrical device or RF radio product to be switched off in designated areas.

Dispose of the product and the product's battery in accordance with local laws and regulations.

Do not place put flame source near the product.

Use the specialized adapter for charging.

Avoid using in damp or corrosive environment.

Do not touch metal or short circuit electrode.

Warning:

Changes or modifications not expressly approved by the party responsible for compliance could void the user authority to operate the equipment

FCC Statement

This equipment has been tested and found to comply with the limits for a Class B digital device, pursuant to part 15 of the FCC rules. These limits are designed to provide reasonable protection against harmful interference in a residential installation. This equipment generates, uses and can radiate radio frequency energy and, if not installed and used in accordance with the instructions, may cause harmful interference to radio communications.

However, there is no guarantee that interference will not occur in a particular installation. If this equipment does cause harmful interference to radio or television reception, which can be determined by turning the equipment off and on, the user is encouraged to try to correct the interference by one or more of the following measures:

- Reorient or relocate the receiving antenna.
- Increase the separation between the equipment and receiver.
- Connect the equipment into an outlet on a circuit different from that to which the receiver is connected.
- Consult the dealer or an experienced radio/TV technician for help.

To assure continued compliance, any changes or modifications not expressly approved by the party responsible for compliance could void the user's authority to operate this equipment.

This equipment complies with Part 15 of the FCC Rules. Operation is subject to the following two conditions:

- (1) This device may not cause harmful interference, and
- (2) This device must accept any interference received, including interference that may cause undesired operation.

FCC Radiation Exposure Statement:

The device has been evaluated to meet general RF exposure requirement.

The device can be used in the portable exposure condition with restriction