

# GIMBAL

## SPRO30

### User Manual

V1.00 2017.04

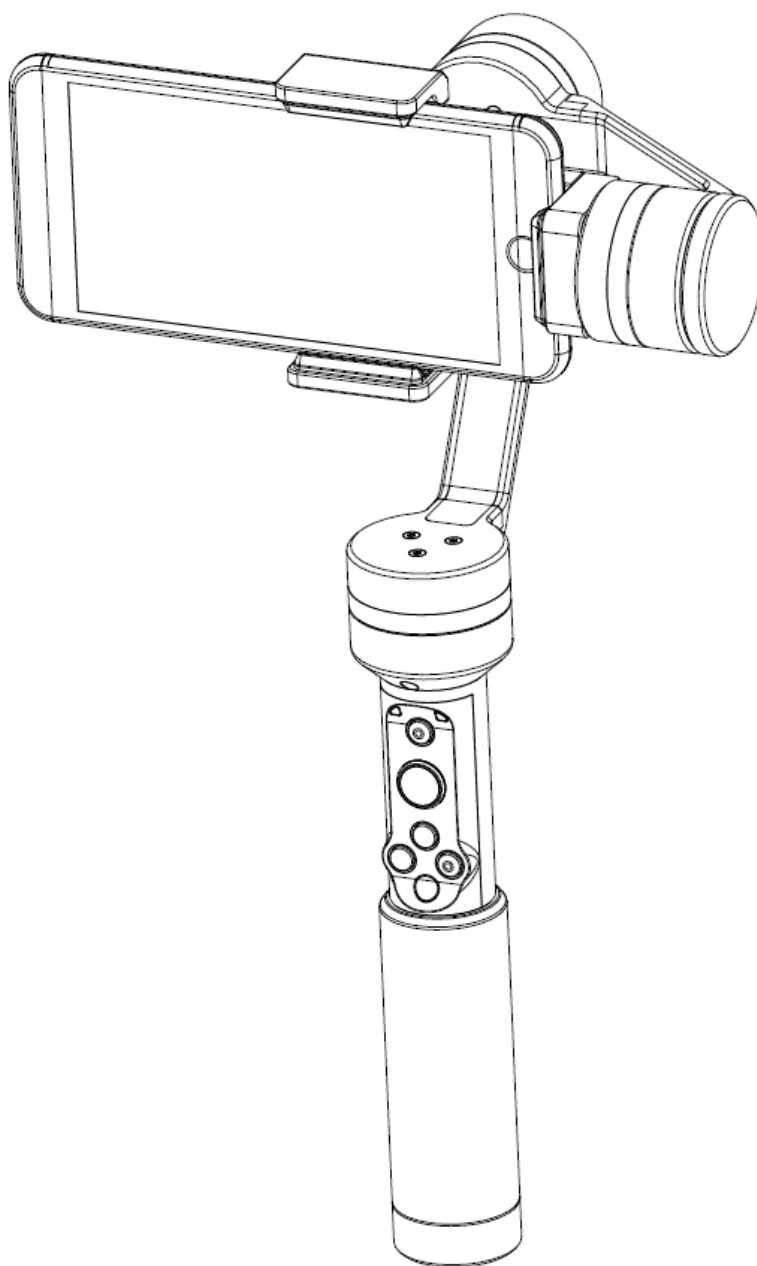

## WARNING:

### ① Please download APP before using

iPhone user please search “GIMBAL” in APP STORE

Android user please download and install APP from official website

Note: IOS system version should be IOS8.0 or above, Android system version should be 5.0 or above

### ② Clip the smart phone before you turn the device on (smart phone may weigh differently, please adjust the phone to keep the Roll axis in horizontal level, a counterweight may required in some circumstances)

## 1, Product description

The smart phone is used for illustration purpose only.

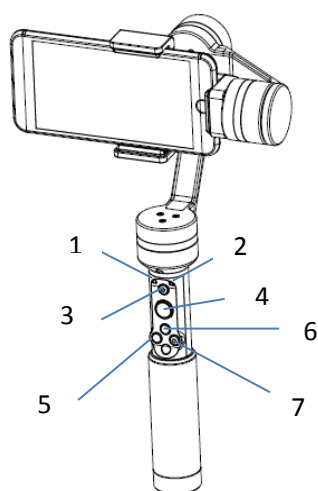

- 1, Indicator LED 1
- 2, Indicator LED 2
- 3, Power Switch

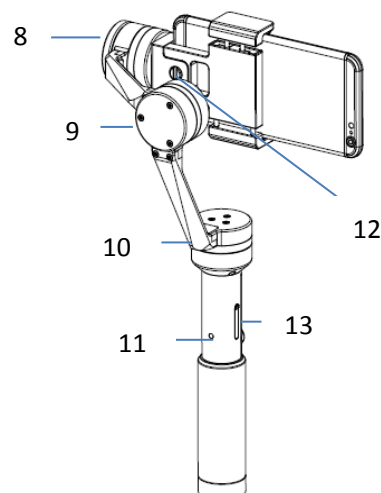

- 8, Pitch Axis
- 9, Roll Axis
- 10, Yaw Axis

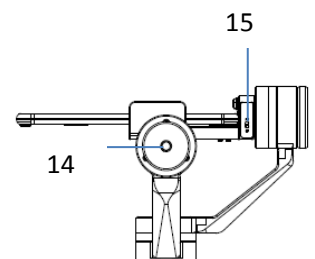

- 14, Pitch Axis
- 15, Roll Axis

- |   |   |
|---|---|
| 4, Control stick                                | 11, Charging indicator LED                        |
| 5, Mode switch button                           | 12, Smart phone/Sport camera quick released screw |
| 6, Horizontal/vertical mode switch button       | 13, USB charging port                             |
| 7, Video/Photo button                           | 14, threads                                       |
| 15, Smart phone/sport camera mode switch button |   |

## Bluetooth:

Name: GIMBAL

Version: Low power consumption bluetooth4.0

## Battery:

Type: Li-ion

Single cell: 18650

Voltage: 3.7V

Capacity: 3400Mah

## Sport camera bracket

# 2, GIMBAL user guide

**GIMBAL comes with a control stick to switch to different modes, photo/video, horizontal/vertical mode, smart phone/camera mode.**

### 【1】 Power switch

Press power switch, and long press for 3S to turn the GIMBAL ON or OFF.

### 【2】 Control stick

Move the Control stick to Left or Right to control GIMBAL Yaw axis to move Left or Right. Move the Control stick Up or Down to control GIMBAL Pitch axis to move Up or Down. This control mode is continuously variable, and the control directions can be modified on GIMBAL APP.

### 【3】 Video/Photo button

【4】 When GIMBAL is connected with APP. To take a single photo on phone by Pressing Video/Photo button once, to take a continuous photo by holding Video/Photo button, the video can be closed by another single press. The before/behind camera can be exchanged by double pressing Video/Photo button.

### 【5】 Horizon/Vertical switch button

When GIMBAL is working, Click Horizon/Vertical model switch button can switch between Horizon model and Vertical model.

### 【6】 Model Switch Button

When GIMBAL is working, You can switch full following , semi following and lock model by clicking Model Switch Button. You can exit the dynamic capture model by clicking Model Switch Button twice ,hence back to gimbal original status.

### 【7】 Smart phone/sport camera mode switch button

Pls switch the Smart phone/sport camera mode switch button according to the guide of GIMBAL before charging.(Pls make sure switch before charging, it doesn't work

during the gimbal's operation)

**【8】** Charging indicator LED status

Below chart is the explanation for the status of GIMBAL during operation.

**【9】** Removal Method of Phone and sport camera

Either a coin or screwdriver can be used to replace phone arm and sport camera arm.

**【10】** GIMBAL Charging

Whether it's on or off, GIMBAL can be charged with a laptop or charging treasure, mobile phone charger, car charger, etc. Charger specifications are as follows: (Voltage: 5V, Current: <2.1A)

**【11】** 1/4 Screw Thread

The 1/4 Screw Thread under the handle can work with selfie stick or tripod.

### 3, GIMBAL APP Set and Handle

Warning: The icon location of Android and iOS may be different, but the function is same.

Pls handle the APP according to the guide of APP.

### 4, Specification

<b>Name</b>	<b>GIMBAL</b>
<b>Dimension</b>	<b>296*106*110mm</b>
<b>Weight</b>	<b>475g (Without smartphone)</b>
Angle jitter	$\pm 0.05^{\circ}$
Pitch Angle	<b>270°</b>
Roll Angle	<b>270°</b>
Heading Angle	<b>360°</b>
Following speed	<b>&lt;120° /S</b>
<b>Suitable Phone</b>	mobile phone that is less than 6.1 inch
<b>Max Current</b>	<b>&lt;3A</b>

This equipment has been tested and found to comply with the limits for a Class B digital device, pursuant to part 15 of the FCC Rules. These limits are designed to provide reasonable protection against harmful interference in a residential installation. This equipment generates, uses and can radiate radio frequency energy and, if not installed and used in accordance with the instructions, may cause harmful interference to radio communications. However, there is no guarantee that interference will not occur in a particular installation. If this equipment does cause harmful interference to radio or television reception, which can be determined by turning the equipment off and on, the user is encouraged to try to correct the interference by one or more of the following measures:

- Reorient or relocate the receiving antenna.
- Increase the separation between the equipment and receiver.
- Connect the equipment into an outlet on a circuit different from that to which the receiver is connected.
- Consult the dealer or an experienced radio/TV technician for help.

Caution: Any changes or modifications to this device not explicitly approved by manufacturer could void your authority to operate this equipment.

This device complies with part 15 of the FCC Rules. Operation is subject to the following two conditions: (1) This device may not cause harmful interference, and (2) this device must accept any interference received, including interference that may cause undesired operation.

The device has been evaluated to meet general RF exposure requirement. The device can be used in portable exposure condition without restriction.