



Chatter **Box!**™

THE ORIGINAL COMMUNICATOR

CHATTERTUNES 



SOUND, FORM, AND FUNCTIONALITY IN A BOX

Owner's Manual



FCC Certification Requirements

Caution: Any changes or modifications in construction of this device which are not expressly approved by the party responsible for compliance could void the user's authority to operate the equipment.

This device complies with part 15 of the FCC Rules. Operation is subject to the following two conditions: (1) This device may not cause harmful interference, and (2) This device must accept any interference received, including interference that may cause undesired operation.

The manufacturer is not responsible for any radio or TV interference caused by unauthorized modifications to this equipment. Such modifications could void the user's authority to operate the equipment.

This equipment has been tested and found to comply with the limits for a Class B digital device, pursuant to Part 15 of the FCC Rules. These limits are designed to provide reasonable protection against harmful interference in a residential installation. This equipment generates, uses and can radiate radio frequency energy and, if not installed and used in accordance with the instructions, may cause harmful interference to radio communications. However, there is no guarantee that interference will not occur in a particular installation. If this equipment does cause harmful interference to radio or television reception, which can be determined by turning the equipment off and on, the user is encouraged to try to correct the interference by one or more of the following measures:

- Reorient or relocate the receiving antenna.**
- Increase the separation between the equipment and receiver.**
- Connect the equipment into an outlet on a circuit different from that to which the receiver is connected.**
- Consult the dealer or an experienced radio/TV technician for help.**



Table of Contents

| | |
|--|------------|
| 1. INTRODUCTION TO CHATTERTUNES V1.0 | 3 |
| UNPACKING AND INSPECTION | 3 |
| 2. GETTING TO KNOW YOUR CHATTERTUNES V1.0 | 4-5 |
| BUTTONS AND INPUTS | 4-5 |
| 3. OPERATION | 6-7 |
| CHARGING THE DEVICE | 6 |
| TURNING ON THE CHATTERTUNES | 6 |
| PAIRING WITH A BLUETOOTH®-ENABLED DEVICE | 6-7 |
| CONNECTING TO AN AUXILIARY DEVICE | 7 |
| 4. BICYCLE APPLICATION | 8-9 |
| BRACKET INSTALLATION | 8 |
| SPEAKER INSTALLATION | 8 |
| WATER-RESISTANT CASE APPLICATION | 8 |
| RAIN COVER OPERATION | 9 |
| BRACKET AND SPEAKER UNINSTALLATION | 9 |
| 5. SPECIFICATIONS | 10 |

1. Introduction to ChatterTunes V1.0

This is a portable speaker that supports Bluetooth® version 2.1.

With this Speaker, you can:

1. Play music from a Bluetooth®-enabled mobile phone or audio source that is compatible with A2DP, such as an iPod/iPhone/iPad, Android Smartphone, PC or Mac.
2. Use the ChatterTunes as a speaker phone for a Bluetooth® connected mobile phone.
3. Play music from an auxiliary device connected through the supplied 3.5mm audio cable.

Unpacking and inspection

Please check and make sure that you have everything listed below inside the box. If you find any parts missing or that have been damaged, please contact our customer service immediately.

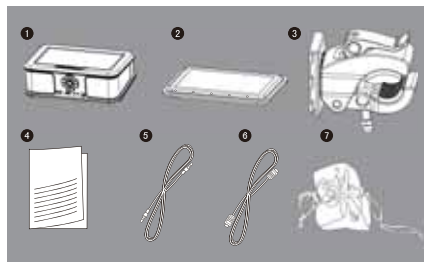

1. Bluetooth® Wireless Speaker
2. EVA Waterproof Case for Electronic Devices
3. Handlebar Mounting Bracket
4. Owner's Manual
5. 3.5mm Audio Input Cable
6. USB Charging Cable
7. Rain Cover

CHATTERBOX USA







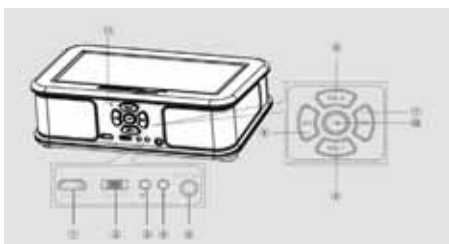

3

2. Getting to know your ChatterTunes V1.0

Buttons and inputs

The ChatterTunes is packed with many features in a light compact casing. Please refer to the picture shown to find out the location and functions of each button.

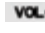

-  1. Charging input port
 - Connect the micro USB charging cable
-  2. Power switch
 - Turn on or turn off the Bluetooth® speaker
-  3. Power indicator
 - Indicate when charging / low power
 - Operating: green light
 - Charging: red light
 - Low power: red light slow blinking
-  4. Bluetooth® indicator
 - Indicate the Bluetooth® when searching / connecting
 - Searching: light and quick blink
 - Connecting: light and slow blink
-  5. Audio input port
 - Connect an auxiliary device
-  6. During play, skip to the next song
-  7. During play, skip to the previous song
-  8. Turn up volume of speaker or microphone
-  9. Turn down volume of speaker or microphone



10. Play / Pause / Phone button

- During play, press to start or pause the music
- Press once to answer / hang up a call
- Press twice to recall the last number
- Press and hold to switch between your mobile phone and speaker microphone



11. Microphone

- During a call (incoming or outgoing) you can listen through the speakers



3. Operation

Charging the device

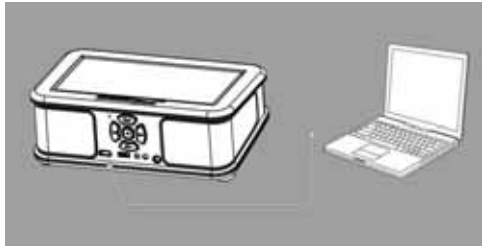

When the power indicator blinks slowly, this means the power level is low, so you need to charge the speaker as soon as possible.

Connecting the supplied charging cable:

Plug Micro USB connector into the DC IN port, and connect USB connector to a USB port on your PC/Mac/Power bank. The power indicator will turn on when charging. When fully charged the indicator light will turn off.

Turning on the ChatterTunes

Turn the power switch to the ON position, then power indicator light will light up.
Turn the power switch to the OFF position, then the power indicator light will turn off.

Pairing with a Bluetooth®-enabled device

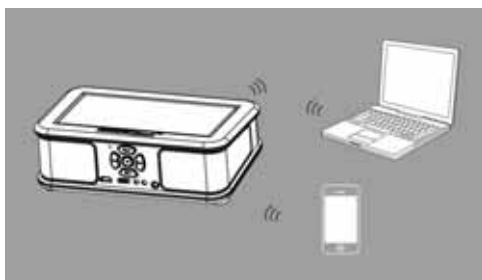

In order to sync to the ChatterTunes, you must operate the Bluetooth® options on the device you want to pair up to, then search and connect to the ChatterTunes (Bluetooth® mode of the bike speaker).





The speaker's Bluetooth® indicator light will blink when you are searching ,and the light will turn on when paired.

Tip 1: The Bluetooth® indicator light will be disappear when you connect the audio cable.

Tip 2: The Bluetooth® range between speaker and another device is 10m.

Connecting to an auxiliary device

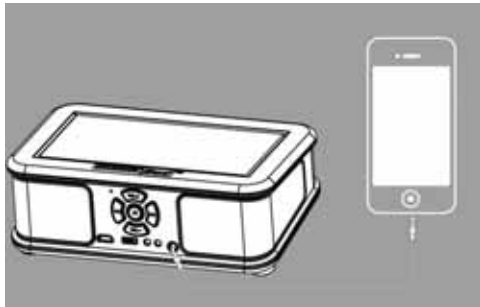

You can also listen to music from any auxiliary device with a 3.5mm headphone port. Such as a PC or an MP3 player through the audio input cable.





4. Bicycle application

Bracket installation

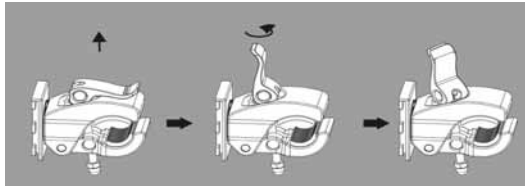

Take the handle bar mounting bracket. Move the screw handle up and turn counterclockwise to loosen the screw until you can match the bracket with the bicycle handle bar.

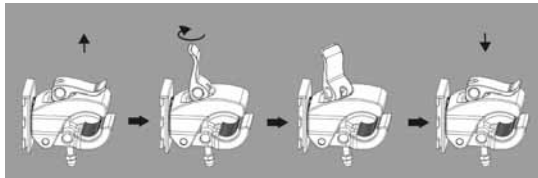

Place the bracket onto the bicycle handle bar, turn clockwise to tighten the screw until the bracket is tightly on the bicycle handle bar.

Speaker installation

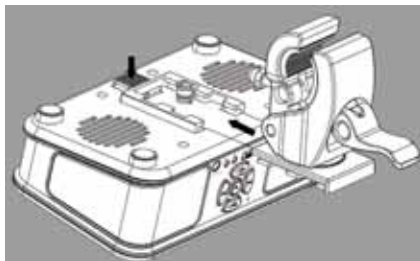

Slide the bracket onto the rails at the bottom of the speaker. Press and hold the button when you slide bracket in or out of the rails of the speaker, then release the button after locked in.

Water-resistant case application



The Size of water-resistant case is 149x89x6mm. Put your cell phone or auxiliary device into the water-resistant case. The water-resistant case can protect cellphone from light rain or scratch. Place the water-resistant case on your speaker.
Tip: There is a small hook on the water-resistant case. You can use as a carry bag.





Rain cover operation

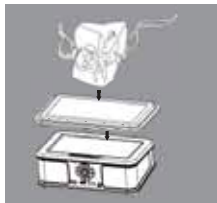

If you ride your bicycle on rainy days, don't forget to use the rain cover for your speaker to avoid possible damage.

Bracket and speaker uninstallation

Hold the button on bracket and pull the bracket out from the rails. Move the screw handle up and turn counterclockwise to loosen the screw.

5. Specifications

| GENERAL | |
|-----------------------------------|---|
| AES | 6 W |
| Charging voltage/current | DC 5V / 600mA - 800mA |
| THD | 0.5% |
| Charge time | 2.5 - 4 hours |
| Dimension of speaker | 149 x 89 x 50mm |
| Wireless | Bluetooth® version: 2.1 |
| Audio input | 1 x 3.5mm port; 1 x wireless input Bluetooth® |
| Built-in lithium battery capacity | 1600mAh |
| Frequency response | 65Hz - 18kHz |
| Signal-to-noise ratio | 76dB |
| Weight of speaker | 288g |
| Bluetooth® response range | Region at Dia distance 10m |
| Continuous playing time | 5 - 7 hours |



NOTE

CHATTERBOX.USA

11



16310 Arthur Street, Cerritos, CA 90703
www.chatterboxusa.com
Customer Service: 888-452-2269
info@chatterboxusa.com

Congratulation on your purchase of the Chatterbox product.
For additional information, go to chatterboxusa.com

For product support, go to
www.chatterboxusa.com/support