



User's Guide

SOLTREPEATER

Supplies Per Models

Repeater

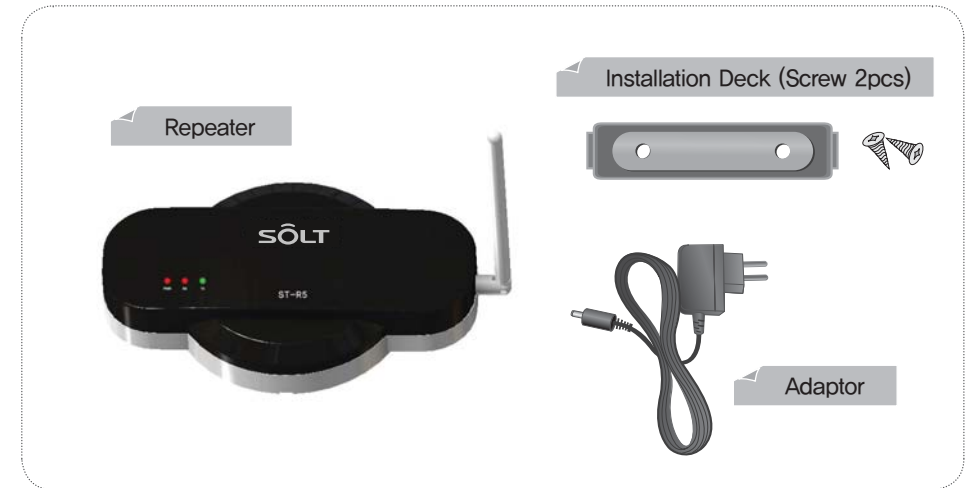

Specification

Model	SOLTPEPEATER
Frequency(MHz)	433.0500 ~ 434.7900
Freq Stability	± 5 ppm
Data Rate	1800 bps
Channel space	12.5 KHz
Modulation	FSK (±3KHz)
Output Power	10mW (Max)
Sensitivity	-118dBm (at 12dB)
Power Supply	DC 12V/1A Adapter
Dimension(mm)	146W × 90L x 32H
Battery Life cycle	External Power
Antenna	Tilt base snap-in_dipole (External)

Name of each section

Front

① Retractable antenna

② Status indicator



③ Holes for wall mount

Back

④ Setting buttons

⑤ Call number Display

⑥ Adapter input
(DC 12V 1A)

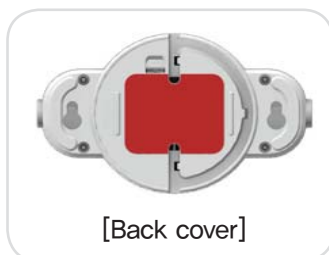
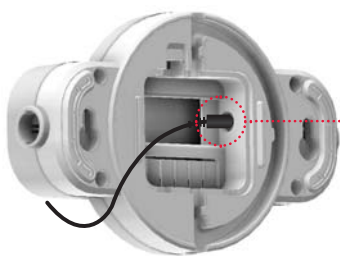

① Folding antenna : 180 degrees pivot

② Bell number indicator : activated led number varies by different models.

PWR	Red led indicates power is on
RX	Blinking Red led indicates bell model
TX	Blinking Green led indicates pager model

③ Wall mount holes :

Refer to item 4 of Installation Guide in page 53.



[Wall mount bracket installation]

④ Setting buttons

MENU / ESC	<ul style="list-style-type: none"> Menu button in setting mode alphabetic and numeric changing button
▲ ▼	up /down
◀ ▶	left / right buttons
SET / PWR	<ul style="list-style-type: none"> Storing button for set value Dower button

⑤ Display



⑥ Adapter input: DC12V 1A (Use the supplied adapter)

Limited accessory warranty: malfunctioning of supplied adapter during its use is not covered by manufactures' warranty.

Purchasing an adapter with AC110~220V input, DC12V 1A output is recommended.



Input : AC110~220V
Output : DC12V 1A

Installation guide

To assure the finest performance, please read this manual carefully.

① Location

※ Transmitter must be installed with in 100% reception area.

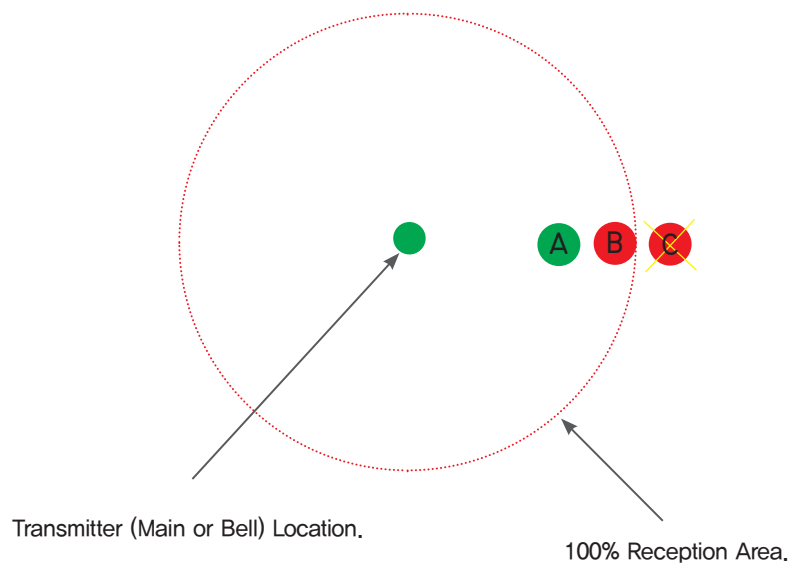

It is most appropriate to install A location which is located within 100% reception area.
(See map a picture above)

※ This product is needed to avoid moisture and water (It can be cause of breakdown)
Recommend to install away from water. If needed to install outside of building, install where does not get wet.

② Bracket Installation

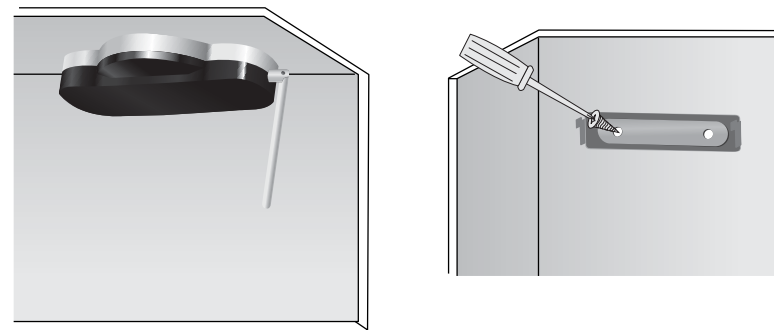

Install at roof like picture above, it is better if antenna direction go downward.
In the case of cannot be installed to the roof install rear the roof.
Once decided where to install, fix the mount.

③ Power Cord (Use the adapter provided in the package.)

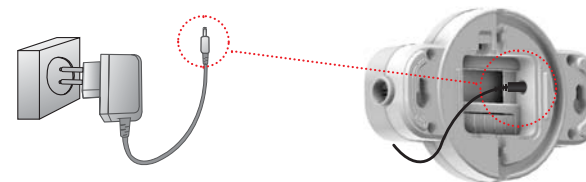

④ Wall Mounting (Pull down the unit until clicking sound is heard.)

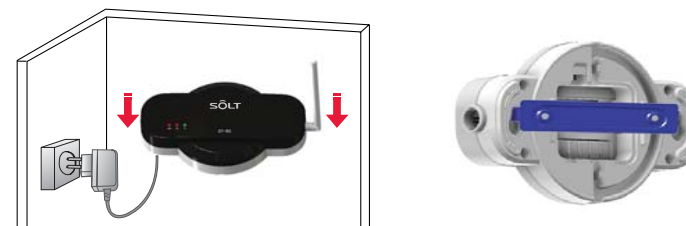

Repeater setting modes

Listed items below can be set by using user setting buttons.

E1	Repeater selection mode Sets the repeater as call bell repeater or pager repeater.
E2	Download mode Downloads registered call numbers from main transceiver. [TBD]
E3	No receive call number setting mode Selects call numbers that are not desired to receive.
E4	Call redundancy interval setting mode Sets interval for redundant calls. (default value is 3 seconds)
E5	Call number deleting mode Deletes registered call numbers.
E6	Call number registering mode Registers new call numbers.
E7	TX delay time setting mode Sets delay time for received call number from bell.



Repeater selection mode (Cbr / CPr)

· Sets the repeater as call bell repeater or pager repeater.

(1) Press and hold (MENU) button for 3 seconds.



· Entering setting mode as [E1 Rsel] is displayed.

(2) Press (SET) button.



· [Cbr or CPr] is displayed.

(3) Press (▲▼) buttons. (Cbr / CPr)



Cbr : Extends bell receiving range by relaying bell's data to main transceiver.

CPr : Extends pager receiving range by relaying main transceiver data to pager.

(4) Press (SET) button.



· [E1 Rsel] is displayed and returns to previous step.

※ Press (▲▼) buttons to select different setting mode.

(5) Press (MENU) button.



· [ST-r5] is displayed and ready for reception.

E2880W7

Download mode

- Downloads registered call numbers from main transceiver.

(1) Press and hold (MENU) button for 3 seconds



displayed.

(2) Press



[TBD]

(3) Press



(4) Press (SET) button.



- [---] is displayed during downloading is in progress.

- [E2 Down] is displayed when downloading is completed and returns to previous step.

※ Press (▲▼) buttons to select different setting mode.

(5) Press (MENU) button.



- [ST-r5] is displayed and ready for reception.

E388A0F

No receive call number setting mode

- Selects call numbers that are not desired to receive.

(1) Press and hold (MENU) button for 3 seconds.



- Entering setting mode as [E1 Rsel] is displayed.

(2) Press (▲) button twice.



- [E3 Daof] is displayed.

(3) Press (SET) button.



- Registered call number is displayed.

(4) Press (▲▼) buttons to select a Call number don't want to receive.



- Selected call number is displayed.

(5) Press (SET) button to select desired receiving mode.



- [No Receive] button toggles each time SET button is pressed.

※ To set another receiving mode, repeat steps (4) to (5).

(6) Press (MENU) button.



- [ST-r5] is displayed and ready for reception.



e.g.) Call number 200 is set to not receive when [No Receive] icon is displayed.

E488UPT

Repetition call setting mode

· Sets interval for redundant calls.

(1) Press and hold (MENU) button for 3 seconds.



· Entering setting mode as **[E1 Rsel]** is displayed.

(2) Press (▲) button 3 times.



· **[E4 Dupt]** is displayed.

(3) Press (SET) button.



· **[3]** is displayed.
※ 3 is set for default. (Unit : second)

(4) Press (▲▼) buttons. Sets the desired number.



· Selected number is displayed.

(5) Press (SET) button.



· **[E1 Rsel]** is displayed and returns to previous step.

※ Press (▲▼) buttons to select different setting mode.

(6) Press (MENU) button.



· **[ST-r5]** is displayed and ready for reception.

E588ELE

Call number deleting mode

· Deletes registered call numbers.

(1) Press and hold (MENU) button for 3 seconds.



· Entering setting mode as **[E1 Rsel]** is displayed.

(2) Press (▲) button 4 times.



· **[E5 Dele]** is displayed.

(3) Press (SET) button.



· Registered call number is displayed.

(4) Press (▲▼) button. Select the call number you want to delete.



· Selected call number is displayed.

(5) Press (SET) button.



· "It has been deleted." is played.
· To delete another call number, repeat the processes from (4) to (5).

(6) Press (MENU) button.



· **[ST-r5]** is displayed and ready for reception.

E6887E9

Call number registering mode

· Registers new call numbers.

(1) Press and hold (MENU) button for 3 seconds.



· Entering setting mode as **[E1 Rsel]** is displayed.

(2) Press (▲) button 5 times.



· **[E6 Breg]** is displayed.

(3) Press (SET) button.



· Blinking **[0]** is displayed.

(4) Press (▲▼◀▶) buttons. sets desired to call number.



· Press (◀▶) buttons to move to different digits.
· Press (MENU) button to toggle input mode from / to numeric and English modes.

Number mode	0123456789 (Blank)
English mode	AbCdEfGh IjKlMnOpQr StUvWxYz - _ (Blank)

(5) Press (SET) button.



· Selected-number from (4)section is displayed on the screen and the number stop blinking.

(6) Press the button to register.



· Registration for selected call number is completed.
· The number of screen is again blinking.

· To register another Bell, repeat the processes from (4) to (6).

(7) Press and hold (SET) button for 3 seconds when registration is finished.



· **[ST-r5]** is displayed and ready for reception.



TX delay time setting mode

· Sets delay time for received call number from bell.

(1) Press and hold (MENU) button for 3 seconds.



· Entering setting mode as **[E1 Rsel]** is displayed.

(2) Press (▲) button 6 times.



· **[E7 Txdt]** is displayed.

(3) Press (SET) button.



· **[0]** is displayed.
 · 10(1Second), 20(2Second) ... 100(10Second)
 ※ '0' is default value :
 transmits as soon as receiving a call.

(4) Press (▲▼) buttons. Sets the desired number.



· Selected number is displayed.

(5) Press (SET) button.



· **[E1 Rsel]** is displayed and returns to previous step.

※ Press (▲▼) buttons to select different setting mode.

(6) Press (MENU) button.



· **[ST-r5]** is displayed and ready for reception.