



# OPERATION MANUAL

## VSPHOENIX S USER GUIDE



# CONTENTS

## Standard and Installation Methods

Attentions .....	3
Name of each part of VSPHOENIX S .....	4
VSPHOENIX S Size & Specification .....	6
Names of the major parts of the lower part .....	8
How to assemble VSPHOENIX .....	10
How to measure and install the throw line .....	14

## Online VS PHOENIX S

Router connection .....	18
Online setting .....	19
Set Network .....	20
Set Network FAQ .....	23

## SETUP MODE

How to get into SETUP MODE .....	24
SETUP MODE Control .....	25
SETUP MAIN MENU EXPLANATION .....	26
EASY SETUP / MENU SETTING .....	28
GAME SETTING .....	29
SYSTEM SETTING .....	31
COIN ASSIGNMENT .....	33
BOOKS .....	34
EVENTLOG .....	37
MACHINE STYLE .....	37

## CREDIT SETUP

How to setup credit .....	38
Payment setting (FREE PLAY) .....	39

## Other Management Methods

Segment management tip/ Daily management .....	40
Orders of regular scheduled inspection .....	41

## How to solve VS Phoenix-S problem

Power / Lighting .....	42
Monitor screen / Miss recognition .....	43
Sound .....	44
Coin or Bill / Stuck .....	45
PHOENIX Card .....	46
Online / Versus Movie .....	47

# Safety Instructions

## General safety instructions

1. Available voltage: AC 110~120V / 60Hz
2. Be careful not to bend or push the power cord.
3. Do not place the power cord in place where many passing through are allowed.
4. Unplug the power cord during a thunderstorm.
5. Do not touch any other areas except the designated area. There is risk of electric shock or short circuit.
6. The machine inspection when the electrics are charged should be done by store management administrator or technician.

## Attention before the installation

1. Installation place
  - Place the back of machine and the runway in their approximate final positioning leaving a 10 cm gap in between them for the protection against heat.
  - Avoid high temperature and moisture area.
  - Avoid the vibration and noisy area. (Make sure there is no speaker or amplifier near the machine.)
  - Choose solid and horizontal place to install for the stabilization of dart system.
  - In case of installing in other places except in the surface of the wall, the machine should be reinforced to not fall down by fixing with L bracket.
  - Make sure not to let machine touch each other when the installation place is confined.
2. To use safely,
  - The voltage of outlet should be larger than 110V~120V.
  - If it exceeds the standard due to parallel connections or etc., it may causes fire.
  - Do not touch electrical wiring placed inside of the machine.
  - Do not alter or attempt to modify any parts of the machine in any way.

※ Our Company is not responsible for the damages or thunderstruck caused by customer's fault.
3. Safety instructions
  - There are high temperature and pressure areas inside the machine. Please be careful when inspecting inside of the machine.
  - Do not touch things not mentioned in the instruction.
  - Do not place any flammable agents near the machine and be aware of fire protection.
- 4 If any problems are occurred,
  - If the machine is not working properly, please turn off the power, remove the plug from the outlet and contact store management administrator.
5. about liability
  - Our company does not accept any temporary modification, repair and exchange to the contents that are not mentioned in the user's instructions.
  - Our company is not responsible for any accidents; thus, consumer's special attention will be needed.

※ A specification or design can be changed without any notices.



Name of each part of VSPHOENIX S

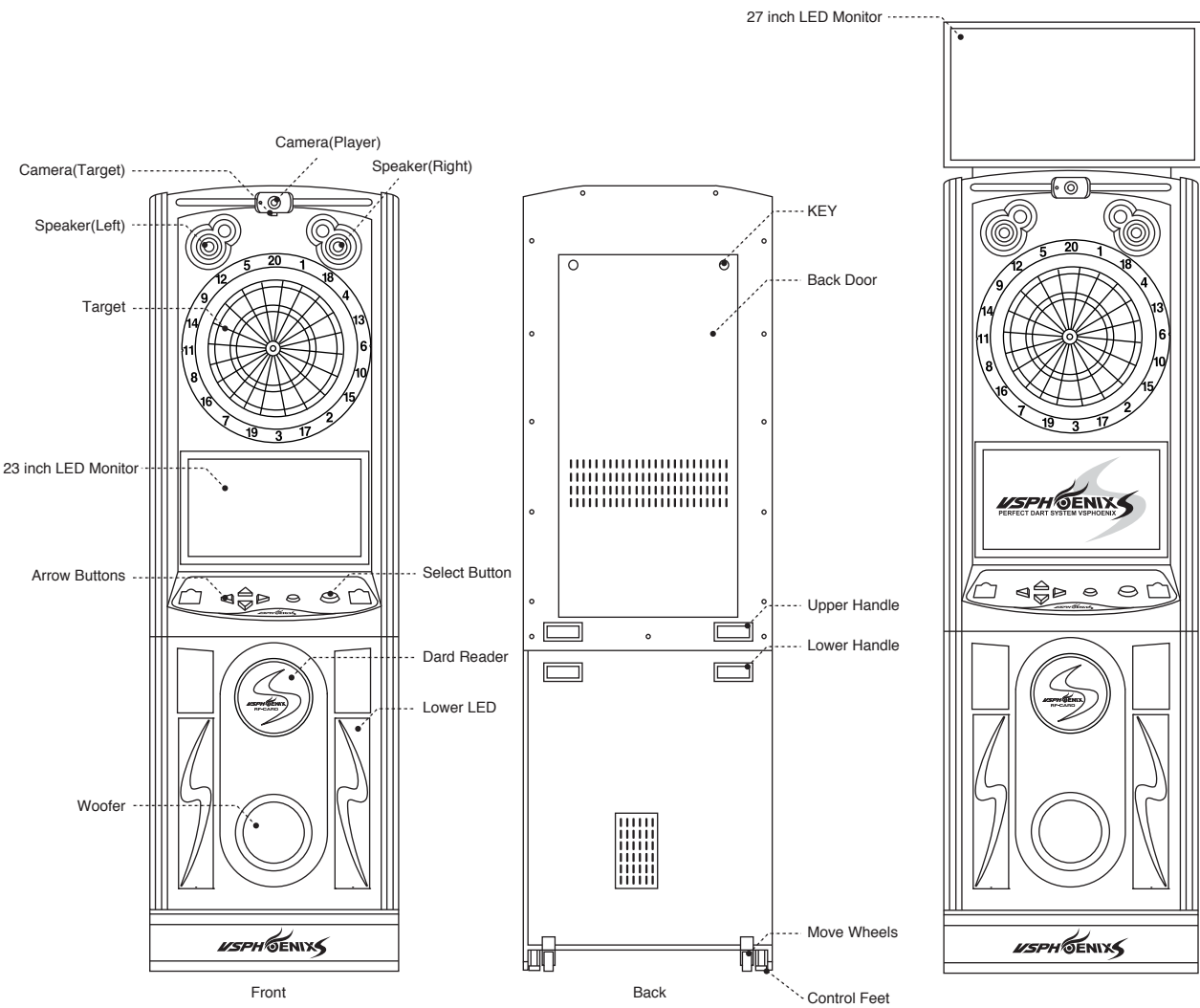

Name of each part of VSPHOENIX S

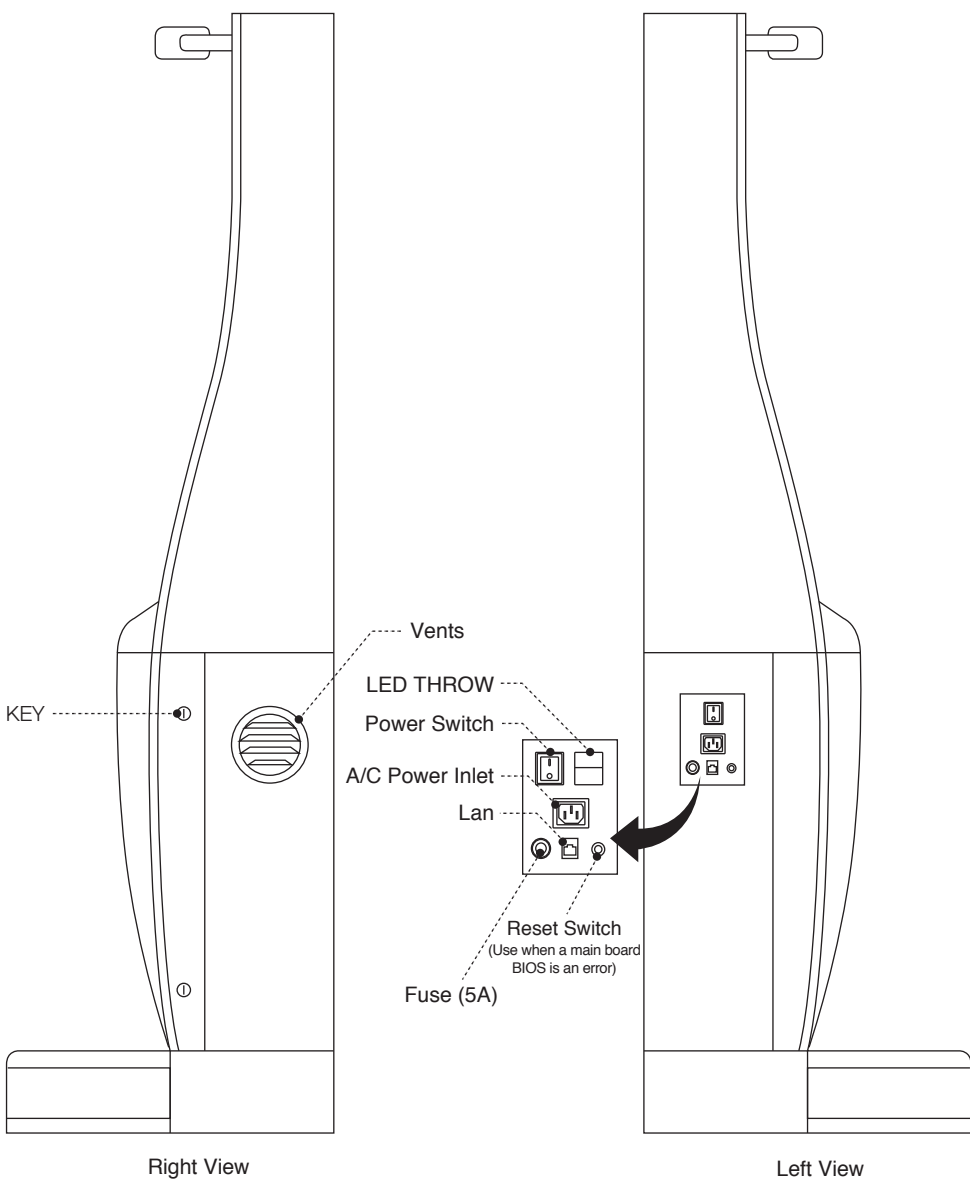



VSPHOENIX S SIZE

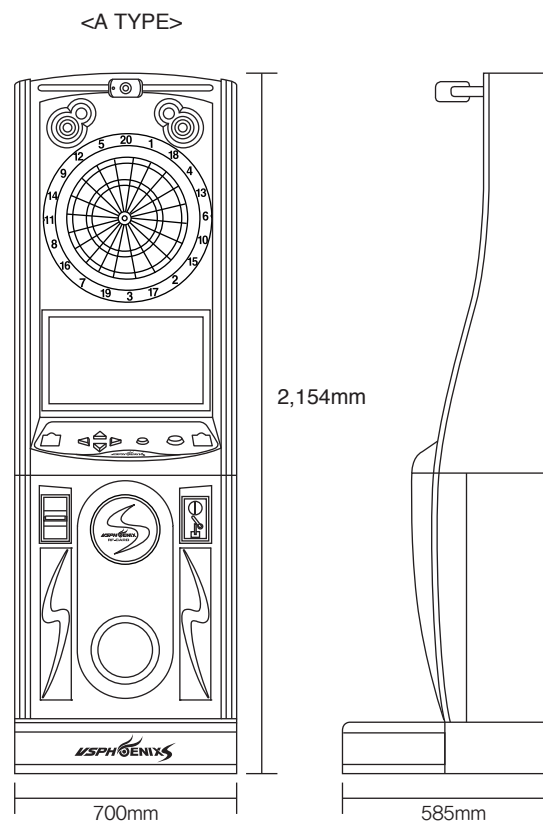

VSPHOENIX-S Specification

■ A TYPE (Standard Type)

Height	2,154mm
Width	700mm
Depth	585mm(Including Foot Step)
Gross Weight	109.1kg
Power Consumption	165w

UPPER

Weight	40.3kg
Height	1,240mm

LOWER

Weight	68.8kg
Height	914mm
Depth	440mm(Not including Foot Step)
	600mm(Including Foot Step)



VSPHOENIX S SIZE



VSPHOENIX-S Specification

■ B TYPE (27" Dual Monitor)

Height	2,510mm
Width	700mm
Depth	585mm(Including Foot Step)
Gross Weight	122.6kg
Power Consumption	190w

UPPER

Weight	53.8kg
Height	1,240mm

LOWER

Weight	68.8kg
Height	914mm
Depth	440mm(Not including Foot Step)
	600mm(Including Foot Step)



Main Parts on the Lower Part

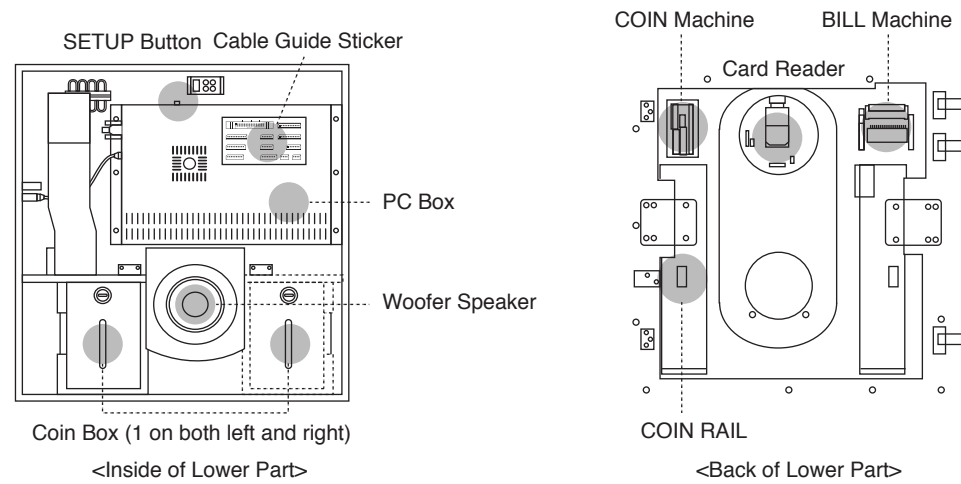

Other Parts

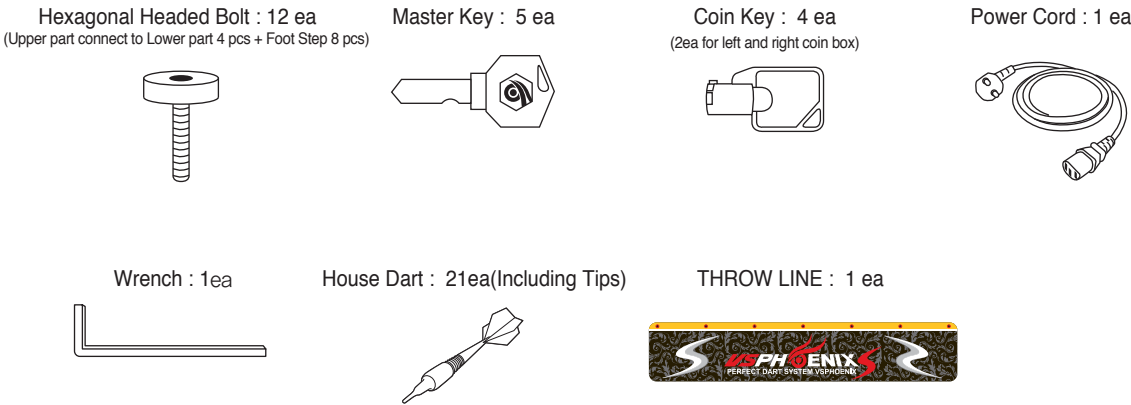

Main Parts of PC Box

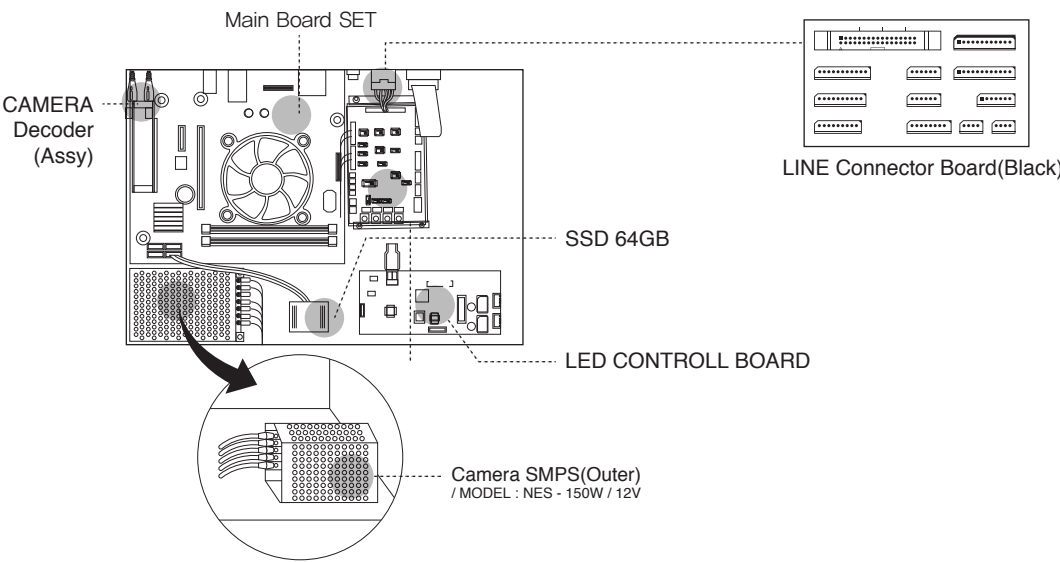



## ⚠ Notice before Installation

1. Be careful with camera and its support to avoid breakage.
2. After installation, please fix machine with machine foot.
3. Should be setup by 2 or more person for safety

### A TYPE Assembly(Monitor in middle)

1. Assemble foot step and lower part.
- 2 Fasten the footboard to bottom part by using 8 of hexagonal headed bolt.
- 3 Make sure the 4 footsteps are horizontally on flat surface. If you have to install the machin on inclined plane, use paper or plastic to make the surface horizontal level.

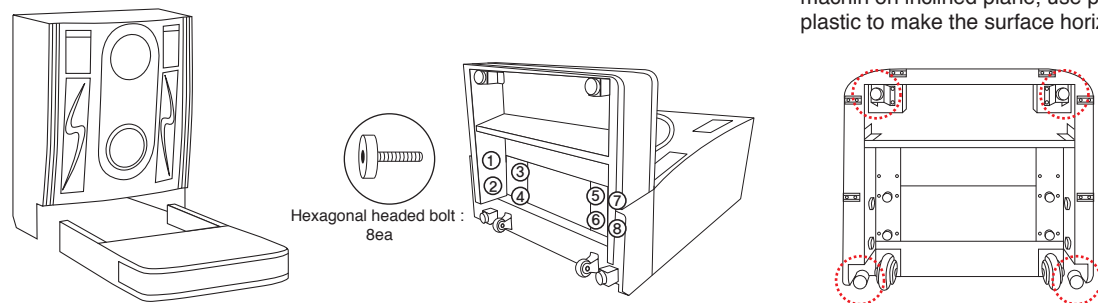

- 3 Prepare the upper part and lower part
- 4 Lift up the upper part and place it on top of the lower part. (Should be setup by 2 or more person)
- 5 Remove steel plate on the back.

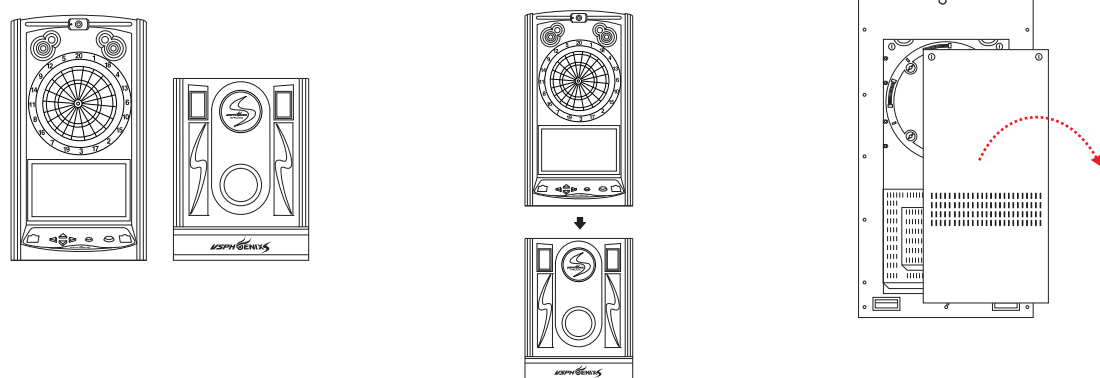

- 6 Tighten Hexa Bolts by using hex wrench.
- 7 Connect cables according to Cable guide sticker on the PC Box.
- 8 Completed assembly of the machine.

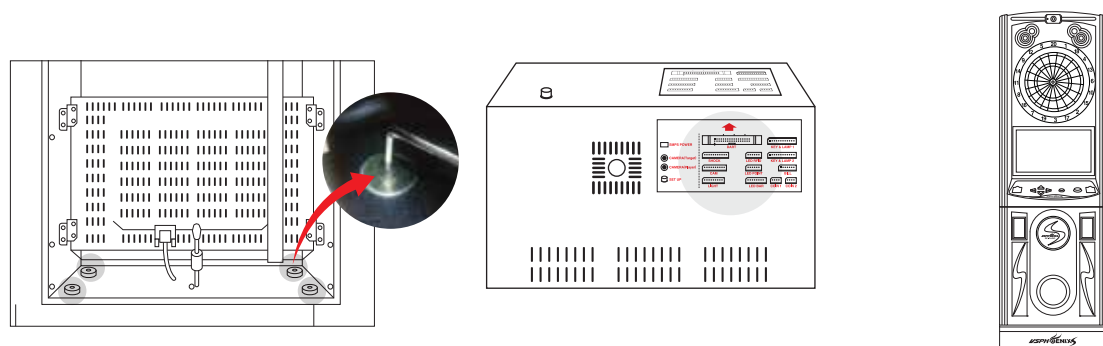

### B TYPE Assembly(Monitor on top)

⚠ Should be setup by 2 or more person for safety.

#### Required Parts

Top Bracket 1ea / Wrench Bolts 4ea(Including Washer) / LED Monitor 1ea / Monitor Cable 3M 1ea / Wooden Pannel 1ea / AD paper 1ea / Protection Acrylic 1ea / Screw 4ea

- 1 Remove steel plate on the back
- 2 Remove wooden plate on the back

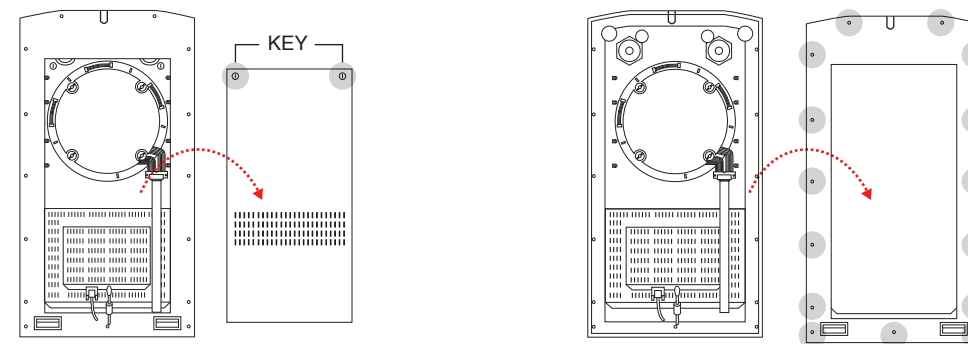

- 3 Disconnect Sensing PCB cables
- 4 Remove LED monitor

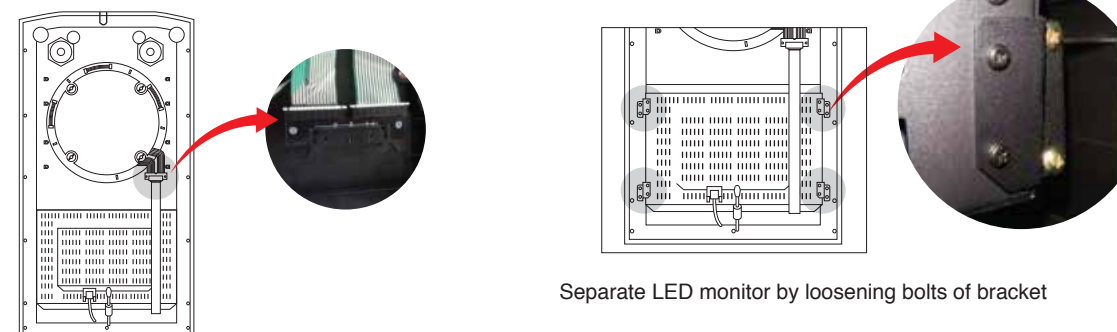

※ Pictures of the bolts used when dual monitor is combined.







- 5 Attach the wooden panel to where the monitor was placed. (Same size as LED Monitor)



- 6 Insert AD paper between wooden panel and acrylic board.



<TIP> When you insert AD paper, it will be easier if you fix the bolts on the below beforehand.

- 7 Prepare LED monitor Bracket

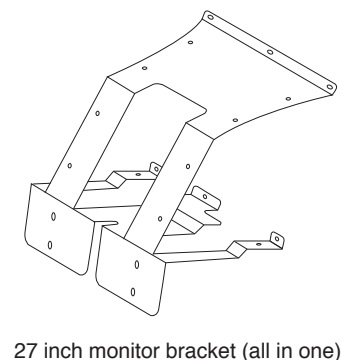
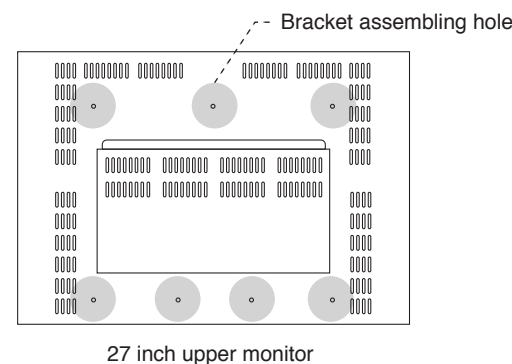

- 8 Attach monitor on bracket

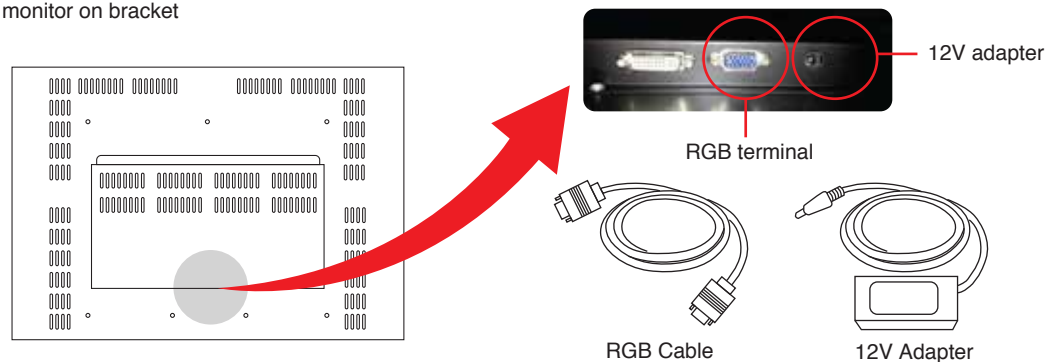

※How to install Transformer and pictures of the bolts to be used.

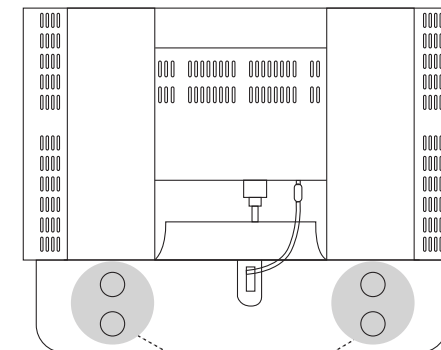
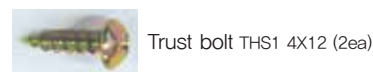
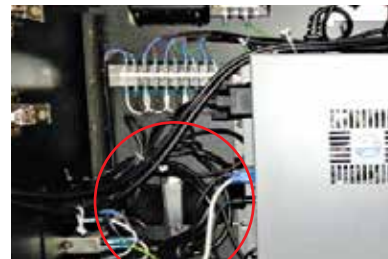

Bracket assembling hole

- 10 Put wooden panel on the back

※ Pick monitor cable and adapter cable throughout small hole when you combine wooden case with machine.

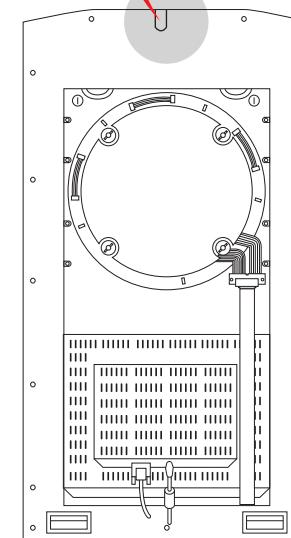

- 9 Completed image



- 11 Combine monitor bracket with upper

- 1) Connect monitor cable to DVI.
  - 2) Connect monitor power cable.
- (Tighten the bolts to fix tightly.)

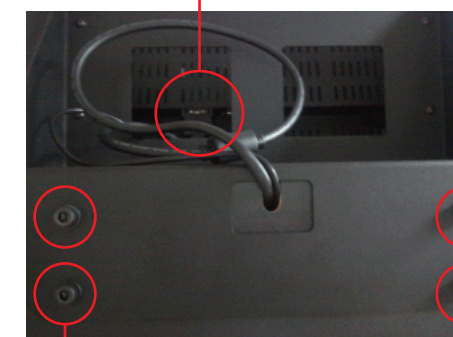

※ Tighten the bolts to fix the monitor tight before you connect the cables.





## THROW LINE Distance Measurement

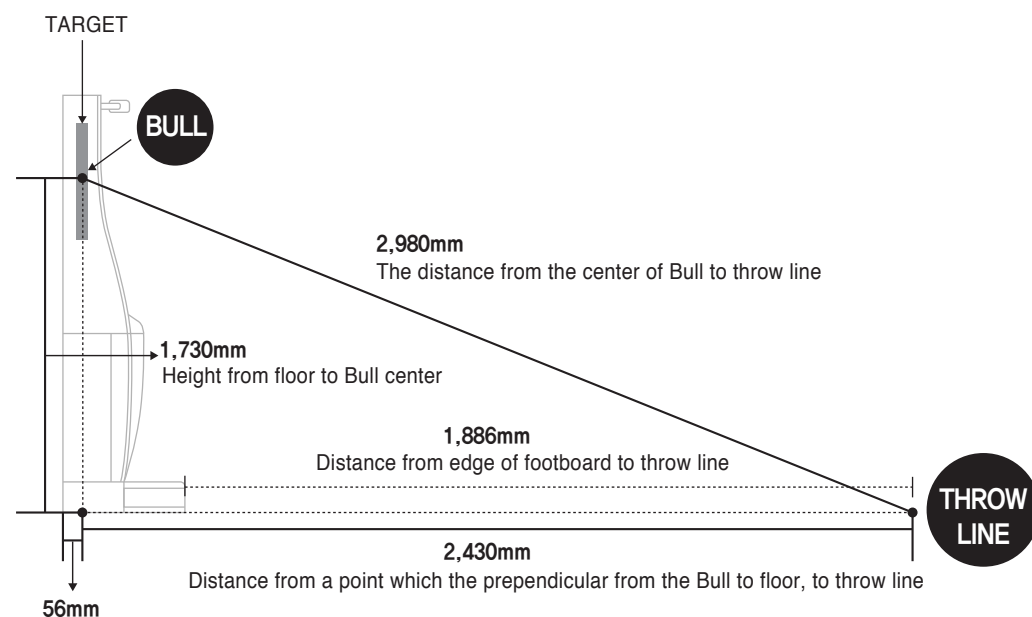

- 1 The diagonal distance from center of IM BULL to the starting point of throw line should be 2.983mm.
- 2 The throw line should be placed 1.970mm far away from the edge of VSPHOENIX S footboard.
- 3 Throw line should be perpendicular to the main body

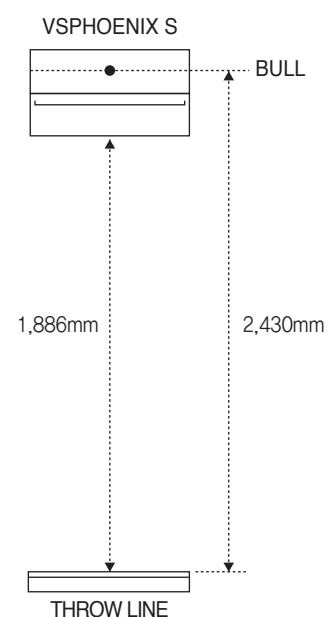

## Mark the edge line of footboard

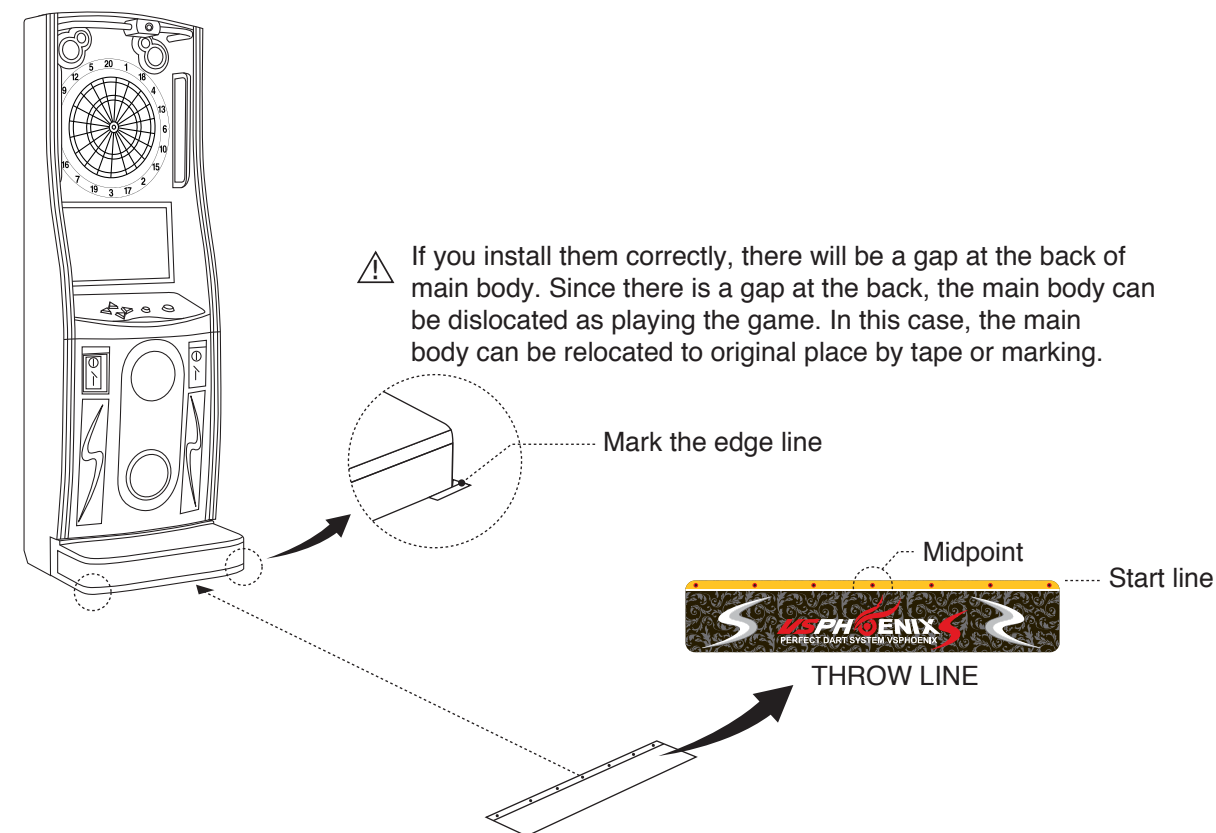





THROW LINE Distance Measurement

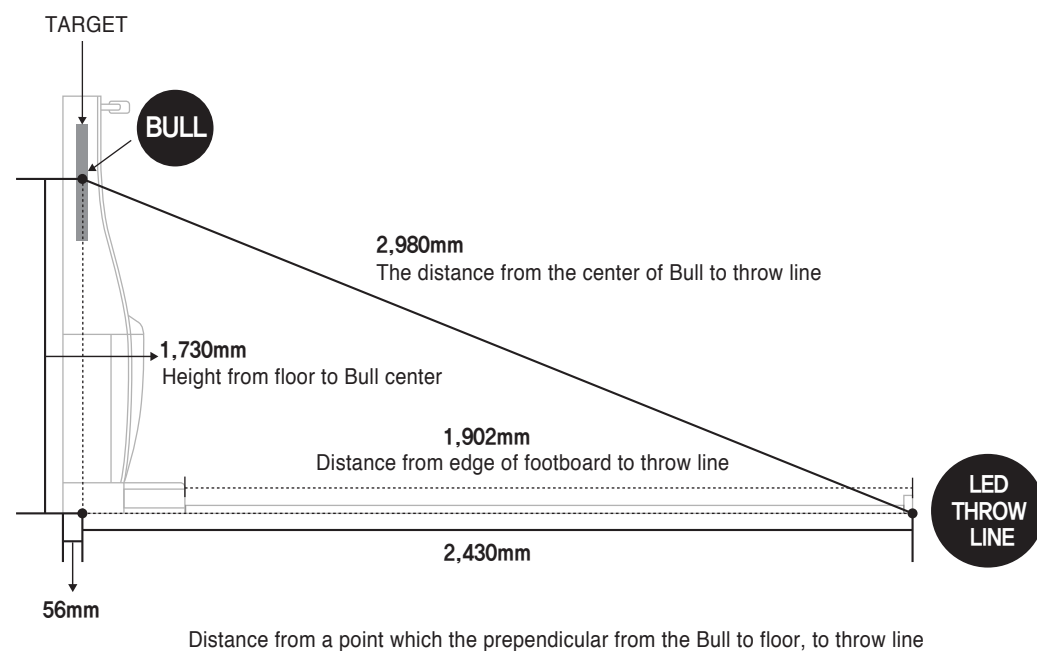

- 1 The diagonal distance from center of IM BULL to the starting point of throw line should be 2.983mm.
- 2 The throw line should be placed 1,902mm far away from the edge of VSPHOENIX S footboard.
- 3 Throw line should be perpendicular to the main body



THROW LINE Distance Measurement

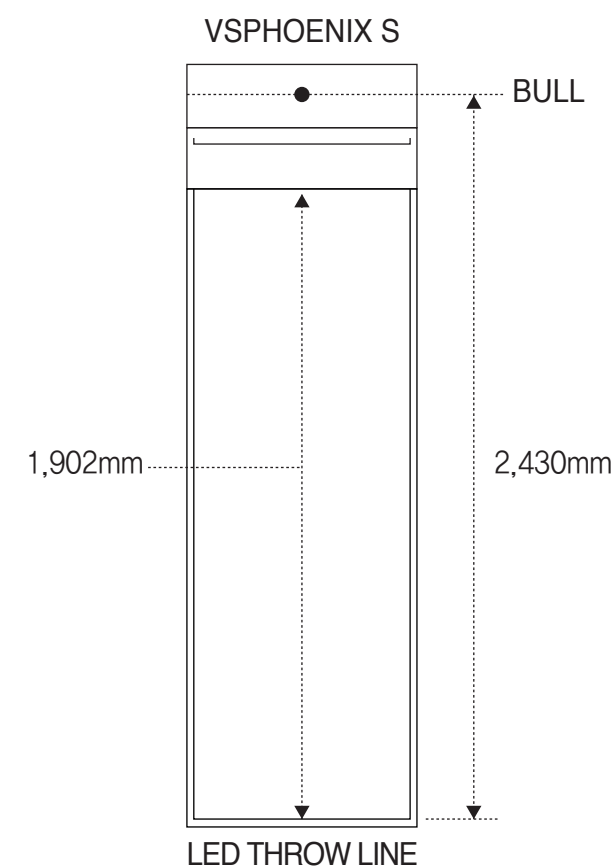



## Router Connection

1. Before the installation, check if LAN cable and router is ready at the installation shop.
2. Connect LAN cable to router WAN; and after putting additional LAN orderly, connect them to VSPHOENIX S

⚠ We recommend the use of wired router to enjoy a smooth versus movie.  
(VERSUS MOVIE can be running abnormally if you use wire/wireless router.)

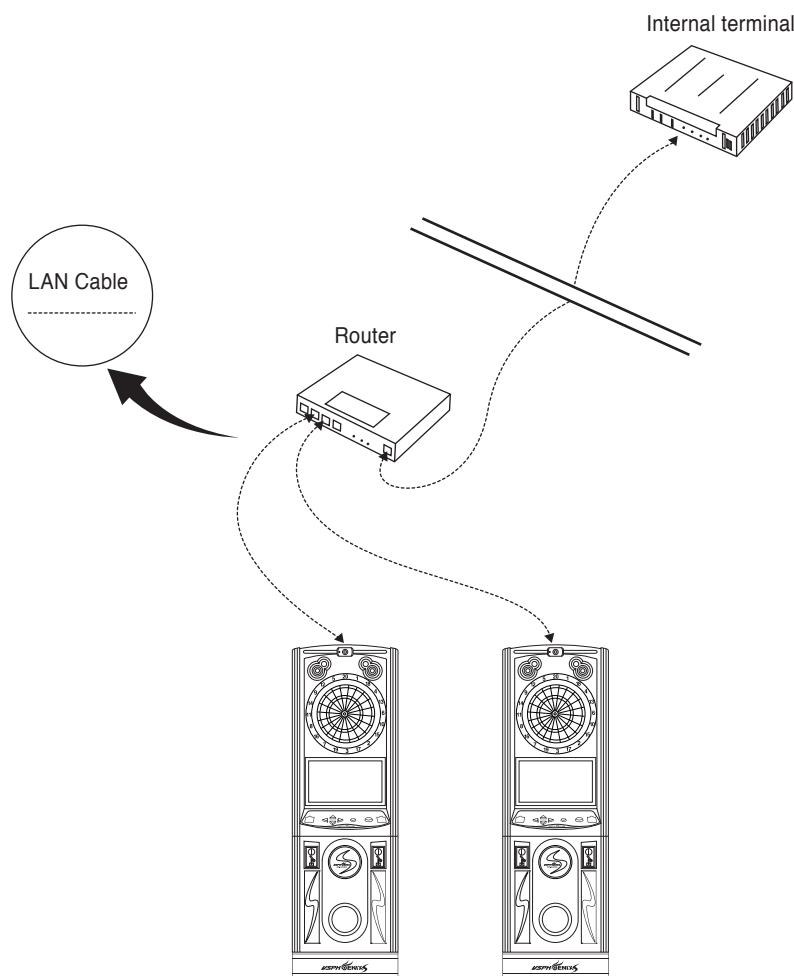

Example: VSPHOENIX S 2 units



## ONLINE SET UP

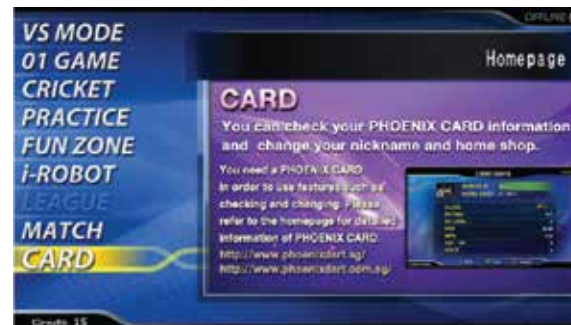

### MAIN SCREEN

Select the card at the game menu screen.

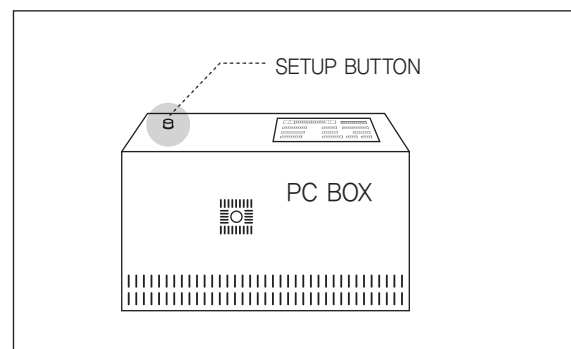

### HOW TO GET INTO SET UP MENU

Open the lower part of VSPHOENIX S and press the setup button on the top of pc box.

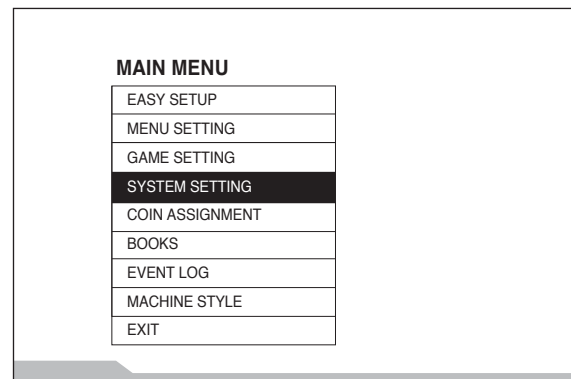

### MAIN MENU - Step 1

Select the system setting at the main menu.

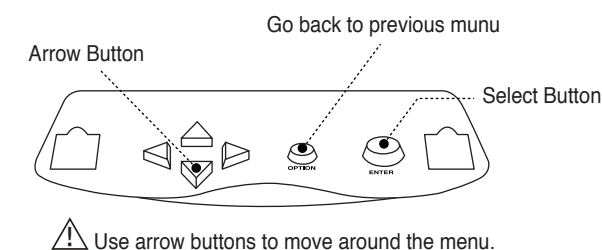

⚠ Use arrow buttons to move around the menu.

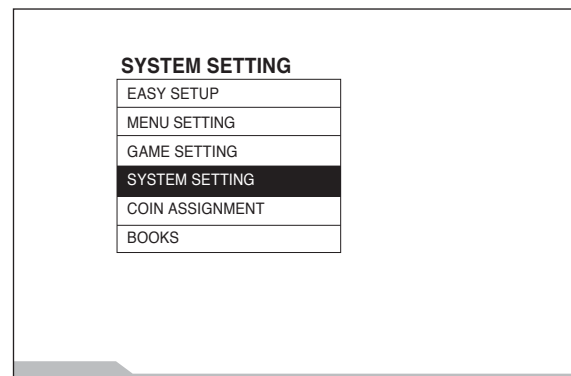

### SYSTEM SETTING - Step 2

Select the system setting at the system setting screen.

**SYSTEM SETTING**

SET TIME
<b>SET NETWORK</b>
SET ADMIN CARD
DEFAULT SETTING
RESTART PHOENIX

**SYSTEM SETTING Step 3**

Select the set network at the system setting screen.

**SET NETWORK**

USE NETWORK	YES
DHCP	YES
IP ADDRESS	192.168.0.44
GATEWAY	192.168.0.1
MAC ADDRESS	00:1F:D0:1A:XX:XX
DNS ADDRESS	211.53.XXX.XXX
GAME SERVER	211.106.XX.XX
GAME PORT	XXXX

INPUT NUMBER : DART BOARD 1-9, 10(0)  
 DELETE NUMBER : LEFT BUTTON  
 DOT(.) : BULL

**SET NETWORK - Step 4**

Set network

**SET NETWORK**

The ID Address and Gate way will be automatically set up when DHCP is in YES mode. However, if setting up manually, put DHCP in NO mode and enter the IP Address and Gate way.

**SET NETWORK**

USE NETWORK	YES
DHCP	YES
IP ADDRESS	192.168.0.44
GATEWAY	192.168.0.1
MAC ADDRESS	00:1F:D0:1A:XX:XX
DNS ADDRESS	211.53.XXX.XXX
GAME SERVER	211.106.XX.XX
GAME PORT	XXXX

INPUT NUMBER : DART BOARD 1-9, 10(0)  
 DELETE NUMBER : LEFT BUTTON  
 DOT(.) : BULL

**Set up Use network as YES mode**

This set up is for deciding whether you use an online or not. (You can change them as YES mode when you transfer the offline machine to online.)

**Set up DHCP as NO mode**

If you don't set up as No mode, you are not able to enter the IP Address and Gateway manually.

## ※ How to enter the setting

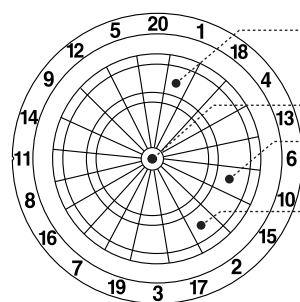

1 → 1

BULL → .

10 → 0

2 → 2

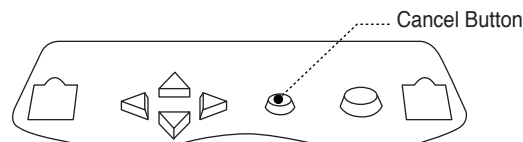
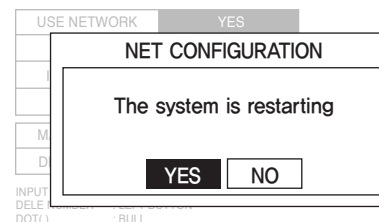
**SET NETWORK****Rebooting selection-screen**

If the selection screen is asking to restart, choose yes and press enter.

**GAME UPDATE**

업데이트 중입니다.  
전원을 절대 끄지 마세요.

**Automatic online update**

As the picture on the left, the automatic online update will be installed as VSPHOENIX S is rebooted. The update may take approximately 5 to 10 minutes and you need to wait until the update is finished.

⚠ An automatic update will be installed only there is thing to update.

**Rebooting is completed.**

If the rebooting is completed, it will be marked as online at the right-top side. Then, select the card menu on the main menu.

**Card touch screen**

When a card touch screen is appeared, touch the online card to the card reader





Check card touch

Your information will be shown at the card pane if a card is touched on.

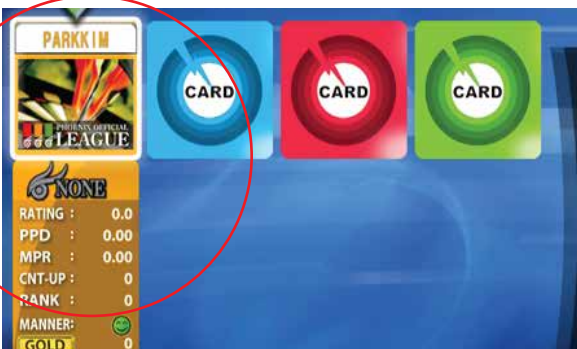

If online setting is not working



If online setting is not working

Card-1 will be shown at the card nick name.

Set network FAQ

If online setting is not working, please refer to the below according to the signs.

- 1) When automatic update is not installing when rebooting,  
→ The network may not be connected correctly. Please check the online status
- 2) If main screen is not showing up even the rebooting time is over,  
→ Rebooting is OS reading and program update; thus, it may take approximately 5 to 10 minutes. If no changes are found even after 5 to 10 minutes, please check the network.
- 3) If no response is occurred even the card touched the censor  
→ The card or sensor might be defected. Please contact an administrator.
- 4) 4) When a card is touched on the reader; however, no response is found upon the screen and only beep sound is produced,  
→ The card or sensor might be defected. Please contact an administrator.
- 5) 5) If card-1 is shown on your card ID on the card touch screen,  
→ The network connection might be the problem. Please check the online status.

■ How to check the online

- Check if network modem and hub power are ON
- Check the LAN of modem/ hub/ phoenix for the connection of LAN cables.
- Start the online setting step again

■ If the LAN line is connected normally

Green light will be on and orange light will blink on and off below the internet connector on mainboard.

※ If these errors are continuously occurred, please contact the head company.



## 1. How to get into SETUP MODE by pressing Setup button on PC Box

1. Open the lower door of VSPHOENIX S with power ON.
2. If you press the SETUP button on top of the PC Box, you will get into SETUP mode.

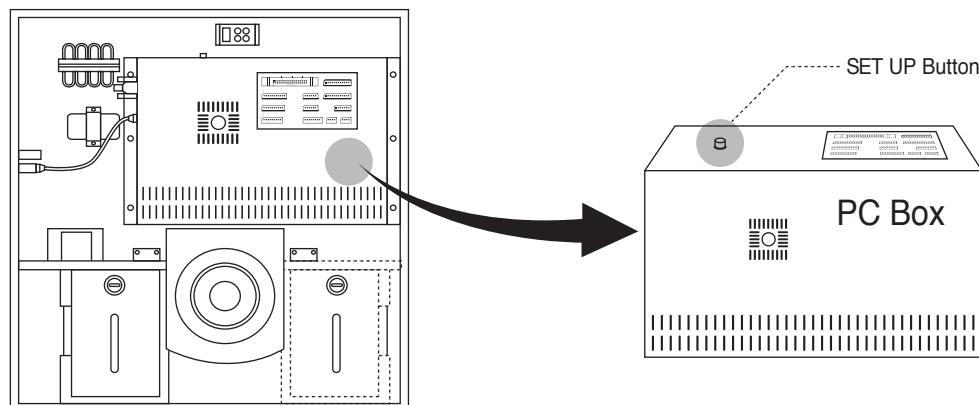

## SET UP MODE CONTROL

### MAIN MENU

EASY SETUP
MENU SETTING
GAME SETTING
SYSTEM SETTING
COIN ASSIGNMENT
BOOKS
EVENT LOG
MACHINE STYLE
EXIT

You can use arrow buttons to set the menu.

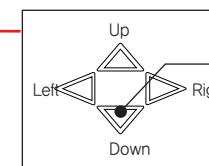
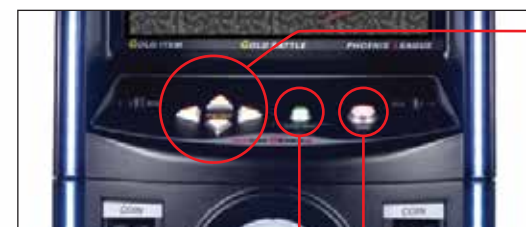

1. Arrow Buttons  
Use the arrow keys to navigate the menu.

### 2. ENTER Button

※ Use the Arrow Buttons to navigate the menu. And select menu by pressing Enter Button. After selection, press Cancel Button to exit the menu.

※ To go to GAME screen from SETUP MODE, press Option button.

### 3. OPTION Button(Also as Cancellation Button) It works as EXIT button.

## 2. HOW TO SET ADMIN CARD

1. Check if the game screen of VSPHOENIX S LED monitor is the main screen..
2. Touch the ADMIN CARD at the card reader machine



⚠ If video is playing on screen, press a button to stop it.

### HOW TO SET ADMIN CARD

You can enter into SETUP mode without opening top of VSPHOENIX S  
There is 2 ways to do as followings.

1. OPERATOR: An operator has an authority to set up all things in setup menu including payment and setting.
2. LOCATION: Only EASY SETUP including volume, adjust and hardware test are allowed to setup.

#### HOW TO SET ADMIN CARD

1. Be ready to have a phoenix card can be used at the shop.
2. Open the VSPHOENIX S lower door. Press the setup button on top of the PC Box and enter into the main menu.
3. Select SYSTEM SETTING.
4. Select the SET ADMIN CARD at the system setting.
5. Select the set of OPERATOR (or LOCATION) and touch the phoenix card you previously have prepared.
6. When a card data at the right side is shown, select the SET and press the red button.





## SETUP MODE Screen Setting-1

## SETUP MODE MAIN MENU

## MAIN MENU

EASY SETUP
MENU SETTING
GAME SETTING
SYSTEM SETTING
COIN ASSIGNMENT
BOOKS
EVENT LOG
MACHINE STYLE
EXIT

## SETUP MODE DETAILED MENU

## EASY SETUP

INTRO MOVIE SOUND	OFF
SOUND TEST	0
MOVIE TEST	0
LOCAL RANK CLEAR	01 GAME
PLAYER CHANGE TIME(SEC)	DEFAULT
REMOVE DART TIME(SEC)	2.0
SNAPSHOT	ON
VOLUME SETTING	
HARDWARE TEST	
CAMERA SETTING	
LED SETTING	

## MENU SETTING

VS MODE	+	ENABLE
RECOMMEND	+	ENABLE
BEGINNER	+	ENABLE
01 GAME	+	ENABLE
CRICKET	+	ENABLE
PRACTICE	+	ENABLE
FUN ZONE	+	ENABLE
LEAGUE		ENABLE
DCROWN	+	ENABLE
MATCH	+	ENABLE
CARD		ENABLE
PROMOTION		ENABLE

## GAME SETTING

01 GAME
CRICKET
PRACTICE
FUN ZONE
BEGINNER
ETC

## SYSTEM SETTING

SET TIME
SET NETWORK
SET ADMIN CARD
DEFAULT SETTING
RESTART DARTS MACHINE

1. EASY SETUP : You can set up sound setting, hardware test and volume camera LED.  
(You can access to easy setup also with location card.)
2. MENU SETTING : You can check whole menus and under menus whether they are running or not.
3. GAME SETTING: You can set detailed contents of each game.
4. SYSTEM SETTING: You can setup the important setting of machine.
5. COIN ASSIGNMENT: You can set coin / credit.
  - A. Coin setting
  - B. Happy hour setting
  - C. Option setting

## COIN ASSIGNMENT

HAPPY HOUR SETTING
OPTIONS

## SETUP MODE Screen Setting-2

## SETUP MODE MAIN MENU

## MAIN MENU

EASY SETUP
MENU SETTING
GAME SETTING
SYSTEM SETTING
COIN ASSIGNMENT
BOOKS
EVENT LOG
MACHINE STYLE
EXIT

## SETUP MODE DETAILED MENU

## BOOKS

BOOKS DISPLAY
CASH SETTLEMENT SETUP
CASH SETTLEMENT COLLECTION

## EVENT VIEWER

VIEW EVENT LOG
DELETE LOG FILE

## MACHINE STYLE SETTING

MENU STYLE	PHOENIX
REVOLUTION	1ST STAGE

6. BOOKS : You can check coin and game date.
  - A. BY EARNING : Add up the coin date in applicable period.
  - B. BY TIME & DATE : Record the coin date according to date and day.
  - C. BY GAMES : Record the coin date of each game.
7. EVENT LOG : You can check error history.
8. MACHINE STYLE : You can set main menu styles for whole machine. You can set it as a Normal Machine or a Perfect Machine.
9. EXIT : Go back to the demo screen from SETUP MAIN MENU.





Explaining EASY SETUP screen

EASY SETUP Menu

EASY SETUP	
INTRO MOVIE SOUND	OFF
SOUND TEST	0
MOVIE TEST	0
LOCAL RANK CLEAR	01 GAME
PLAYER CHANGE TIME(SEC)	DEFAULT
REMOVE DART TIME(SEC)	2.0
SNAPSHOT	ON
VOLUME SETTING	
HARDWARE TEST	
CAMERA SETTING	
LED SETTING	

1. INTRO MOVIE SOUND : You can set an intro movie sound.  
A. If you set this "ON", it will make a sound when intro movie is playing.  
B. If you set this "OFF" it will not make a sound when intro movie is playing.
2. SOUND TEST : You can check all sound types that are playing at the VSPHOENIX S. Using a left/right button, select the sound effect; and play that sound by pressing enter button.
3. MOVIE TEST : You can watch all videos that are playing at the VSPHOENIX S.
4. LOCAL RANK CLEAR : Delete the game ranking you have selected.
5. PLAYER CHANGE TIME(SEC) : Set up the player replacement time.c
6. REMOVE DARTS TIME(SEC) : You can set the time of preparing darts.
7. SNAPSHOT

Explaining MENU SETTING screen

MENU SETTING		
VS MODE	+	ENABLE
RECOMMEND	+	ENABLE
BEGINNER	+	ENABLE
01 GAME	+	ENABLE
CRICKET	+	ENABLE
PRACTICE	+	ENABLE
FUN ZONE	+	ENABLE
LEAGUE		DISABLE
DCROWN	+	ENABLE
MATCH	+	ENABLE
CARD		ENABLE
PROMOTION		ENABLE

1. You can select menu by using up/down buttons and make it enable or disable by using left / right buttons.

MENU SETTING			
VS MODE	+	ONLINE	ENABLE
RECOMMEND	+	GLOBAL ONLINE	ENABLE
BEGINNER	+	REVOLUTION	ENABLE
01 GAME	+		
CRICKET	+		
PRACTICE	+		
FUN ZONE	+		
LEAGUE			
DCROWN	+		
MATCH	+		
CARD			
PROMOTION			

2. If press Select Button on VS MODE, you will see the screen on left.  
※ REVOLUTION is possible to choose only when tournament period.



GAME SETTING Screen Explanation

GAME SETTING MENU

GAME SETTING	
① 01 GAME	
② CRICKET	
③ PRACTICE	
④ FUN ZONE	
⑤ BEGINNER	
⑥ ETC	

①	<b>01 GAME</b>
	301 GAME
	501 GAME
	701 GAME
	901 GAME
	1101 GAME
	1501 GAME

④	<b>FUN ZONE</b>
	GOLD HUNTING
	KUNITORI
	3 IN LINE
	JUMP UP
	HYPER JUMP UP
	BOXER
	CARNIVAL
	VS LET'S GO
	BALLOON

②	<b>CRICKET</b>
	STANDARD CR.
	CUT - THROAT CR.
	RANDOM CR.
	PICK THROAT CR.
	HIDDEN CR.

⑤	<b>BEGINNER</b>
	COUNT UP LIGHT
	CRICKET LIGHT
	3 IN LINE LIGHT
	TEKICHU

③	<b>PRACTICE</b>
	COUNT - UP
	CR. COUNT - UP
	BULL SHOOT
	HALF - IT
	VS ARCHERY
	OVER
	UP DOWN COUNT - UP

⑥

**ETC**

ONLINE VS CREDIT(S)	1
FREE ROBOT CREDIT	YES
GOLD BATTLE	ENABLE



SYSTEM SETTING Screen Explanation 2

GAME SETTING ▶ 01 GAME ▶ 301 GAME

301 GAME

CREDIT(S)	1
HAPPY HOUR CREDIT(S)	1
ROUND LIMIT	1
BULLS EYE	25/50
BUST LIMIT	NO

1. CREDIT(S) : You can set up the number of credit per one game.
2. HAPPY HOUR CREDIT(S) : You can set up the happy hour credit.  
※ It changes to set up credit on happy hour.
3. ROUND LIMIT : You can set up the number of round.
4. BULLS EYE : You can set up the bull (single and double) score. (25/50, 50/50)
5. BUST LIMIT : If you select the number of bust and the designated number of bust are came up during the game, that game will be Busted.  
Example : When 3 players are playing a game and setting bust limit as 3, the player who bust 3 times is not able to throw the darts any more.  
※ BUST LIMIT MENU applies only on 01 GAME.

※ The settings of the other games are same as 301 GAME.

SYSTEM SETTING Screen Explanation - 1

SYSTEM SETTING MENU

SYSTEM SETTING

- ① SET TIME
- ② SET NETWORK
- ③ SET ADMIN CARD
- ④ DEFAULT SETTING
- ⑤ RESTART PHOENIX

①

SET TIME

20XX - 0X - X0\_15.27.59

YEAR	2011
MONTH	1
DAY	20
HOUR	15
MIN	27

④

SYSTEM SETTING

SET TIME  
SET NETWORK  
SET ADMIN CARD  
DEFAULT SETTING  
RESTART PHOENIX

CONFIG INITIALIZE

SYSTEM INITIALIZATION

YES NO

②

SET NETWORK

USE NETWORK	YES
DHCP	YES
IP ADDRESS	192.168.0.44
GATEWAY	192.168.0.1
MAC ADDRESS	00:1F:D0:1A:XX:XX
DNS ADDRESS	WindowsDHCP
GAME SERVER	211.43.195.205
GAME PORT	5042

INPUT NUMBER : DART BOARD 1-9, 10(0)  
DELE NUMBER : LEFT BUTTON  
DOT(.) : BULL

⑤



RESTART

③

SET ADMIN CARD

OPERATOR

CARD

SET  
CLEAR

LOCATION

CARD

SET  
CLEAR





## SYSTEM SETTING Screen Explanation - 2

## SYSTEM SETTING MENU

## SET TIME

20XX - 0X - X0\_15.27.59

YEAR	2011
MONTH	1
DAY	20
HOUR	15
MIN	27

## SET TIME

You can set up and change the date and time.

## SET NETWORK

USE NETWORK	YES
DHCP	YES
IP ADDRESS	192.168.0.44
GATEWAY	192.168.0.1
MAC ADDRESS	00:1F:00:1A:XX:XX
DNS ADDRESS	WindowsDHCP
GAME SERVER	211.43.195.205
GAME PORT	5042

INPUT NUMBER : DART BOARD 1-9, 10(0)  
DELE NUMBER : LEFT BUTTON  
DOT(.) : BULL

## SET NETWORK

You can set up the network. The IP address and Gateway will be automatically given when connecting the router.

## SET ADMIN CARD

OPERATOR	SET CLEAR
LOCATION	SET CLEAR

## SET ADMIN CARD

1. Top operator has an authority to set up all in the main menu.
2. Below location can set up only EASY SETUP

## DEFAULT SETTING

## CONFIG INITIALIZE

System Initialization

YES NO

## DEFAULT SETTING

System Initialization

## SYSTEM SETTING

SET TIME
SET NETWORK
SET ADMIN CARD
DEFAULT SETTING
RESTART PHOENIX

## RESTART PHOENIX

Restart VSPHOENIX S



## COIN ASSIGNMENT Screen Explanation

## COIN ASSIGNMENT MENU

## COIN ASSIGNMENT

HAPPY HOUR SETTING

OPTIONS

## COIN ASSIGNMENT SETTING

You can set up happy hour setting and option.

## COIN ASSIGNMENT ► HAPPY HOUR

## HAPPY HOUR SETTING

HOUR	SUN	MON	TUE	WED	THU	FRI	SAT
0	HAPPY	--	--	--	--	--	--
1	HAPPY	--	--	--	--	--	--
2	HAPPY	--	--	--	--	--	--
3	HAPPY	--	--	--	--	--	--
4	--	--	--	--	--	--	--
5	--	--	--	--	--	--	--
6	--	--	--	--	--	--	--
7	--	--	--	--	--	--	--
8	--	--	--	--	--	--	--
9	--	--	--	--	--	--	--
10	--	--	--	--	--	--	--
11	--	--	--	--	--	--	--
12	--	--	--	--	--	--	--
13	--	--	--	--	--	--	--
14	--	--	--	--	--	--	--
15	--	--	--	--	--	--	--
16	--	--	--	--	--	--	--
17	--	--	--	--	--	--	--
18	--	--	--	--	--	--	--
19	--	--	--	--	--	--	--
20	--	--	--	--	--	--	--
21	--	--	--	--	--	--	--
22	--	--	--	--	--	--	--
23	--	--	--	--	--	--	--

## HAPPY HOUR SETUP

You can set up the time for happy hour.

The coin setting at the happy hour can be setting up at the setting screen of each game.

The setting screen is composed of day and time.

If you move a cursor to changed time and press the select button, you can designate as following.

- -- : Normal payment
- HAPPY : Set happy hour

## COINASSIGNMENT ► OPTIONS

## OPTIONS

FREE PLAY	NO
FREE CREDITS	0

CLEAR CREDITS

COIN	1
CREDITS	1
BILL	1
CREDITS	2

## OPTIONS

You can set up the option related to coin.

1. FREE PLAY : You can set up the FREEPLAY.
2. FREE CREDITS : You can add free credit (1 to 12).
3. CLEAR CREDITS : You can remove the credit remaining at current game machine.
4. COIN / CREDITS : You can set up the number of credit according to the inserted coin (you can set up 1 to 3).







## BOOKS Screen Explanation - 3

## BOOKS CASH SETTLEMENT SCREEN

**CASH SETTLEMENT SETUP**

FROM : 20XX/08/XX    TO:20XX/0X/0X

SERVICE	ONLINE	UPDATE	A/S
FEE	0	0	0
REVENUE	AFTER	AFTER	AFTER

LOCATIONÖS SPLIT(%)	0
---------------------	---

INPUT NUMBER : DART BOARD 1-9, 10(0)  
DELETE NUMBER : LEFT BUTTON

## CASH SETTLEMENT SETUP

This feature will automatically calculate the online, A/S and update costs, and coin profit distribution.

If you change the setting here, You can check your calculation result at the CASH SETTLEMENT COLLECTION menu.

## BOOKS CASH SETTLEMENT COLLECTION SCREEN

<b>CASH SETTLEMENT COLLECTION</b>	
<u>SUMMER FOR CURRENT COLLECTION</u>	
FROM 2010/08/20 TO 2011/01/20	
152 DAYS	
TOTAL-REVENUE :	221900
- FEES BEFORE SPLIT :	0
BALANCE TO SPLIT :	221900
LOCATION COMMISSION :	0
- FEES AFTER SPLIT :	0
LOCATION REVENUE :	0
OPERATOR REVENUE :	221900
<b>CLEAR / COMPLETE COLLECTION</b>	

## CASH SETTLEMENT COLLECTION

The profit distribution is automatically calculated in this screen.

If you enter whatever the price at the CASH SETTLEMENT SETUP, the calculation results will be shown automatically. You can delete the data after the coin calculation by date unit.



## EVENT VIEWER SETUP

### EVENT VIEWER SCREEN

[illegible]

## EVENT VIEWER

You can view a LOG data.

1. VIEW EVENT LOG : You can check the hardware and error status.
2. DELETE LOG FILE : You can delete a LOG file.

## MACHINE STYLE SCREEN EXPLANATION

MACHINE STYLE SETTING	
MENU STYLE	PERFECT
REVOLUTION	1st

## MACHINE STYLE SETTING

You can setup whole style of VSPHOENIX S MENU

1. MENU STYLE : You can setup Normal Mode / Perfect Mode / Revolution Final Mode.
2. REVOLUTION : You can setup each 1st / 2nd / 3rd Stage.

MACHINE STYLE SETTING	
MENU STYLE	REVOLUTION
REVOLUTION	THE FINAL



## HOW TO SETUP CREDIT

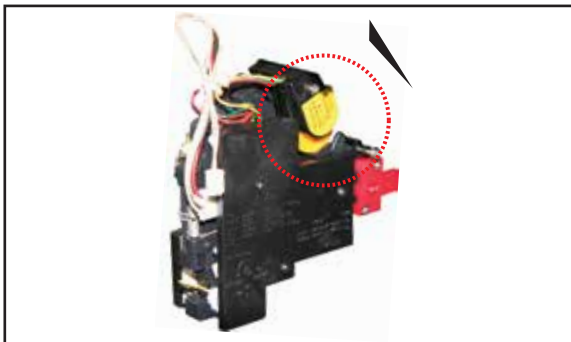

## Coin Machine Setting

Open the door at the lower of VSPHOENIX S and insert the coin into the coin selector.

⚠ If you use coins on bad condition, the machines will not response properly.

## SETUP MAIN MENU

EASY SETUP
GAME SETTING
SYSTEM SETTING
COIN ASSIGNMENT
BOOKS
EVENT LOG
EXIT
DEV MENU

IP Address :  
Server :

## Setup the number of credit per each game

1. Select the GAME SETTING at the SETUP MODE main menu.
2. Set up the number of credit per one game of each game.

## SETUP MAIN MENU

EASY SETUP
GAME SETTING
SYSTEM SETTING
COIN ASSIGNMENT
BOOKS
EVENT LOG
EXIT
DEV MENU

IP Address :  
Server :

## HAPPY HOUR SETTING

1. Select the COIN ASSIGNMENT at the SETUP MODE main menu
2. Select the HAPPY HOUR SETTING.
3. Setup the date and time.

## What is HAPPY HOUR?

This feature is to operate the game at the shop in designated date and time with additional fee.

- 1) Select the GAME SETTING at the main menu of SETUP MODE and set up the number of credit per one game of each game.
- 2) Set up YEAR / MONTH / DAY / HOUR / MIN at Set time of SYSTEM SETTING.

※ Happy hour will be automatically applied according to the time setting.

⚠ If the date and time of system is wrong, HAPPY HOUR setting will be also wrong.  
Therefore, please setup the correct date and time on SET TIME of SYSTEM SETTING MENU.



## Bill acceptor (ICI L77F)



Dip switch

## PAYMENT SETTING - FREE PLAY

## SETUP MAIN MENU

EASY SETUP
GAME SETTING
SYSTEM SETTING
COIN ASSIGNMENT
BOOKS
EVENT LOG
EXIT
DEV MENU

IP Address :  
Server :

## FREE PLAY SETUP

Select the COIN ASSIGNMENT.

## OPTIONS

FREE PLAY	YES
FREE CREDITS	0
CLEAR CREDITS	
COIN	CREDIT
500 WON	1

## OPTION SETUP

Set up FREE PLAY as YES mode at the OPTION.

※ If you set up as above, the Credit in the left side of main menu will be changed to free play.





### Segment Management Methods

1. The tip being stuck on the segment will be expanded as time goes by. As the tips are expanding, the segment also will be expanded. The expanded segment can be stuck on the spider (frame) and this may cause an error.
2. If above situation continues, the response of segment will be worse and the dart will be hard to remove. Also, the expanded segment due to the remaining and broken tips will make the hole near the plugged area smaller. Thus, throwing darts cannot be sticking.
3. In results, an athletic performance of player will be lowered since the points without regard to the throwing toward whatever the target, will be reflected.

⚠ The segment influences the dart game to the most. Since the condition of segment, whether it's good or bad effects the players' satisfactions and their images, you need to do manage the daily and inspection regularly.

### Daily management

In case of the tip is broken and remaining

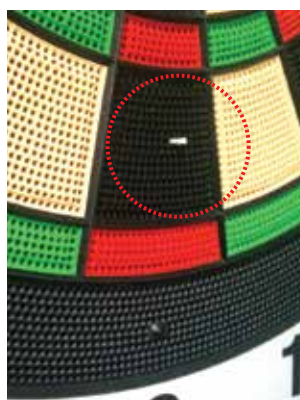

Nippers

In case of the tip is broken and stuck

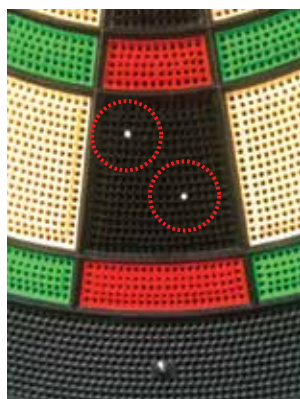

Remover

※ The target segment can be broke if you push in too hard.  
Please be careful when pulling them.

⚠ VSPHOENIX S target has a cover on the back so even if you push the tip into the target, the broken tips will be gathered inside the target due to it is designed to reduce target errors.



### Orders of Regular Scheduled Inspection

1. Open the door of the back of VSPHOENIX S and disconnect the sensing PCB cables.
2. Disassemble the back board by loosening the 4 of fly nuts.
3. After disassembling the back board, disassemble the sensing PCB, sensing rubber and segment
4. If the sensing rubber is worn out, change them with new one.
5. Remove the tips sticking on disassembled segment.
6. After the inspection, assemble them by opposite order.
7. Go into the SETUP MODE and test the sensor at the HARDWARE TEST of EASY SETUP. Check if all things are working properly.

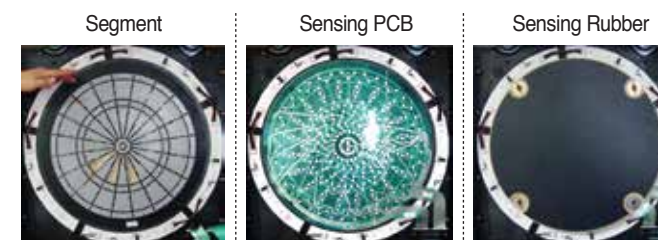

⚠ Use washer when you tighten fly nuts.

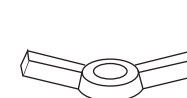

Fly nut



Washer

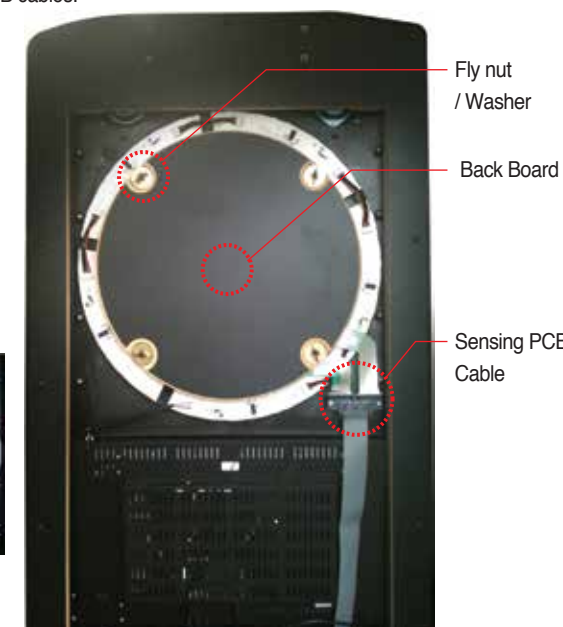



## 1. When all power is not working (lights are included)

1. Check the power whether it is plugged well.
2. Open the cover of fuse and check the fuse.  
(If the fuse color is black or disconnected, please change the fuse for 220V/5A.)
3. Check all the cables inside of lower part.

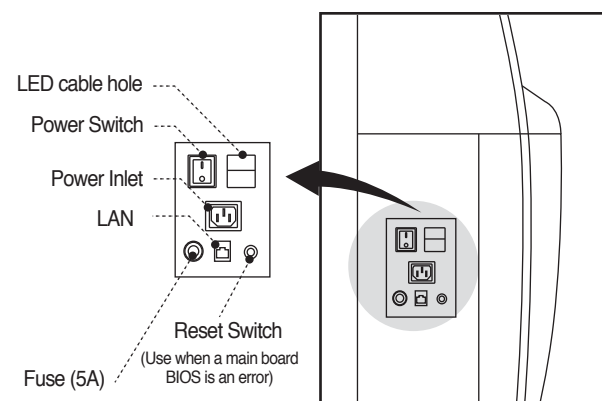

## 2. If the machine is not working but the light is on

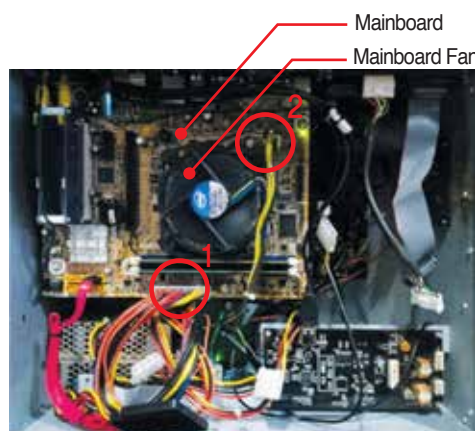

1. Check if the cable of no.1 power supply is connected properly.
  2. Check if the cable of no.2 power supply is connected to the mainboard properly.
  3. Check the power of mainboard(Fan) and then press reset switch on the side of machine.
  4. If the problem is not solved, then change Power Supply.
  5. If the problem is not solved with above solutions, change mainboard.
- ※ If you can see the screen and button light,  
- Check mainboard and I/O board cables
- ※ If you can't see screen but the lights are working on the buttons.  
- Check Memory / CPU / Mainboard/ DVI(RGB) Cable / Check LED Monitor
- ※ Check HDD (If you see 'Reboot and Select' on screen even you reconnect power cable and SATA cable, it is HDD defect.) and if there is a problem in HDD, please change HDD or Mainboard.e



## 3. If the screen is not working

1. Check DVI(RGB) is connected to the mainboard or LED monitor.
2. Check the monitor power cable is connected to LED monitor.
3. If there is no screen but you can hear the sound when you press any button of VSPHOENIX S, change DVI(RGB) cable / LED Power cable / LED Monitor.

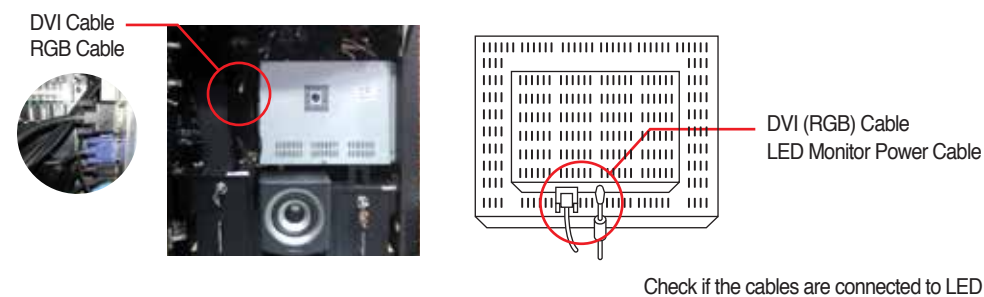

## 4. MISS recognition error

1. Check the reception control button of I/O board. When the problem continues, check the vibrating sensor cable.
2. You need to change the cable if there is problem with vibrating sensor cable.  
※ Disassemble each of all 4 (white) cables at the left bottom side and check. (If 2 are ok among all 4, the miss recognition will be available.)  
※ If you use the defected sensor after disassembling the cable, the miss recognition will be available.)
3. Change the vibrating sensor if no problem with I/O board is found.  
※ If the sensor makes error, check where the point is show on screen and disconnect the cables one by one from vibrating sensor and then check where the noise come from.  
※ Change the vibrating sensor which is making noise.

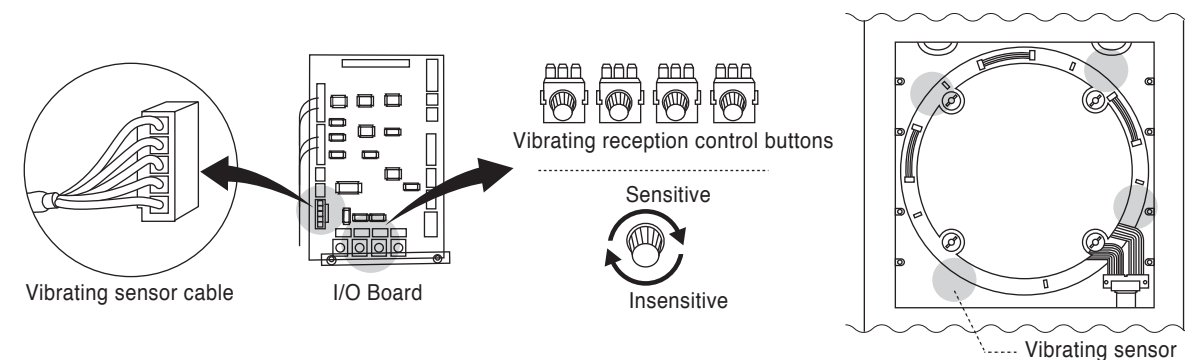





## 5. If sound is not working

1. Check the speaker cable and re-connect and change the cable if there is problem. If no problem is found, check the volume setting at the setup mode.

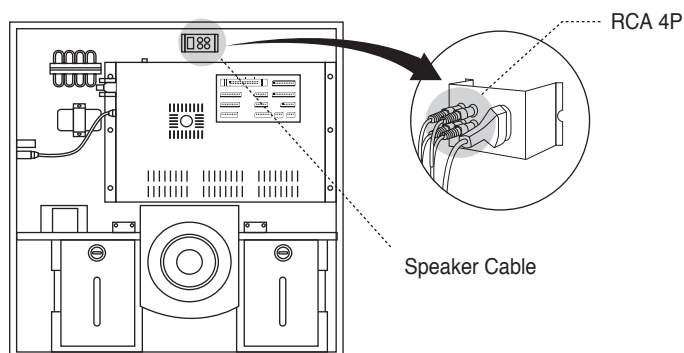

2. If there is problem with test mode, adjust the volume. If the problem is continuing, check the audio input cable (green) at the main board.

VOLUME CONTROL	
MASTER	128
GAME	128
AWARD	128
INTRO	128
BGM	128

SETUP MODE ▶ EASY SETUP ▶ VOLUME CONTROL

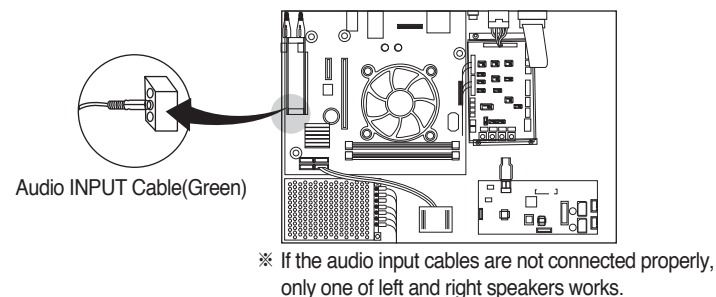

3. If there is no problem is found in audio input cable, check the woofer at the bottom.

※ Check the woofer status: Power/ adjust volume / cable connection status

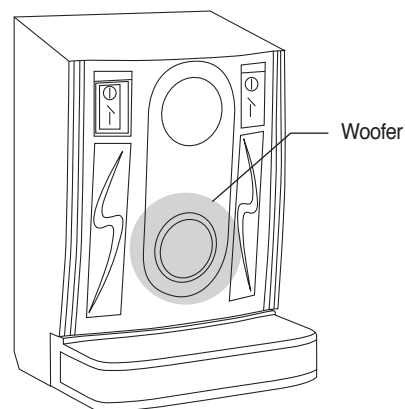

### If only one speaker is working.

1. Check the speaker cables on both right and left back sides of target.
2. Check upper and lower of the speaker cables on middle of upper part.
3. Check lower woofer speaker cable.
4. If the problem is not solve with the above solution, change the broken speaker.
5. Check solderings of RCA 4P.
6. Change mainboard



4. Replace SSD or Macinboard when no problem was found on lower woofer after replacement of woofer.

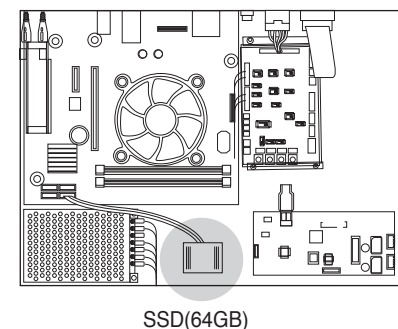

## 6. If it doesn't recognize the coin

1. Chack if the sample coin is placed properly in coin machine.
2. Check the cable connection. Reconnect the cable if there is problem.
3. Check the coin machine. Change the coin machine if there is problem.
4. Check an I/O board. Change the I/O board if there is problem.
5. You need to change the cable if the problem continues.

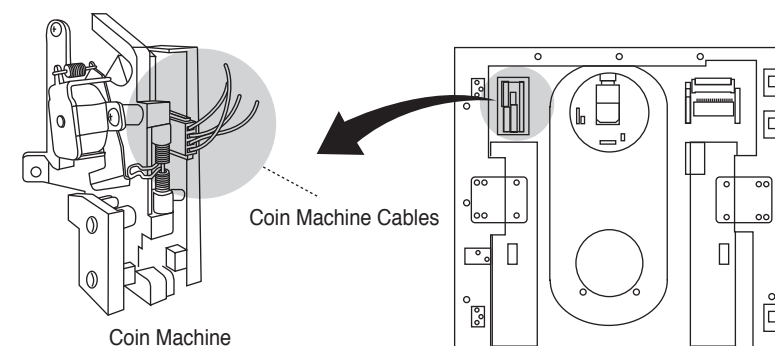

## 7. If it doesn't recognize the bill

1. Check if lamp on bill acceptor is flashing.
2. Check if bill acceptor cable is corretly connected.
3. Clean lense with a soft patch (alcohol) after checking if there are dirt on lense cover of bill acceptor.
4. Check if dip switch on bill acceptor is correctly set.
5. Replace I/O board if there is no problem found on bill acceptor.

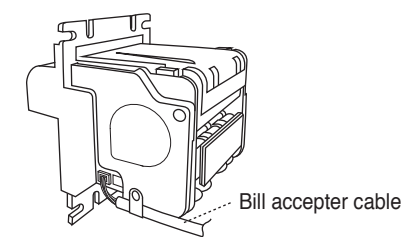
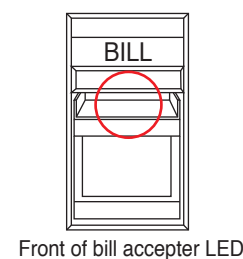

Locking lever on bill acceptor lense

## 8. Sticking during the game ( it will mark as OO MATRIX STUCK)

1. Check the I/O board and need to change if there is problem.
2. Remove the dart tip or clean the target. But, you need to change the target if there is problem with target itself.





### 9. If the coin is not inserted in

Check the coin control screw at the back of coin machine. Adjust the size of coin hole if there is problem.

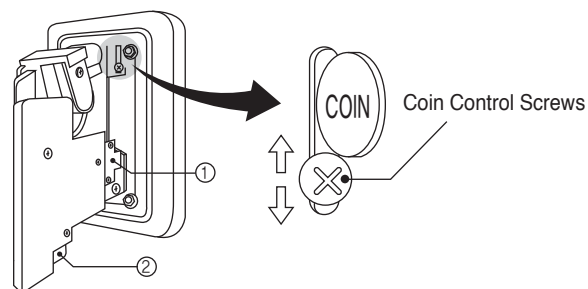

※ Push the red plastic stick (no.1) on right side in the coin machine.  
Pull no.2 which is on the bottom and check any coin is stucked.

### 10. If a phoenix card is not recognized

1. Check the card reader cable. If there is problem, try to reconnect or change the cable.
2. Check the card reader. It needs to be changed if there is problem.

※ If the red light is ON at the board lamp, the power is providing properly.

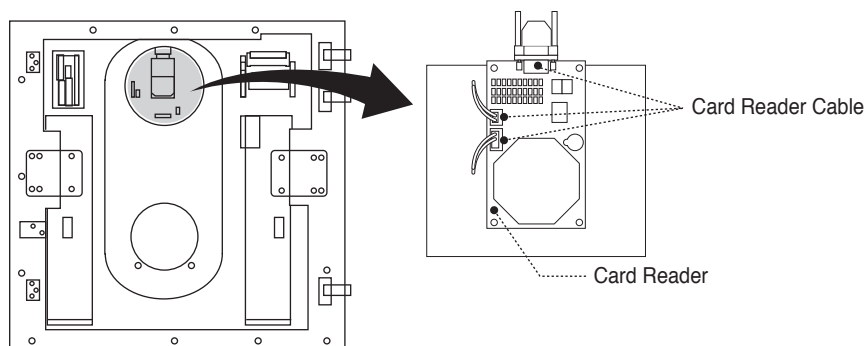

### 11. If online is not working

1. Check the action status of router or hub. If it doesn't work, you need to reboot or change them
  2. Check the LAN. You need to reconnect them if there is problem with LAN itself.(Example: If the green LED which is under the LAN connector of mainboard is not on.)
  3. Check if IP address can be tracked at the test menu.
  4. Check the main board and LAN connector. You need to change the main board or LAN connector if there is problem.
- ※ After removing LAN connector, you need to connect the LAN to the main board directly.

### 12. If versus movie is not working

1. Check if the router is correctly setting up.
2. After checking the VSERSUS MOVIE connection time, please confirm the MAC ADDRESS and camera whether its power is On or Off with an administrator.

## FCC Information to User

This equipment has been tested and found to comply with the limits for a Class B digital device, pursuant to Part 15 of the FCC Rules. These limits are designed to provide reasonable protection against harmful interference in a residential installation. This equipment generates, uses and can radiate radio frequency energy and, if not installed and used in accordance with the instructions, may cause harmful interference to radio communications. However, there is no guarantee that interference will not occur in a particular installation. If this equipment does cause harmful interference to radio or television reception, which can be determined by turning the equipment off and on, the user is encouraged to try to correct the interference by one of the following measures:

- Reorient or relocate the receiving antenna.
- Increase the separation between the equipment and receiver.
- Connect the equipment into an outlet on a circuit different from that to which the receiver is connected.
- Consult the dealer or an experienced radio/TV technician for help.



## Caution

Modifications not expressly approved by the party responsible for compliance could void the user's authority to operate the equipment.

**FCC Compliance Information :** This device complies with Part 15 of the FCC Rules. Operation is subject to the following two conditions: (1) This device may not cause harmful interference, and (2) this device must accept any interference received, including interference that may cause undesired operation

## IMPORTANT NOTE:

### IMPORTANT Safety Instruction:

<b>CAUTION</b>	
To reduce the risk of electric shock, do not remove the top cover (or the rear section). No user serviceable parts inside, refer servicing to qualified personnel.	
	This symbol, wherever it appears, alerts you to the presence of uninsulated dangerous voltage inside the enclosure-voltage that may be sufficient to constitute a risk of shock.
	This symbol, wherever it appears, alerts you to the important operating and maintenance instructions in the accompanying literature. Please read the manual.

- 1) Read these instructions.
- 2) Keep these instructions.
- 3) Heed all warnings.
- 4) Follow all instructions.
- 5) Do not use this equipment near water.
- 6) Do not use near any heat sources such as radiators, heat resistors, stove, or other equipment that produce heat.

**CAUTION**  
**RISK OF EXPLOSION IF BATTERY IS REPLACED**  
**BY AN INCORRECT TYPE.**  
**DISPOSE OF USED BATTERIES ACCORDING**  
**TO THE INSTRUCTIONS**

**Information to user.**

The users manual or instruction manual for an intentional or unintentional radiator shall caution the user that changes or modifications not expressly approved by the party responsible for compliance could void the user's authority to operate the equipment. In cases where the manual is provided only in a form other than paper, such as on a computer disk or over the Internet, the information required by this section may be included in the manual in that alternative form, provided the user can reasonably be expected to have the capability to access information in that form.

**HONG International Corp.**

**3F, JnK Digital Tower 222-3, Guro-3Dong, Guro-Gu, Seoul, Republic of Korea**

**TEL : +82-2-6124-6731 / FAX : +82-2-6124-6759 / E-mail : [bbc@darts.kr](mailto:bbc@darts.kr)**