

1

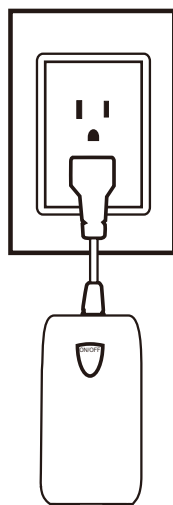

Scan the QR code to download REC App. You can also search keyword "ANKUOO" at App Store or Google Play to download REC App. Then register your account and log in.

2



Press the on/off button for more than 5 seconds until the Wi-Fi indicator starts to flash quickly. Wi-Fi Switch is now ready for synchronization.

3

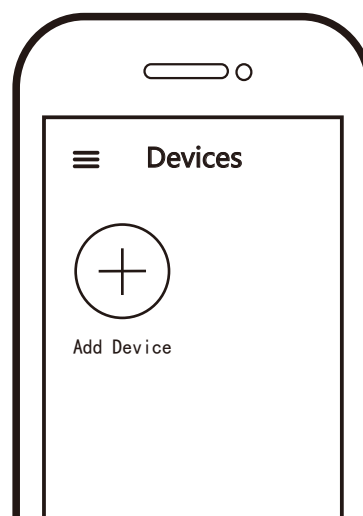

Connect your smart phone to Wi-Fi network and launch REC App. Click on the device menu to "Add Device".

4



Make sure your smart phone and Wi-Fi switch are in the same Wi-Fi network. The connecting process takes about 30-120 seconds, depending on your network condition and the length of Wi-Fi password.

5



If configure failed, please click AP at the right corner. Connect REC_AP_XXXXXX first, then connect the wifi router. Please visit www.ankuoo.com/support for more details.

6

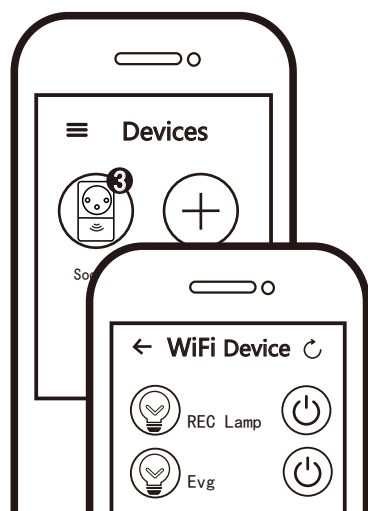

When configuration is done, the Wi-Fi switch will be shown on the REC App. You can change the ON/OFF state at the home-page.

7

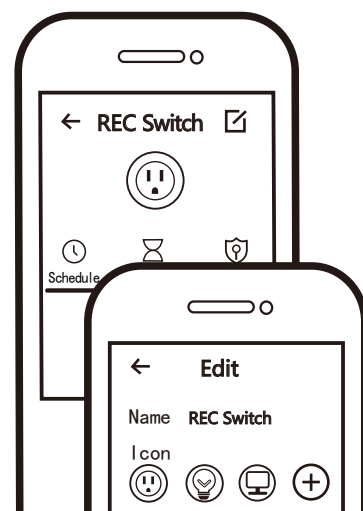

Select the edit icon in the upper right corner. Then you can rename the device and choose an icon, or you can take a photo for your device icon.



Anti-theft Timer

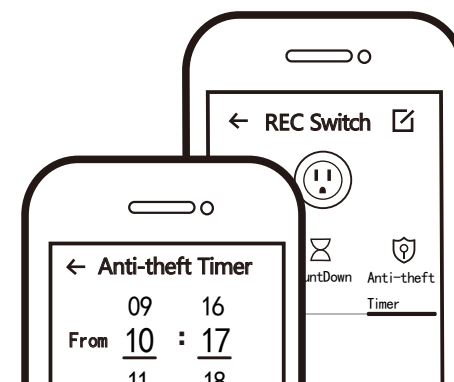

Guard your house by randomly turning on/off the lamp plugged into Wi-Fi Switch. You choose the time frame and number of slots in certain time period.



Remote control

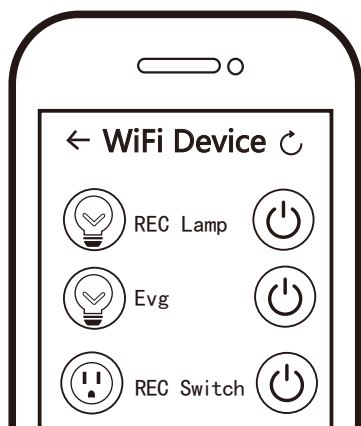

Turn on/off your electrical appliances from anywhere.



Countdown Timer

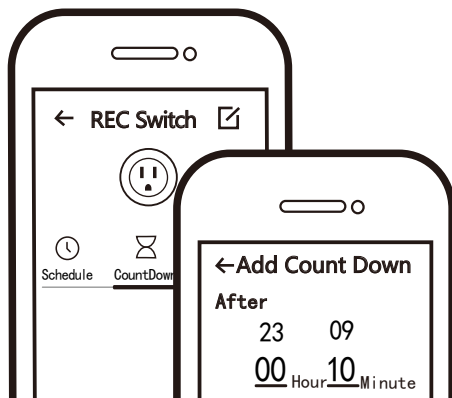

Turn on/off device plugged into Wi-Fi Switch by the time assigned.



Schedule Timer

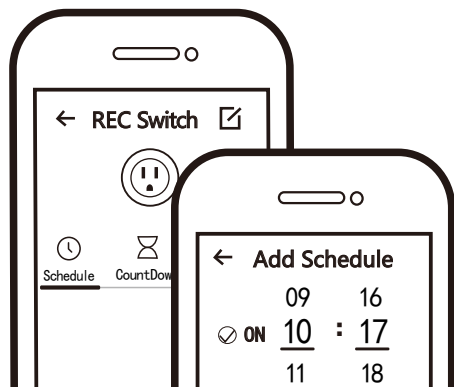

Perform the same routine operation at the same time in a week for your home appliances.

Work with Alexa:

1. Download Alexa app, and log in with your Alexa account ;
2. Click the left corner and open the menu,- click "skills" ;
3. Type in "REC" in the search box ;
4. Click "Ankuoo REC" in the search results, Enable the skill ;
5. Next page is the Ankuoo' s login page, please use the account you have created in REC app to login ;
6. Click "Discover Devices" ; Alexa will search for all your REC devices now (make sure your phone is connected to the same Wi-Fi as REC; Note: Before discover devices, you must change the switch name in REC app, such as kitchen,office..) ;
7. Now you can control your REC devices using Alexa.

THINGS TO KNOW BEFORE USING WI-FI SWITCH

- Make sure your router is configured to 2.4G, and your smartphone is connected to this 2.4G network.

- Make sure the electronic device shown on your iOS/Android REC App is the one plugged into the Wi-Fi Switch.

- Make sure you have a strong Wi-Fi signal at the Wi-Fi Switch.

- Make sure there are not too many devices connected to your router at the same time. You may temporarily turn off some other devices connected to the router and turn them back on again after the configuration is complete.

- Make sure the "AP isolation" function is deactivated on your router.

- Make sure no extra log in page is required on browser after your device is connected to Wi-Fi.

The sync and all operations of Wi-Fi Switch are only possible via a Wi-Fi network connected to the internet.

- Wi-Fi Switch needs to be setup again when the SSID or password is changed.

No need to setup the Wi-Fi Switch again when you turn it off or unplug it from one socket and plug it into another

- socket.

- Hard Reset: Press ON/OFF button for 5 seconds and release it. The Wi-Fi indicator light will flash quickly. Wi-Fi Switch is now ready for synchronization.

This equipment has been tested and found to comply with the limits for a Class B digital device, pursuant to Part 15 of the FCC Rules. These limits are designed to provide reasonable protection against harmful interference in a residential installation. This equipment generates, uses and can radiate radio frequency energy and, if not installed and used in accordance with the instructions, may cause harmful interference to radio communications.

However, there is no guarantee that interference will not occur in a particular installation.

-If this equipment does cause harmful interference to radio or television reception, which can be determined by turning the equipment off and on, the user is encouraged to try to correct the interference by one or more of the following measures:

—Reorient or relocate the receiving antenna.

—Increase the separation between the equipment and receiver.

—Connect the equipment into an outlet on a circuit different from that to which the receiver is connected.

—Consult the dealer or an experienced radio/TV technician for help.

This equipment complies with FCC radiation exposure limits set forth for an uncontrolled environment.

This equipment must be installed and operated in accordance with provided instructions and the antenna(s) used for this transmitter must be installed to provide a separation distance of at least 20 cm from all persons and must not be co-located or operating in conjunction with any other antenna or transmitter.

Lumi Legend Electrical has not approved any changes or modifications to this device by the user. Any changes or modifications could void the user's authority to operate the equipment.

REC:

QUICK INSTALLATION GUIDE AND FUNCTION INTRODUCTION

Wi-Fi Switch

Specifications

- Electrical Rating: 15A 125V~60HZ
- Wi-Fi:2.4GHz 802.11b/g/n
- For Indoor Dry Location Use Only

• Working Temperature:0-40 C

• Working Humidity:≤80 %

System requirements

- Wi-Fi® router
- iPhone,iPad (IOS 7.0 or higher)
- Android 4.0 or higher

Technical Support

- Support@ankuoo.us
- By Ankuoo Electronics Inc., a division of Lumitek Group.