



NEO Power WiFi Switch

GET STARTED



IMPORTANT POINTS TO KNOW BEFORE USE

- Please make sure the appliance showed in your Android/iOS display is the one connected to NEO WiFi Switch.
- Disconnect NEO WiFi Switch from power source if you are going to be absent for long time.
- The sync of NEO WiFi Switch to internet is only possible via WiFi network connected to internet. Please make sure NEO WiFi Switch is connected to WiFi network secured by password. If there is change of SSID or password of WiFi router, NEO WiFi Switch has to be resynchronized with WiFi router. Each NEO WiFi Switch is assigned with an individual local IP address automatically by WiFi router.

You do not need to reconfigure NEO WiFi Switch again no matter you turn it off or unplug it from one socket and plug it in another socket, as long as the SSID and password is unchanged and the WiFi network is working. Once the device is configured, it will appear on all other smart devices' app automatically.

- All setting operation of NEO WiFi Switch is only valid when NEO WiFi switch is connected to internet.
- The clock of NEO WiFi Switch is based on standard timing on cloud server and not of your local IOS/Android device. 1-2 minutes timer delay is perfectly normal.
- NEO has to be synchronize to WiFi network again after firmware is upgraded automatically or manually.

- Please make sure the device plugged in NEO WiFi Switch is the right device to be controlled by your smart device.
- Please disconnect NEO WiFi Switch from power source if you are long absent.
- Please make sure NEO WiFi Switch is connected to WiFi network secured by password. If there is change of SSID or password of WiFi router, NEO WiFi Switch has to be resynchronized with WiFi router on your smart device. Each NEO WiFi Switch is assigned with an individual local IP address automatically by WiFi router.
- Please be cautioned that changes or modifications not expressly approved by the party responsible for compliance could void the user' s authority to operate the equipment.

NOTE: This equipment has been tested and found to comply with the limits for a Class B digital device, pursuant to part 15 of the FCC Rules. These limits are designed to provide reasonable protection against harmful interference in a residential installation. This equipment generates, uses and can radiate radio frequency energy and, if not installed and used in accordance with the instructions, may cause harmful interference to radio communications. However, there is no guarantee that interference will not occur in a particular installation. If this equipment does cause harmful interference to radio or television reception, which can be determined by turning the equipment off and on, the user is encouraged to try to correct the interference by one or more of the following measures:

- Reorient or relocate the receiving antenna.

—Increase the separation between the equipment and receiver.

—Connect the equipment into an outlet on a circuit different from that to which the receiver is connected.

—Consult the dealer or an experienced radio/TV technician for help.

Region Selection

Limited by local law regulations, version for North America does not have region selection option.

MPE Requirements

To satisfy FCC / IC RF exposure requirements, a separation distance of 20 cm or more should be maintained between the antenna of this device and persons during device operation.

To ensure compliance, operations at closer than this distance is not recommended.

THIS IS HOW NEO SWITCH WORKS



1

Scan the QR code to download Neo app at App Store or Google Play.

You also can search keyword
“ANKUOO” at Google play or App
store to download Neo App.



2

Plug Neo into power socket, then
press ON/OFF switch for 5 seconds
and release the switch. The WiFi
indicator light will flash quickly.

Now, Neo is ready for sync.
configuration.



3

Connect your smart devices to local Wi-Fi network and launch Neo App. Find “add new device” in the menu.



4

Make sure your WiFi SSID is the same as the WiFi network, your smart device is connected and input password. The connection process takes 15–120 seconds which depends on your network condition and length of WiFi password.

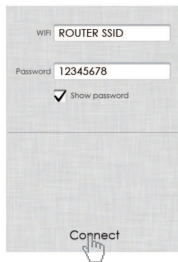

- * You do not need to reconfigure Neo again no matter you turn it off, or even unplug it from one socket and plug it in another socket, as long as the SSID and password is unchanged and the WiFi network is working. Once the device is configured, it will appear on all other smart devices' app automatically.

5

When configuration is done, the device will be listed in the device homepage. The ON/OFF state of Neo can be changed by clicking its switch on app.



6

Click one device's icon on homepage to enter detailed setting page for this device.

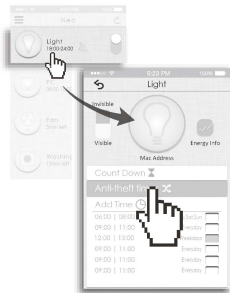

7 Timer Settings

NEO comes with three timer modes. You can set them at anywhere on your app with internet connection.





Countdown Timer:

Shut on/off device connected to Neo by the time assigned.



Anti-theft Timer:

Guard your house by turning on/off the lamp connected to Neo randomly: the timer splits the period you set into as many parts as you want it to be turn on/off and picks “on time” and “off time” in each part of time split randomly.



Schedule Timer:

Perform the same routine operation at the same time in a week for your home appliances.

* When one mode is activated, the rest two modes will be deactivated.

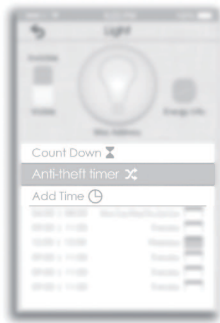

8 Power Meter Settings

With NEO Power, you will have a very insightful knowledge about how the electricity is consumed on real time, daily, weekly, monthly and yearly basis.

- Access the power meter function by clicking "Energy Info" icon in the timer setting page.

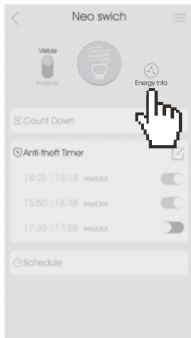

- Check detailed electricity consumption on real time, daily, weekly, monthly and yearly basis by selecting the respective title on the top menu.

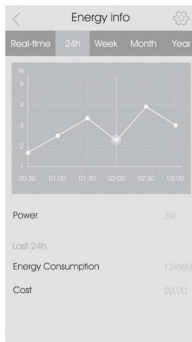

- To set the electricity price, please click the setting icon on the up right corner and input unit electricity unit price and currency unit.

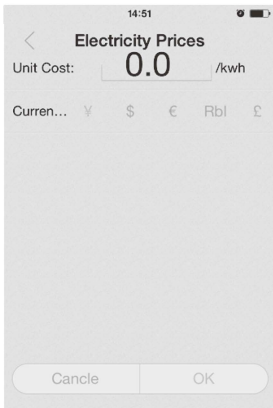

The screenshot shows a mobile application interface for setting electricity prices. At the top, the status bar displays the time 14:51 and a battery icon. Below this is a navigation bar with a back arrow on the left and the title "Electricity Prices" in the center. The main content area features a label "Unit Cost:" followed by a text input field containing the value "0.0" and a unit label "/kwh". Below the input field is a horizontal list of currency options: "Curren...", "¥", "\$", "€", "Rbl", and "£". At the bottom of the screen, there are two rounded rectangular buttons labeled "Cancel" and "OK".

NEED MORE HELP?

Learn more online

www.ankuoo.com

If you encounter any problem for configuration,
please check detailed trouble guide at our website or
contact our service office or authorized seller.



©2014 Ankuoo Electronics Inc. All rights reserved.