

105*280mm(4折 折后尺寸105*70mm)

back

Commission Devices

Remote Overview

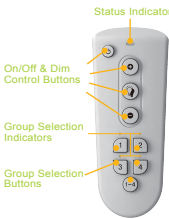

Status Indicator:
■ Remote is in Standby mode or Selected Group is OFF
■ Selected Group is ON
■ Finding Network Channel (slow) (when batteries are inserted)
■ Commissioning a bulb (fast)

ON/Off/Dim Control Buttons

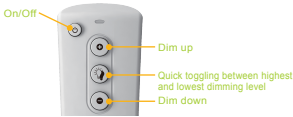

Group Selection Indicators
LED's indicate selected group. LED's will be OFF in standby mode.

Group Selection Buttons



Remote Control User Guide

1.Group Selection

Press the group button you want to control.
e.g. For Light 1--- Press group button 1--- Group indicator on--- Now you can play
If you want to control all bulbs please press (1-4) button.
e.g. Press (1-4) button---All group indicator on---Now you can play



2.ON/OFF

ON/OFF: Every single press turns ON or OFF all the Lights in selected group(s).



Remote Control User Guide

3.Dimming

Dimming: Dimming the lights that already commissioned to the remote.

UP/DOWN: Every single press the light up/down in selected group(s) by one level until max/min. Level is reached.

Remark: There are totally 16 brightness dimming levels.

Dimming(Shortcut): Every single press toggles the light in selected group(s) between max and min, Dimming level.



4.Releasing (Un-Pairing) Lights

Releasing (Un-Pairing) Lights: To release the lights that already in the certain group.

Caution: All lights in this certain group will be released. To release a single light, keep other lights in the same group powered off by wall switch.

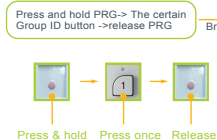

Press & hold Press once Release

Brightness is at 5%.

All lights in this group are set to factory default

Blinks twice

Light finishes On

User connects bulb to new network

Or after 5 min

Network close

Restarted by wall switch

Remote Control User Guide

5.Commissioning (Pairing) Lights

Commissioning (Pairing) Lights: Follow instruction below to commission new smart lights. In case you buy new smart lights or the current smart lights are set to Factory Default.

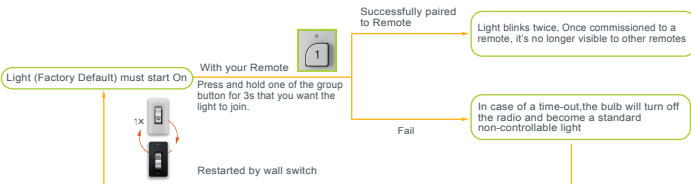

6.Reset

Reset: Set remote to factory default and delete all stored data.

Key combination: PRG->ON/OFF->DOWN->ON/OFF



After pressing all the keys in sequence above, indicator LED will flash for 5 sec and then the remote is reset done.

FCC WARNING

This device complies with Part 15 of the FCC Rules. Operation is subject to the following two conditions:

- (1) This device may not cause harmful interference, and
- (2) this device must accept any interference received, including interference that may cause undesired operation.

NOTE 1: Any changes or modifications to this unit not expressly approved by the party responsible for compliance could void the user's authority to operate the equipment.