



User Manual
Smart Remote Dimmer Switch, Works with Alexa, Wire-free

Guide de l'utilisateur
Smart Remote Dimmer Switch, Works with Alexa, Wire-free

Manual del usuario
Smart Remote Dimmer Switch, Works with Alexa, Wire-free
HVIN: HCR-Z54C-B-A667-01

EN Getting To Know Your Smart Remote

Overview

Smart remote front

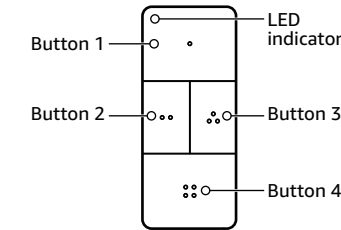

Smart remote back

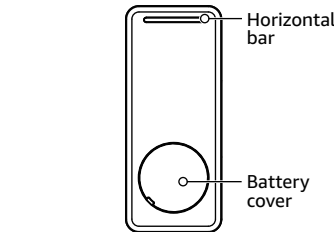

Wall plate front

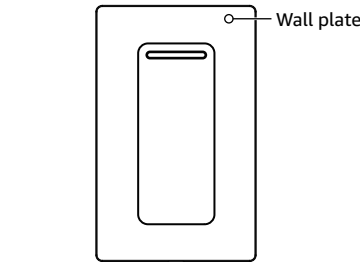

Wall plate back

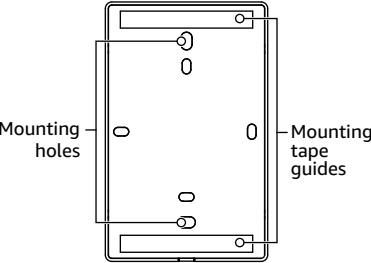

Activating the Smart Remote

Pull out the battery tag to turn on the smart remote, then press any button to enter Bluetooth Low Energy (BLE) beaconing mode.

Using the Smart Remote

Use the Alexa app to set up routines for each button.

What's in the Box

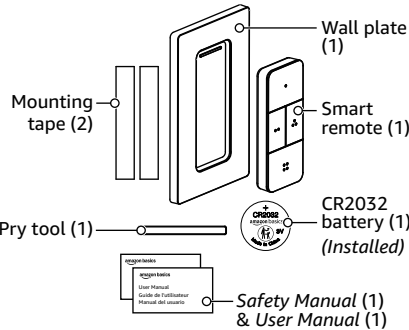

Know Before You Set Up your Device

This smart remote is designed to work with compatible Amazon Echo devices.

- Refer to <https://www.amazon.com/b?node=122309645011> for compatible Echo devices. The following Echo devices are not compatible: Amazon Echo (1st Gen), Amazon Echo Dot (1st Gen), Amazon Echo Link, Amazon Echo Plus (1st Gen), Amazon Echo Show (1st Gen, 2nd Gen), Amazon Echo Spot (1st Gen), Amazon Echo Sub, and Amazon Echo Tap.
- Update your Echo device to the latest firmware by saying "Alexa, check for software updates."
- When using your smart remote, stay within 10 m (32.81 ft.) radius of the Echo device. Before first use, pull out the battery tag and press any button to enter Bluetooth Low Energy (BLE) beaconing mode.

Setup in the Alexa App

NOTICE: You must use a compatible Echo device with updated firmware to set up the smart remote.

- Download the latest version of the Alexa app.
- Tap **+** on the top right, then select **Device**.
- Tap **Remote**, then choose **Amazon Basics Smart Remote**.
- Follow the in-app instructions to install the device.

Resetting to Factory Defaults

Press and hold **O** (button 1) and **88** (button 4) for 10 seconds until the LED indicator blinks green quickly.

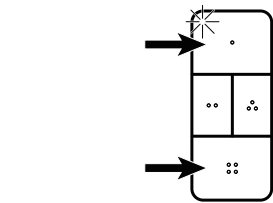

Mount Your Smart Remote

Choose one of the following methods to mount your smart remote: on a flat surface, on a magnetic surface, or on the wall plate. Do not place the smart remote higher than 2 m (6.6 ft.) above the ground.

On a Flat Surface (Standalone)

Place the smart remote with its back resting on any flat surface without the wall plate.

On a Magnetic Surface

Place the back of the smart remote on a magnetic surface. Magnets hold the smart remote in place.

On the Wall Plate

Using mounting tape

- Remove the backing from one side of the mounting tape and attach it to the tape guides on the back of the wall plate.

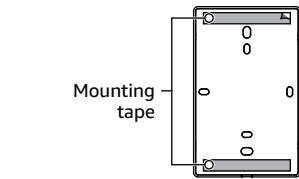

- Remove backing on the other side of the mounting tape and carefully push the wall plate onto your mounting surface.
- Place the smart remote in the wall plate. The horizontal bar on the back of the remote slots into the horizontal bar on the wall plate.

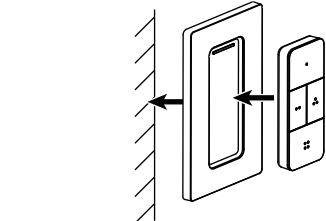

Using screws (not provided)

You'll need: Two countersunk screws (3x10 mm or 3x15 mm) and Phillips screwdriver.

- Pull the wall plate apart using the pry tool.

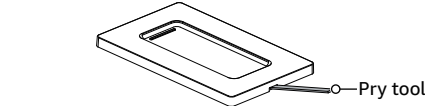

- Mount the back of the wall plate using two screws (countersunk 3x10 mm or 3x15 mm) and a Phillips screwdriver to your outlet box. Make sure the horizontal bar on the wall plate is at the top and parallel to the ground.

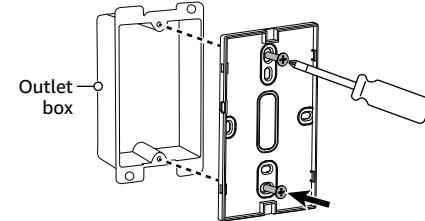

- Push the wall plate cover onto the wall plate's back over, then place the smart remote in the wall plate. The horizontal bar on the back of the remote slots into the horizontal bar on the wall plate.

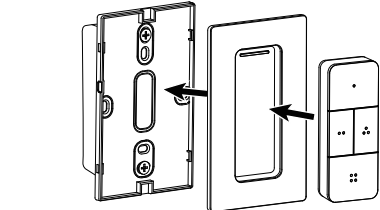

Things to Try with Your Smart Remote

You can control lighting or music, or personalize your smart remote to control the thermostat, announcements, multiple device types, and more. Use the Alexa app to set up routines for your remote buttons.

Troubleshooting

Problem

The smart remote isn't working, and there is no indication on the LED.

Solutions

- ▶ If using the smart remote for the first time, make sure that you remove the battery tag protecting the battery.
- ▶ Make sure that the battery is installed correctly or try replacing the battery.

Problem

The smart remote fails to find a compatible Echo device in setup mode.

Solutions

- Make sure a compatible Echo device is powered on and set up in your Alexa account. If you have a compatible Echo device and haven't set it up, you can do it now. For a compatibility list, see "Know Before You Set Up Your Device."
- Make sure that your Echo device is updated to the latest firmware version. See "Know Before You Set Up Your Device" for information about how to update your Echo device.
- Make sure the green LED indicator on the smart remote is blinking in the setup mode.
- Make sure your smart remote is within 10 m (32.81 ft.) of the Echo device.

Problem

The smart remote command fails to reach your Echo device.

Solutions

- ▶ Try to move the smart remote closer to your Echo device. The remote should be within 10 m (32.81 ft.) of the Echo device.

Problem

The smart remote is indicating low battery.

Solutions

Replace your device battery with a new 3V CR2032 battery. For convenient battery ordering, see "Supplies" in your smart remote's settings in the Alexa app.

Specifications

Dimensions (L x W x H)	85 x 36 x 11 mm (3.35 x 1.42 x 0.43 in.)
Power supply	3V (CR2032)
Battery life	1.5 years
Control distance	10 m (32.81 ft.) in an open area
Ambient temperature	-20° to 50°C (-4° to 122°F)
Storage temperature	-40° to 85°C (-40° to 185°F)
Bluetooth version	BLE5.3
Radio frequency	2.4GHz
Protection class	IP30
Authentication	FCC ID, IC ID

Feedback and Help

We would love to hear your feedback. Please consider leaving a rating and review through your purchase orders. If you need help with your product, log in to your account and navigate to the customer service / contact us page.

FR French goes here

French goes here

French goes here

French goes here

French goes here

French goes here

ES

Spanish goes here

Spanish goes here

Spanish goes here

Spanish goes here

Spanish goes here



amazon.com/pbhelp



MADE IN THAILAND
FABRIQUÉ EN THAÏLANDE
HECHO EN TAILANDIA
V01-10/24