

Bm1

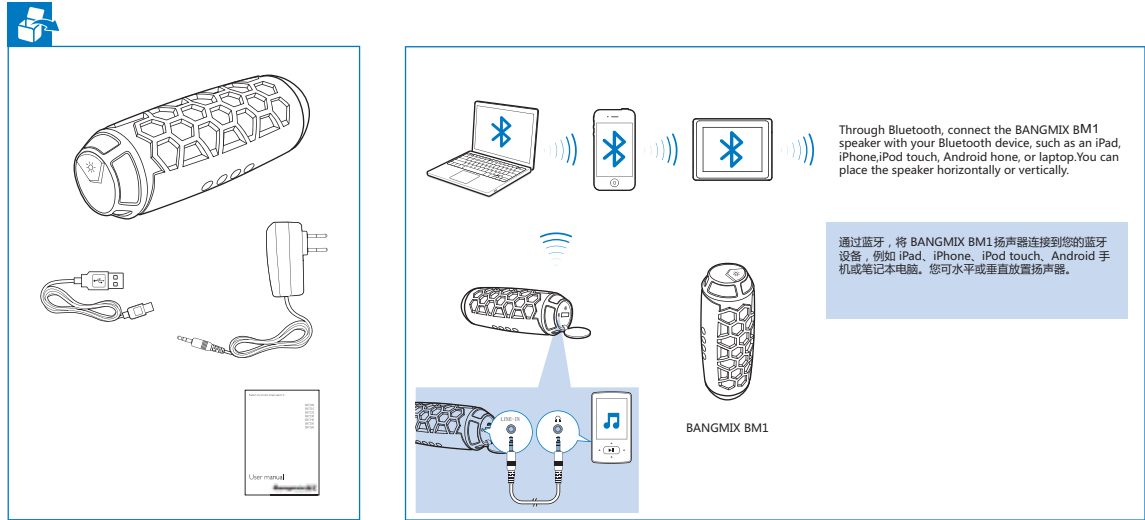

Switch on & Connect 打开并连接

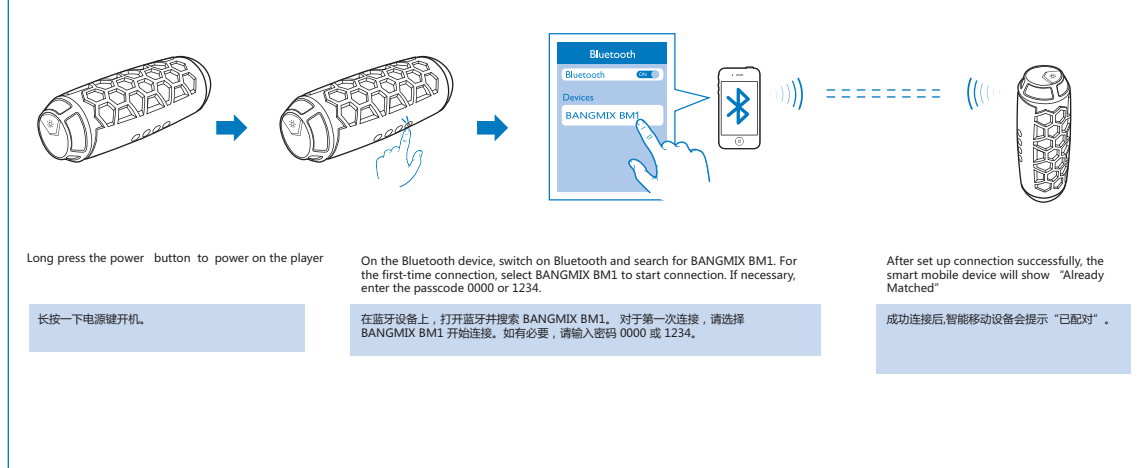

Play 播放

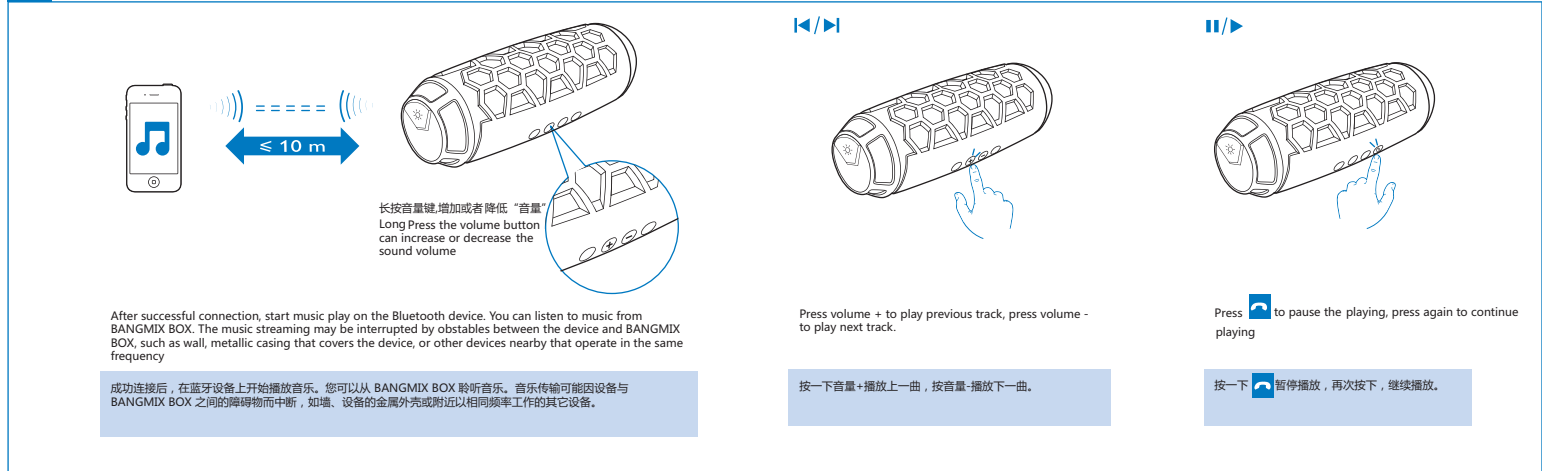



Charge 充电

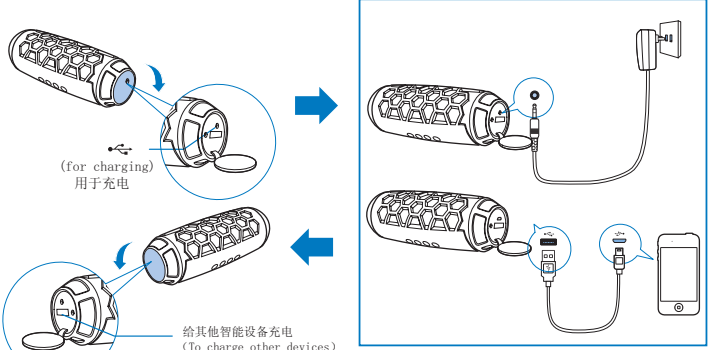

(for charging)
用于充电

给其他智能设备充电
(To charge other devices)

红色指示灯常亮，设备正在充电。红色指示灯快闪，设备电量不足。
Red light indicator power on constantly: The device is under charging status, red light indicator flashes quickly, the device is going to be out of power.



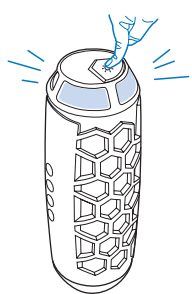

Lighting/Outward charging 照明/对外充电



Press the illuminating  to power-on the lighting system, press again to shut-off the lighting system.

按一下  开启照明系统，再按一下，关闭照明系统。

Long press  button to power on outward charging system, at the mean time the red light will be power on constantly. Long press again to shut down the outward charging system and the red light indicator will shut off.

长按  开启对外充电系统，此时红色指示灯点常亮，再次长按就关闭对外充电系统，红色指示灯熄灭。



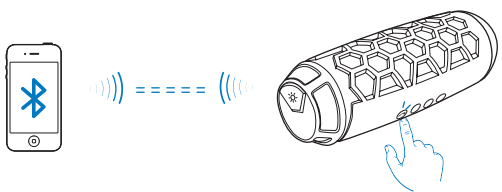

After the speaker powered on, it will get into matching status automatically and the blue light flashes rapidly, if it can't matched, press  twice continually to get into the matching status, when it is matched the blue light flashes slowly. If there is no any Bluetooth signal within 5 minutes, the speaker will get into standby status.

机器开机后，自动进入配对状态，蓝色指示灯快速闪烁，如果配对不成功，连续按  两次进入配对状态，配对成功后，蓝色指示灯慢闪，如果5分钟没有任何蓝牙信号，机器进入待机状态。

After the Bluetooth has been set paired, press the  to activate the hands-free answering function, press again to shut-off the phone call. When in hands-free status, the music playing will be suspended, after the phone call has been shut-off, the music will continue playing.

蓝牙配对后，按一下  进行免提接听，再按一下，挂断电话。免提电话时，播放的音乐处于暂停状态，挂断电话后，5秒后继续播放。

规格

Specifications

兼容性

兼容大部分智能手机，平板电脑，音乐设备
IPAD：IPAD1，IPAD2，IPAD3
IPHONE：IPHONE3GS，IPHONE4，IPHONE 4S，
IPOD TOUCH：3代以上
ANDROID 平板电脑和智能手机，带ANDROID 2.1和BLUETOOTH 2.1或更高版本

连接

蓝牙模式：A2DP, AVRCP, HFP, HSP
蓝牙范围：10米或者30英尺
麦克风：内置麦克风
充电：适配器 充电
音频接口：3.5毫米线路输入

声音

输出功率(RMS):8瓦
声音系统:单声道混合立体声
扬声器:2 英寸

功率

电池类型:锂电池或聚合物电池(内置)
电池容量:3000毫安
电池支持播放时间: 8小时
输出电压/电流: 5V/2A
输入电压/电流: 9V/1A

照明

LED功率：1W
LED 照射距离：<10米

Compatibility

Compatible with most smart phones, tablet computers and music devices
IPAD：IPAD1，IPAD2，IPAD3
IPHONE：IPHONE3GS，IPHONE4，IPHONE 4S，
IPOD TOUCH：3rd generation or above
ANDROID tablet computer and smart phone with ANDROID 2.1 and BLUETOOTH 2.1 or higher version

Connectivity

Bluetooth mode: A2DP, AVRCP, HFP, HSP
Bluetooth range: 10 meters or 30 feet
Microphone: Build-in Microphone
Adaptor charging
Audio terminal: 3.5mm input

Sound

Output consumption(RMS): 8W
Sound System: Monophonic Mixing Stereo
Loudspeaker: 2 inch

Consumption

Battery Type: Lithium battery or polymer battery(Build-in)
Battery Volume: 3000mA
Battery Supported Playing Time: 8 Hours
Output Voltage/ Current: 5V/2A
Input Voltage/ Current: 9V/1A

Lighting

LED Power：1W
LED Illumination Distance：<10M

FCC Certification Requirements

Caution: Any changes or modifications in construction of this device which are not expressly approved by the party responsible for compliance could void the user's authority to operate the equipment.

This device complies with part 15 of the FCC Rules. Operation is subject to the following two conditions: (1) This device may not cause harmful interference, and (2) This device must accept any interference received, including interference that may cause undesired operation.

The manufacturer is not responsible for any radio or TV interference caused by unauthorized modifications to this equipment. Such modifications could void the user's authority to operate the equipment.

This equipment has been tested and found to comply with the limits for a Class B digital device, pursuant to Part 15 of the FCC Rules. These limits are designed to provide reasonable protection against harmful interference in a residential installation. This equipment generates, uses and can radiate radio frequency energy and, if not installed and used in accordance with the instructions, may cause harmful interference to radio communications. However, there is no guarantee that interference will not occur in a particular installation. If this equipment does cause harmful interference to radio or television reception, which can be determined by turning the equipment off and on, the user is encouraged to try to correct the interference by one or more of the following measures:

- Reorient or relocate the receiving antenna.**
- Increase the separation between the equipment and receiver.**
- Connect the equipment into an outlet on a circuit different from that to which the receiver is connected.**
- Consult the dealer or an experienced radio/TV technician for help.**