

# Advisor

## Users manual

Ver 1.1



03 Dongsuwon Bd, #549, Gyeongsu-daero, Paldal-gu, Suwon-si, Gyeonggi-do,  
442-832, Korea

# Table of Contents

## 1. Musts to remember in use

|           |        |
|-----------|--------|
| 1. Notice | .....3 |
|-----------|--------|

## 2. Contents of Advisor

|   |        |
|---|--------|
| 1. Contents of Advisor and name of the part | .....4 |
|---|--------|

## 3. How to use Advisor

|   |        |
|---|--------|
| 1. Advisor management   | .....5 |
| 2. The Use of Advisor   | .....5 |
| . Power on  | .....5 |
| . App installation in smart device & connecting Advisor to the smart device | .....6 |
| . Attaching method the Advisor to the toothbrush                            | .....6 |

## 4. Other Information

|                           |        |
|---------------------------|--------|
| 1. Product specifications | .....7 |
| 2. Warranty               | .....7 |



# 1. Musts to remember in use

Notice

1. Inform children of the risk of electrocution.
2. Do not touch an inner power switch, USB slot or inner part with wet hands.
3. Do not use while taking a shower.
4. Place the body out of reach by water or other liquid.
5. When the liquid like water permeates inner body, separate battery immediately.
6. When the body has fallen into water, use it after making it dry in a breezy place.
7. If this product does not operate, do not disassemble it and please contact a service center or the shop that you bought it at.
8. Keep this product away from fire or heat.
9. Do not drop or disassemble this product
10. Place a body on flat place out of reach by water.
13. If the power USB cable is damaged, you should replace it by the manufacturer, its agency, or qualified technician in order to avoid the risk.



This device complies with part 15 of the FCC Rules.  
Operation is subject to the following two conditions:  
(1) This device may not cause harmful interference, and  
(2) This device must accept any interference received,  
including interference that may cause undesired operation.

Caution: Any changes or modifications to the equipment not expressly approved by the party responsible for compliance could void user's authority to operate the equipment.



## 2.Contents of Advisor

### 1. Contents of Advisor and name of the part



Adapter

Body

Water proof ring

Charging Cap

Power Switch

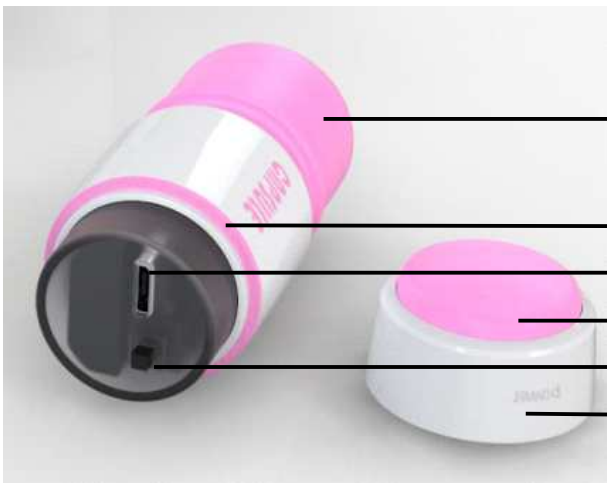

Adapter

Water proof ring

Charging micro USB slot

Power Switch

Inner Power Switch

Charging Cap



## 3.How to use Advisor

### 1.Advisor Management



- ★ Please set the body on edge when Advisor is not used like left picture.

Please power off the Advisor after use.

- ★ Wash the body and adapter after brushing. Remove toothbrush from the adapter and wash inside of the adapter in running water. Wash the body also in order to remove toothpaste clearly.

- ★ Remove dregs at the connection part of toothbrush and body for sanitation at all times.

- ★ Please make the body dry before opening the charging cap, after then open the charging cap. Finally, connect the power USB cable to the USB slot in order to charging.

### 2. The Use of Advisor

#### [1] Power on

- ◆ Please push the power switch and check the LED is on

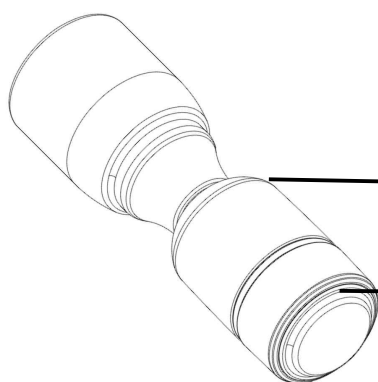

1. Please push the switch once, then the power is on and LED is on. When the power is on, the LED blink.

2. Please push the power switch during the LED blink(Power on), then the power is off and LED is off.

LED

Power Switch

## [2] App installation in smart device and connecting Advisor to the smart device.



1. Download and install Mom brush App from the App store  
(The Kinds of Mom brush App: Fones(Stages 1), Rolling(Stages 2, 3), Modified Bass(Stages 4), Orthodontic toothbrush for braces(Stages 5))
2. Activate the Bluetooth of smart device.
3. Turn on the power of Advisor mom.
4. Select " new connection" after scrolling down the screen that store User registration.
5. Select "device search"
6. Select the device named "xiu...." after the screen shows all Bluetooth device nearby as searched result.
7. Please enter the PIN no. as [0000], then select [Confirm].
8. First connected Advisor is automatically connected to the smart device until another Advisor is connected. At this time, the status of bluetooth of the smart device must be activated.

## [3] Attaching method the Advisor to the toothbrush.

1. Please put the toothbrush insert the adapter of Adviser mom. Because the material of the adapter is elastic, you can put the toothbrush insert the adapter of Adviser mom easily.
2. When you put the toothbrush insert the adapter, you have to make an array of the bristle of toothbrush and the logo of the Advisor mom.





## Other Information

### 1. Product specifications

|  |                      |
|--|----------------------|
| Product name   | Mombrush             |
| Model name   | Advisor              |
| Rated voltage  | 5 V                  |
| Rated input  | 3 W                  |
| IP Rating  | IPX7                 |
| Size(w/o Bristle)  | 29*29*91.3(mm)       |
| Weight   | g                    |
| Manufacturer   | Xiusolution Co., Ltd |
| Manufacturer Country   | Korea                |
| The date of manufacture  | 20 - -               |
| Seller   | Xiusolution Co., Ltd |
| Customer Care Center   | 070-8730-8775        |
| It might can be some interference when this wireless equipment in use. |                      |

### 2. Warranty

#### LETTER OF DESIGNATION AS QUALITY-ASSURED COMPANY

We warrant our goods as follows:

Please have the date of purchase written on the warranty card and keep it in a secure place as you have to present the card to get good service from us when asking for repair.

1. This product is manufactured under strict quality control and inspection processes.
2. When this product goes out of order under the normal use of customer, we will repair it free of charge
2. during the warranty period.
3. Even during the warranty period, we will provide repair services for problems not covered under this
3. warranty with reasonable charges.
4. Please show us the warranty card when you ask for repair service.
5. Please keep the warranty card securely as it is not reissued.

|                    |          |                                    |     |
|--------------------|----------|------------------------------------|-----|
| Product name       | MomBrush | Term of Validity                   |     |
| Model name         | Advisor  | One year from the date of purchase |     |
| Serial number      |          |                                    |     |
| The date purchased | / /      | To                                 | / / |
| Purchaser Address  |          |                                    |     |
| Purchaser Name     |          | Tel                                |     |

Name of Company: Xlusolution Co., Ltd

Representative: Jinsang Hwang

Address: 303 Dongsuwon Bd, #549, Gyeongsu-daero, Paldal-gu, Suwon-si, Gyeonggi-do, 442-832, Korea

Please contact us for further questions of Xiu Oralcare Dual Program. You may find a distributor in your area on the distribution list at [www.xiusolution.com](http://www.xiusolution.com) or send email to the [admin@xiusolution.com](mailto:admin@xiusolution.com)