



本使用手册所提及的商标与名称均属风网公司所有  
The copy right of this User's Manual and Trademark are  
belong to Shanghai Bluebell Networks, Inc.

目录 CONTENT

产品介绍

Product Introduction

- 04 主要功能 Main Function
- 05 产品组件 Components
- 06 播放器接口介绍  
Introduction of Connection
- 08 无线遥控器使用说明 Instruction  
for Wireless Remote Controller
- 09 产品规格 Product Specifications

操作指南

Operation Guide

- 12 系统设置 System Setting
- 13 网络设置 Network Setting
- 14 无线网络设置  
Wireless Network Setting
- 15 有线网络设置  
Wired Network Setting
- 17 基本显示设置  
Basic Display Setting
- 19 显示模式设置  
Display Output Mode Setting
- 19 声音设置 Sound Setting
- 21 存储 Storage
- 22 应用程序 Apps
- 23 语言和输入法 Language & Input
- 24 日期和时间 Date & Time
- 25 关于设备 About Device

1

产品介绍  
Product Presentation

主要功能 MAIN FUNCTION

BH102为上海风网网络科技有限公司新推出的一款新一代高科技产品——风网高清网络播放器。BH102运行Android操作系统，其电视上网功能，是对普通电视播放器功能上的新突破，同时更是对传统上网模式的突破。您可以在自家舒服的沙发上以任何自在轻松姿势通过蓝光电视播放器自带的无线遥控器或无线键盘随意操作电视来体验家庭网上冲浪，观赏高清网络电视带来的享受。BH102自带大容量存储（本机4GB容量，可通过USB进行容量扩展）让您可以方便下载Android应用。BH102提供了连接普通电话的RJ11接口，可以接入普通电话拨打以及接听任何电话，完全替代了家庭或酒店旅馆的PSTN固定电话功能。BH102自带的无线遥控器支持VoIP语音通话以及文字语音输入功能。BH102风网高清网络播放器提供RJ45上网端口，802.11b/g/n无线上网接口，USB接口，视频输出接口，视频输出最高分辨率可达1080p@60Hz。

Shanghai Bluebell Network, Inc. introduces a new High-Tech product "HD network player"—BH102. This box is operated with Android system which TV-network function will improve the operation for regular TV set, as well as for regular network online browsing. You can comfortably sit on the sofa at home to watch the HDTV programs, to browse on line with the Blue Ray TV Box and wireless remote controller. BH102 box has 4GB memory and also can be connected through USB to add more memory which would make you to down load any Android APP conveniently. BH102 Box also provides with RJ11 for connecting regular telephone to make phone calls that could replace the traditional telephone function for you at home or in the hotel. BH102 box's wireless remote controller will provide functions of VoIP phone and voice input for language. The box provides with RJ45 port for wired network online, 802.11b/g/n wireless network port, USB port, HDMI port will support the high resolution up to 1080p@60Hz.

产品组件 COMPONENTS

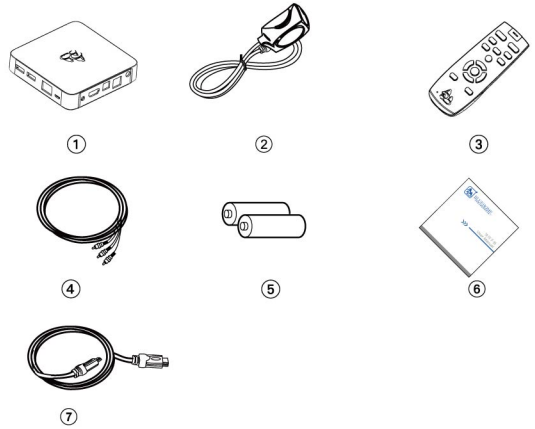

1. BH102风网高清网络播放器 HD network player 2. 12V/1.5A外置电源适配器  
3. 2.4G无线遥控器 Wireless Remote Controller Power Adapter  
5. 干电池（2节）Battery (2 pieces) 4. 一分三AV线（自购）AV cable  
7. HDMI高清视频连接线 HDMI cable 6. 产品说明书 User Manual

播放器接口介绍 INTRODUCTION OF CONNECTION

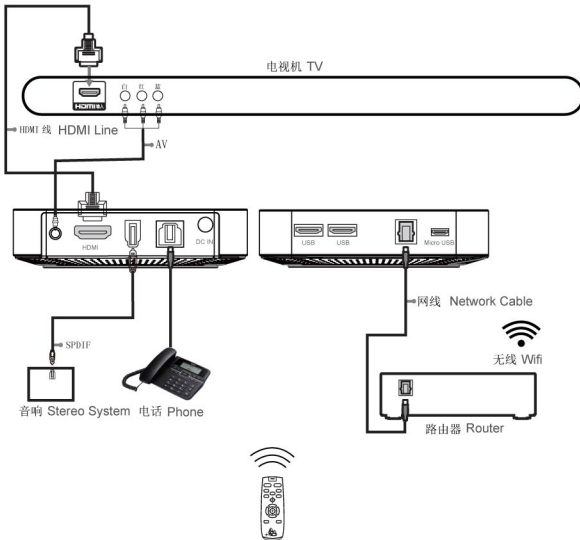

1. 网络：100MBASE-T RJ45接口，通过CAT5网线连接路由器。网速要求2M以上。  
Network: 100MBASE-T RJ45 wired network port, use CAT5 wire to connect to network router. The requirement for the network speed is >2 Mbps.
2. HDMI：数字高清音视频输出接口，满足HDMI1.3标准，最高支持1080p@60Hz，通过产品自带的HDMI连接线连接电视机的HDMI输入端口。  
HDMI: High Definition audio/video output port to meet HDMI1.3 standard with high resolution up to 1080p@60Hz. BH102 box comes with HDMI cable.
3. RJ11：连接普通电话接口。Regular telephone port.
4. AV：通过连接线连接到电视机的视频输入接口（黄色）以及左右声道输入接口（白/红色）  
AV: Using AV wire to connect with TV AV input port.
5. SPDIF：光纤数字音频输出接口，通过SPDIF连接线与支持SPDIF功能的音频功放连接。  
SPDIF: Optical Fiber for Stereo output to home stereo system.
6. USB主机接口，可以外接U盘支持本地视频播放，音乐播放，图片浏览等功能。  
USB port on the box can be connected with USB disk for local video, music, and pictures.
7. Micro USB：与PC等终端进行数据传输。Port can be connected to PC for data transfer.
8. WiFi无线：内置WiFi模块及天线，支持802.11b/g/n协议。可以通过WiFi连接无线路由器访问网络（若使用RJ45端口，则可以不使用）。  
WiFi wireless: Built-in WiFi chip and antenna to support 802.11b/g/n agreement which ensure BH102 box can be connected with wireless router through WiFi.
9. 电源输入：输入要求12V/1.5A。DC IN: power of input requires 12V/1.5A.

无线遥控器使用说明 INSTRUCTION FOR WIRELESS REMOTE CONTROLLER

在启动主界面里 点击遥控器图标“”，会提示遥控器的使用说明。  
In the home page, there is " " button for help which demonstrates the function of each button.



⏻	关闭/打开屏幕显示 Turn off/Turn on
🔇	静音 Mute
🔍	屏幕放大 To enlarge screen
🔍	屏幕缩小 To reduce screen
🔊	增加音量 To increase volume
🔊	减小音量 To reduce volume
🖱️	激活鼠标或关闭鼠标同时打开体感模式 Activation of the mouse or closed and open mouse somatosensory mode
⬆️⬆️⬆️	上下左右四个导航键 Keys for moving up, down, left, and right.
Ok	当鼠标激活时，此键相当于鼠标左键，在文本编辑值内点击此键会弹出软键盘，在界面空白处长时间按住此键会弹出菜单，按住此键不放然后向上或向下拖拽实现翻页；当鼠标没有激活时，此键相当于回车键。 When the mouse is been activated, this key is acting as left button. By pressing this button, the soft keyboard will come up on the screen; the menu will come up when pressing for awhile at empty space; moving the pages up and down by pressing the button and move the cursor up and down. When the mouse is not been activated, it acts as a return key.
🏠	回到系统首页 Back to Home page.
Esc	退出当前页 Return to the previous page.
🗣️	左下角圆孔是麦克风可以语音输入 The lower left corner circular microphone can voice input

产品规格 PRODUCT SPECIFICATIONS

- ◆ 内置CPU：ARM Cortex-A8 CPU：ARM Cortex-A8
- ◆ 内存容量：1GB Memory Capacity：1GB
- ◆ 存储容量：4GB Flash Capacity：4GB
- ◆ 外置存储器：外接U盘或USB硬盘  
External Storage: Connected with USB disk or removable storage
- ◆ 视频解码(Video HW Decoder): H263,H264,MPEG4,VC-1
- ◆ 视频格式(Video format): AVI, WMV, 3GP, MP4, MOV,MPG,VOB,MKV,FLV,TS/TP ASF
- ◆ 音频格式(Audio format): MP3,MP2,WMA,OGG,AAC,WAV,FLAC,APE,AC3,DTS
- ◆ 图片格式(Picture format): bmp,jpg,jpeg,gif,png
- ◆ 语言(language): 支持多语言 Multi-language supported
- ◆ 操作系统(Operation system): Android4.0
- ◆ 浏览器(Browser): 内置Webkit浏览器 Built-in Webkit browser
- ◆ 分辨率(Resolution): 1920x1080p,1280x720p,1920x1080i
- ◆ 电源(Power Supply): DC12V/1.5A，适配器输入(Adapter input) 100~240V AC@50/60Hz
- ◆ 机身重量(Product weight): 小于500克 <500g
- ◆ 消耗功率(Consume power): 工作时小于10W <10W in operating
- ◆ 工作环境(Working environment): 温度(Temperature):0~40°C,湿度(Humidity): 0~95%RH 无结露 no condensation
- ◆ 存储环境(Storage environment): 温度(Temperature)-20~70°C,湿度(Humidity): 5~90%RH 无结露 no condensation

操作指南  
Operation Guide

www.bluebell-networks.com

系统设置 SYSTEM SETTING

BH102启动完成后，第一个用户界面（首页）如图1所示。



图1  
P1

点击首页右下方的“设置”图标，将会进入设置界面，如图2，用户必须先配置好网络才能使用本产品的大部分功能，可参考“网络设置”章节；其次用户可以根据需要调节界面大小、选择合适的分辨率、显示模式、声道、输入法与语言等，分别参考“显示设置”、“声音设置”以及“语言与输入法”章节；最后应用程序管理参考“应用程序”章节，系统内部外部存储查看参考“存储”章节，日期与时间修改参考“日期与时间”章节，系统升级及设备版本参考“关于设备”章节。

After connecting and turn on the BH102 box, the home page will be as P1 shown below. By click “Settings” icon at low right end, the set up page will come up on screen as P2. Customer should first select the network before set up other functions by using Chapter “Network setting” as a reference. Second, customer should adjust the screen size according to the TV size, select proper resolution, Display Output Mode, audio, input format, and language by using chapter of “Basic Display Setting”, “Display output Mode Setting”, “Volume Setting”, “Language & Input”. suing chapter “Storage” to observe storage information; using chapter “Date and Time” for set up date & time; using “About System” to update the system.



图2  
P2

网络设置 NETWORK SETTING

BH102内置有802.11b/g/n无线网卡以及100Mbps有线网络接口。您可以通过有线网络端口或无线网卡连接网络。

BH102 box has internal wireless network card (802.11b/g/n) and 100Mbps wired network port. You can use either wired network port or wireless to connect with network.

注意：网络设置只在BH102初次投入使用或网络路由器参数发生变化后才需要一次性设置。设置成功后，BH102后续开机将会自动建立起网络连接，不需要重新设置参数。

Attention: Set up the network only been required one time at the beginning for turning on the system or when the router has changed its parameter. After initial setting, BH102 will automatically connect to the network whenever the box is been turned on again and there is no need to reset any parameters.

无线网络设置 WIRELESS NETWORK SETTING

在设置界面左边分类栏中选择“Wi-fi”，进入“Wi-fi”即无线网络设置界面，将开关按钮为“打开”状态，如果附近有无线网络，在屏幕的右边将会搜索出所有的无线网络，选择其中一个进行连接，如果设置了密码会提示用户输入密码（图3）。输入完成后点击连接后系统会自动完成后续的验证与连接工作。连接成功后屏幕右下角会出现“Wi-Fi”图标。

At the left side of setting page, select “Wi-fi” to enter “Wi-fi” which is wireless network set up page, then pressing on/off button to turn on wireless connection when wireless is available nearby. At the right side of the screen, there will be a list of wireless network addresses shown, please select one of them and enter the user's password if it is required (as P3). After completing above process, the system will be automatically verify and connect the wireless. The wireless connection icon will appear at the right low corner of the screen once it is successfully connected.



图3  
P3

有线网络设置 WIRED NETWORK SETTING

在设置界面左边分类栏中选择“有线网络”，如图4，屏幕右边会出现“以太网”选项，选择进入，如图5，将会出现以太网设置“eth0”，点击此设备进行“动态IP”或“静态IP”设置，如果路由器端开启动态分配IP功能，则选择“动态设置IP”，BH102将会自动建立网络连接；如果没有，用户则需要输入地址IP，子网掩码，网关以及DNS等参数后才能建立网络连接（如图6）。连接成功后屏幕右下角会出现“有线网络”图标。

At the left side of setting page, select “Ethernet” as in P4 to enter “Ethernet Network” page. At the right side of the screen as in P5, there will be “Ethernet Network” net for wired network setting, please select either “Dynamic IP” or “Static IP”. If the router was set up at Dynamic IP condition, please select “Dynamic IP”, then the wired network will be automatically connected; If the router was set up at Static IP condition, please input



"Static IP", "net mask", "net gateway", and DNS as in P6, then the wired network will be automatically connected. After completing above process, the wired network connection icon will appear at the right low corner of the screen once it is successfully connected.



图4  
P4



图5  
P5



图6  
P6

基本显示设置 BASIC DISPLAY SETTING

如果发现屏幕大小与电视机不匹配，或者屏幕不够清晰，或者字体太小等，可在设置界面左边分类栏中选择“显示”，进入“显示”设置界面，如图7，选择右方栏目中“屏幕切边”选项，调节界面长宽大小以适应电视屏幕；选择“显示输出模式”选项，参考图8，根据自身电视的实际情况调到最高的分辨率使屏幕更清晰；选择“字体大小”，调节整个系统的字体大小；选择“屏幕适配”，系统会自动调节屏幕大小以及分辨率。

用户还可以根据自己的喜好调节“亮度”、“对比度”、“饱和度”等。

If there the display size does not match with TV screen or the screen is not clear or the font size is too small/big, you can select "Display" on the left side of screen to enter "Display" page as in P7. Selecting "Screen Trimming" on the right side of the screen, you can adjust the size of display to suit screen; selecting "Display Output Mode" as in P8,

you can select the highest resolution to match TV's resolution; selecting "Font Size", you can adjust the system's font; selecting "Screen Adaption", you can automatically adjust screen size and resolution. You can adjust "Brightness", "Contrast", "Saturation" according to your favorite.



图7  
P7

显示模式设置 DISPLAY MODE SETTING

用户可以不通过界面操作就能完成显示模式的切换。显示模式分两大类，一类是HDMI，另一类是AV。如果用户同时连接HDMI线与AV线（连接方法参考前叙章节播放器接口介绍），系统优先使用HDMI显示模式；如果只有AV线连接，系统会自动切换到AV显示模式，注意此时电视机的显示模式也必须切换到AV或视频模式。如果用户使用本产品的AV模式，用户还可以根据电视制式设置“NTSC”或“PAL”制式，参考图8。

You don't have to go through Page 8 to switch Display Output Mode. Display Output Mode contains 2 types. One is HDMI and another is AV. If you connect both HDMI and AV, the system will use HDMI automatically. If you just use AV as connection, you should ensure the TV display set at "AV" or video mode. If you use AV mode, you can set TV model at "NTSC" or "PAL" as P8.



图8  
P8

声音设置 SOUND SETTING

如果用户发现没有声音输出，在设置界面左边分类栏中选择“声音”，进入“声音”设置界面，如图9，然后选择右方栏目中“音频输出模式”，弹出声道选择对话框，如图10，在这里用户根据音频输出的实际情况选择合适的声道。如果音视频接口只有HDMI线连接，则选择“AUDIO\_HDMI”；如果音视频接口只有AV线连接，则选择“AUDIO\_CODEC”；如果想用光纤线将音频输出到功放，则选择“AUDIO\_SPDIF”

图9中“音量”选项为音量大小调节。

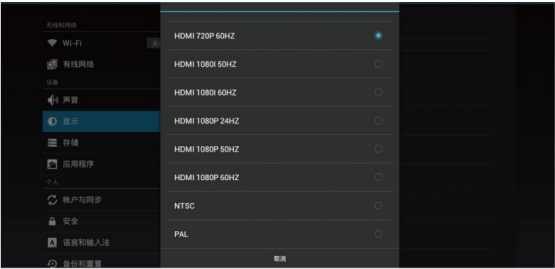
If you find no sound output, please select "Sound" on the left side of screen to enter "Sound" page as P9. Please select "Audio output mode" on the right side of the screen

to activate audio output mode selection box as P10 to select proper audio channel. If the system was set at HDMI, please select "AUDIO\_HDMI"; if the system was set at AV, please select "AUDIO\_CODEC"; If you prefer to use Optical cable for audio connection, please use "AUDIO\_SPDIF".



图9  
P9



图10  
P10

存储 STORAGE

在设置界面左边分类栏中选择“存储”，右边将会出现“内部存储空间”的大小，如图11，包括总容量、已使用的空间以及可用空间；如果插入U盘或者移动硬盘将会出现“外部存储空间”的大小使用情况，用户可以在这里将外部存储安全地加载或移除。

Selecting "Storage" on the left side of screen, you can activate "Internal storage Space" page on the right side as P11. This page contains the information of total volume, used volume, and available volume; the volume of external storage space from USB Disk or removable storage.



图11  
P11

应用程序 APPS

在应用程序界面里，用户可以对一些程序进行卸载，以节省存储空间和提高系统的运行效率。见图P12以及 P13

Selecting "Apps" on the left side of screen, enter the page of "Apps", you can remove the less common used applicator for reducing inner occupied memory space and improving the system efficiency as P12 & P13



图12 P12



图13 P13

语言和输入法 LANGUAGE & INPUT

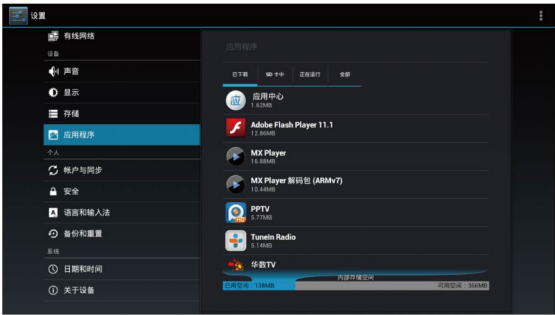
在设置界面左边分类栏中选择“语言和输入法”，进入“语言和输入法”设置界面，如图14，点击屏幕右边的“语言”菜单，然后，用户根据需要选择英文、中文或其他语言。在“键盘和输入法”下方用户可以选取合适的软键盘，默认的软件盘为讯飞输入法。

Selecting "Language and Input" on the left side of screen, you can enter the page of "Language and Input" as P14, then click "Language" on the right side to select English, Chinese, or other language. Under the "Keyboard and Input", you can select proper soft keyboard, "Xun-Fei Input" is default software.



图14 P14



图15 P15

日期和时间 DATE & TIME

在设置界面左边分类栏中选择“日期和时间”，进入“日期和时间”设置界面，用户可以修改系统的日期和时间，也可以选择时区，如图15

Selecting "Date & Time" on the left side of screen, you can enter the page of "Date & Time" and adjust date and time by the time zone as in P15.

关于设备 ABOUT DEVICE

在设置界面左边分类栏中选择“关于设备”，设备的各种信息将会在屏幕的右边展现出来，如图16，点击右边栏目中的“系统更新”，用户将会更新系统版本到最新。

Selecting "About Device" on the left side of screen, you can enter the page of "About Device", there are various information will be shown on the right side as P16, click "System Update" and you will obtain the latest version.



图16 P16

联系方式 Contact Information

公司地址：上海市徐汇区桂平路680号33幢403室 邮编：200233  
Company Address: Room 403,Building 33,No.680,Gui Ping Road, Xuhui District, Shanghai, 200233 China  
客服热线（Service Hotline）：400-885-6500  
公司网址（Company Website）：http://www.bluebell-networks.com

特别声明 Special Notice

- 在您通过本产品与互联网相连时，经由付费网站产生的相关费用，由使用者自行承担。  
You will be responsible for all the cost generated from purchasing any Apps and internet connection.
- 本手册版权归上海风网网络科技有限公司所有，不可擅自复制和传播，如有侵权行为，应承担相应的法律责任。  
The copy right of this User's Manual is belong to Shanghai Bluebell Networks, Inc. Any illegal copy or misconduct of usage will subject a legal responsibility.
- 每套产品附有保修单一份，请您妥善保管，以便售后服务与维修。  
You will find a Warranty paper included within the packing box. Please keep it properly for service.
- 本手册最终解释权归上海风网网络科技有限公司所有。  
Company, Shanghai Bluebell Networks, Inc., reserves the right to interpret of the User's Manual.

This equipment has been tested and found to comply with the limits for a Class B digital device, pursuant to Part 15 of the FCC Rules. These limits are designed to provide reasonable protection against harmful interference in a residential installation. This equipment generates uses and can radiate radio frequency energy and, if not installed and used in accordance with the instructions, may cause harmful interference to radio communications. However, there is no guarantee that interference will not occur in a particular installation. If this equipment does cause harmful interference to radio or television reception, which can be determined by turning the equipment off and on, the user is encouraged to try to correct the interference by one of the following measures:

- Reorient or relocate the receiving antenna.
- Increase the separation between the equipment and receiver.
- Connect the equipment into an outlet on a circuit different from that to which the receiver is connected.
- Consult the dealer or an experienced radio/TV technician for help.

This device complies with Part 15 of the FCC Rules. Operation is subject to the following two conditions: (1) This device may not cause harmful interference, and (2) this device must accept any interference received, including interference that may cause undesired operation.

FCC Caution: Any changes or modifications not expressly approved by the party responsible for compliance could void the user's authority to operate this equipment. To comply with FCC's RF radiation exposure limits for general population, the HD network player must be installed to provide a separation distance of at least 20 cm from all persons and must not be collocated or operating in conjunction with any other antenna or transmitter.