

# SOUNDBAR-F020L

## USER MANUAL



### FCC Statement

#### FCC Warning Statement

Changes or modifications not expressly approved by the party responsible for compliance could void the user's authority to operate the equipment. This equipment has been tested and found to comply with the limits for a Class B digital device, pursuant to Part 15 of the FCC Rules. These limits are designed to provide reasonable protection against harmful interference in a residential installation. This equipment generates uses and can radiate radio frequency energy and, if not installed and used in accordance with the instructions, may cause harmful interference to radio communications. However, there is no guarantee that interference will not occur in a particular installation. If this equipment does cause harmful interference to radio or television reception, which can be determined by turning the equipment off and on, the user is encouraged to try to correct the interference by one or more of the following measures:

- Reorient or relocate the receiving antenna.
- Increase the separation between the equipment and receiver.
- Connect the equipment into an outlet on a circuit different from that to which the receiver is connected.
- Consult the dealer or an experienced radio/TV technician for help.

This device complies with part 15 of the FCC Rules. Operation is subject to the following two conditions: (1) This device may not cause harmful interference, and

(2) this device must accept any interference received, including interference that may cause undesired operation.

#### RF Exposure Statement

To maintain compliance with FCC's RF Exposure guidelines, This equipment should be installed and operated with minimum distance of 20cm the radiator your body. This device and its antenna(s) must not be co-located or operation in conjunction with any other antenna or transmitter.

## 2.1 CH MULTIMEDIA SPEAKER SYSTEM

1

### Speaker accessories:

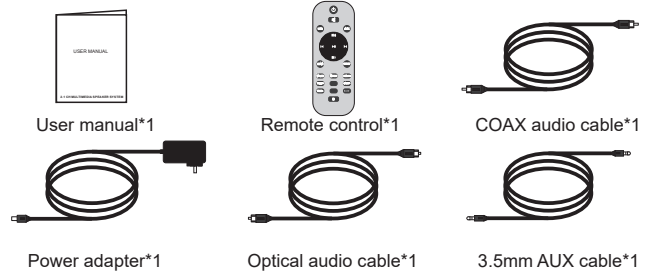

### Components function description

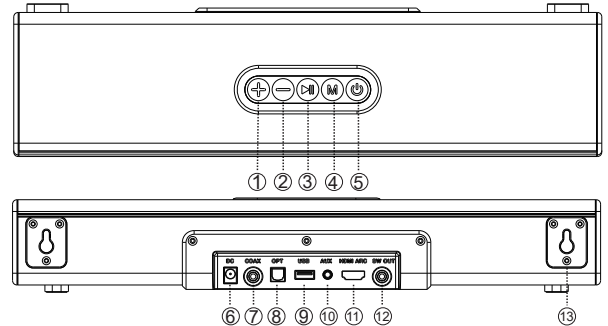

1. Volume up/previous song
2. Volume down/next song
3. Music play/pause button
4. Mode switching button
5. Power on/off button
6. DC15V IN interface
7. Coaxial digital audio input socket
8. Optical digital audio input socket
9. U-disk/USB interface
10. 3.5 mm AUX input socket
11. HDMI ARC input interface
12. Subwoofer output interface
13. Wall-mount Dimension

**NOTE:** short press "+" - "-" buttons to volume adjustment, long press "+" - "-" buttons to the preview/next songs.

2

### Infrared remote control function

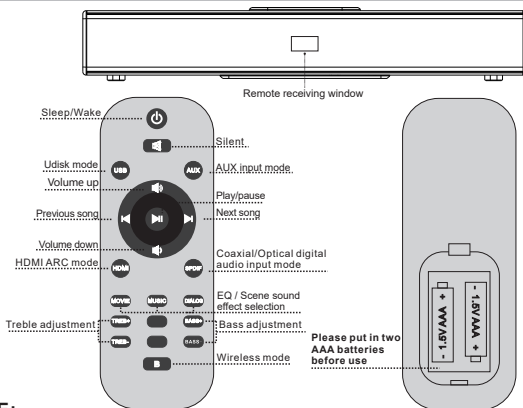

#### NOTE:

1. Press 'SPDIF' button to enter the optical and coaxial mode, the first press for OPT mode, and then press once to enter the COAX mode, the two modes are cyclic switching.
2. Please use the treble and bass adjustment keys with caution, over-adjustment may cause sound distortion, you can press the scene sound effect mode key (MOVE/MUSIC/DIALOG) to reset.
3. In COAX/OPT/HDMI ARC/AUX modes, the "MUTE" button has no function, press "MUTE" button is the mute function.

### Indicator Status

SOURCE OR MODE	WIRELESS	HDMI ARC MODE	OPT MODE	COAX MODE	AUX MODE	Udisk MODE
Indicator	Wireless is not connected: blue light fast flashing; Wireless connected / work status: blue light stop flashing.	Red light	Orange light	Light blue light	Green light	Purple light
Related interface		HDMI ARC	OPT	COAX	AUX	Udisk

3

### Subwoofer connection

Please connected the speaker and subwoofer before using as shown in the picture.

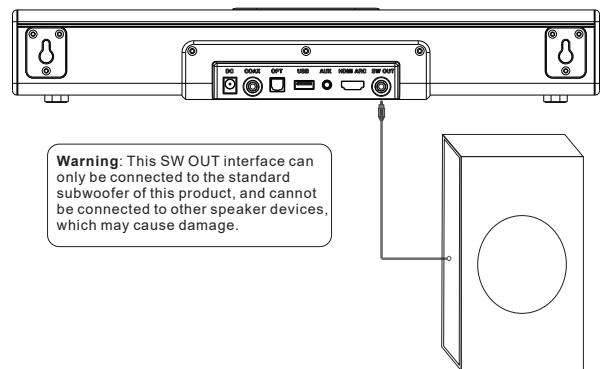

(Optional, The power cannot exceed 20W)

### Wireless function

1. When the speaker is used for the first time, after the speaker is connected to the power adapter, it will automatically turn on and enter to wireless mode, the blue light will be flashing, and accompanied by voice prompt, then the speaker has been in standby search status.
2. Open the phone's wireless function, searched the speaker's wireless name: " F020L " and paired, when the speaker connected successfully, a prompt sound will beep, at the same time, the blue light stop flashing, you can start using the speaker to play music; the next time with the same device matching, the speaker will automatically to connected.

**Note:** wireless connection must be completed within 30 minutes, not connected for more than 30 minutes the speaker will be automatically turn off.

4

## HDMI ARC INPUT MODE

Connect the TV's HDMI ARC interface



### NOTE:

1. As shown the HDMI ARC interface of the speaker must be connected to the TV'S HDMI ARC interface (it with audio return function), if it is a normal HDMI interface, it may not be used to connect the speaker.
2. Please use the HDMI cable in the TV accessories or other high-quality HDMI cables, Low-quality HDMI cables may not be available.
3. Due to the different processing chips of the TV, the response time of the HDMI mode may be different. so some TVs use the HDMI interface to connect to the speakers for the first time, the sound output time may be delayed by about 10 seconds. please know that, thanks!
4. Please select audio source output of the TV, can not be used directly. Set HDMI ARC output from your TV first (setting--sound--advanced-- audio output--select HDMI ARC audio output) .
5. In the boot state, press the "HDMI" button on the remote control enter to the HDMI mode or press the mode switching button once to the HDMI audio mode on speaker, at the speaker changed successful you can hear the voice prompt and the indicator light is red.
6. Short press "+ , -" button to volume up/down.
7. Short press "▶||" button to mute.

## SPDIF INPUT MODE ( COAXIAL OR OPTICAL )

Speaker connect to TV'S SPDIF(COAXIAL/OPTICAL) interface

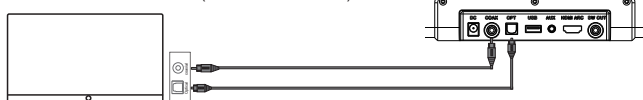

1. In the boot state ,as shown, connected the audio cable for your device and the speaker.

5

2. Press the SPDIF" button on the remote control to enter the OPT/COAX mode or short press the " M " button on speaker to enter the this mode. if you changed successful you can hear the voice prompt (the prompt tone in COAX mode is an electronic tone ).
3. Set digital audio output from your TV first (setting--sound--advanced-- audio output--select digital audio output).
4. Short press "+ , -" button to volume up/down.
5. Short press "▶||" button to mute.

**NOTE: Please select audio source output of the TV, can not be used directly.**

## External audio AUX input function

In the boot state, the external devices (such as mobile phones, computers/MP3 and other audio output devices) with the 3.5mm audio cable connected to the speaker, this time the speaker will automatically switch to the AUX input mode, and the indicator light is purple. there will be a tone, then the speaker can play the audio from the device.

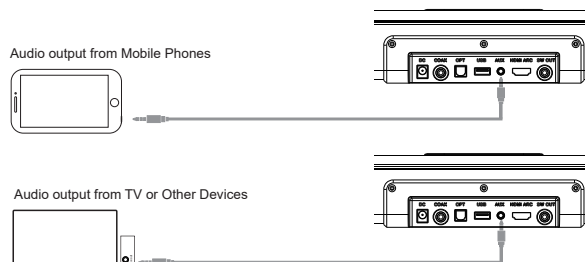

### Note:

**In AUX mode, can't adjust the previous or the next tune, press "▶||" button is the mute function.**

6

## Play Udisk function

In the boot state, when inserted the Udisk, the speaker will automatically converted to Udisk mode, it with a prompt tone, and the indicator light is purple. the music will be played automatically after 2 seconds, short press "+ -" button to volume adjustment, long press "+ -" button to the preview/next songs.

**NOTE: the Udisk must have Mp3 audio files or WAV format files .**

## Technical parameters

- ☆Model: F020L
- ☆Power adapter voltage: DC15V 4A
- ☆Frequency response: 50Hz-16KHz
- ☆Noise ratio : ≥90DB
- ☆Distortion: THD ≤ 1%
- ☆Support the TV connection: HDMI ARC/COAX and OPT/AUX
- ☆Support Udisk music format: MP3 /WAV
- ☆Wireless transmission distance: 10M (due to environmental factors and wireless devices vary)
- ☆Conforms to the Wireless V5.0 agreement.
- ☆Product size: L400mm\*W105mm\*H65mm.

## Using the environment and storage environment

1. Operating environment  
Temperature: 0 ~ 40 DEG C, humidity: 0% ~ 85%RH
2. Storage environment  
Temperature -30 ~ 60 DEG C, humidity: 0% ~ 90%RH

7

## Troubleshooting

### 1.TV cannot connect to speakers and used

If the TV does not have HDMI ARC, AUX and coaxial/optical output ports, try connecting speakers to a TV box or DVD to use.

### 2.No sound in Optical/Coaxial audio input mode

Please confirm the speaker whether optical /coaxial mode is currently entered, press the SPDIF" button on the remote control to enter to coaxial mode or short press the " M " button on speaker to enter the optical /coaxial mode. if you changed successful you can hear the voice prompt (the prompt tone in COAX mode is an electronic tone ).

Press the "SPDIF" of the remote controller to switch between OPT and COAX modes.

Set digital audio output from your TV first (setting--sound--advanced--digital audio output format--select PCM/ setting--sound--advanced-- audio output--select digital audio output) , devices compatibility will be vary, see your device's documentation for more information to set.

### 3.No sound in HDMI ARC mode

Please confirm the speaker whether HDMI mode is currently entered ,press the "HDMI" button of the remote control to enter the mode; short press the "M" button to enter the HDMI mode, when the speaker enter to HDMI mode ,the indicator light will turn red and you can hear the voice "HDMI" prompt.

Set HDMI ARC output from your TV first (setting--sound--advanced-- audio output--select HDMI ARC output) , devices compatibility will be vary, see your device's documentation for more information to set.

Please read carefully the precautions in the manual about the HDMIARC function.

### 4.Unable to boot

Check whether the power adapter is plugged in securely, or replace the power socket and try it.

### 5.No sound

Is the mute function turned on or the volume adjusted to a minimum?  
Press the mute button to close the function or turn up the volume.

### 6.The remote control does not work

Is the battery exhausted ? Change a new battery.  
Is the distance between the remote control and the speaker too far? Get close to the device.  
Is the remote control aimed at the infrared receiver?  
Aim the remote control at the middle part of the speaker.

### 7.Wireless cannot connect

Please confirm the speaker whether wireless mode is currently entered (the blue indicator will flash quickly in wireless mode).  
Restart the speaker, delete the phone's wireless record and search for a new pair.

8