



528 Stunt motorcycle manual



Thank you for choosing our product, in order to better understand and use of this product, please read the instructions with this product carefully, then operate. And keep the manual for necessary reread.

1.Product Configuration List



Motorcycle



Transmitter



Remote antenna

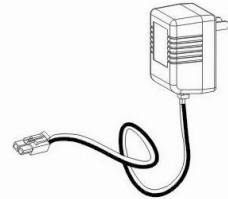

Charger

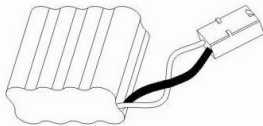

Rechargeable battery



2 Turn support pieces



Manual

2.Description of of body and remote

1.Motorcycle

- | | |
|----------------------------------|-----------------|
| 1.Motorcycle | 2.Power Switch |
| 3.The battery cover press button | 4.Battery cover |
| 5.Turn support pieces | 6.Drive gear |

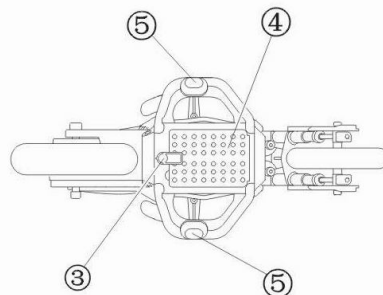
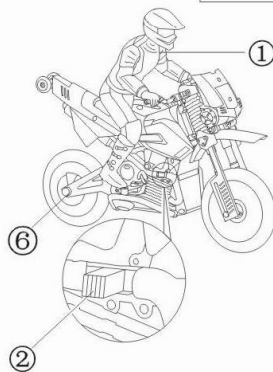

2. Transmitter

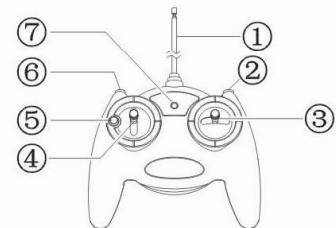

- | | |
|-------------------------------|---------------|
| ①Antenna | ②Off button |
| ③Left and right steering rods | ④Forward rods |
| ⑤Speed button | ⑥Brake button |
| ⑦Work light | |

3.description of of body and remote

As shown (Figure 1), connect original rechargeable batteries and charger in the correct way , then put the charger into an electrical socket, then the light of charger is on indicates charging in progress , charging about 4 hours, the surface of battery micro-thermal , the lighth of charger become dark or off that is fully charged. If the charging time is too long, the battery may cause damage or burns, fire, etc..

Note:

- 1.Ensure that the charger voltage meet your local standards.
- 2.This product can only charge the battery by charger included
- 3.The staff not to leave when charging. Do not put flammable materials next to the battery and not to use flammable goods covering the batteries.
- 4.Do not over-charging the battery, charging batteries found in hot, stop charging. .
- 5.After repeated charging, the charging time can be increased.
- 6.If a smell or battery get hot suddenly, deformation, discoloration or other abnormalities when use or charge the battery, please immediately stop using the battery.

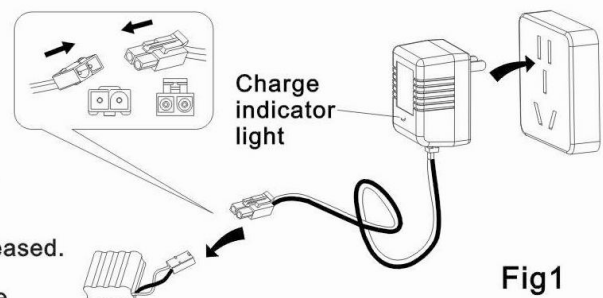

Fig1

4.Preparing to install antenna and battery of remote control before control.

- 1.insert the antenna end into remote antenna hole,then tighten the clockwise direction. (Figure 2)
2. open the remote battery cover, install on the remote control 3 "AA" batteries (not included) in the correct way, install battery cover with Phillips screwdriver tighten the screw clockwise (optional). (Figure 3)

Note:

- ①Install the battery must look for battery terminals and battery box of the positive and negative, can not install in reverse.
- ②Do not mix old and new batteries or different types of batteries.

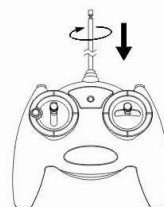

Fig2

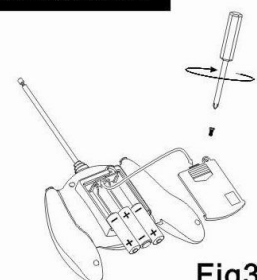

Fig3

5.prepare on how to install the battery of body before control

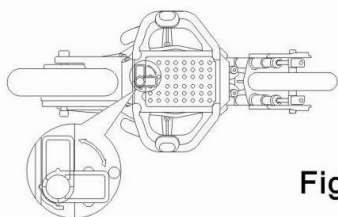

Fig4

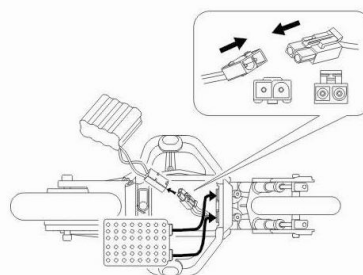

Fig5

- 1.Headstand the body, rotate the battery cover press button outside the battery cover, remove the battery cover. (Figure 4)
- 2.Connecting the plug of rechargeable battery pack and power plug of car in right way, put in battery box, cover the battery lid, rotate the battery cover press button to battery cover.(Figure 5)

6.Body basic control method

- 1.Put the body on the ground, push the "forward handle" of remote, body moving forward.(Figure 6)

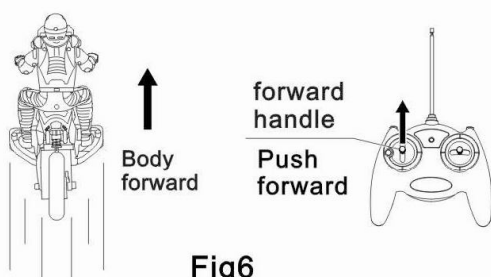

Fig6

- 2.When the body moving forward, press the "speed button", body speed driving. (Figure 7)

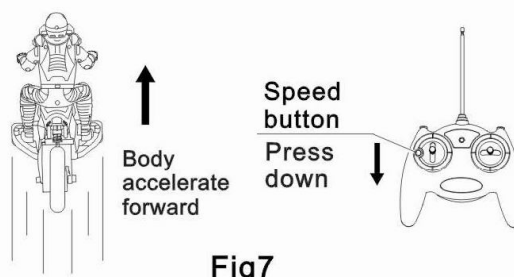

Fig7

- 3.When the body in driving, press the "brake button", the body will stop running. (Figure 8)

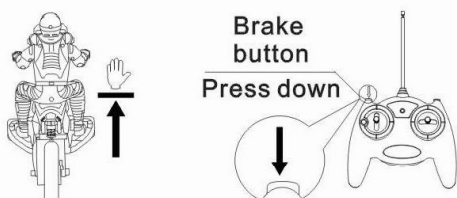

Fig8

- 4.When the body in moving, push the left / right control stick, the body will be to the left / right. (Figure 9)

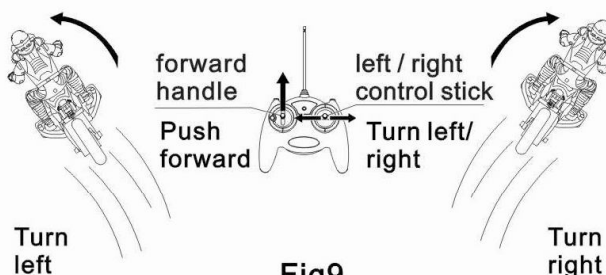

Fig9

7.Prepared to control

- 1.Site requirements: as the size of a basketball court or a more spacious and smooth rough, clean without water cement floor.
- 2.Lengthening the remote antenna (remote control farther), the body is up, turn on the body power switch (switch to "ON" state), to prepare control. (Figure 10)

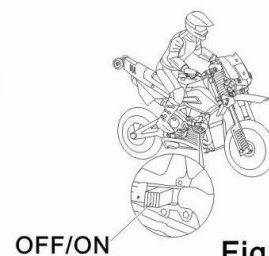
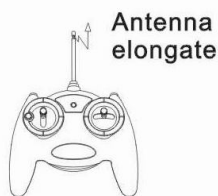
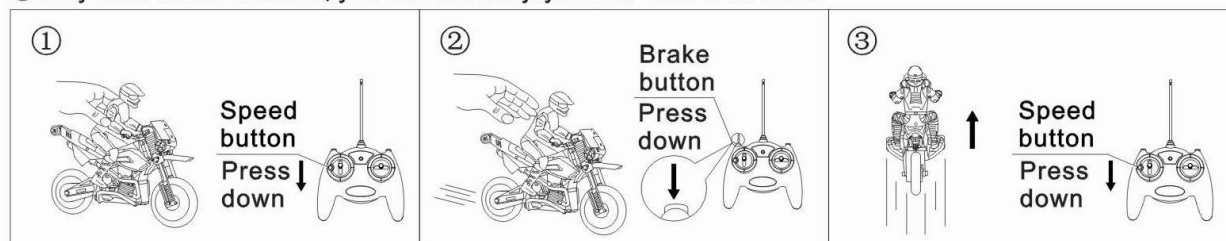

Fig10

8.Game Method

A.

- ①Left hand holding the body vertical with the ground, and then right hand press the accelerate button, then the rear wheels quickly rotate.
- ②Rear wheel rotating about 10 seconds, press the brake button and put the car on ground vertically moment, Then press the speed button, the body forward.
- ③body drive some distance, you can use the joystick to control forward.



B.

- ① In smaller ground, press brake button, when body support piece contact with the ground , then push forward handle, then the steering angle is smaller.
- ② When prepare to turn left and right, need to slow down. General do is unlash forward handle, operate the left and right handle when the body in natural process of sliding, then the body turn left and right, if power shortage when turning can push forward handle.

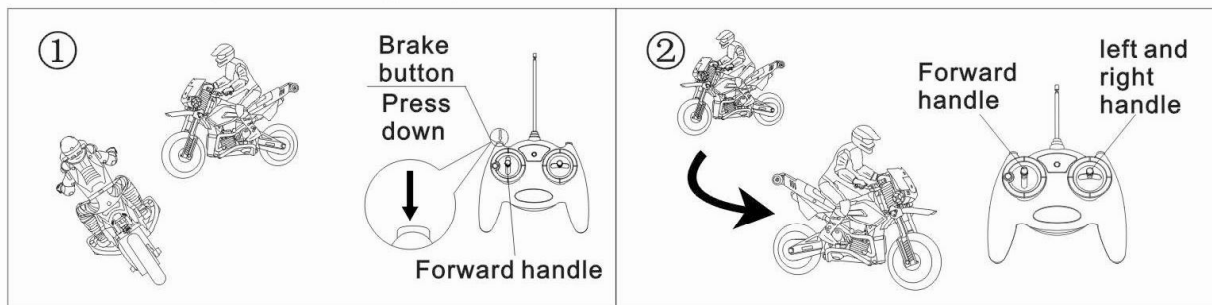

9.Special challenge

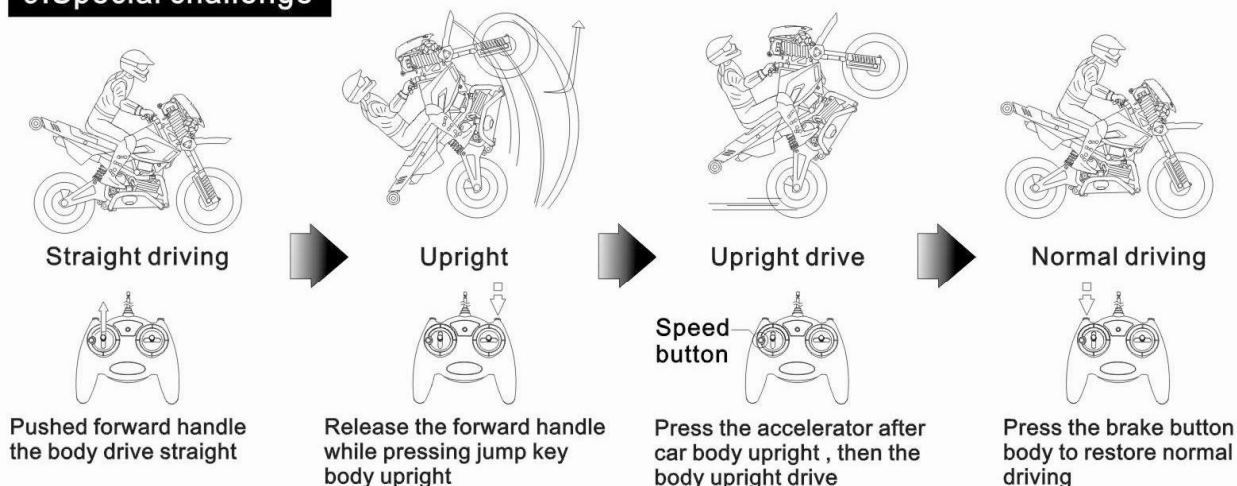

1.Erect single-wheel drive:

Fig11

When the body in Straight line moving , (body plumb with the ground as possible),while release the forward handle press bouncing button then release, when the body straight up and then press the acceleration button, then cars will be driving straight, When found the body slope, press brake button return to normal driving.(Figure 12)

Note:

- (1)Front wheel bouncing power more fierce when press jumping button, so do not be facing the front wheel to human facial or eye, in order to avoid injuries. (Figure 12)
- (2)When a moving body in an upright body, if found to tilt to the next by "brake button" return to normal driving status to prevent the body falling.

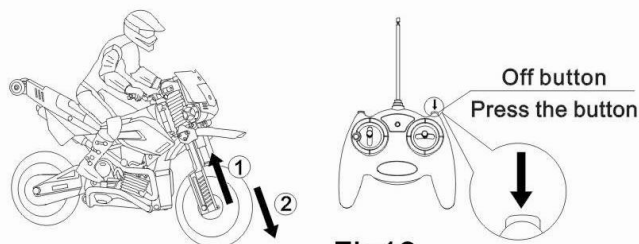

Fig12

2.Point of body 360° roll

Such as (Figure 13), the body moving in accelerating slope, the moment when the front wheel leave the slope,press the "brake button" then immediately release, then the car roll up to 360° till the body return normal driving conditions, then push the "left stick" back to normal driving.

Note: This operation requires player know the methods of control this product , and operate each function keys of remote control.

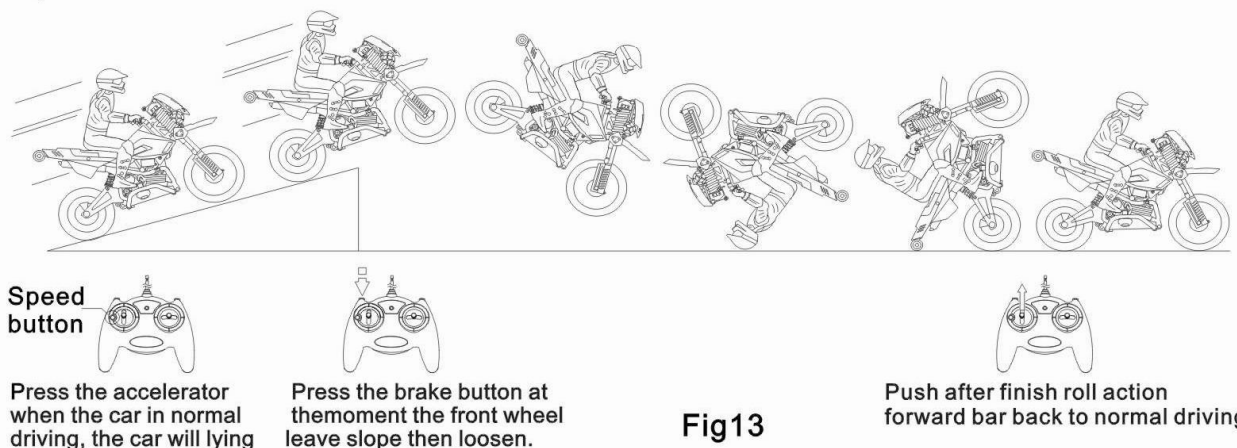

Fig13

10.replacement turning support part

Figure (Figure 14),

- 1.Body be use in a long time, the left / right "turning support part " wear, resulting in damaged,need to replace the parts .
- 2.Keep the body oblique, with Phillips screwdriver counterclockwise rotation, until "turning support part"removed
- 3.Install the product free "turning support part" in the right way
- 4.Tighten screw by screwdriver in a clockwise direction.

Tips: if this "turning support part" all used up, go to the nearby dealer to buy.

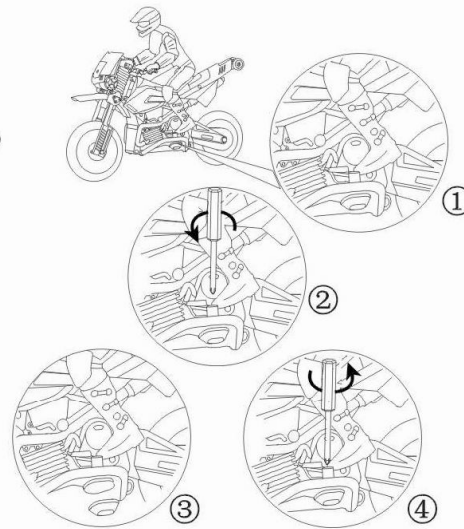

Fig14

11.troubleshooting guide

Problem	Cause	Solution
Remote control indicator is off	Do not use the remote control function keys	Push the joystick or press the button
	Install the batteries but does not follow the right polarity	Check and ensure that the battery install accordance with polarity of battery box
	The battery has run out of power	replacing new battery
Can not control the helicopter	Power switch of body is not turn on, in OFF positio	Switch to "ON" position
	Do not use the remote control function keys	Push the joystick or press the button
	body power cord plug and battery plug is not connect well	Check and ensure that the battery plug and power cord plug connect in right way
	The battery pack has run out of power	Please charge the battery pack again
body can't bounce and easy skew	Site is Slipper	Change more rough ground

- 1.When remote and body's power is low, will affect control then the distance is short.
- 2.The maximun control radius of this product is about 35 meters, please control it within about 35 meters, if over 35 meters, may loss control and cause accidents.
- 3.When the body battery power is low, please stop playing and turn body power switch to "OFF" state, to avoid battery damage as over-discharge ; a long time without playing, set the battery plug and the body power cord plug disconnect , and fully charge the battery before stock.
- 4.Long time not use, please remove remote battery, to avoid product damage as battery leakage or other failure caused.
- 5.The body can't crash serious, it will damage the body or shorten use times.

12.Caution

The user is cautioned that changes or modifications not expressly approved by the party responsible for compliance could void the user's authority to operate the equipment.

This equipment has been tested and found to comply with the limits for a Class B digital device, pursuant to part 15 of the FCC Rules. These limits are designed to provide reasonable protection against harmful interference in a residential installation. This equipment generates, uses and can radiate radio frequency energy and, if not installed and used in accordance with the instructions, may cause harmful interference to radio communications. However, there is no guarantee that interference will not occur in a particular installation. If this equipment does cause harmful interference to radio or television reception, which can be determined by turning the equipment off and on, the user is encouraged to try to correct the interference by one or more of the following measures:

- Reorient or relocate the receiving antenna.
- Increase the separation between the equipment and receiver.
- Connect the equipment into an outlet on a circuit different from that to which the receiver is connected.
- Consult the dealer or an experienced radio/TV technician for help.

WARNING

- *Please observe the operation manual or packing explanation to install and use, some parts should be install and use under the adult supervision.
- *The product contains small parts,it may cause swallow or choke.
- *Do not play in a place where it full of the road,as it may lead to malfunction.
- *Please throw the wrapper in time to avoid damage the children.
- *Regularly examine for damage to the charger, wire,plug, bodysell or other parts.In the event of any damage,it must not be used until the damage has been repaired.
- *The charger,battery box and battery must insert with the appointed power source of product symbol same.
- * Only use the original collocation charger.
- * The charger is not a toy.
- * Apart the charger and toy before clean
- * Do not aim the antenna at people,face or eyes to avoid cause the damage.
- * Batteries are to be inserted or replaced with the correct polarity.
- * Use the "AA" non-rechargeable or rechargeable batteries.
- * Non-rechargeable batteries are not to be recharged.
- * Rechargeable batteries should only be charged under adult supervision.
- * Different types of batteries or old and new batteries are not to be mixed.
- * Exhausted batteries should be removed in time.
- * Do not short circuit the terminals.
- * Never short circuit the batteries,disassemble or throw it in a fire.
- * Please remove the batteries when not in use.
- * Please keep this package and manual as it included the important information.