

# Instruction For Use

## SE-02W

*Thank you very much for using our products, please Install and use after reading the instructions carefully.*

Preface Energy saving receptacle (ESR) is a intelligent wall socket which is developed jointly by Yangzhou Jinding Electronics Co., Ltd and Sunrise Energy LLC to solve standby power of home appliances. Its main features are: Eliminating the standby power of electric appliances, Improving the quality and power efficiency of electricity, extending lifespan of electric appliances, reducing the electromagnetic radiation and electrical fire caused by electric appliances.

### I. Safety Caution

1. Don't install the unit in some wet and inflammable circumstance.
2. Clean control with a soft damp cloth only. Do not use any chemical cleaners.
3. Don't insert metal into socket directly which may result in electrical shock.
4. Don't insert the electric appliance that its power greater than the rated power marked on the socket.

### II. Product Parameter

Name: Energy saving receptacle (ESR)

Model: SE-02W

Material: (UL94V0) Fireproof PC shell、H62-Y copper parts

Packaging: 40 pieces/box

Dimension: 105.6mmX48mmX65.1mm

Working temperature: —10°C to 50°C

Working Humidity: ≤95%RH

Remote-controlled distance: ≥5m

Ratings: 125V~ 60Hz 15A

Frequency range: 315MHz

### III. Installation

1. Turn power OFF. Remove old receptacle and disconnect all wires.
2. Refer to Wiring Diagrams.
3. Connect live (black wires) to brass screw terminal(s), and tighten securely.
4. Connect neutral (white wires) to silver screw terminal(s), and tighten securely.
5. Connect isolated ground wire to green grounding screw terminal, and tighten securely. Note: Isolated ground wire should be insulated and readily distinguishable (as in green with yellow striped insulation) from the building ground (green insulation).
6. Refer to Mounting Instruction

### (1) Important Note

1. For installation by a qualified electrician only.
2. Connect only No. 10, 12 or 14 AWG (6, 2.5 or 1.5 mm<sup>2</sup>) copper or copper-clad wire to this device.  
Do not connect aluminum wire to this device. See device for strip length.

### (2) Mounting Instructions

1. Push wires into wallbox, allowing room for receptacle to be inserted. Do not pinch wires between wallbox and receptacle.
2. Mount receptacle to wallbox using screws provided.
3. Replace faceplate adapter (if removed) and snap on faceplate.

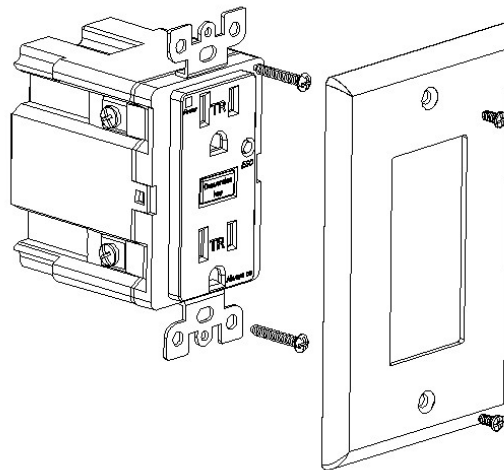

**Note:** Mounting means not grounded. Receptacle does not self ground when mounting it to a wallbox. A ground wire connection is required for receptacle grounding. Failure to connect a ground wire to the green grounding screw terminal will result in an ungrounded receptacle.

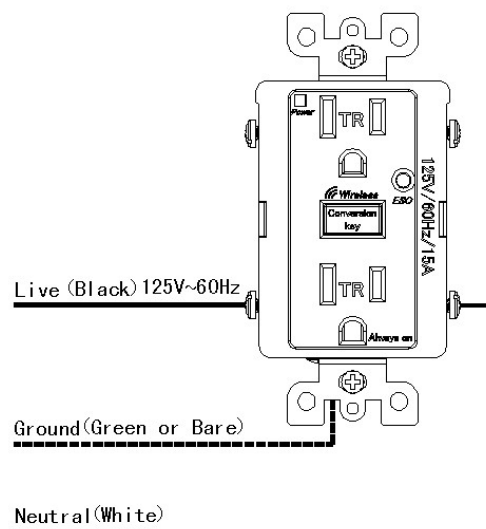

#### IV. Icon Description of Use function

Remote control mach coding: Press On button ESO for 2 seconds, pressing the buttons on the matched remote control aiming the socket when indicator light flashing. Light off means matching code successfully.

1. Power indicator: Indicating the current situation of the intelligent socket.
2. Intelligent socket: Electrical appliances on the socket are in a state of off or standby, it shall cut out the power automatically after 15 seconds.
3. Conversion key: Two sockets will be converted to normal power on when pressing the key, the intelligent program will be started when pressing again.
4. Always on socket: The normal open socket.
5. ESO key: Power Reset key, match code key.
6. Remote controller indicator: Indicates that if the remote key can be triggered successfully.
7. Remote control on-off key: You can connect power of intelligent socket by pressing it after matching code, and turn off by pressing again.

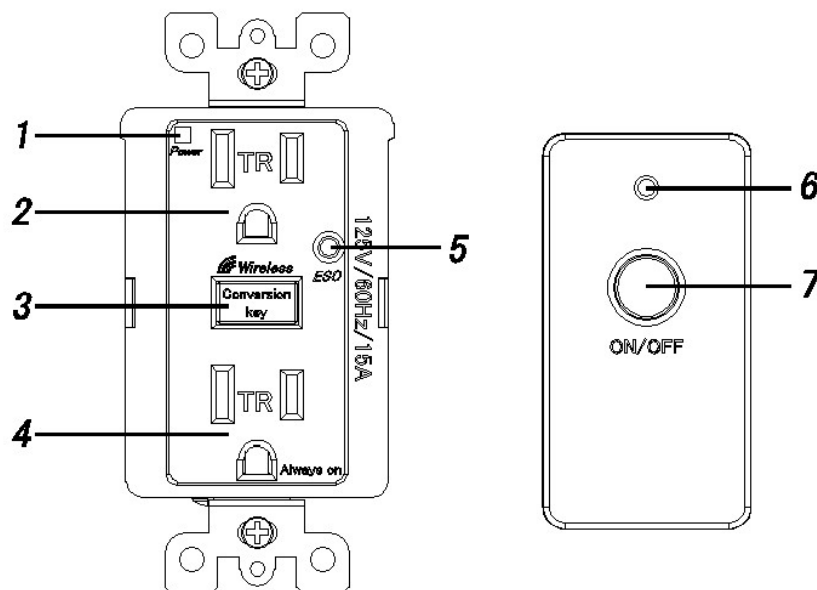

## **V. Limited Warranty**

(Valid only in the U.S.A., Canada, Puerto Rico, and the Caribbean.)

Sunrise Energy will, at its option, repair or replace any unit that is defective in materials or manufacture within one year after purchase. For warranty service, return unit to place of purchase or mail to Sunrise Energy at 12322 Highway 99, Suite E89, Everett, WA 98204.

THIS WARRANTY IS IN LIEU OF ALL OTHER EXPRESS WARRANTIES, AND THE IMPLIED WARRANTY OF MERCHANTABILITY IS LIMITED TO ONE YEAR FROM PURCHASE.

THIS WARRANTY DOES NOT COVER THE COST OF INSTALLATION, REMOVAL OR REINSTALLATION, OR DAMAGE RESULTING FROM MISUSE, ABUSE, OR DAMAGE FROM IMPROPER WIRING OR INSTALLATION. THIS WARRANTY DOES NOT COVER INCIDENTAL OR CONSEQUENTIAL DAMAGES. Sunrise Energy' S LIABILITY ON ANY CLAIM FOR DAMAGES ARISING OUT OF OR IN CONNECTION WITH THE MANUFACTURE, SALE, INSTALLATION, DELIVERY, OR USE OF THE UNIT SHALL NEVER EXCEED THE PURCHASE PRICE OF THE UNIT.

This warranty gives you specific legal rights, and you may have other rights which vary from state to state. Some states do not allow the exclusion or limitation of incidental or consequential damages, or limitation on how long an implied warranty may last, so the above limitations may not apply to you.

©2013 Sunrise Energy LLC

## **DÉCLARATION DE LA FCC**

1. Cet appareil est conforme à la partie 15 des règles de la FCC. Son fonctionnement est soumis aux deux conditions suivantes:

(1) Ce dispositif ne doit pas causer d'interférences nuisibles.

(2) Cet appareil doit accepter toute interférence reçue, y compris les interférences pouvant entraîner un fonctionnement indésirable.

## FCC STATEMENT

1. This device complies with Part 15 of the FCC Rules. Operation is subject to the following two conditions:

(1) This device may not cause harmful interference.

(2) This device must accept any interference received, including interference that may cause undesired operation.

2. Changes or modifications not expressly approved by the party responsible for compliance could void the user's authority to operate the equipment.

NOTE: This equipment has been tested and found to comply with the limits for a Class B digital device, pursuant to Part 15 of the FCC Rules. These limits are designed to provide reasonable protection against harmful interference in a residential installation.

This equipment generates uses and can radiate radio frequency energy and, if not installed and used in accordance with the instructions, may cause harmful interference to radio communications. However, there is no guarantee that interference will not occur in a particular installation. If this equipment does cause harmful interference to radio or television reception, which can be determined by turning the equipment off and on, the user is encouraged to try to correct the interference by one or more of the following measures:

- Reorient or relocate the receiving antenna.

- Increase the separation between the equipment and receiver.

- Connect the equipment into an outlet on a circuit different from that to which the receiver is connected.

- Consult the dealer or an experienced radio/TV technician for help.