



## User Manual

### Welcome to the world of tinyFinder!

tinyFinder is a revolutionary device that will help you prevent losing your valuable things. The User Manual provides a few basic features and step-by-step processes.

If you have any questions or encounter any difficulties, you can reach us at **service@tinyfinder.com**

© 2013 Tiny Finder Co., Ltd. All rights reserve.

### Syncing tinyFinder with Device:

1. Pull out the battery insulator from the tinyFinder.
2. Download the tinyFinder App from the Apple App store.
3. Turn on Bluetooth connection on your smart device.
4. Turn on the tinyFinder App and click (+) on the top right corner to sync your tinyFinder. Make sure the tinyFinder you wish to be synced is next to your smart device. Wait for approximately 30 to 60 seconds. The App will let you know when the new tinyFinder is detected. Rename your tinyFinder if needed.
5. You can pair more than 8 tinyFinder on your smart device.

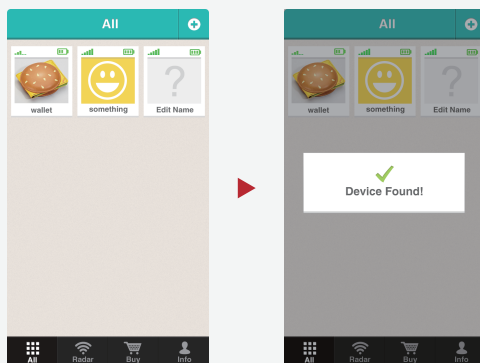

### Radar:

The radar feature provided in the App gives you a visual image on your smart device of the distance and movement of the object you want to keep track of.

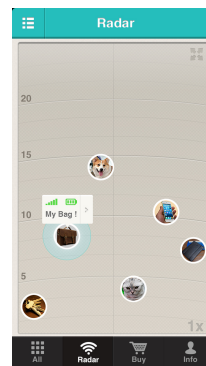

### Range:

tinyFinder can trace your valuables up to 150 feet/45M in an open area. You can also set specific distance you want from your App on your smart device to activate tinyFinder.

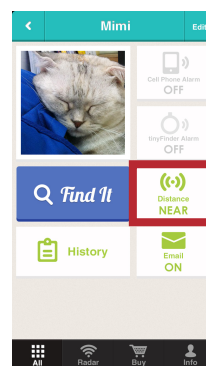

### REQUIREMENTS:

iOS device with Bluetooth 4.0

### SPECS:

Technology: Bluetooth 4.0

Range: About 150 feet/45M

Battery: Lasts for a year (30 mins. day use)

Battery Type: CR2016 watch battery

Temperature Range: 5°F~150°F



#### FCC Statement:

Changes or modifications not expressly approved by the party responsible for compliance could void the user's authority to operate the equipment. NOTE: This equipment has been tested and found to comply with the limits for a Class B digital device, pursuant to part 15 of the FCC Rules. These limits are designed to provide reasonable protection against harmful interference in a residential installation. This equipment generates, uses and can radiate radio frequency energy and, if not installed and used in accordance with the instructions, may cause harmful interference to radio communications. However, there is no guarantee that interference will not occur in a particular installation. If this equipment does cause harmful interference to radio or television reception, which can be determined by turning the equipment off and on, the user is encouraged to try to correct the interference by one or more of the following measures: —Reorient or relocate the receiving antenna. —Increase the separation between the equipment and receiver. —Connect the equipment into an outlet on a circuit different from that to which the receiver is connected. —Consult the dealer or an experienced radio/TV technician for help.

### Find It:

Press the Find It button on the App after you select the one of the icons on the Radar screen to make the tinyFinder light and alarm.

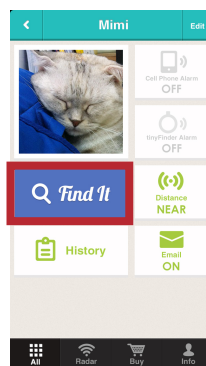

### 2-Way Tracking:

What happens when you found your tinyFinder but can't find your phone? Click the button on this amazing little device to make your phone alarm.

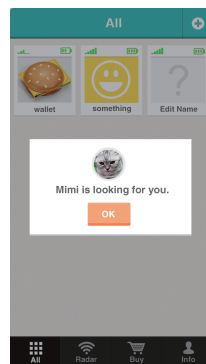

### Changing Battery:

tinyFinder uses CR2016—a standard watch battery. Take off the top cover, remove the old battery and replace it with a new one. One side of the battery is marked with +, the positive side. Carefully place the battery into the device with the same side down as the old battery.

### Stick or Hang:

tinyFinder can be stuck onto anything or be hung like an accessory as it comes with a loop.

### Email Notification:

Tracking history will be stored and recorded on your App; and if you would like, you can also turn on Email Notification to receive instant tracking messages.