

Welcome to Tracki - Attention! Please read

Thank you for choosing Tracki - if you are not completely satisfied, please contact our **24 hrs 7 days live support at: tracki.com/chat or call: US: +1 (323) 785 2020 | UK:+44 7700 175 888 | CA:+1 (226) 741-2505 | MX: +52 55 9414 6571**

We strive to make you fully satisfied, and satisfaction is 100% guaranteed. We will be glad to help you anytime you need.

Any issues? Please allow us to resolve your issue or concerns before returning the product or submitting a complaint.

To get started

1. Download Tracki App Scan the QR code below or type in your browser tracki.com/ios for IOS or tracki.com/android for android.

2. Create an Account Open the app and tap "Lets Start!". Enter your email, name, country, and password. Tap "Continue".

3. Activate your Device Add your tracker ID and IMEI, you can find it on the box or on the side of the tracker. Choose and pay for your subscription. Enter your devices name, info & picture. (Subscription pays for your data plan to send live location data to our servers via the cellular network, the costs of maintaining our servers, infrastructure and tech support).

FYI: GPS Trackers need to be in a location that can properly receive satellite signals. Satellite signal may be obstructed by dense trees, tall buildings, or going indoors. In such cases, your Tracki will make use of nearby Wi-Fi routers to provide an approximate location. There are a few battery saving modes, please refer to the online manual or in app instructions.

Getting Started

1 Scan to download, sign in to the Tracki app and view the full user manual.



2 Link your device and select a subscription plan



3 Take the device outdoors and start tracking.

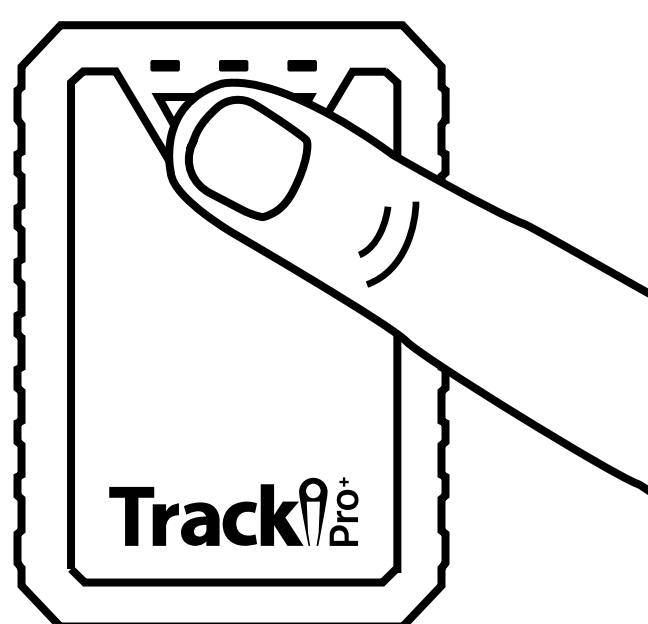

**Short-press the button to ensure the device is on. If none of the lights turn on, press the button for 3 seconds*

Buttons and lights

Device is starting up	(long press 5s)	
Device is powering off	(long press 3s)	
Device is online	(single press)	
Device is on but offline	(single press)	
Activate SOS mode	(triple press)	
Battery is low	(flashes continuously)	
Device is charging	(connected to power)	
Device is fully charged		

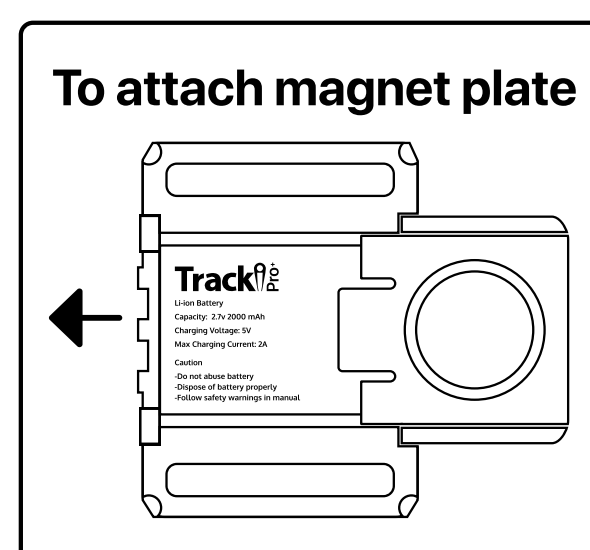

FCC Compliance Summary This device complies with FCC Part 15 rules: it may not cause harmful interference and must accept any interference received. Unauthorized modifications void usage rights. Follow all safety guidelines to prevent injury or damage. For more info visit tracki.com/fcc

Battery, Li-Polymer Battery | DC 3.7V, 10000mAh, 36Wh Attention Use only approved charger | Do not disassemble or modify | Do not short-circuit | Do not dispose of in fire | Do not expose to high temperature (60°C/140°F) Made in China by Huizhou Xiangyu New Energy Co. For product safety info visit tracki.com/safety

FCC Caution.

This device complies with part 15 of the FCC Rules. Operation is subject to the following two conditions: (1) This device may not cause harmful interference, and (2) this device must accept any interference received, including interference that may cause undesired operation.

Any Changes or modifications not expressly approved by the party responsible for compliance could void the user's authority to operate the equipment.

Note: This equipment has been tested and found to comply with the limits for a Class B digital device, pursuant to part 15 of the FCC Rules. These limits are designed to provide reasonable protection against harmful interference in a residential installation. This equipment generates uses and can radiate radio frequency energy and, if not installed and used in accordance with the instructions, may cause harmful interference to radio communications. However, there is no guarantee that interference will not occur in a particular installation. If this equipment does cause harmful interference to radio or television reception, which can be determined by turning the equipment off and on, the user is encouraged to try to correct the interference by one or more of the following measures:

- Reorient or relocate the receiving antenna.
- Increase the separation between the equipment and receiver.
- Connect the equipment into an outlet on a circuit different from that to which the receiver is connected.
- Consult the dealer or an experienced radio/TV technician for help.

This GPS Tracker meets the government's requirements for exposure to radio waves. The guidelines are based on standards that were developed by independent scientific organizations through periodic and thorough evaluation of scientific studies. The standards include a substantial safety margin designed to assure the safety of all persons regardless of age or health.

The SAR limit of USA (FCC) is 1.6 W/kg averaged over one gram of tissue. Device types: GPS Tracker (FCC ID: 2AAI6-TRKM110-C) has also been tested against this SAR limit. The highest SAR value reported under this standard during product certification for when properly worn on the body is 1.294W/kg. This device was tested for typical body-worn operations with the back of the handset kept 5mm from the body. To maintain compliance with FCC RF exposure requirements, use accessories that maintain a 5mm separation distance between the user's body and the back of the handset. The use of belt clips, holsters and similar accessories should not contain metallic components in its assembly. The use of accessories that do not satisfy these requirements may not comply with FCC RF exposure requirements, and should be avoided.

This device was tested for typical body-worn operations. To comply with RF exposure requirements, a minimum separation distance of 5mm must be maintained between the

user's body and the handset, including the antenna. Third-party belt-clips, holsters, and similar accessories used by this device should not contain any metallic components. Body-worn accessories that do not meet these requirements may not comply with RF exposure requirements and should be avoided. Use only the supplied or an approved antenna.

IC Warning

This device contains licence-exempt transmitter(s)/receiver(s) that comply with Innovation, Science and Economic Development Canada's licence-exempt RSS(s). Operation is subject to the following two conditions:

1. This device may not cause interference.
2. This device must accept any interference, including interference that may cause undesired operation of the device.

The SAR limit of USA is 1.6 W/kg averaged over one gram of tissue. Device types: GPS Tracker (IC: 12317A-TRKM110C) has also been tested against this SAR limit. The highest SAR value reported under this standard during product certification for when properly worn on the body is 1.172W/kg. This device was tested for typical body-worn operations with the back of the handset kept 5mm from the body. To maintain compliance with IC RF exposure requirements, use accessories that maintain a 5mm separation distance between the user's body and the back of the handset. The use of belt clips, holsters and similar accessories should not contain metallic components in its assembly. The use of accessories that do not satisfy these requirements may not comply with IC RF exposure requirements, and should be avoided.

Body-worn Operation

This device was tested for typical body-worn operations. To comply with RF exposure requirements, a minimum separation distance of 5mm must be maintained between the user's body and the handset, including the antenna. Third-party belt-clips, holsters, and similar accessories used by this device should not contain any metallic components. Body-worn accessories that do not meet these requirements may not comply with RF exposure requirements and should be avoided. Use only the supplied or an approved antenna.

Cet appareil contient des émetteurs/récepteurs exemptés de licence qui sont conformes aux RSS exemptés de licence d'innovation, sciences et développement économique Canada. Le fonctionnement est soumis aux deux conditions suivantes:

- (1) l'appareil ne doit pas produire de brouillage, et
- (2) l'utilisateur de l'appareil doit accepter tout brouillage radioélectrique subi, même si le brouillage est susceptible d'en compromettre le fonctionnement

La limite SAR des Etats-Unis est de 1,6 W / kg en moyenne par gramme de tissu. Types d'appareil: GPS Tracker (IC: 12317A-TRKM110C) a également été testé contre ces valeurs. La valeur de das la plus élevée déclarée en vertu de cette norme lors de la certification du produit lorsqu'il est correctement porté sur le corps est de 1,172w /kg. Ce dispositif a été testé pour les opérations typiques portés sur le corps avec le dos du combiné gardé 5mm du corps. Afin de maintenir la conformité aux exigences de la IC, utilisez des accessoires qui maintiennent une distance de séparation 5mm entre le corps de l'utilisateur et le dos du combiné. L'utilisation de pinces de ceinture, étuis et accessoires similaires ne doivent pas contenir de composants métalliques dans son ensemble. L'utilisation d'accessoires qui ne satisfont pas à ces exigences ne peuvent pas

se conformer aux exigences de la IC, et devrait être évitée.

Porté au corps Opération

Ce dispositif a été testé pour les opérations typiques portés sur le corps. Pour se conformer aux exigences d'exposition aux radiofréquences, une distance de séparation minimale de 5mm doit être maintenue entre le corps de l'utilisateur et le combiné, y compris l'antenne. Tiers pinces de ceinture, étuis et autres accessoires similaires utilisés par ce dispositif ne doit pas contenir de composants métalliques. accessoires qui ne répondent pas à ces exigences peut ne pas se conformer aux exigences d'exposition RF et doit être évité Body-porté. Utilisez uniquement l'antenne fournie ou une approbation.