

Air / Wing

+ Please visit our website to download our multi-language manual www.isawcam.com

ENGLISH / ESPAÑOL / FRANÇAIS / DEUTSCH
PORTUGUÊS / РУССКИЙ / ITALIANO
한국어 / 中国 / 日本

V106



2. LCD icons



No.	Function	Description
1	Mode	Shows the current shooting mode (video or photo)
2	WiFi	Shows the WiFi connection status
3	Memory capacity	Shows the usable memory capacity in percentage (%)
4	Battery	Shows the battery capacity status option
5	Resolution	While shooting videos or photos, it shows the current recording resolution
6	Shooting mode	While shooting videos or photos, it shows the current shooting mode
7	Recording Time	While shooting videos or photos, it shows the current recording time

7. User setup menu

- You can select basic settings and detailed setting options through the user setup menu.
- 1. Press SETUP to enter the user setup menu.
- 2. User setup menu is divided into four categories (video, photo, My Tune, settings)
- 3. Press and hold MODE to move category.
- 4. Press SETUP and MODE to browse that category.
- 5. Press REC to select and confirm the setting option within the sub-menu.

Function	Sub menu	Description
Video	Resolution	1080P 1920 x 1080 30fps
		960P 1280 x 960 30fps
		720P 1280 x 720 60fps
		720P 1280 x 720 30fps
	Time lapse	Time lapse 1s, 2s, 3s, 5s, 10s, 15s, 30s Take pictures at the selected interval to create an accelerated video.
		Loop Rec.
	Auto start	On / Off. If ON, starts to record after the selected time when the camera is switched on (1s, 5s, 10s)
Mic	On / Off. If ON, sound will be captured and added to the video recording.	
Color filters	Shoot in Vivid colors, Natural colors, Sepia filter, Black & White	
Time Stamp	On / Off	

8. Recharging the battery

- The LCD will flash the low battery icon when the battery is too low and almost depleted.
- The camera will save the file, if it is recording, and then turn off.
- Then, you must recharge your battery.
- It will take about 150 minutes to fully charge the battery via USB.
- You can use an AC charging adapter (optional accessory) for a quicker recharge.

 1. Turn off the camera.
 2. Connect the camera USB port to your computer via USB cable.
 3. The blue LED will be on and the battery will start recharging.
 4. The LED will be off when the battery is fully charged.

9. Smartphone control

- With the WiFi function of ISAW Cameras, you can control the camera with your smartphone.
- Compatible with iOS ver. 6.0 or higher, Android OS Jelly Bean or higher.
- Before you connect the camera, download the 'ISAW Viewer II' application on your smartphone.
- Search for 'ISAW VIEWER II' in iPhone App Store or Google Play Store
- * While your smartphone is connected to the camera, camera button operation will be disabled.
- * 'ISAW VIEWER II' will be upgraded with more features as further updates are released.

1. Name of parts

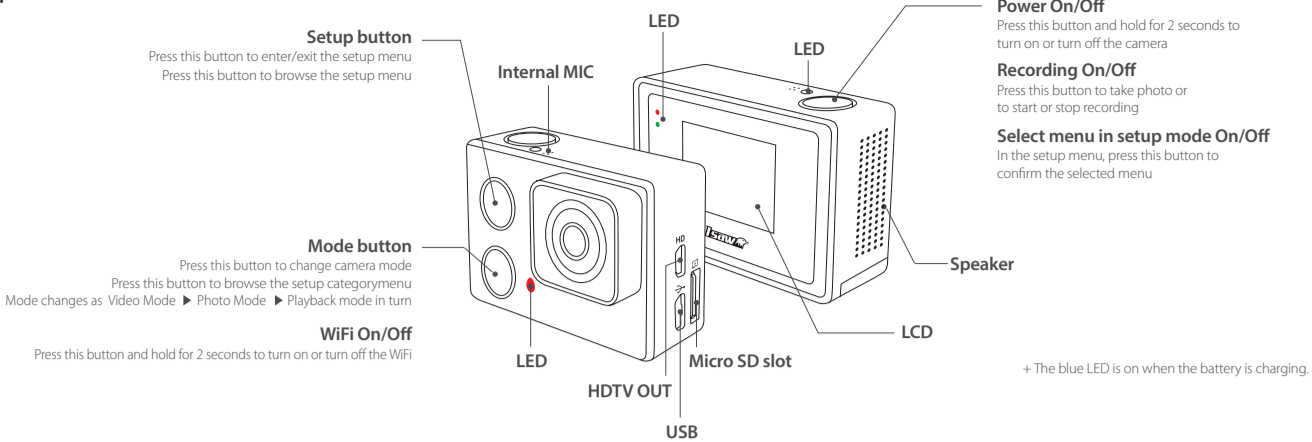

3. Start the camera

- 1) Open the battery cover and insert an ISAW Li-ion battery.
- 2) Insert a SD card into the SD card slot.
- 3) Press the power button and hold 2 seconds.
- 4) The camera turns on and the LCD monitor shows the camera image.
- 5) Mode changes as (Video mode ▶ Photo mode ▶ Playback mode ▶ Video mode) in turn.

4. Video recording

- While the camera is on, press REC to start recording videos as per the established settings.
- When the camera starts to record, the LED blinks and the LCD displays the recording time.
- Press REC again to stop the recording.
- You can choose various resolutions and recording options in the Video section of the User setting menu section (see 7. User setup menu)

5. Photo shoot

- While the camera is on, press MODE to change to photo camera mode.
- Press REC to take a photo.
- You can choose various photo sizes and capture options in the Photo section of the User setting menu section (see 7. User setup menu)
- In time-lapse mode press REC to start the time-lapse and REC again to stop it.

Function	Sub menu	Description
Photo	Resolution	12M 4608 x 2592 16:9
		8.5M 3840 x 2160 16:9
		7.3M 3648 x 2048 16:9
		5M 3072 x 1728 16:9
		3M 2304 x 1296 16:9
	2M 1920 x 1080 16:9	
Capture options	Manual	Take pictures at the selected interval to create an accelerated video.
	Burst	Take 10 photos with a single press of the button
Self timer	Time lapse 3s, 5s, 10s, 15s, 30s, 60s	
	Self timer	Delays the photo by the selected time: 2s, 10s.
Color filters	Color filter	Shoot in Vivid colors, Natural colors, Sepia filter, Black & White
	Time Stamp	On / Off

6. Playback mode

- Press MODE hold to change to playback mode
- You can view recorded videos or photos through the LCD screen of the camera.

 1. In playback mode, press SETUP to choose a file to view.
 2. Press REC to view the file.
 3. While the file is playing you can use the control panel by pressing:

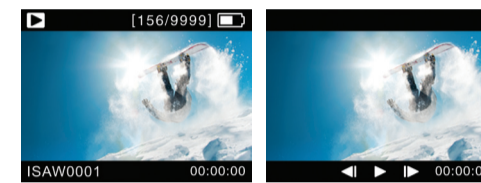

Function	Sub menu	Description
My Tune	My Tune	When turned on, below settings will be restored to their last value. Turn off to set to auto.
	Sharpness	Strong, Normal, Soft
	Exposure	+2, +1.7, +1.3, +1, +0.7, +0.3, 0, -0.3, -0.7, -1, -1.3, -1.7, -2 Set the correction of the exposure
	ISO	ISO 50, 100, 200, 400, 800, 1600
	AE Metering	center, average, spot
Settings	White balance	Set the white balance to a different type of light Auto, Daylight, Cloudy, Tungsten lamp, Fluorescent lamp
	WDR	On / Off
	Mirror Flip	On / Off (Flips the image vertically)
	Power off	Off / 3m / 5m / 10m
	LCD off	Off / 1m / 5m / 10m
	LED	On / Off
	Beep	On / Off
	TV	Choose frequency PAL (50Hz) or NTSC (60Hz)
	Delete all	Cancel / Confirm (Delete files under 'DCIM' folder only)
	Format	Cancel / Confirm (Delete all files and format SD card)
Default	Cancel / Confirm	
Time	Set the current time (YYMMDD#HHMM)	
Language	English, French, Spanish, German	
Information	Shows the current S/W version	

NB : New settings and parameters are added via updates of the firmware. Make sure to use the latest firmware for an optimal experience. Check www.isawcam.com for the latest firmware updates.

10. Connect your ISAW Camera to a smartphone

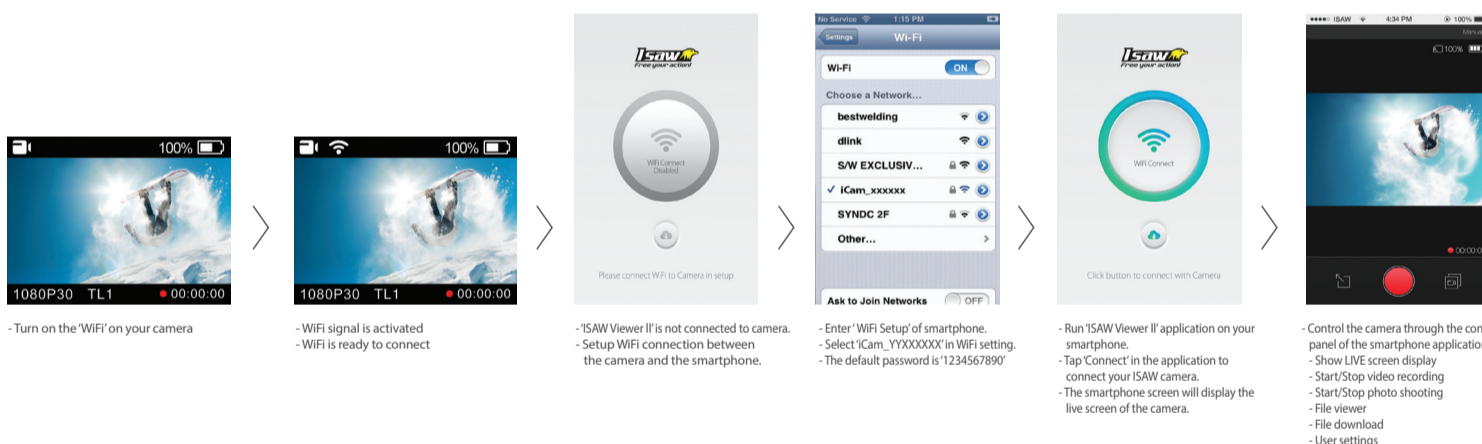

11. Transferring data to a computer

- If the camera is connected to a computer or an AC adapter while it is powered off, the camera starts to recharge the battery.
- If the camera is connected to a computer while it is powered on, the camera changes to file-transfer mode.
- While the camera is connected to an AC adapter or a car charger for recharge, the camera can record while it is recharging.

 1. Turn on your ISAW Camera.
 2. Connect the camera to a computer via a USB cable.
 3. The camera LCD will display 'USB Ready'.
 4. Go to 'my computer' in the PC.
 5. Locate 'removable disc'.
 6. Double click 'DCIM' folder and search video or photo files.

12. Firmware Update (www.isawcam.com)

- You can always find the latest firmware updates of ISAW products on the website. www.isawcam.com
- Firmware upgrade may not be possible if the battery is too low.
- Recharge the battery up to two third of the gauge for a safer upgrade.

 1. Format the memory card, and copy the firmware file to the root directory of the Micro SD card.
 2. Insert the Micro SD into ISAW Cameras and turn the camera on.
 3. The firmware upgrade will start automatically, and the camera will turn off when upgrade is finished. (Do NOT turn off the device or remove the battery during the firmware upgrade.)

13. Features and specifications

- Super Slim Action camera
- Full HD 1080p 30fps professional video quality
- 40m waterproof housing (Included in Wing only)
- High precision digital CMOS sensor with maximum 12MP photo resolution
- 150° wide-angle field of view
- 1.5" built-in LCD view finder
- Built-in WiFi with enhanced application viewer
- Versatile recording resolution (1080p / 960p / 720p)
- Time lapse video, time lapse photo
- Burst shot photos (max. 10 consecutive photo shots)
- Multi language menu (Eng, Esp, Fra, Deu)
- Rechargeable Li-ion battery
- Battery running time : max. 100 minutes of continuous recording (* recording time may vary, depends on environmental condition.)
- Recharging time : 150 minutes
- Easy graphical user interface in LCD display

14. Package Includes

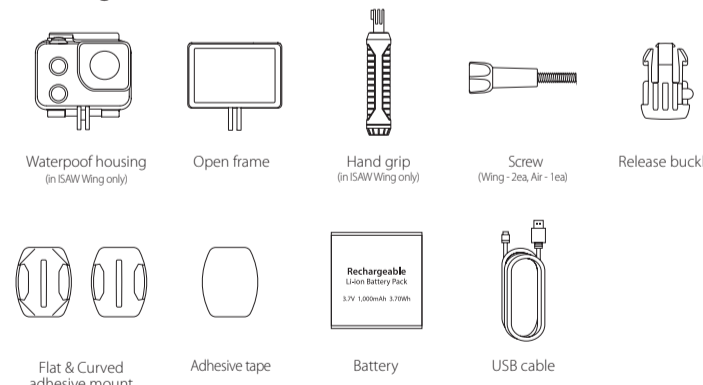

Any Changes or modifications not expressly approved by the party responsible for compliance could void the user's authority to operate the equipment.

This device complies with part 15 of the FCC Rules. Operation is subject to the following two conditions: (1) This device may not cause harmful interference, and (2) this device must accept any interference received, including interference that may cause undesired operation.

FCC Radiation Exposure Statement:

This equipment complies with FCC radiation exposure limits set forth for an uncontrolled environment. This transmitter must not be co-located or operating in conjunction with any other antenna or transmitter. Note: This equipment has been tested and found to comply with the limits for a Class B digital device, pursuant to part 15 of the FCC Rules. These limits are designed to provide reasonable protection against harmful interference in a residential installation. This equipment generates uses and can radiate radio frequency energy and, if not installed and used in accordance with the instructions, may cause harmful interference to radio communications. However, there is no guarantee that interference will not occur in a particular installation. If this equipment does cause harmful interference to radio or television reception, which can be determined by turning the equipment off and on, the user is encouraged to try to correct the interference by one or more of the following measures:

- Reorient or relocate the receiving antenna.
- Increase the separation between the equipment and receiver.
- Connect the equipment into an outlet on a circuit different from that to which the receiver is connected.
- Consult the dealer or an experienced radio/TV technician for help.