

BUSH - Bluetooth Stereo Speaker

User Instructions – Please keep for future reference

SPK310

BUSH



SPK310

Important – Please read these instructions fully before using

These instructions contain important information which will help you get the best from your appliance and ensure safe and correct use and maintenance.

Functions & Controls

Customer Helpline: 0870 600 3030

Please familiarize yourself with the parts and accessories listed below

Accessories included

- 1 x SPK310
- 1 x Micro USB cable
- 1 x Instruction manual

Overview of controls

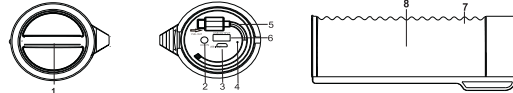

1. Knob Switch (Power ON/OFF [Press and hold]; Vol-/Vol+ [Turn left / right])
2. AUX IN (Connect the mobile phone via the 3.5mm Audio cable directly)
3. Micro USB INPUT Socket (Connect the provided micro USB cable to your computer for charging up the speaker)
4. Battery charging indicator
5. Internal micro USB cable
6. USB OUTPUT (Charge the mobile phone)
7. Mode indicator
8. Microphone

User Instructions

Power ON/OFF

- Press and hold the knob switch to turn the unit on. The unit will beep. The LED indicator will blink in red once, then light up in blue color.
- Press and hold the knob switch to turn the unit off. The LED indicator will disappear.

Bluetooth

1. Turn on the Bluetooth function of your Bluetooth device.
2. Turn on the speaker, it will beep.
3. Press and hold the knob switch button twice continuously and quickly to activate Bluetooth pairing. The unit will beep, then the LED indicator will flash blue until it pairs. When successfully paired, the unit will beep once and the LED indicator will regularly flash blue at 5-seconds intervals (approx.).
4. Search for the unit with your Bluetooth device and you should see "SPK310". Enter password "0000" if requested.

Power bank

- Connect the charging cable of your mobile phone to the USB OUTPUT as shown below. It would start charging.

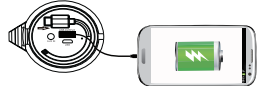

Power bank

- SPK310 provided with an internal micro USB cable, you can charge your mobile phone via the cable directly.



Note: 1. Make sure the product is turned on and fully charged during use.
2. Please PAUSE or OFF the bluetooth connection when charge your mobile phone.

Operations

To	Press / Hold	Effect
Increase Volume	Turn right the knob switch	Louder
Decrease Volume	Turn left the knob switch	Quieter
Answer Call (during playback)	Press once the knob switch	Answer call & stop playback
End Call (during playback)	Press once the knob switch	End Call
Reject Call (any time)	Press the knob switch for about 1 second	Reject call
Use Speaker for call (during call)	Press the knob switch for about 1 second	Switch to unit's mic and speaker
Use mobile phone for call (during call)	Press the knob switch for about 1 second	Switch to mobile phone

! Safety Information

Important – Please read these instructions fully before installation

- Ventilation**
 - To prevent the risk of electric shock or fire hazard due to overheating, ensure that curtains and other materials do not obstruct the ventilation vents.
 - A minimum distance of 5cm around the unit should be maintained to allow for sufficient ventilation.

- Safety**
 - Always disconnect the unit from the mains supply before connecting/disconnecting other devices or moving the unit.
 - Unplug the unit from the mains socket during a lightning storm.

- Maintenance**
 - Ensure to unplug the unit from the mains socket before cleaning. Do not use any type of abrasive pad or abrasive cleaning solutions as these may damage the unit's surface.
 - Do not open any fixed covers as this may expose dangerous voltages.

- Interference**
 - Do not place the unit on or near appliances which may cause electromagnetic interference. If you do, it may adversely affect the operating performance of the unit, and cause a distorted sound.

User Instructions

Caution

The unit has a built-in rechargeable Li-polymer battery. The battery is charged automatically when the micro USB INPUT socket is connected with your computer or USB charger.

- The speaker needs to be fully charged once a month.
- It takes 5 - 6 hours (approx.) to fully charge the battery.
- A fully charged unit has up to more than 8 hours of playback time.
- Do not overcharge the battery as it may shorten its life.
- To prolong battery life & sound quality, do not use while charging.

Troubleshooting

In the unlikely event of difficulties with your appliance please follow the troubleshooting guide below.
If the problem persists, contact the retailer if the machine is still under guarantee.
Customer **helpline: 0870 600 3030**

Menu	Description / Solution
No power.	<ul style="list-style-type: none">• Make sure that the unit is switched ON at the rear.• The battery may be exhausted. Connect the USB cable and plug into a USB port of a computer which is turned on.
Loud hum or noise is heard.	<ul style="list-style-type: none">• The plugs and sockets are dirty. Wipe them with a cloth slightly moistened with an appropriate non-abrasive cleaning solution.
Cannot answer calls	<ul style="list-style-type: none">• Ensure your mobile phone supports Bluetooth HSP/HFP.• Check the mobile phone and unit are connected.
Exceed Red SPK310T on my Bluetooth device.	<ul style="list-style-type: none">• Ensure the Bluetooth function is activated on your Bluetooth device.

Contents

Safety Information	2-4
Functions & Controls	5
Accessories included	5
User Instructions	6
Power ON/OFF	6
Bluetooth	6
Power bank	6-7
Operations	7
LED Indicator Status	7
Caution	8
Troubleshooting	8
Rechargeable battery removal	9
Specifications	9



Product Codes
SPK310

User Instructions

Operations

Call functions only applicable if mobile phone is paired with the speaker and both are switched on.

When the minimum volume or maximum volume is reached, the unit will beep.

- To successfully answer a call, ensure your mobile device supports Bluetooth HFP.
- Ensure your Bluetooth device is configured to take full advantage of the unit's functions. Please refer to your Bluetooth device's manual for detailed instructions.
- When using the AUX IN function, you need to use your media device for all operations.

LED Indicator Status

The below table provides a summary of the LED indicator statuses:

Unit Mode	LED Color	LED Action
On	Red (Mode indicator)	Blinks once
Standby, without pairing	Blue (Mode indicator)	Blinks twice every other 1.5 seconds
Pairing	Blue (Mode indicator)	Blinks rapidly
Connected to Bluetooth Device	Blue (Mode indicator)	Blinks twice every other 5 seconds
AUX IN	Red & Blue (Battery indicator)	Solidly lit & Blinks as the Bluetooth mode
Charging	Red (Battery indicator)	Solidly lit
Charging complete	Blue (Battery indicator)	Solidly lit

! Safety Information

Important – Please read these instructions fully before installation



The lightning flash with arrowhead symbol, within an equilateral triangle, is intended to alert the user to the presence of uninsulated "dangerous voltage" within the unit's enclosure that may be of sufficient magnitude to constitute a risk of electric shock.

The exclamation point within an equilateral triangle is intended to alert the user to the presence of important operating and maintenance (servicing) instructions in the manual accompanying the unit.



This appliance complies with the following EU directives: 2006/95 /EEC Low voltage directive, 2004/108/EC EMC directive, 2002/96/ EC WEEE directive.



The symbol on the product or its packaging indicates that this product may not be treated as household waste. Instead it should be handed over to the applicable collection point for the recycling of electrical and electronic equipment. By ensuring this product is disposed of correctly, you will help prevent potential negative consequences for the environment and human health, which could otherwise be caused by inappropriate waste handling of this product. For more detailed information about recycling this product, please contact your local council office, your household waste disposal service or the shop where the product was purchased.

Rechargeable battery removal

In order to preserve the ecology please dispose of this unit properly so that it can be recycled.

Do not dispose of to unsorted waste.

For more detailed information about recycling of this product or battery, please contact your local Civic Office or your household waste disposal service.

If need to disassembly the battery, please follow the steps as follow:

- NOTE: The instruction for maintenance person reference only. Special tools may required.
1. Pull out the plug
 2. Remove the blocking stripes
 3. Remove the iron net
 4. Pull the knob
 5. Remove the knob and PCB.
 6. Open the shell
 7. Remove the battery

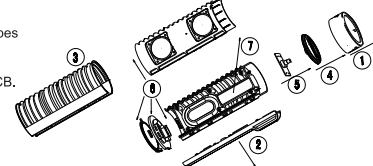

Specifications

Model	SPK310
Output Power	5W x2
Bluetooth	Bluetooth 4.0 (A2DP V1.2/HFP V1.6)
Dimension	186 (L) x 77 (W) x 65 (H) mm

Features and specifications are subject to change without prior notice.

! Safety Information

Important – Please read these instructions fully before installation

- Read all the instructions carefully before using the unit and keep them for future reference.

- Retain the manual. If you pass the unit onto a third party make sure to include this manual. Check that the voltage marked on the rating label matches your mains voltage.

- Damage**
 - Please inspect the unit for damage after unpacking.
 - Do not continue to operate the unit if you are in any doubt about it working normally, or if it's damaged in any way- switch off, withdraw the mains plug and consult your dealer.

- Location of Unit**
 - The unit must be placed on a flat stable surface and should not be subjected to vibrations.
 - Do not place the unit on sloped or unstable surfaces as the unit may fall off or tip over. The mains unit and should be easily accessible. socket must be located near the unit.

- Temperature**
 - Avoid extreme degrees of temperature, either hot or cold. Place the unit well away from heat sources such as radiators or gas / electric fires.

- Avoid exposure to direct sunlight and other sources of heat.

- Naked Flames**
 - Never place any type of candle or naked flame on the top of or near the unit.

- Moisture**
 - To reduce the risk of fire, electric shock or product damage, do not expose this unit to rain, moisture, dripping or splashing. No objects filled with liquids, such as vases, should be placed on the unit.
 - If you spill any liquid into the unit, it can cause serious damage. Switch it off at the mains immediately. Withdraw the mains plug and consult your dealer.

NOTE: This equipment has been tested and found to comply with the limits for a Class B digital device, pursuant to part 15 of the FCC Rules. These limits are designed to provide reasonable protection against harmful interference in a residential installation. This equipment generates uses and can radiate radio frequency energy and, if not installed and used in accordance with the instructions, may cause harmful interference to radio communications. However, there is no guarantee that interference will not occur in a particular installation. If this equipment does cause harmful interference to radio or television reception, which can be determined by turning the equipment off and on, the user is encouraged to try to correct the interference by one or more of the following measures:

- Reorient or relocate the receiving antenna.
- Increase the separation between the equipment and receiver.
- Connect the equipment into an outlet on a circuit different from that to which the receiver is connected.
- Consult the dealer or an experienced radio/TV technician for help

Changes or modifications not expressly approved by the party responsible for compliance could void the user's authority to operate the equipment. This device complies with Part 15 of the FCC Rules. Operation is subject to the following two conditions:

- (1) this device may not cause harmful interference, and
- (2) this device must accept any interference received, including interference that may cause undesired operation.

This device complies with Industry Canada licence-exempt RSS standard(s). Operation is subject to the following two conditions: (1) this device may not cause interference, and (2) this device must accept any interference, including interference that may cause undesired operation of the device.

Le présent appareil est conforme aux CNR d'Industrie Canada applicables aux appareils radio exempts de licence. L'exploitation est autorisée aux deux conditions suivantes : (1) l'appareil ne doit pas produire de brouillage, et (2) l'utilisateur de l'appareil doit accepter tout brouillage radioélectrique subi, même si le brouillage est susceptible d'en compromettre le fonctionnement.