

amaran®

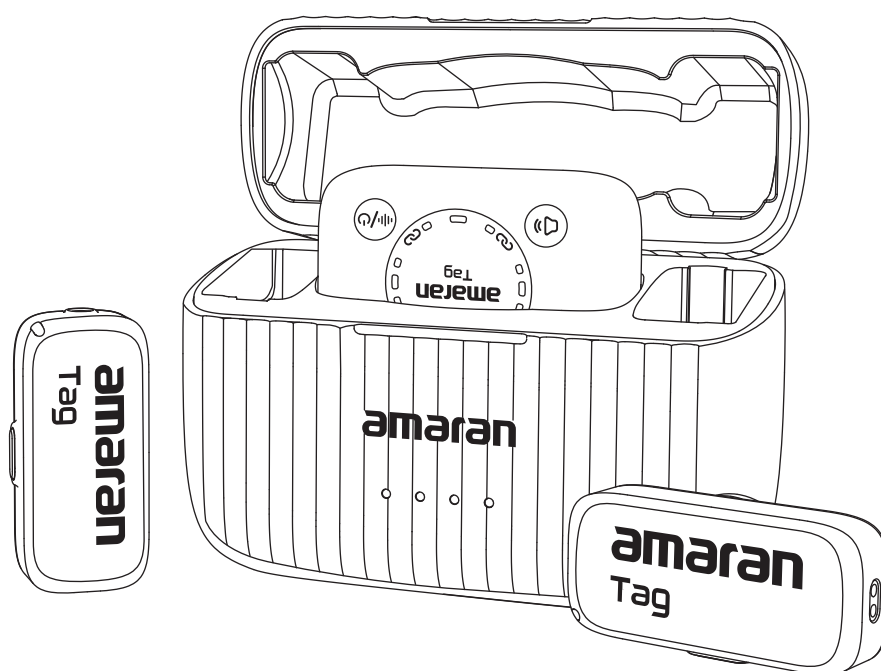

amaran Tag

Product Manual

English

Table of Content

| | |
|--------------------------------------|----|
| Introduction..... | 03 |
| Components List..... | 04 |
| Product Overview | 05 |
| Indicator Light Description..... | 09 |
| Operations | 11 |
| 1. TX RX power on/off..... | 11 |
| 2. TX RX pairing and connection..... | 11 |
| 3. Device connection..... | 13 |
| 3.1 Connect phone/tablet..... | 13 |
| 3.2 Connect camera | 14 |
| 3.3 Connect computer..... | 14 |
| 4. Wear microphone transmitter | 15 |
| 5. Gain adjustment..... | 16 |
| 6. Noise reduction adjustment | 16 |
| 7. Shutter control | 17 |
| 8. Charge the device | 17 |
| 9. Firmware Upgrade | 18 |
| Using the amaran App | 18 |
| Specifications | 19 |
| Important Safety Instructions | 21 |
| FCC Compliance Statement..... | 22 |
| RF Warning Statement..... | 22 |
| Disclaimer | 23 |

Introduction

Thank you for purchasing the amaran Tag. Designed for on-the-go content creators, the amaran Tag is a dual wireless microphone offering high-quality audio with seamless compatibility across devices – from phones, tablets, computers, to cameras. Whether you're vlogging, recording an interview, or live streaming, the amaran Tag provides creators with easy to use, versatile audio that lasts all day, while ensuring crystal clear sound.

The amaran Tag features two transmitters and one receiver, with each transmitter equipped with the ability to capture 24bit of high-quality, stable audio with up to 300m of stable transmission without interference. And with 3 levels of gain and voice isolation controls directly on the receiver, you can control how loud the signal is and how much background noise is filtered out, ensuring your voice remains clear, sharp, and natural in any recording environment.

Components List

Please make sure all accessories listed below are completed before using. If not, please contact your sellers immediately.



amaran Tag Receiver (RX) *1



*2

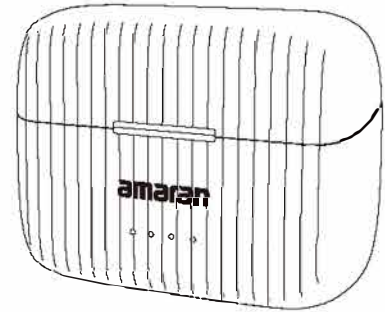

amaran Tag Charging Case *1



amaran Tag Magnetic Clip *3

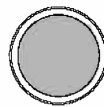

amaran Tag Magnet *2



amaran Tag Winscreen *2

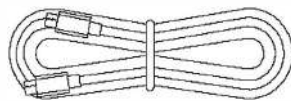

amaran USB-C Charging Cable (30cm) *1

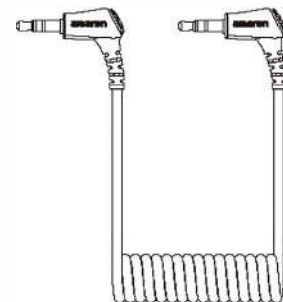

amaran Tag 3.5mm TRS Audio Cable *1

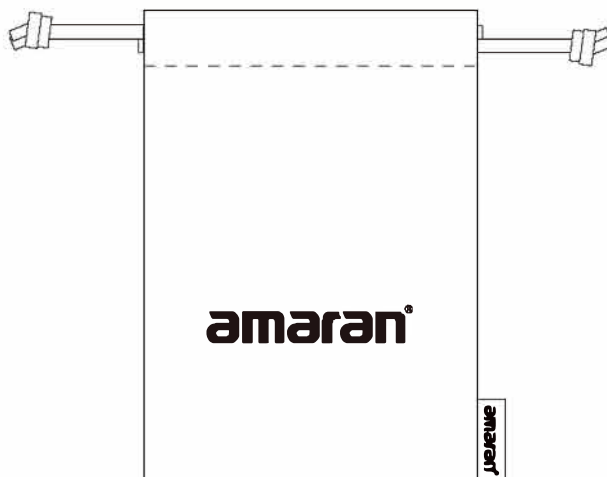

amaran Tag Carrying Pouch *1

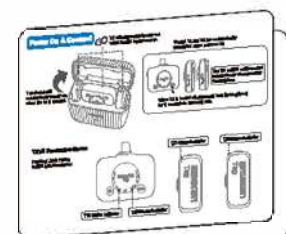

Quick Start Manual *1

Note: The illustrations in the manual are only diagrams for reference. Due to the continuous development of new versions of the product, if there are any differences between the product and the user manual diagrams, please refer to the product itself.

Product Overview

1. Receiver (RX)

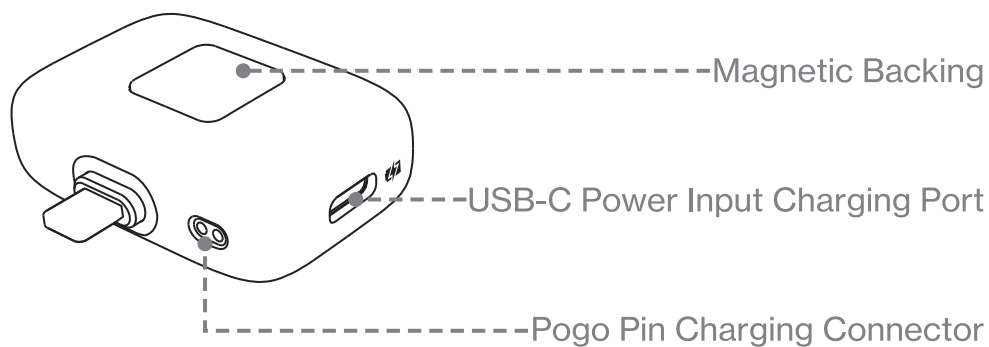
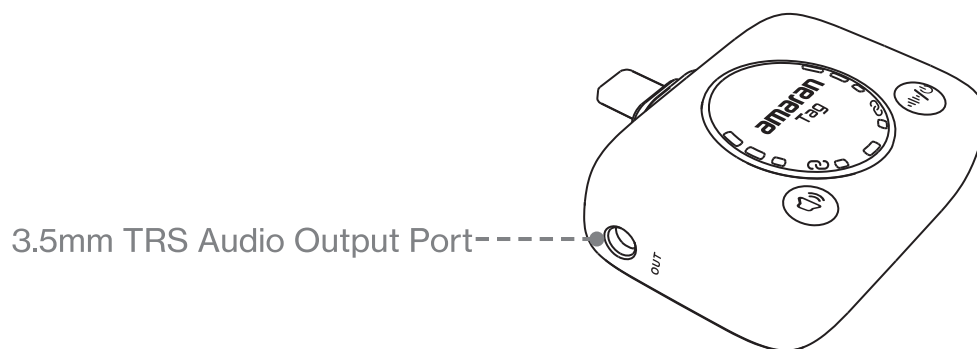
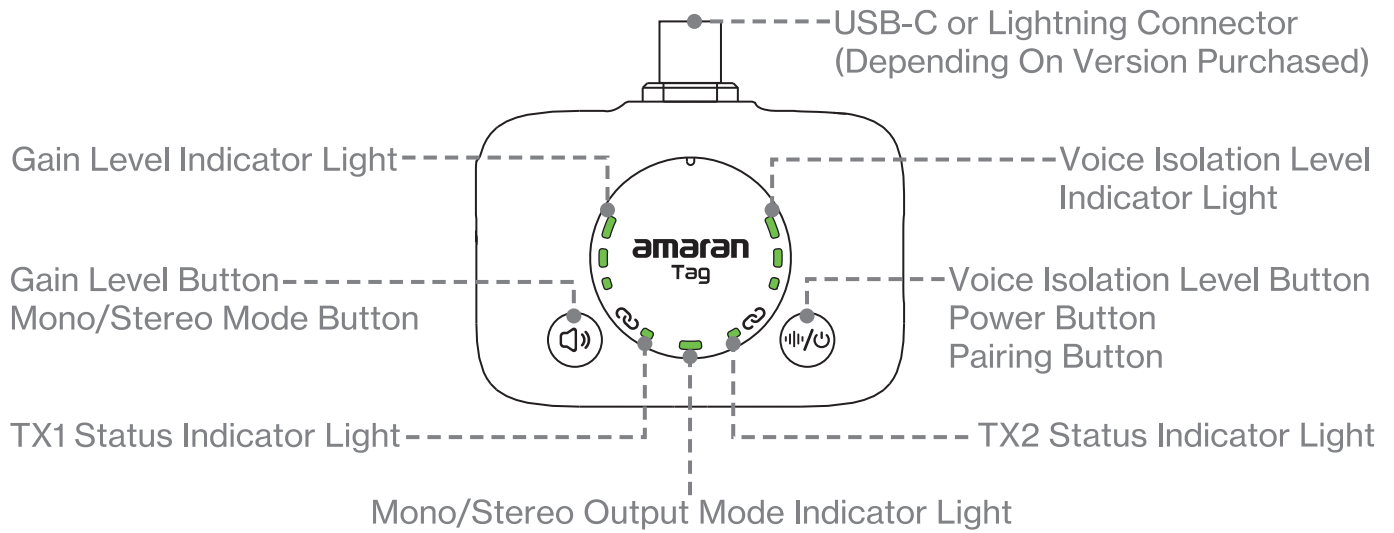

Receiver (RX) Description:

Gain Level / Output Mode Button

Click to adjust gain levels from 0-3 to control how loud the signal is. When all the gain indicator lights are off (0 Gain Level), the microphone is in silent mode and does not output sound.

Press and hold for 3 seconds to switch between Mono and Stereo recording modes.

- Mono Mode: Green Indicator Light
- Stereo Mode: Yellow Indicator Light

Voice Isolation Level / Power / Pairing Button

Click to adjust voice isolation levels from 0-3 to control how much background noise is filtered out. When all the voice isolation indicator lights are off (0 Voice Isolation Level), the microphone is in original sound mode and voice isolation is turned off.

Press and hold for 3 seconds to power the RX on/off. The RX will automatically pair with the TX when turned on.

When the RX is turned off, press and hold for 6 seconds to activate pairing mode.

2. Transmitter (TX)

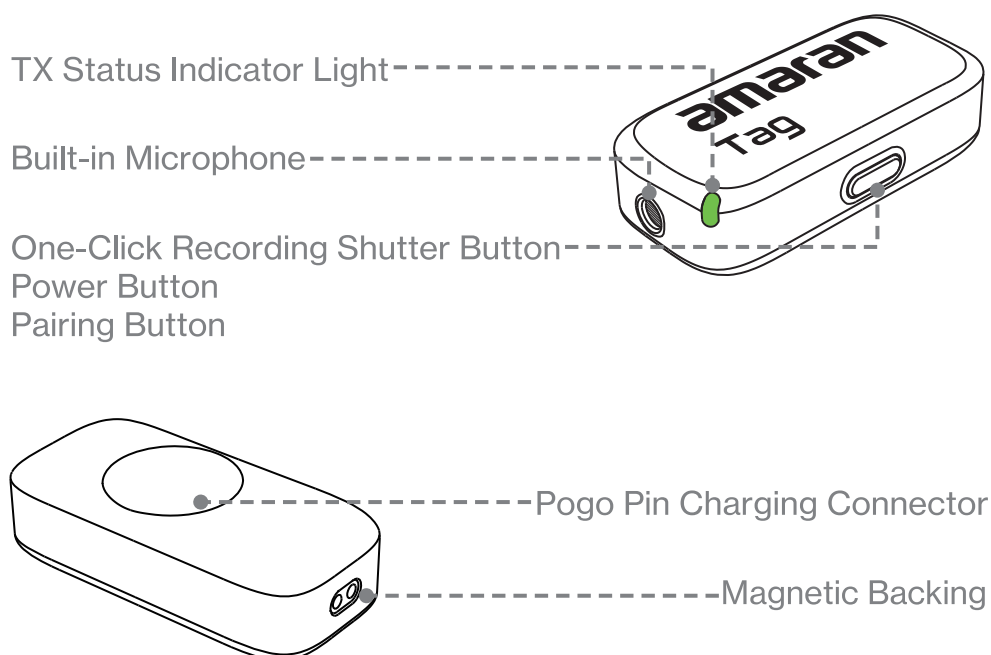

Transmitter (TX) Description:

One-Click Recording / Power / Pairing Button

Click to control the shutter of your phone or tablet. You can start and stop recording with a simple tap.

Press and hold for 3 seconds to power the TX on/off. The TX will automatically pair with the RX when turned on.

When the TX is turned off, press and hold for 6 seconds to activate pairing mode.

3. Charging Case

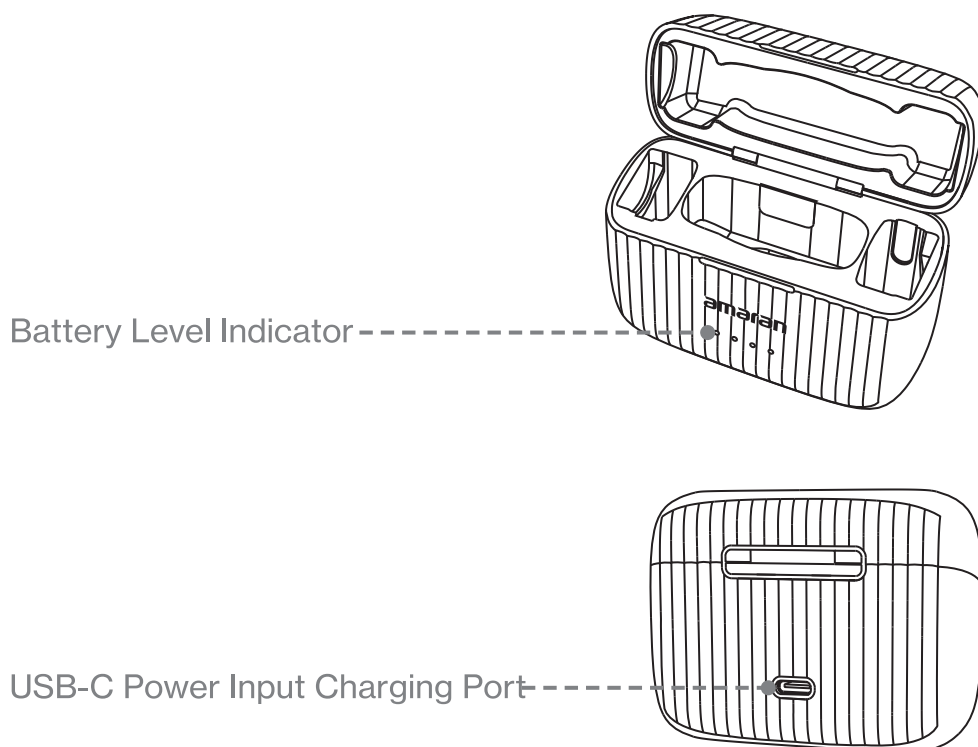

Charging Case Description:

The charging case can simultaneously charge the transmitters (TX) and receiver (RX), providing approximately 2 full cycles of charging.

When the charging case is opened, the transmitters and receiver will be automatically turned on. The TX and RX are automatically paired at the factory and are ready to be used out of the charging case.

When the charging case is closed, the transmitters and receiver will be automatically turned off. The TX and RX will continue charging with the case closed, and will stop when fully charged.

The lights at the front of the charging case indicate the battery level of the charging case. The USB-C charging port is located on the back of the charging case.

4. Magnetic Accessories

The transmitters have a built-in magnetic backing, allowing you to attach the transmitter to clothing via the included magnets or magnetic clip, or onto your camera's cold shoe mount via the magnetic clip.

Back Magnet

Place the magnet on the back of your clothing, and secure the TX on the front of your clothing with the magnet.

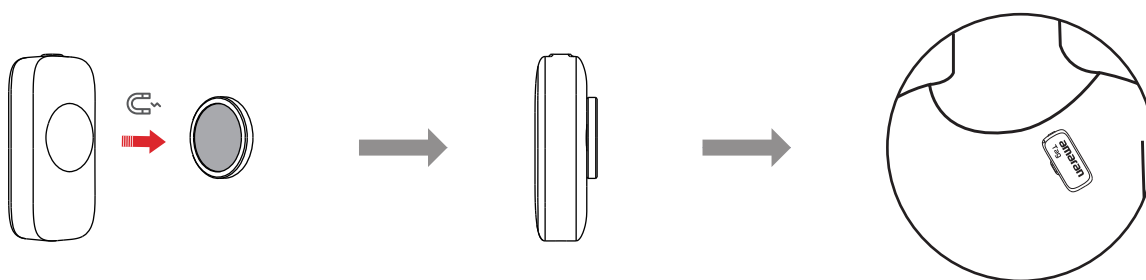

Magnetic Clip

Secure the magnetic clip onto the TX with the magnet and clip it onto your collar.

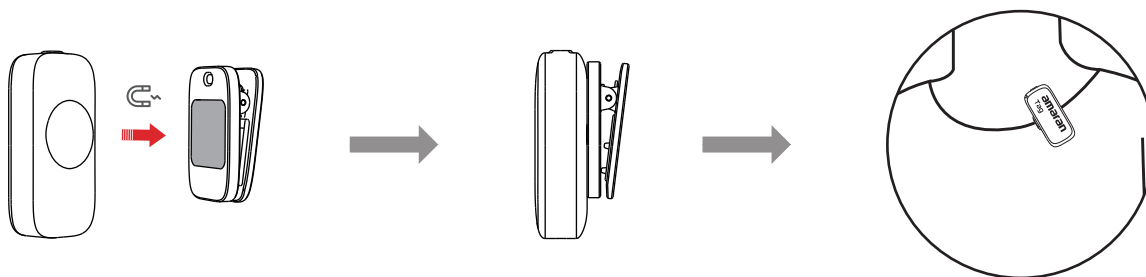

To attach the receiver onto a camera mount, secure the magnetic clip onto the RX and clamp the magnetic clip onto your camera's cold shoe mount.

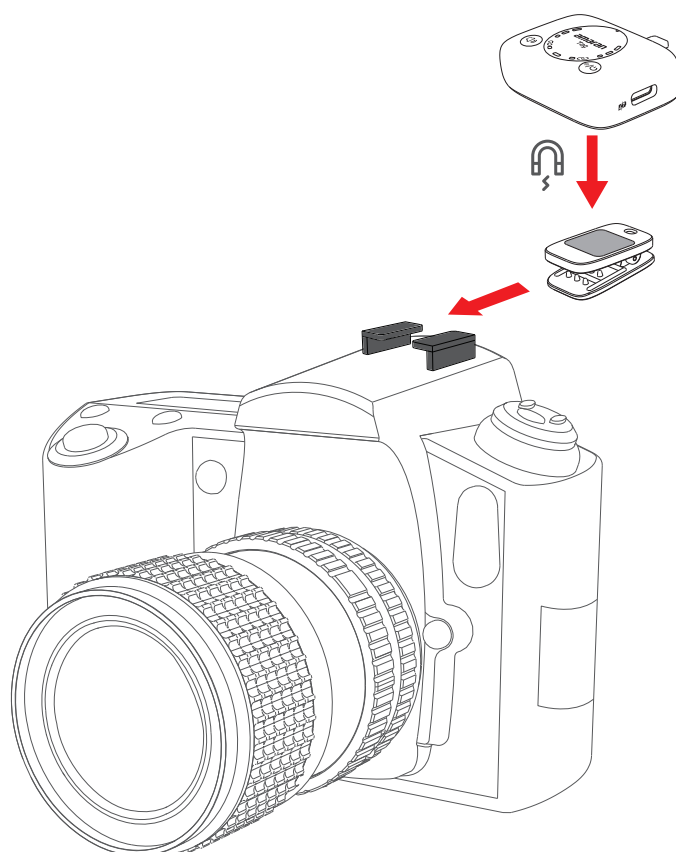

Indicator Light Description

| Transmitter (TX) | |
|---------------------|--|
| Slow Flashing Green | Not paired with receiver. The transmitter will search for the receiver for pairing, if not paired for 10 minutes, the transmitter will be turned off |
| Solid Green | Paired successfully with receiver |
| Solid Yellow | Paired successfully with receiver with voice isolation turned on |
| Slow Flashing Red | Low battery (below 10% battery) |
| Solid Red | Charging in progress. Indicator light will turn off when charging is complete |
| Off | Transmitter is powered off |
| Flashing Green | Pairing in progress |
| Flashing Yellow | Firmware update in progress |

Transmitter Status Indicator Light Priority: Pairing Status > Battery Status > Voice Isolation Status

| Receiver (RX) | |
|---|---|
| TX1/TX2 Status Indicator Light | |
| Slow Flashing Green | Not paired with transmitter. The transmitter will search for the receiver for pairing, if not paired for 10 minutes, the transmitter will be turned off |
| Solid Green | Paired successfully with transmitter |
| Flashing Green | Pairing in progress |
| RX Status / Output Mode Indicator Light | |
| Flashing Red | Low battery (below 10% battery) |
| Solid Red | Charging in progress. Indicator light will turn off when charging is complete |
| Off | Transmitter is powered off |
| Solid Green | Mono Recording Mode |
| Solid Yellow | Stereo Recording Mode |
| Flashing Yellow | Upgrading in progress |
| Gain Level Indicator Light | |
| Green | <p>The 3 gain level indicator lights will turn green sequentially as you adjust gain levels, first increasing from 0-3, then decreasing from 3-0.</p> <p>The default gain level is set to 1. When all the gain indicator lights are off, the microphone is in silent mode and does not output sound.</p> |
| Voice Isolation Level Indicator Light | |
| Green | <p>The 3 voice isolation level indicator lights will turn green sequentially as you adjust voice isolation levels, first increasing from 0-3, then decreasing from 3-0.</p> <p>When all the voice isolation indicator lights are off, the microphone is in original sound mode and voice isolation is turned off.</p> |

Charging Status / Output Mode Indicator Light Priority: Battery Status > Output Mode Status

| Charging Case | |
|-----------------------|---------------------------------|
| One Flashing Light | Low battery (below 10% battery) |
| Flashing Sequentially | Charging in progress |

The white indicator lights on the charging case will indicate the battery level of the charging case when the charging case is open. When the lid is closed, the battery indicator light will turn off after 1 second.

Operations

1. Power On / Off

Auto Power On / Off

When placed in the charging case, the transmitters and receiver will automatically turn on when the cover is open and automatically turn off when the cover is closed.

Manual Power On / Off

Press and hold the transmitter and receiver power buttons for 3 seconds to turn on and off.

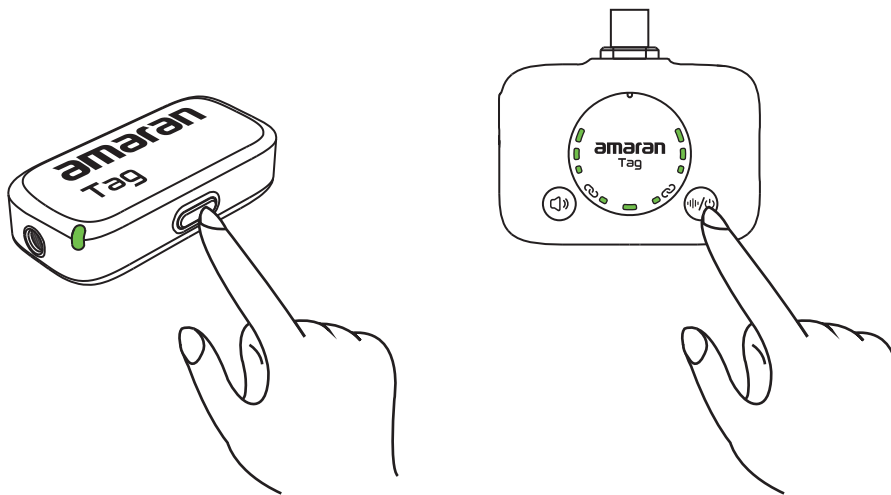

2. Pairing the Transmitters and Receiver

The transmitters and receiver are pre-paired at the factory and do not require manual pairing. They will be automatically paired when powered on for the first time.

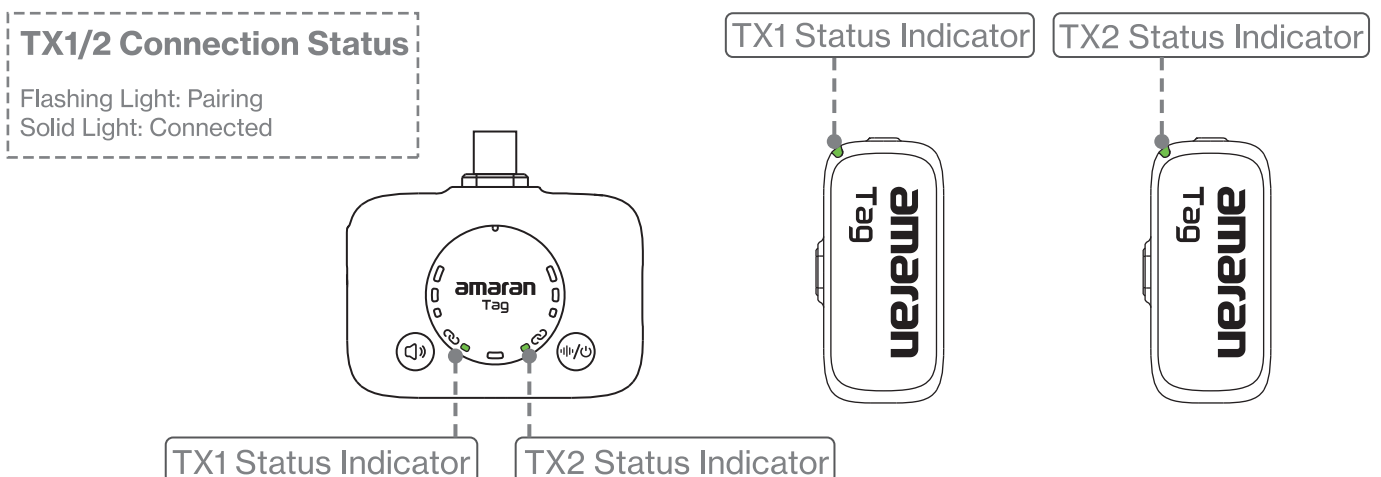

Manual Pairing

If the transmitters and receiver need to be reconnected, press and hold the pairing button for 6 seconds while the TX and RX are turned off to enter pairing mode.

*Paired TX and RX are automatically connected when powered on

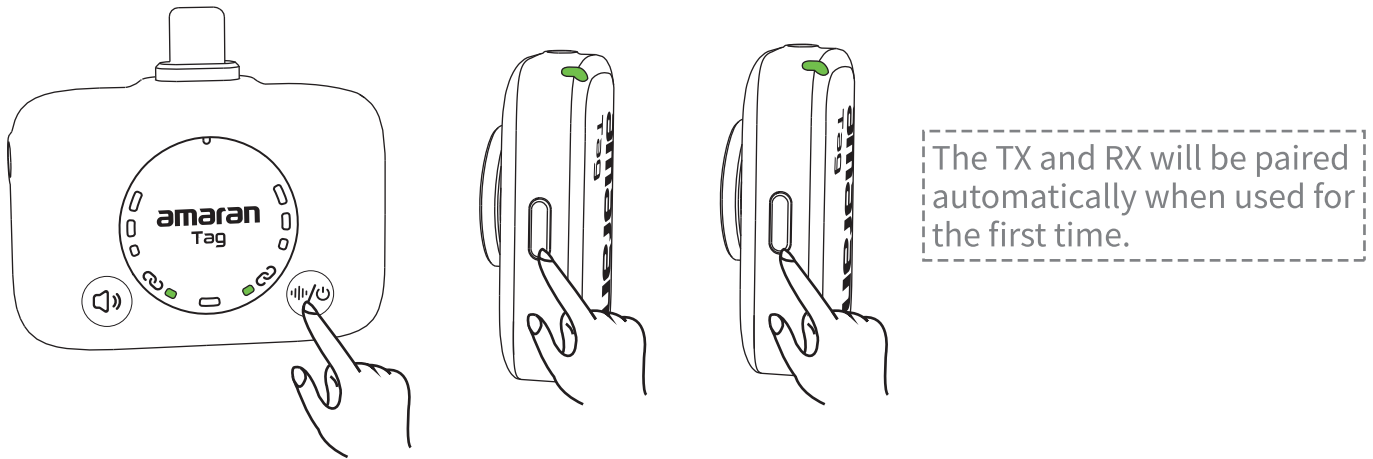

When TX is turned off, press and hold [pairing icon] for 6 seconds to manually pair.

3.Connecting the amaran Tag to Your Devices

3.1 Using with a Mobile Device or Tablet

To record and transmit audio to a mobile device or tablet, connect the receiver to your Lightning or USB-C compatible device. Attach the transmitter to your clothing or collar with the included magnets and magnetic clip, or use it handheld. Adjust the gain and voice isolation levels according to your recording environment and needs directly on the receiver, and start recording via the shutter button on the transmitter.

① Receiver (Lightning Connector)

Connected to Mobile Device

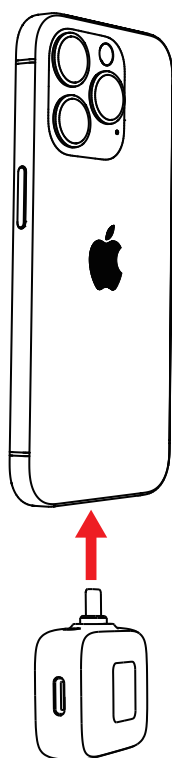

② Receiver (USB-C Connector)

Connected to Mobile Device

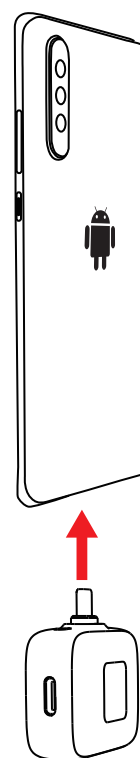

You can simultaneously record while charging your phone through the receiver, so you can record all day without worrying about running out of battery. Plug the included USB-C charging cable into the receiver while connected to your phone, providing up to 5V/2A power supply to your mobile device.

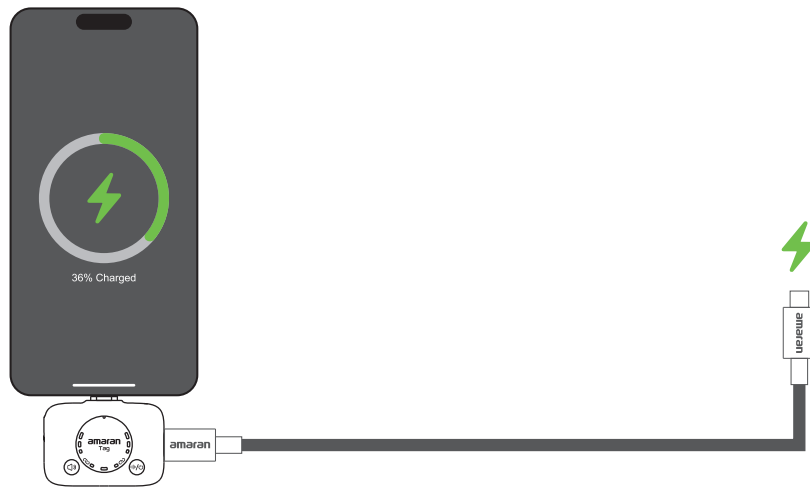

3.2 Using with a Camera

To record and transmit audio to a camera, attach the receiver onto your camera's hot shoe using the magnetic clip, and connect the receiver's 3.5mm audio output port to the camera's audio input port using the included 3.5mm TRS to TRS audio cable. Once the camera recognizes the external audio input signal, adjust the gain and voice isolation levels according to your recording environment and needs directly on the receiver, and begin recording.

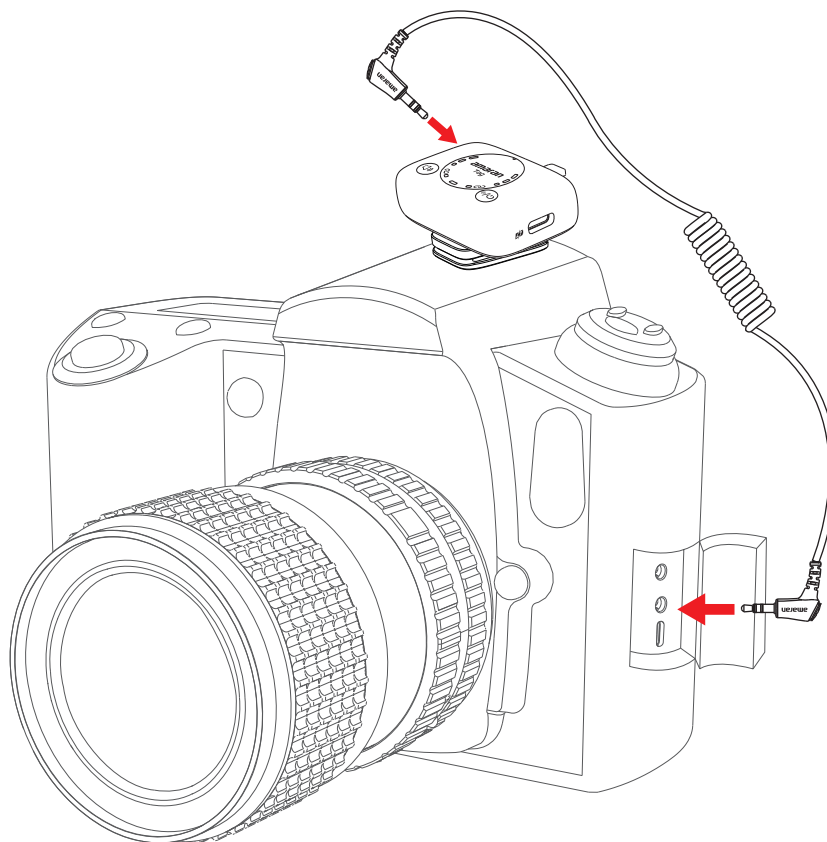

3.3 Using with a Computer (USB-C Version Only)

To record and transmit audio to a computer, connect the USB-C port of the receiver to the USB-C port of your computer. Once the computer recognizes the external audio input signal, adjust the gain and voice isolation levels according to your recording environment and needs directly on the receiver, and begin recording.

You can also record with a computer by connecting the receiver into your computer's 3.5mm audio input port with the included 3.5mm TRS to TRS audio cable, or sound card device.

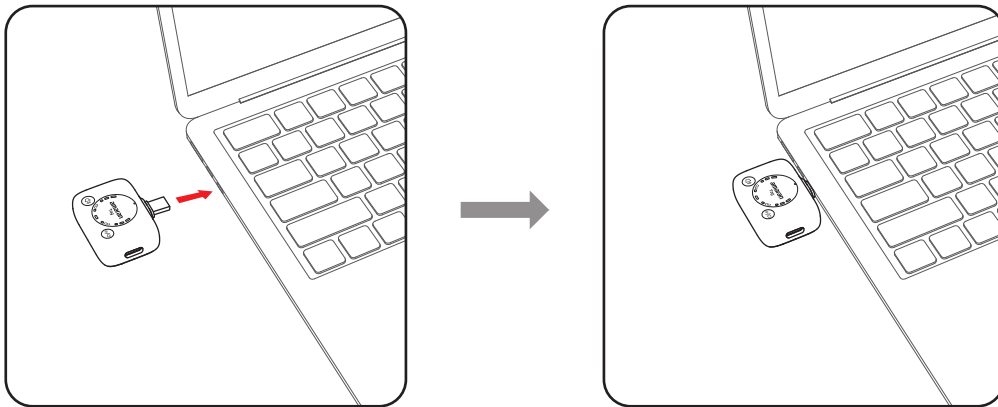

Plug the USB-C receiver directly into the USB-C port of your computer

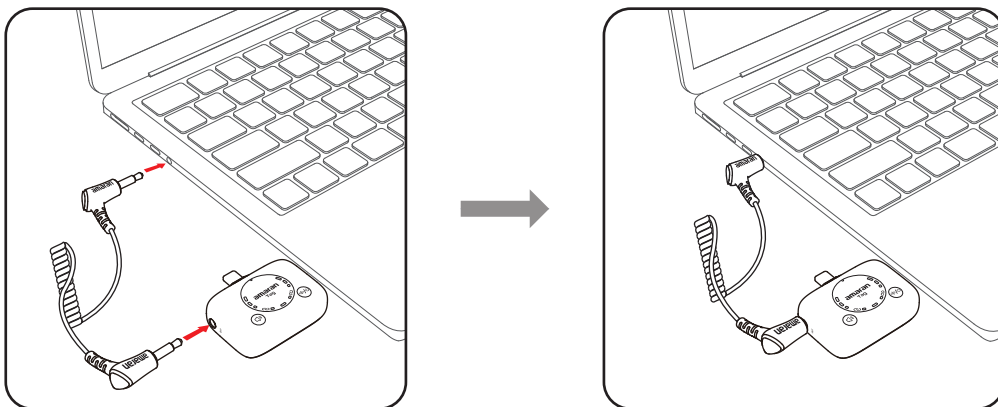

Connect your receiver to your computer's audio input port with the included 3.5mm TRS audio cable

4. Attaching the Transmitter

Attach the transmitter to your clothing via the included magnets or magnetic clip for a hands-free recording experience. Place the magnet on the back of your clothing, and secure the TX on the front of your clothing with the magnet. Or secure the magnetic clip onto the TX with the magnet and clip it onto your collar.

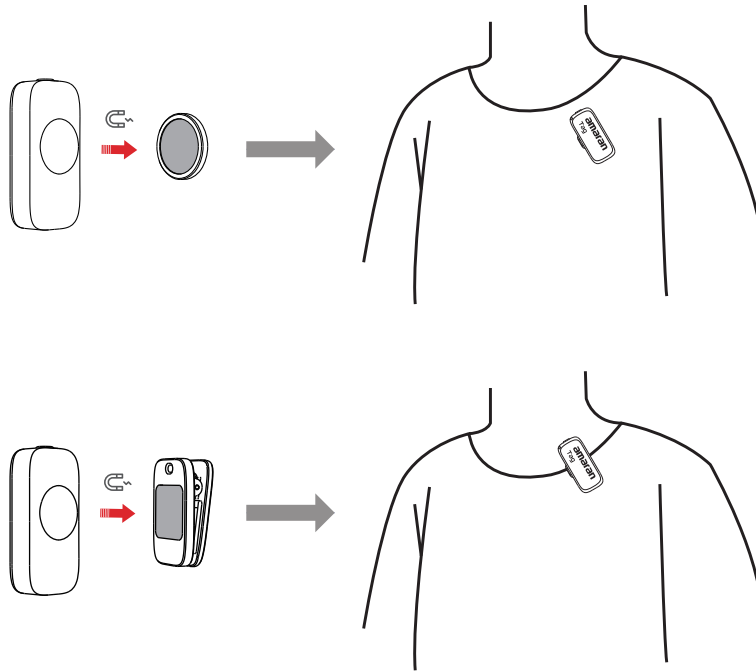

When recording in outdoor or windy environments, it is recommended to use a windscreen on your transmitter to minimize unwanted noise.

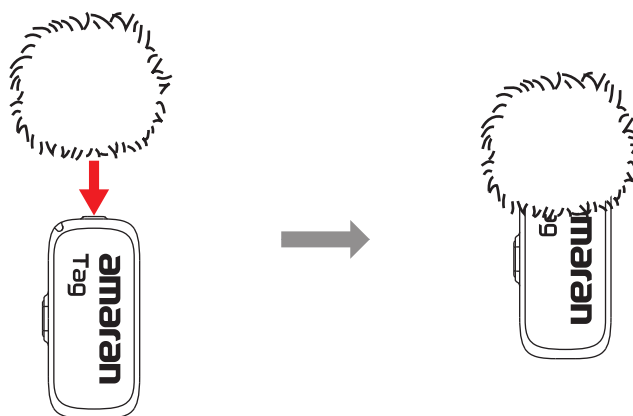

5. Adjusting Gain Levels

Click the gain level button on the receiver to control how loud the signal is from 0-3. The gain levels of the two transmitters are the same. The gain levels will adjust sequentially, first increasing from 0-3, then decreasing from 3-0. When all the gain indicator lights are off (0 Gain Level), the microphone is in silent mode and does not output sound.

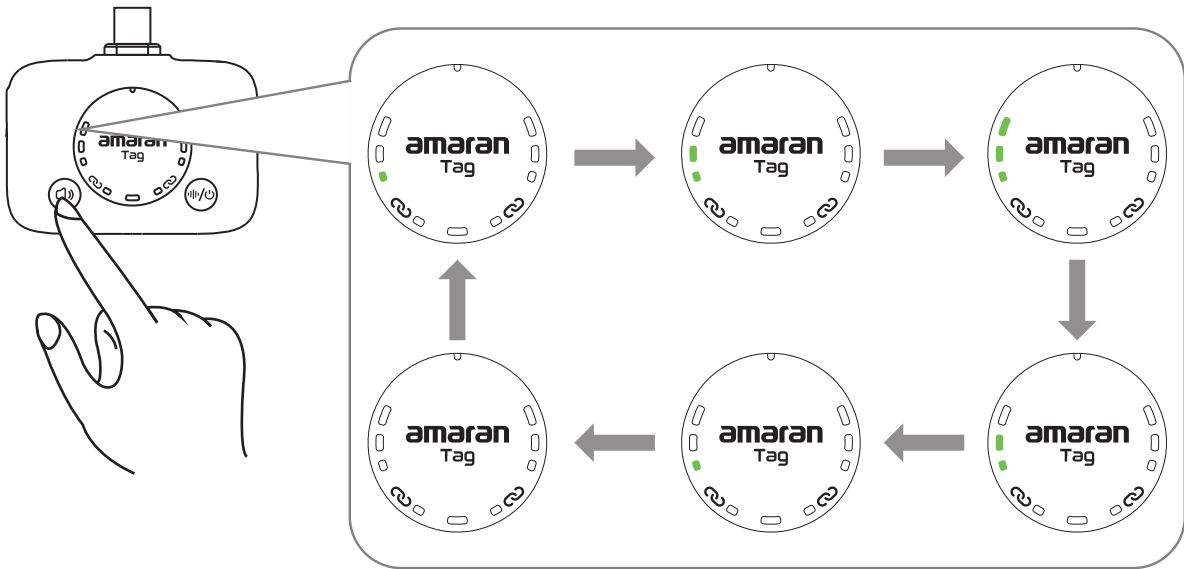

6. Adjusting Voice Isolation Levels

Click the voice isolation level button on the receiver to control how much background noise is filtered out from 0-3. The voice isolation levels of the two transmitters are the same. The voice isolation levels will adjust sequentially, first increasing from 0-3, then decreasing from 3-0. When all the voice isolation indicator lights are off (0 Voice Isolation Level), the microphone is in original sound mode and voice isolation is turned off.

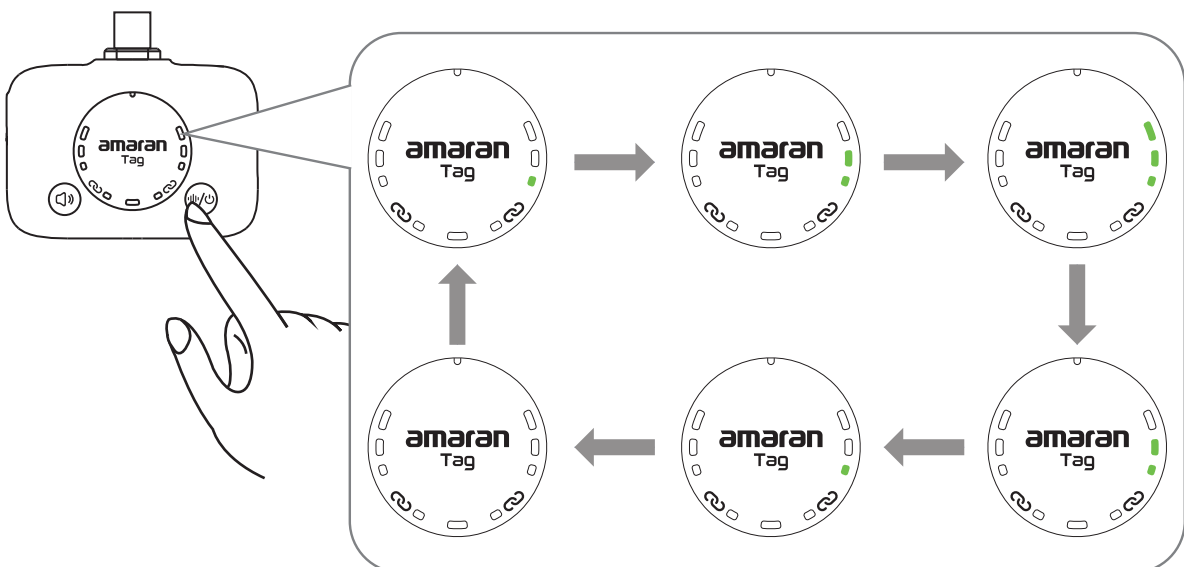

7. One-Click Recording With Shutter Button (Only Compatible with Mobile Devices and Tablets)

When the receiver is plugged into a mobile device or tablet, you can create instantly with a single click on the transmitter. Open the Camera app on your phone or tablet and click the shutter button to start or stop recording.



*The one-click recording feature can also be used on other camera apps that support using the volume buttons for shutter controls.

8. Charging the amaran Tag

When the transmitter or receiver status indicator light flashes red, the corresponding device's battery level is below 10% and needs to be charged. The transmitter or receiver will begin charging automatically once placed into the charging case.

The transmitters and receiver can also be charged directly via the included USB-C charging cable. The transmitter and receiver indicator lights will remain red when charging. When charging is completed, the transmitter status indicator will turn Green, and the receiver status indicator will turn off.

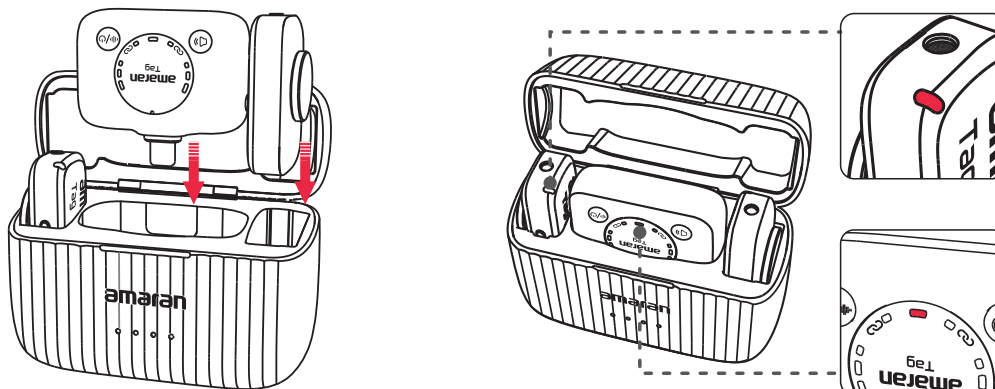

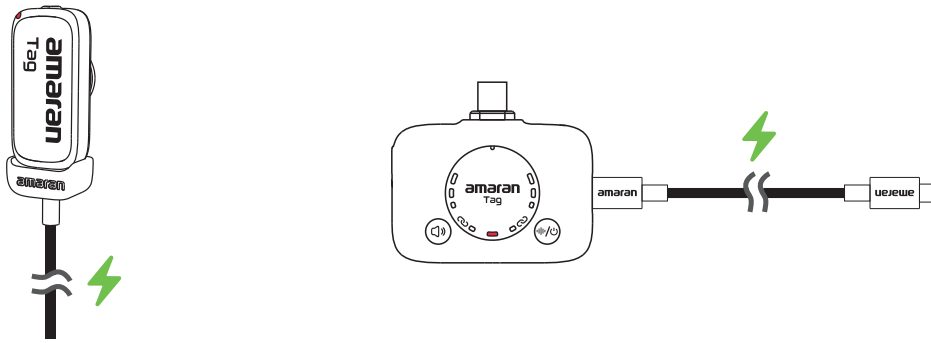

When the indicator light on the front of the charging case displays one flashing light, the battery level of the charging case is below 10% and needs to be charged. The charging case can be charged by connecting the included USB-C charging cable to the USB-C charging port on the back of the charging case. The indicator lights will slowly flash sequentially when charging.

9. Firmware Upgrade

Firmware updates can be updated via the amaran app. Connect the receiver to your phone or laptop, with the transmitter paired. Open the amaran app on your phone or laptop, and click on the Firmware Update function to upgrade the firmware.

Using the amaran App

You can download the amaran mobile app from the iOS App Store, Google Play Store, and other platforms for enhancing the functionality of the light. You can download the amaran desktop app from the amaran website. Please visit amarancreators.com for more details regarding how to use the app to control your amaran lights.



Scan the QR code to download the amaran app



amarancreators.com

Specifications

| | |
|---|---|
| Model | amaran Tag |
| Dimensions | Transmitter (TX): 4.15 x 2.0 x 1.15cm / 1.63 x 0.79 x 0.45in Receiver (RX): 4.65 x 4.15 x 1.75cm / 1.83 x 1.63 x 0.69in Charging case: 8.55 x 3.25 x 6.35cm / 3.37 x 1.28 x 2.5in |
| Weight | Transmitter (TX): 10.7g / 0.02lbs Receiver (RX): 24.3g / 0.05lbs Charging case: 108.3g / 0.24lbs |
| Battery Type | Li-ion |
| Battery Capacity | TX: 180mAh RX: 305mAh Charging case: 1900mAh |
| Battery Energy | TX: 0.639Wh RX: 1.129Wh Charging case: 7.03Wh |
| Operating Time | TX: 11h RX: 13.5h |
| Charging Case Recharges TX and RX Batteries | Charge two TX and one RX approximately twice simultaneously |
| Charging specifications of the Charging case | 5V 2A, 5V 1.5A |
| Charging method | TX: Pogo pin RX: Pogo pin/USB-C Charging case: USB-C |

| | |
|-------------------------------------|---|
| Charging Time | TX: 2.2h RX: 2.2h Charging case: 2.1h |
| Wireless type | 2.4GHz adaptive frequency modulation |
| Wireless Range | 45m (Back-to-body transmission) 300m (Visual distance) |
| Delay | 24ms |
| Transmission power | 10dBm |
| Frequency Range | 20-20kHz |
| Sampling Rate | 48kHz |
| Sampling Depth | 24bit |
| Maximum Sound Pressure Level | 121dB SPL |
| Microphone Sensitivity | -35±3dB@1Khz,94dB SPL |
| Signal-to-Noise Ratio | Analog output :>80dB Digital output :>90dB |
| Total Harmonic Distortion | <0.5% at 1kHz |
| Directivity | Omnidirectional |
| Microphone Head Size | 4mm |
| Output | Analog output Digital output |
| Gain | 3+1 gears (silent mode when the indicator light is completely off) |
| Noise Reduction | 3+1 gears (when the indicator light is completely off, the noise reduction is turned off, which is the original sound mode) |
| Real-time Monitoring | RX support |

| | |
|------------------------------|-----------------------|
| Shutter Control | TX support |
| Operating Temperature | -20~45°C |
| Charging Temperature | 0~45°C |
| Upgrade method | amaran App |
| APP control | amaran App |
| Wearing Method | Magnet, Magnetic Clip |

Important Safety Instructions

When using the amaran Tag, basic safety precautions should always be followed, including the following:

1. Read and understand all instructions before using.
2. Keep this product manual. Always include this product manual when passing the product onto third parties.
3. Heed all warnings and follow all instructions in this product manual.
4. Do not place the product near corrosive chemicals in order to protect the product from corrosion, which may cause it to malfunction.
5. Operate carefully - dropping or hitting the product may cause damage.
6. Keep all liquids away from the product. Liquids entering the product can short-circuit the electronics or damage the mechanics.
7. Store the product in a dry, clean, dust-free environment.
8. Do not allow children to come into contact with this product to avoid accidents.
9. Please have the product checked by an authorized service personnel agent if the product has a problem. Any malfunctions caused by unauthorized disassembly are not covered by the warranty. The user may pay for maintenance.
10. We recommend only using the original amaran cable accessories. The charging head should use a 5V/2A or 5V/1.5A charging head.
11. Machine damage caused by improper use and operation is not covered by the warranty. The user may pay for maintenance.
12. The instructions and information in this manual are based on thorough, controlled company testing procedures. This user guide is developed based on strict testing conducted by our company. Design and specifications are subject to change without prior notice.
13. The illustrations in this manual are for reference only. Due to ongoing new product development, if there are any discrepancies between this product and the illustrations in the user manual, please refer to the product itself.

FCC Compliance Statement

WARNING

Changes or modifications not expressly approved by the party responsible for compliance could void the user's authority to operate the equipment.

NOTICE

This equipment has been tested and found to comply with the limits for a Class B digital device, pursuant to Part 15 of the FCC Rules. These limits are designed to provide reasonable protection against harmful interference in a residential installation. This equipment generates, uses, and can radiate radio frequency energy and, if not installed and used in accordance with the instructions, may cause harmful interference to radio communications. However, there is no guarantee that interference will not occur in a particular installation.

If this equipment does cause harmful interference to radio or television reception, which can be determined by turning the equipment off and on, the user is encouraged to try reorient or relocate the receiving antenna.

- Increase the separation between the equipment and receiver.
- Connect the equipment to an outlet on a different circuit than the receiver is connected to.
- Consult the dealer or an experienced radio/TV technician for help.

RF Warning Statement

The device has been evaluated to meet general RF exposure requirement.

The device can be used in portable exposure condition without restriction.

Disclaimer

Before using this product, please read the product manual to ensure correct use under the complete understanding. After reading, please keep the product manual properly for future reference. In case of not operating this product correctly, it may seriously harm yourself or others, or result in product damage and property loss. When using this product, it shall be deemed that you have understood, recognized and accepted all clauses and contents of this document. The user commits to be responsible for their own behaviors and all consequences thereof. amaran shall not be liable for any loss due to the user who does not use this product in accordance with the product manual.

Under the laws and regulations, our company holds the final explanation right of this document and all related documents of this product. No prior notice will be given for any update, revision or termination. Please visit the official amaran website for the latest product information.