

WATERPROOF BLUETOOTH HEADSET WITH MICROPHONE

This product in waterproof construction design with quality stereo headset can enrich and upgrade your lifestyle, enjoy your favor music at anywhere anytime. Its Bluetooth wireless system can be able to pair with your devices (such as tablets, notebooks, smartphone) easily. Also, built-in microphone can let you talk over the phone while sporting.

Waterproof performance:
The waterproof level of this product complies with IP46 standards, is designed to ensure normal operation in water at a specified conditions and dustproof. It cannot be immersed in water. Design is for powerful water jets only.

Product Description:

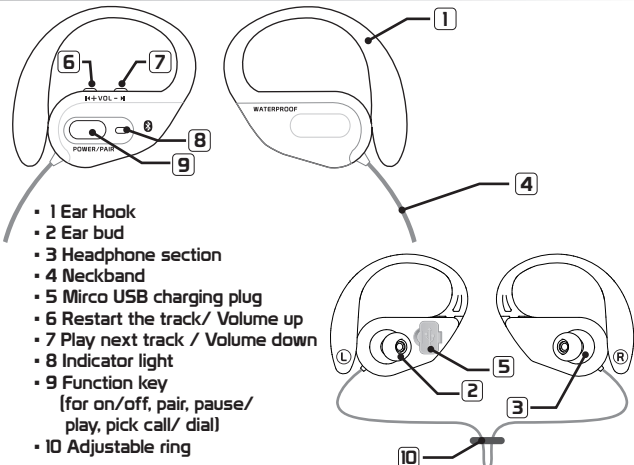

Before using this unit:

Please ensure that the  watertight cap of the mirco USB plug is completed closed before using this unit. Trouble attribute to water seeping into the unit from to loosely closed watertight cap are not covered by the warranty. Water droplets that enter the headphone or microphone holes do not cause troubles. However, the product performance may temporarily decrease until the water droplets are dried. Problems may include unclear sound and difficulties in getting your voice clearly. If such circumstances exist, please remove water droplets and dry the product.

Product Specifications:

Bluetooth version	Bluetooth V4.0 +EDR A2DP and AVRCP
Operating range (maximum)	10 m (The transmission distance changed depending on the environment where the product is used.
Headset Impedance / Output:	32Ω 0.02mm, dia. 10mm x 2
Power supply	Built in Li-Polymer
Battery Capacity	3.7V / 80mAh
Current consumption:	<10uA
Continuous standby time:	180 Hours
Continuous transmission time:	8 hours
Continuous talking time: #	5 hours
#The actual continuous standby/transmission times may become shorter than those in the specifications depending on the environment or conditions for keeping/using the unit, etc.	
#Batteries are consumables. The battery service time gradually decreases after the charging and discharging cycles, even if the batteries are used properly.	
#The battery performance deteriorates quickly if the unit is kept under high temperature conditions. Please keep the unit in a cool, well-ventilated location, away from direct sunlight.	
Operating Temperature:	0 °C to – 40 °C
Operating humidity range:	20-80% (no condensation)
Product size:	55(W) x 52(H) x 30(D)mm (for single)
Weight:	23g
Waterproof performance:	IP46
Number of devices that can be registered	8

How to place the headset on your ears:

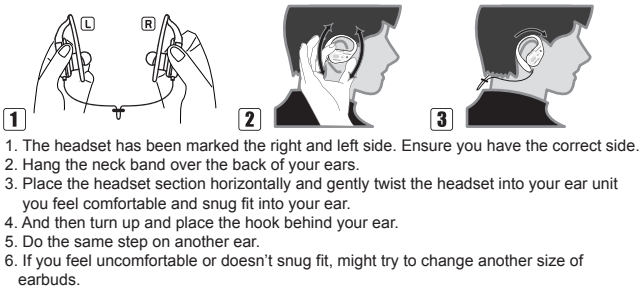

How to install the earbuds:

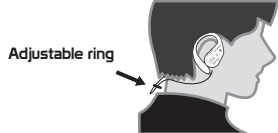
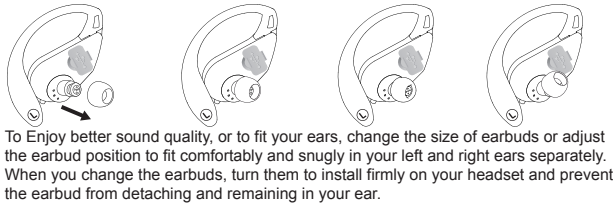

To prevent headset taking off your ears:
By using provided adjustable ring to the neckband part before placing headset on your ears.

This device complies with Part 15 of the FCC Rules. Operation is subject to the following two conditions: (1) this device may not cause harmful interference, and (2) this device must accept any interference received, including interference that may cause undesired operation

Bluetooth™ INSTRUCTION MANUAL

Charging the battery:

- Charging the headset by USB charging cable (included in the package)
- The LED lamp is lit red while the battery is charged.
- The LED lamp is lit blue when the battery is fully charged.
- It takes around 25 minutes to fully charge the battery
- 1. Connect the USB charging cable to the unit
- 2. Connect the USB charging cable to your PC
- * when the battery power is used up, a beeping alarm will sound, with the LED lamp blinking red. After a while, product will turn off
- * It is not possible to use the product during charging.

Pairing the product with your device at the first time:

1. Hold "Function key" for around 7 seconds, a signal will sound "Do re mi fa so" keep pressing until red & blue light are flashing, means it is ready to be paired.
 2. At this first time to pair, use your device to search the product model "#Bluetooth-Headset#".
 3. When your device searches the product model, press to connect, your device will show if it is successfully connected or not.
 4. If it is successfully connected, you can play music through the product.
- Noted: Terminate any connection between the product and any device before starting the pairing procedure. The pairing procedure cannot be started while a Bluetooth connection is established between the product and a registered device. Terminate the connection and turn off the product.

Up to eight Bluetooth device can be registered:

When nine or more devices are registered, the previously registered devices will be deleted starting from the oldest, to register new ones. A device that is registered twice or more is identified as one device.

Play music:

- Hold "+" to increase the volume. (when up to maximum, it will have 'Beep~' sound)
- Hold "-" to decrease the volume. (when up to minimum, it will have 'Beep ~' sound)
- Press "+" to restart the current track. Press twice to play previous track.
- Press "-" to play next track.
- Press "Function key" to pause/ play the track.

Part 1: pick up call

1. Press "Function key" to pick up the call.
2. Hold "+" to increase the volume. (when up to maximum, it will have 'Beep~' sound)
3. Hold "-" to decrease the volume. (when up to minimum, it will have 'Beep ~' sound)
4. Press "+" & "-" once to have mute function, press "+" & "-" once again back to normal
5. Please "Function key" to hang up.

**Note: To avoid / reduce echo, please do not turn the speaker to maximum volume.

Part 2: Make a call

1. Press "Function key" 2 times quickly to redial the latest call you make.
2. Some smartphones have voice command, hold "Function key" once to enter voice command function with your smartphone. For detail, please refer your smartphone instruction. This performance is different depending on your smartphone setting.
3. Press "Function key" to hang up.

Part 3: Pick up another incoming call

1. Hold "Function key" to reject the call.
2. Press "Function key" once again to continuously playing the song.

Initializing the registration history / resetting the hardware of product:

Under the Off mode, hold "Function key" & + together until it sound a signal with red light.

Caution:

- **Please take full precautions when setting the ringtone volume.**
When this product is paired with a mobile phone, a loud ringtone may give you a shock, which in turn may result in an accident or a heart attack, Gradually increase the volume from the minimum to set it appropriately.
- **Do not damage cables that are connected to this product.**
Fire and disconnection will result.
- **Never leave this product in a car.**
Leaving this product in a hot car cabin for many hours will result in rupture of the built-in battery, sparking, and other troubles, posing significant danger.
- **Do not leave this product under high temperature conditions.**
This product is a precision electronic device. Avoid using/ keeping this product in a location that is subject to high temperature, high humidity or direct sunlight for many hours. When subject to significant temperature changes in the environment, this product may malfunction due to condensation inside the product.
- **Do not touch the metal parts of this product such as the power supply connectors and the charging cable's connector terminals.**
Static electricity or fouling may cause a malfunction or electric shock.
- **Do not disassemble this product.**
Do not repair, modify or disassemble this product on your own, unless operational instructions to the contrary are given in this user's manual, Electric shock, fire, or burns may result.
- **Make sure to close the watertight cap when using this product in a wet or damp environment.**
Make sure to remove any dust, hair, etc., that is present between the watertight cap and the main unit.
- **Follow the user's manual instructions of devices (ex. iPhones and mobile phones) to be connected to this product.**
This product can be wirelessly connected to iPhones, mobile phones, etc. The setting procedures and precautions are different depending on the devices to be connected to this product. Care fully ready the user's manual for these devices and observe any precautions.
- **Do not use/keep this product in a wet or damp environment for a long time if you do not use it.**
Any liquid entering this product may result in troubles, fire, or electric shock.
- **Do not keep this product within reach of small children.**
Unexpected accidents (ex. accidental ingestion) may result.
- **This product is a precision electronic device. Avoid using/keeping this product in an environment that is subject to impact/vibration, strong magnetic forces, static electricity, etc.**
- **Risk of explosion if battery is replaced by an incorrect type. Dispose of used batteries according to the instructions.**

FCC Requirement

Warning: Changes or modifications to this unit not expressly approved by the party responsible for compliance could void the user authority to operate the equipment.

NOTE: This equipment has been tested and found to comply with the limits for a Class B digital device, pursuant to Part 15 of the FCC Rules. These limits are designed to provide reasonable protection against harmful interference in a residential installation. This equipment generates, uses and can radiate radio frequency energy and, if not installed and used in accordance with the instructions, may cause harmful interference to radio communications.

However, there is no guarantee that interference will not occur in a particular installation. If this equipment does cause harmful interference to radio or television reception, which can be determined by turning the equipment off and on, the user is encouraged to try to correct the interference by one or more of the following measures:

- Reorient or relocate the receiving antenna.
- Increase the separation between the equipment and receiver.
- Connect the equipment into an outlet on a circuit different from that to which the receiver is connected.
- Consult the dealer or an experienced radio/TV technician for help.