



Simeon Audita

Portable
Soundfield System



User Manual

Notice:

The changes or modifications not expressly approved by the party responsible for compliance could void the user's authority to operate the equipment.

IMPORTANT NOTE:

To comply with the FCC RF exposure compliance requirements, no change to the antenna or the device is permitted. Any change to the antenna or the device could result in the device exceeding the RF exposure requirements and void user's authority to operate the device.

This device complies with part 15 of the FCC Rules. Operation is subject to the following two conditions: (1) This device may not cause harmful interference, and (2) this device must accept any interference received, including interference that may cause undesired operation.

FCC INFORMATION

The Federal Communication Commission Radio Frequency Interference Statement includes the following paragraph:

The equipment has been tested and found to comply with the limits for a Class B Digital Device, pursuant to part 15 of the FCC Rules. These limits are designed to provide reasonable protection against harmful interference in a residential installation. This equipment generates, uses and can radiate radio frequency energy and, if not installed and used in accordance with the instruction, may cause harmful interference to radio communication. However, there is no grantee that interference will not occur in a particular installation. If this equipment does cause harmful interference to radio or television reception, which can be determined by turning the equipment off and on, the user is encouraged to try to correct the interference by one or more of the following measures:

- Reorient or relocate the receiving antenna.
- Increase the separation between the equipment and receiver.
- Connect the equipment into an outlet on a circuit different from that to which the receiver is connected.
- Consult the dealer or an experienced radio/TV technician for help.

The user should not modify or change this equipment without written approval from Supportive Hearing Systems Inc. Modification could void authority to use this equipment.

Simeon Audita

Portable Soundfield System

Your new Simeon Audita portable soundfield system provides convenient and portable amplification with a choice of dual FM or digital transmitter formats. The system can be set up in any classroom or meeting room and is easy to transport. It also interfaces simply with a Simeon OmniPanel setup, giving the portable system the power of a permanent installation. The system includes:

- A Simeon Audita Portable Soundfield Receiver (with Power Adapter)
- A Simeon 623 directional boom microphone (or optional alternate microphone model)
- A Simeon 602 Transmitter Charging Cradle (with Power Cable)
- Transmitter Belt Clip and Lanyard
- Rechargeable Batteries

The Simeon Audita FM System includes the following components:

- A Simeon FM Dual-Receiver Module (built into the Receiver)
- A Simeon 5T Pendant FM Transmitter
- An OPTIONAL Simeon 5M Handheld FM Transmitter
OR
A second Simeon 5T FM Pendant Transmitter

The Simeon Audita Digital System includes the following components:

- A Simeon Digital Dual-Receiver Module (built into the Receiver)
- A Simeon 6T Pendant Digital Transmitter
- An OPTIONAL Simeon 6M Handheld Digital Transmitter
OR
A second Simeon 6T Digital Pendant Transmitter

Optional Accessories:

- Folding Tripod for the Simeon Audita
- Wall-mounting bracket for the Simeon Audita
- Tote bag for the Simeon Audita
- Connector cables for peripheral audio devices
- A Simeon Omnipanel 900 Flat Panel Loudspeaker (with Speakon Cable)
- Folding Tripod for the Omnipanel

Simeon Audita Portable Soundfield Receiver

Figures 1 & 2

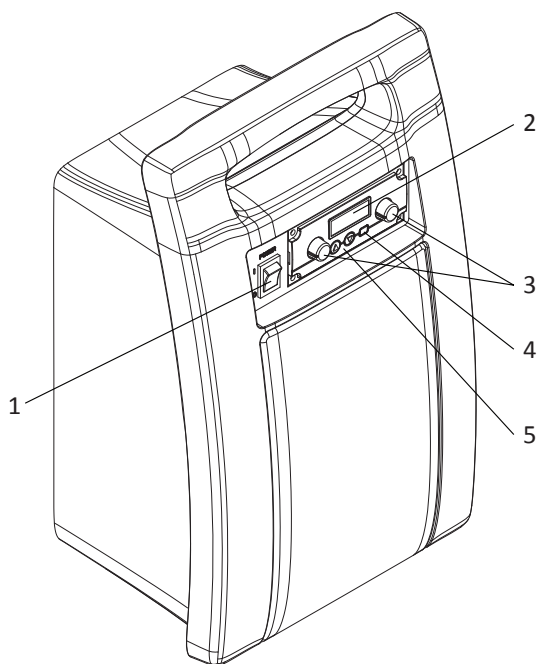

1. Power ON/OFF switch with power indicator
2. Display Screen
3. Volume Control
4. Set Button
5. Cursors
6. Power adapter plug (20V)
7. Speaker Output
8. Speaker Switch
9. Auxiliary RCA Input with gain control
10. Voice Priority Button
11. Wall mount keyhole
12. Tone Control
13. AUX Out Gain
14. AUX Out Equalizer
15. Battery Housing
16. Battery Status Indicator

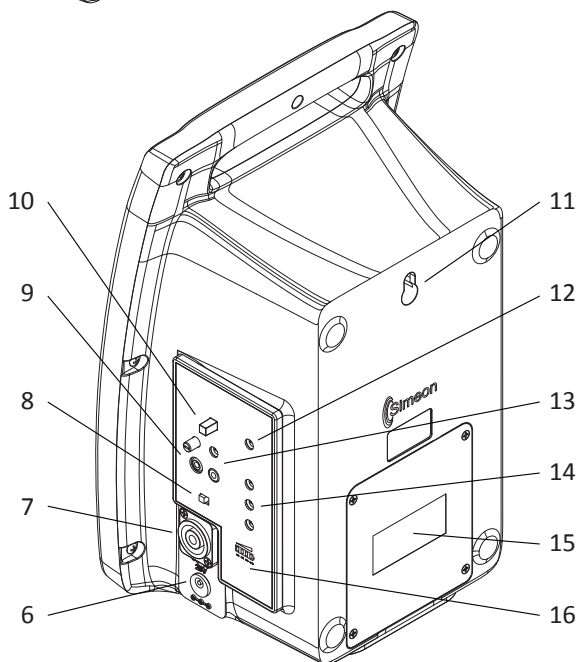

Setup

Carefully unpack the soundfield system and separate its components.

Simeon Audita Portable Soundfield Receiver

Your Simeon Audita System includes either a dual-digital and a dual-FM receiver module, to be used with the corresponding Simeon transmitters. It also includes an integrated speaker, and multiple inputs and outputs. It is at the core of the entire sound system.

It is recommended that you charge the receiver fully before its initial use. Identify the correct power adapter for the receiver. **Caution: never use non-standard power adapters to charge your system.** Plug in the receiver to charge the battery [6]. Make sure the receiver is OFF while it is charging [1]. It takes about 10 hours for the receiver to charge. The battery status indicator [15] will scroll through its coloured lights during charging. A continuous green light indicates when charging is complete.

The transmitter and Receiver channels on both the Audita Digital and Audita FM Systems will have been assigned before shipping. It will only be necessary to change the channels if the preassigned channels conflict with other FM or Digital systems in your facility.

OPTIONAL Omnipanel 900 Flat Panel Loudspeaker

The optional Omnipanel 900 gives great acoustic performance and outstanding speech intelligibility in a small, efficient format. The flat panel speaker can be mounted almost anywhere, and be easily connected to the system when you need the additional performance of an installed system..

The Omnipanel 900 can either be set up on a tripod floor stand or it can be wall mounted. Simply slot the Speaker Mount [19] onto the top of either the Floor Stand or the Wall Mount after they are in place. Tighten the Fastening Knob [20] to ensure the safety of the Omnipanel. Make sure not to over-fasten the knob, as this may cause damage to the Floor Stand or the Wall Mount. Use only the included Speakon cables to connect the Omnipanel to the receiver. Connect the cable into back of the Omnipanel [17] and rotate it to the right to lock it in place. Do the same on the side of the receiver [7]. Move the Speaker Switch [8] to the “**External Speaker**” setting to transfer sound from the internal speaker to the Omnipanel. To unplug the cables pull down on the Speakon “Quick Lock,” rotate the cable to the left and disconnect it. Be sure to move the Speaker Switch back to the “**Internal Speaker**” setting when you no longer want to output sound through the Omnipanel.

Simeon Omnipanel 900 Flat Panel Loudspeaker

Figures 3 & 4

- 17. Speaker Panel
- 18. Exciters (Piezoelectric Drive Elements)
- 19. Receiver Input
- 20. Fastening Knob
- 21. Mount

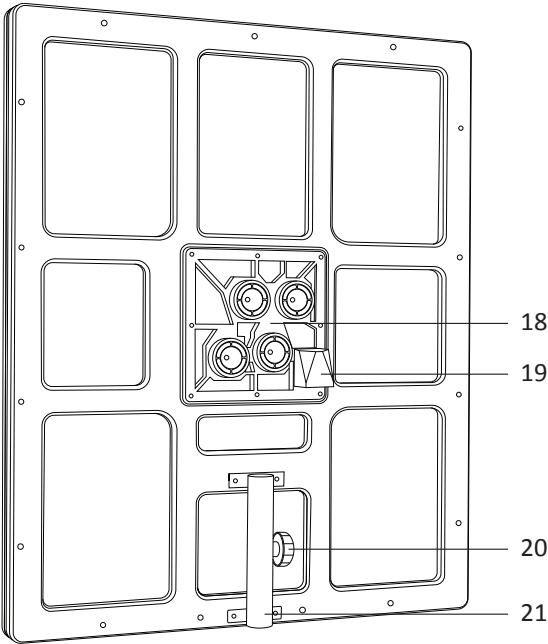
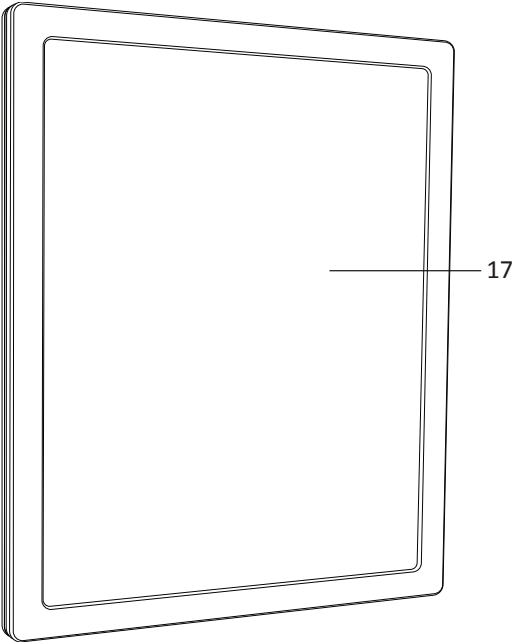

Simeon 5T and 6T Pendant Transmitter

The Simeon 5T Transmitter has 96 channels available over an UHF frequency band to allow for the best possible sound quality and performance. The Simeon 6T Transmitter offers 16 high definition digital audio channels, each with two positions (A & B) that allow for easy setup of two transmitters side by side, and can be used in any country. Your transmitter can be interfaced with a boom (headset) mic, as well as other audio inputs. They can either be used hand-held, or worn around the neck or at the waist in conjunction with a boom (headset) mic. It is recommended that you charge the transmitter fully before its initial use. It is possible to adjust your transmitter microphone sensitivity to accommodate non-standard microphones and other special requirements. If you need to change the microphone sensitivity please contact your point of sale for advice.

The Simeon 5T and 6T come with high capacity rechargeable batteries preinstalled. They should be charged with the Simeon 602 Charging Cradle.

Simeon 5M and 6M Hand-held Transmitter/Microphone

The Simeon 5M and 6M are hand held pass-around microphones.

Open the transmitter battery compartment [42] and insert two NiMH batteries (supplied), taking care to observe the correct battery polarity. **Never use disposable (alkaline) batteries in combination with the charging system.** It is recommended that you charge the transmitter fully before its initial use. The Simeon 5M and 610TM should be charged with the Simeon 602. Inside the Simeon 6M battery compartment there is a Main (M) and Secondary (S) mode switch. In normal operation, this switch should be in the M position. For additional control over the hand-held microphone from the pendant transmitter, the switch can be put in the S position. It is possible to adjust your transmitter microphone sensitivity to accommodate non-standard microphones and other special requirements. If you need to change the microphone sensitivity please contact your point of sale for advice.

Simeon 602 Transmitter Charging Cradle

The Simeon 602 Transmitter Charging Cradle allows for the easy simultaneous charging of any two Simeon 5T, 6T, 5M, or 6M Transmitters, in any combination.

Identify the correct power cable for the charging cradle. Plug in the cradle [44]. Place the transmitters into the Charging Pockets [45]. When inserting the 5T and 6T transmitters, make sure the front of the receiver is facing towards the centre of the charging cradle. The Simeon 5T, 6T, 5M and 6M will turn off automatically when they are placed in the charging cradle. A steady red 'ON' charging indicator will light during charging; a steady green indicator will light once charging is complete [46]. Internal charging circuitry will sense when charging is complete and will terminate charging automatically. Flashing red indicates a failure to charge. check and replace batteries as necessary.

Simeon 5M and 6M Hand-held Transmitter/Microphones

Figures 5, 6 & 7

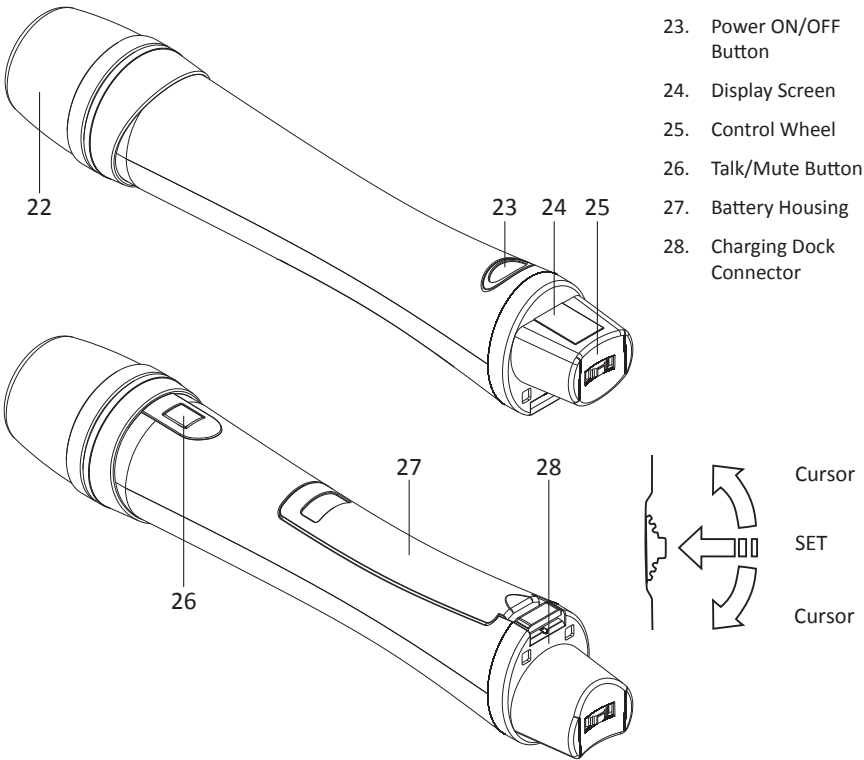

Simeon 602 Transmitter Charging Cradle

Figure 8

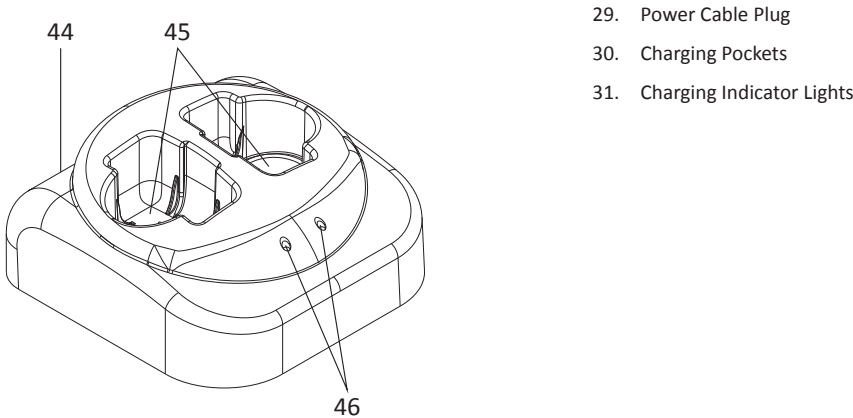

Operation

Check that the transmitters and receiver modules are set to matching channels. With the Simeon Audita **FM** System, make sure that the selected channel frequencies do not conflict with other FM equipment nearby. It is important that separate channels are selected for each system in one location. With the Simeon Audita **Digital** System, make sure that the receiver and both transmitters are set to the same channel group, and that the selected group does not coincide with other Digital soundfield systems where you are.

Simeon Audita Portable Soundfield Receiver

Flick the Power ON/OFF switch on the front of the receiver to the “ON” position [1]. A steady green light indicates that the receiver is on and ready to use. A flashing red light means the receiver is low on batteries and should be recharged. On the front of the receiver are two volume controls [3], one for each of the paired transmitters. Your Simeon Audita is delivered with channels already assigned and the system is ready to use.

Simeon 5M and 6M Hand-held Transmitter/Microphones

To turn the Simeon 5M and 6M on, hold the power button on the front of the transmitter for two (2) seconds [38], until the display screen reads “On”. This screen shows both the channel selection and the battery status. The capsule of the hand-held transmitters [37] is highly directional - point the top of the transmitter directly towards the mouth for best performance. The clicking the talk/mute button on the back of the transmitter [41] allows for the easy interruption of the audio signal. The mute button will be lit by a blue indicator when the transmitter is in talk mode, and by a red indicator when the transmitter is muted. To turn the transmitter off, simply hold the power button for two (2) seconds, until the display screen reads “Off”.

Simeon 602 Charging Combinations

Figure 9, 10 & 11

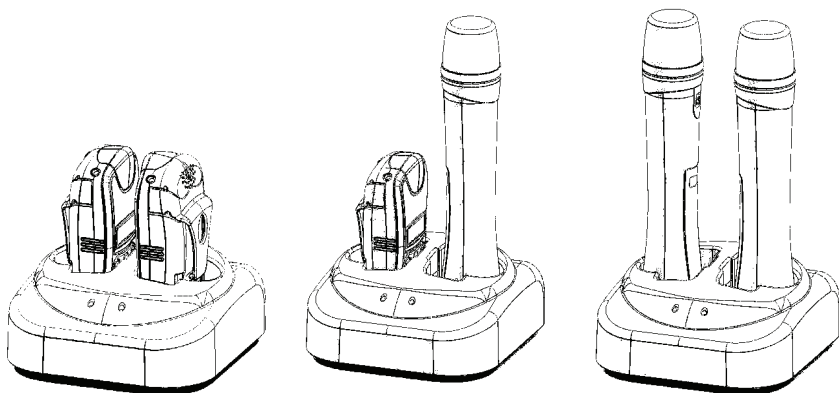

Simeon 5T and 6T Pendant Transmitters

Figures 12 & 13

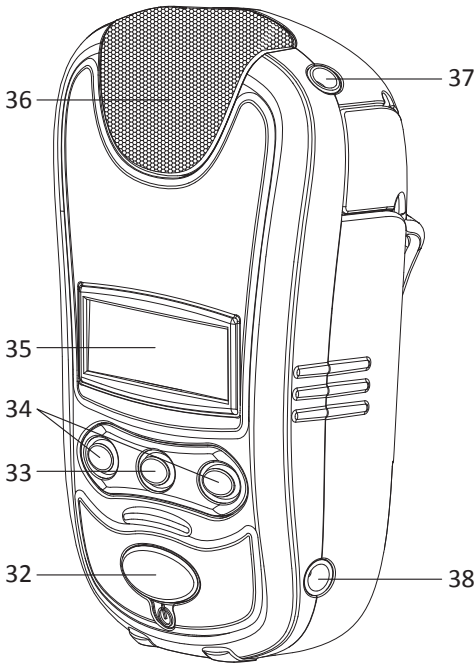

- 32. Power ON/OFF and Talk/Mute Button
- 33. Set Button
- 34. Cursors
- 35. Display Screen
- 36. Microphone Capsule
- 37. Auxiliary Input Jack "Aux In"
- 38. Alternate Charging Plug
- 39. Charging Dock Connectors
- 40. Belt Clip
- 41. Lanyard Hook
- 42. Microphone Input Jack "Mic In"
- 43. Neck Strap Hooks

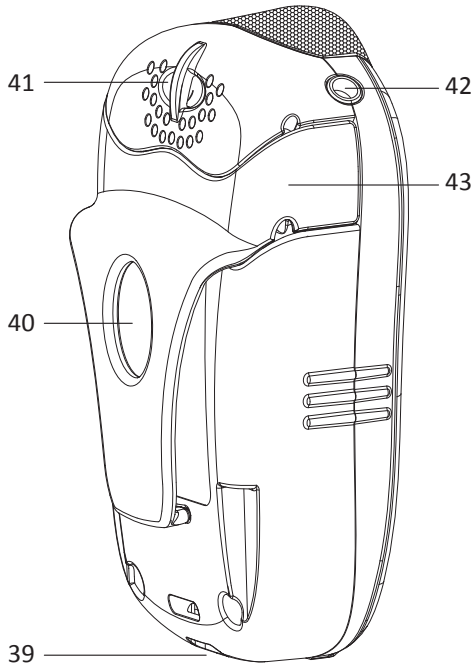

Simeon 5T and 6T Pendant Transmitters

To turn the Simeon 5T or 6T on, hold the power button on the front of the transmitter [21], until the display screen reads “On”. This screen shows both the channel selection and the battery status. Adjust the volume control corresponding to the Digital position (A or B) or FM channel (1-96) displayed on your transmitter. The capsule of the Pendant Transmitters [25] is highly directional - point the top of the transmitter directly towards the mouth for best performance. By quickly pressing the talk/mute button on the front of the transmitter, the same one you used to turn the transmitter on [21], the easy interruption of the audio signal is possible. The power button will be lit by a blue indicator when the transmitter is in talk mode, and by a red indicator when the transmitter is muted. To turn either of the transmitters off, simply hold this same power button until the display screen reads “Off”.

Simeon 623 Directional Boom Microphone

The Simeon 623 microphone and its alternatives are great additions to the Simeon Audita system, improving its performance and ease of use. Using it in conjunction with the Simeon 5T and 6T transmitters frees up your hands and allows the transmitter to be worn either around the neck or at the waist.

Plug the microphone into the 3.5mm microphone input jack MIC IN on the top of the transmitter [31]. The 5T and 6T will automatically adjust sound levels to account for microphone or auxiliary input feeds. **Please Note: If the microphone is inserted into the AUX IN jack speech will not be amplified.** If you are using a Simeon headset (boom) microphone, place the frame [34, 35] over your ears and adjust the boom arm [33] to position the mic capsule to point to the corner of your mouth. It is not necessary to place the microphone in front of your lips and doing so may diminish sound quality. The boom microphone frame must be adjusted to rest comfortably over both ears, with no other contact or pressure points against the head or face. Ensure that the 5T or 6T are not muted [21] and are turned ON. The auxiliary input jack AUX IN can be used for connecting to external audio feeds, including laptops and iPods.

Simeon 623 Directional Boom Microphone

Figures 14 & 15

- 44. Microphone Directional Capsule
- 45. Earhooks
- 46. Spring Metal Frame
- 47. Connector Cable

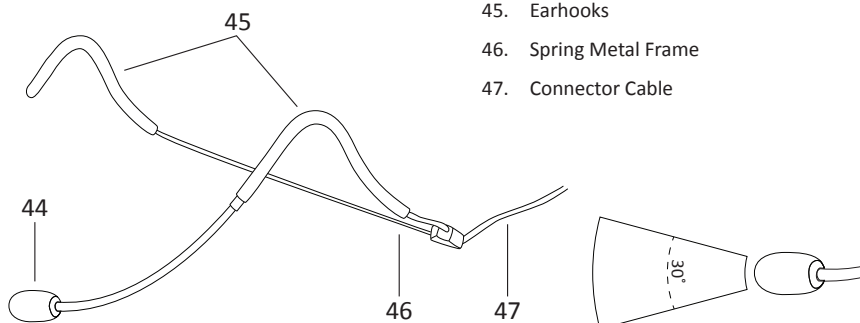

Assigning Channels

FM Transmitters 5T and 5M, and the Simeon FM Dual-Receiver Module, all part of the Simeon Audita FM System, feature a simple-to-use menu that allows selection between 96 UHF channels. To assign a new channel, press the SET button until the displayed channel flashes. Use the up and down cursors to select the new channel. Press SET again to confirm the new channel selection. Make sure that the transmitter channel matches that of the corresponding receiver module.

Digital Transmitters 6T and 6M will automatically pair themselves with the nearest available Simeon Audita Receiver. Before they are paired, the transmitter display screen [24, 39] will show two dashes. Once they are paired, the screen will show the channel group number and a letter, either A or B. The first transmitter to be turned on will be on Channel A, as shown on the transmitter display screen, and will correspond to the left volume dial on the receiver [3]. The receiver display screen [2] will confirm the connection to channel A by displaying the signal strength of transmitter A on the far left of the screen. The second transmitter to be turned on will be on Channel B, as shown on the transmitter display screen, and will correspond to the right volume dial. The receiver display screen will confirm the connection to channel B by replacing the two dashes on the right side of the screen with the channel group number, and displaying the signal strength of transmitter B on the far right of the screen. Note that the digital transmitters will not display a channel until they pair themselves with a Simeon Audita Receiver. The Simeon Digital Dual-Receiver Module features a simple-to-use menu that allows selection between 16 digital channels. To assign a new channel, press the SET button [4] for two seconds, until the displayed channel group number flashes. Use the up and down cursors [5] to select the new channel group. Press SET again to confirm the new channel group selection. The receiver display screen will show the word “On” to confirm the successful change.

External Connections

The side panel of the Simeon Audita has several external connectors. These can be used to connect devices other than the two transmitters to the receiver.

In the left of the side panel there is an auxiliary RCA input jack with gain control [9]. This can be used for connecting external audio sources, such as computers and iPods to the receiver with the appropriate cable.

On the right of the side panel there is a 3.5mm auxiliary output jack [13]. This can be used for direct connections to special equipment such as perAudital FM systems. To make advanced settings adjustments, connect the perAudital FM transmitter to the port on the side of the receiver. Screw-adjust gain and equalizer controls adjust the output for the FM transmitter independently of the speaker volume. The equalizers allow adjustment at 100, 1,000 and 10,000 Hz.

At the bottom of the side panel on the Simeon Audita there is a Speakon cable jack [7]. This can be used to connect the receiver to a Simeon Omnipanel when larger amplification solutions are needed. To set this up, connect the cable into back of the Omnipanel [17] and rotate it to the right to lock it in place. Do the same on the side of the receiver [7]. Move the Speaker Switch [8] towards the front of the receiver to the “**External Speaker**” setting to transfer sound from the internal speaker to the Omnipanel. To unplug the cables pull down on the Speakon “Quick Lock,” rotate the cable to the left and disconnect it. Be sure to move the Speaker Switch back to the “**Internal Speaker**” setting, towards the back of the receiver, when you no longer want to output sound through the Omnipanel.

The 5T and 6T Transmitters are fitted with an auxiliary input jack [26] to allow for connection and transmission of external audio feeds. To set these up, connect them to the port on the top of the transmitter. The pendant transmitters will automatically mute the microphone when an auxiliary feed is connected.

Setting Gain Level

Check the volume position of both channels before turning the system on! Turn the Simeon Audita ON at the master power switch on the front of the system [1]. The Simeon Audita comes with two independent volume controls – one for each transmitter. With the transmitters turned ON and microphone positioned correctly, slowly increase the volume controls to a comfortable listening level. Avoid excessive amplification – speech should be comfortably audible throughout your listening area.

On the top right of the side panel of the Simeon Audita there is a screw-adjust bass and treble control [12]. This will change the tone quality of the Simeon Audita's built in speaker.

Battery Care and Charging

For best performance, use only the included Nickel Metal-Hydride (NiMH) size AA rechargeable batteries in the 5M and 6M transmitters. Never use disposable (alkaline) batteries in combination with the charging system.

Do not attempt to open or change the batteries in the 5T and 6T transmitters. These are special lithium batteries and must be changed at your service centre.

Charge the transmitters after each day of use. The transmitters will automatically power off when placed in the charging cradle. The charging indicator lights [46] will show charging progress: red during charging and green when complete.

Useful Tips

- Wear the pendant transmitters with the belt clip or lanyard and boom mic for comfort and ease of usability.
- Adjust the boom mic headset for comfort, and ensure that the microphone is positioned correctly.
- By selecting the Secondary (S) position for the switch inside the 5M and 6M battery compartment, the handheld can be controlled remotely from the pendant transmitter.
- Consider hanging the Simeon Audita receiver from its keyhole, wall mounting it, or using a tripod floor stand to ensure it is placed optimally.
- Avoid approaching too close to the Receiver or Omnipanel with the transmitters turned on – this may cause a squeal or feedback from the speakers.
- Avoid excessive amplification – soundfield will make speech clearly audible at a comfortable listening level.
- Use the tone control on the side of the Simeon Audita to fine-tune the speaker's sound. Your audiologist or sound professional may assist you with this adjustment.
- Use only the recommended batteries for the transmitters. Use only the correct power adapter for the receiver and charging cradle.
- If you have forgotten to charge the receiver and the internal battery is low, it may be operated from an AC outlet via the charging power adapter.
- Serial numbers are located on the back of the Simeon Audita, on the back of the Omnipanel, on the bottom of the 602, on the back of the 5T and 6T, and inside the 5M and 6M battery compartments.

Microphone care

The microphone is the most delicate component of your soundfield system. Protect the microphone from strain and excessive force. Clean the pin of the microphone plug regularly and replace damaged or missing windscreens and protect the microphone capsule from moisture.

The Simeon 623 boom (headset) microphone has a unidirectional pick-up pattern. The tip of the mic capsule must be pointed towards the corner of the mouth for proper performance.

Five Year Limited Warranty

The Simeon Audita Portable Soundfield main system components (the transmitter and receiver) are covered by a FIVE year parts and labour warranty, effective from the date of purchase. Simeon microphones, chargers, adapters and batteries are warranted for ONE year.

The manufacturer's warranty provides for repair or replacement of defective components or workmanship. Expressly not covered are damages resulting from abuse, neglect, and unapproved substitution of components, batteries or accessories. Extended warranty coverage may be purchased under the Simeon Service Plus extended full service program.

Troubleshooting

No Sound

Check the Speaker Switch on the side of the receiver. Check that the transmitters and receiver are both turned on, and that the transmitters are not set to MUTE. Verify that the Simeon Audita receiver battery is charged, or else plugged into an AC supply with the correct power adapter. Check or replace transmitter microphone. Check that the transmitter batteries are charged. Check that the hand-held transmitter batteries are correctly inserted, observing the correct polarity, and that the battery terminals are making firm contact inside the battery housing.

No FM Signal

Check that the transmitters and receivers are set to matching channels and are within transmission range. Check or replace batteries. Check transmitter is ON position. Make sure the volume controls on the FM Dual-Receiver Module are not locked in the OFF position.

No Digital Signal

Check if Receiver and Transmitter are within transmission range. Make sure 6M mode switch is set to the M position.

Dead Batteries

Check that the transmitter batteries are correctly inserted, observing the correct polarity, and that the battery terminals are making firm contact inside the battery housing. Ensure that the transmitter has been turned off before charging.

Batteries not Charging

Check that the transmitter is making contact in the pocket of the charging cradle and that the charger is connected to the correct power supply. Remove any tape or stickers from the transmitter that may impede contact with the charger. To reset the transmitter battery indicator in case of an unexpected reading, turn the transmitter OFF and then ON again.

Flashing Charging Cradle Light

The transmitter is refusing to charge. Check and replace transmitter batteries as necessary.

Weak Sound

Check and adjust volume setting. Adjust microphone position. Check or replace microphone. Check that the correct power adapter is connected to the receiver.

Noise or Distortion

Check for possible sources of radio interference (e.g. nearby computers, other FM or Digital systems) and try different FM or Digital channels. Check the microphone and the integrity of microphone cord and plug. Clean microphone plug pin with swabbing alcohol or other solvent to maintain noise-free connection. Turn the other volume dial on the Dual-Receiver all the way to the OFF position.

Feedback

Check and adjust volume settings. Ensure that the microphone is positioned correctly. Avoid approaching too close to the portable receiver with the microphone on. To guard against feedback, avoid pointing the microphone directly towards the portable receiver.

Intermittency

Check microphone, mic cable and the plug connection with the transmitter. Replace microphone if necessary.

System Technical Specifications

Simeon Audita Overall System Specifications	
Output power	40W (RMS)
Speaker types	5" Neodymium, 1" tweeter
Audio control	Gain, Tone control, 3-band on auxiliary output
Auxiliary input	Single RCA connector. Input sensitivity 350mV
Auxiliary output	3.5mm mini plug. Output level 1V
Speaker control	Internal Speaker / External Speaker select switch
External speaker output	Single Speakon Connector, 4 Ohm
Power requirements	100 ~ 240VAC / 20VDC, 3.25A switching power supply
Speaker battery type	14.4V, 4.4Ah (Lithium-ion) rechargeable battery, user replaceable
Speaker battery meter	4 LEDs to indicate battery status
Autonomy	≥ 7 Hours at typical gain setting
Charging time	10 Hours
Dimensions	162 x 202 x 326mm (6.5 x 8.0 x 13 inches)
Weight	2.51kg (5.5lb) Including battery
Notes	Operation of this device is subject to the following two conditions:
	1) This device may not cause interference
	2) This device must accept any interference, including interference that may cause undesired operation of the device
	Certain notifications or licensing may apply to infrared equipment in your jurisdiction. Contact the local radio equipment regulating authority for your area for specific requirements.
	© 2013 Supportive Hearing Systems Inc.

Receiver Module Technical Specifications

With RD5 FM Dual Receiver Module	
UHF Frequency range	640~664MHz (Canada & USA); 863~865MHz (Europe)
Number of channels	Canada & USA frequencies: 96; European frequencies: 16
Squelch Adjust OFF	- 100 ± 3dBm
Total harmonic distortion	< 1 %
Signal /noise ratio	> 65dB
Audio frequency response	70 Hz ~ 17kHz
Operating Transmission range	50 ~ 70m (160 ~ 230ft)
Transmission Latency	Real time
Operating temperature	-10°C ~ +60°C (14°F ~ 140°F)
Certifications	Industry Canada, FCC, CE

With RD6 Digital Dual Receiver Module	
Frequency range	2.4 ~ 2.5GHz
Number of channels	16 Channel pairs
Squelch Adjust OFF	- 90 ± 3dBm
Total harmonic distortion	< 1%
Signal /noise ratio	> 60dB
Audio frequency response	40Hz ~ 18kHz
Operating Transmission range	25m (>80ft); 15m (50ft) to establish pairing
Transmission Latency	≤ 6mS
Operating temperature	-10°C ~ +60°C (14°F ~ 140°F)
Certifications	Industry Canada, FCC, CE

Radio Frequency Transmitter Technical Specifications

Simeon 5T FM Transmitter	
Internal microphone type	Electret condenser
UHF Frequency range	640~664MHz (Canada & USA); 863~865MHz (Europe)
Number of channels	Canada & USA frequencies: 96; European frequencies: 16
Radio signal power	High: 10dBm; Low: 3 ± 2dBm
Operating range	50 ~ 70m (160 ~ 230ft)
Max modulation	± 40KHz with level limiting
Battery type	3.7V 1200mAh (Lithium ion) rechargeable, replaceable at service centre
Autonomy	High: 12 hours; Low: 16 hours
Charging time	4 ~ 6 hours
Ext. microphone input	3.5mm mini plug connector
Auxiliary input	3.5mm mini plug connector
LED indicators	Mute / Talk function; Charging status
LCD display	Channel number; Battery status
Wearing options	Safety-release lanyard, belt clip.
Dimensions	33 x 52 x 88mm (1.3 x 2 x 3.5 inches)
Weight	77g (2.7 Oz) Including battery
Certifications	Industry Canada, FCC, CE

Simeon 5M FM Wireless Microphone	
Microphone capsule	Condenser
UHF Frequency range	640~664MHz (Canada & USA); 863~865MHz (Europe)
Number of channels	Canada & USA frequencies: 96; European frequencies: 16
Radio signal power	High: 10dBm; Low: 3 ± 2dBm
Operating range	50 ~ 70m (160 ~ 230ft)
Max modulation	± 40KHz with level limiting
Battery type	AA Nickel Metal Hydride (NiMH) rechargeable, user replaceable
Autonomy	11 Hours
Charging time	4 ~ 6 hours
LED indicators	Mute / Talk function; Charging status
LCD display	Channel number; Battery status
Dimensions(DxH)	37 x 200mm (1.5 x 8 inches)
Weight	143g (5 Oz) Including batteries
Certifications	Industry Canada, FCC, CE

Digital Transmitter Technical Specifications

Simeon 6T Digital Transmitter	
Internal microphone type	Electret condenser
Frequency range	2.4 ~ 2.5GHz
Number of channels	16 Channel pairs
Radio signal power	High: 3 ~ 6dBm and Low: -3 ~ -10dBm
Operating range	25m (>80ft)
Digital pairing range	15m (50ft)
Battery type	3.7V 1200mAh (Lithium ion) rechargeable, replaceable at service centre
Autonomy	24 Hours
Charging time	4 ~ 6 hours
Ext. microphone input	3.5mm mini plug connector
Auxiliary input	3.5mm mini plug connector
LED indicators	Mute / Talk function; Charging status
LCD display	Channel number, Channel A or B position. Battery status
Wearing options	Safety-release lanyard, belt clip.
Dimensions	33 x 52 x 88mm (1.3 x 2 x 3.5 inches)
Weight	77g (2.7 Oz) Including battery
Certifications	Industry Canada, FCC, CE

Simeon 6M Digital Wireless Microphone	
Microphone capsule	Condenser
Frequency range	2.4 ~ 2.5GHz
Number of channels	16 Channel pairs
Radio signal power	High: 3 ~ 6dBm and Low: -3 ~ -10dBm
Operating range	25m (>80ft)
Digital pairing range	15m (50ft)
Battery type	AA Nickel Metal Hydride (NiMH) rechargeable, user replaceable
Autonomy	17 ~ 18 Hours
Charging time	4 ~ 6 hours
LED indicators	Mute / Talk function; Charging status
LCD display	Channel number, Channel A or B position. Battery status
Dimensions(DxH)	37 x 200mm (1.5 x 8 inches)
Weight	143g (5 Oz) Including batteries
Certifications	Industry Canada, FCC, CE



Supportive Hearing Systems, Inc.
283 MacPherson Ave.,
Toronto, ON, Canada M4V 1A4
T: 416-236-4898 | F: 416-483-6210
T: 1-800-732-8804 | F: 1-800-597-3143
e-mail: info@SimeonCanada.com