

Elkfit Cyclor C01 User Manual

Digital Telecom Technology Limited

2013

1. Installation

(1) Install the magnet buttons near the sensor corresponding to the marks on the device, and the distance should be less than 1cm. (Figure 1)



Figure 1

(2) Turn the wheel, and let the magnet pass the sensor, or press the Reset button to activate the device. (Figure 2)



Figure 2

(3) Pair the device with smartphone in the App through Bluetooth. (Figure 3)



Figure 3

(4) Pair code is the 6 digit code printed on the device. (Figure 4)

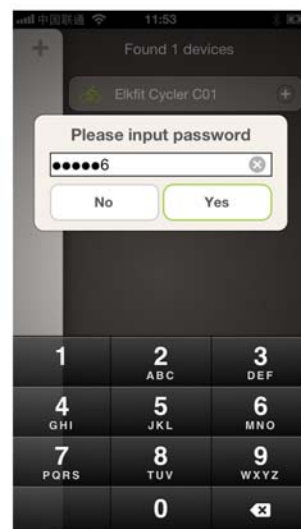

Figure 4

2. Complete profile (Figure 5)

- (1) Click the picture to modify your icon
- (2) Complete your information (gender, age, height, weight) to help calculate calorie consumption more accurately.

Figure 5

3. Device Settings: (Figure 6, Figure 7)

- (1) Auto-lock screen mode:
 - Open - Automatically turns the screen off to save power during riding
 - Close - Reduces the screen brightness during riding eases the way of lighting up screen and decreases battery life
- (2) Device Settings: Turn on the auto calibration, the device will automatically correct the wheel diameter using GPS signal
- (3) Clear Cache: Erase the local history data

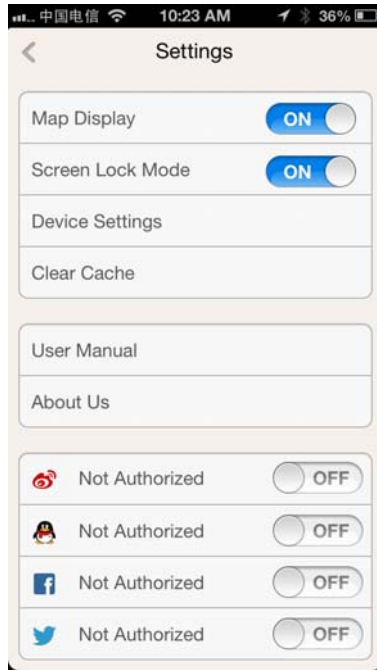

Figure 6

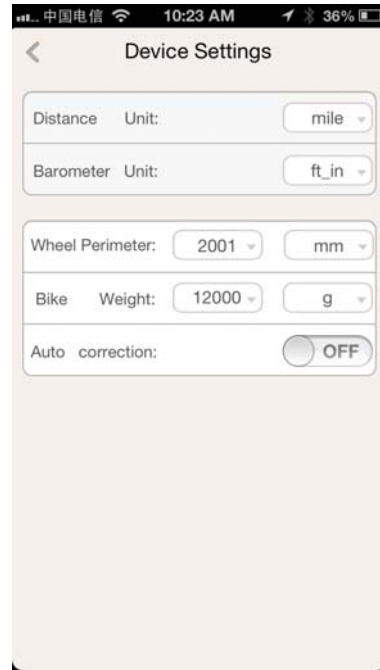

Figure 7

4. History Management: (Figure 8)

- (1) Manage the history of riding date, and cycling data
- (2) Click date in the calendar to display the cycling records
- (3) Click riding list to view details (cycling data, route, velocity, cadence, altitude).

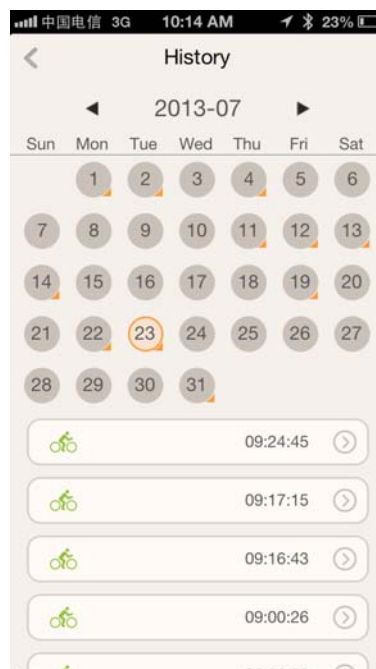

Figure 8

5. User questions

(1) Question1: How do I install it?

a. C01 Sensor Installation: Choose a fitted rubber attach under the sensor, place the sensor on the rear chain stay of your bike, near the pedal. Make sure the reset button is facing outside, and the arm of the sensor should be inside the rear chain stay, facing down. Secure the sensor in place with provided zip ties in product package.

b. The wheel magnet installation: Screw the wheel magnet onto any spoke on your back wheel, facing in, aligning so that it will pass by the arm of the sensor. You can hear a slight "pound" sound to indicate the correct position.

c. The pedal magnet installation: Slip the pedal magnet onto the crank, magnet facing in towards the sensor, aligning so that it will pass by the body of the sensor. You can hear a slight "pound" sound to indicate the correct position.

d. Please double check the magnets are in the correct positions, and make sure the distance between the magnets and the sensor is no longer than 10mm.

Tip: please watch the installation guide video in Support page

(2) Question2: Why is the Bluetooth connection unstable?

a. Please check the magnet position, reference the magnet installation step.

b. Please check if coin battery is in low power.

(3) Question3: How do I change the battery?

The battery is located behind a cover on the back of the sensor and can be replaced by placing a coin in the slot and turning the cover 1/4 turn counterclockwise. Replace with a 3-volt CR2025 battery (Please contact the local waste handling place to dispose the old battery).

(4) For more questions, please send email to support@elkfit.com.

Federal Communications Commission (FCC)

Statement

This device complies with part 15 of the FCC Rules. Operation is subject to the following two conditions: (1) This device may not cause harmful interference, and (2) this device must accept any interference received, including interference that may cause undesired operation.

Warning: Changes or modifications made to this device not expressly approved by Digital Telecom Technology Limited may void the FCC authorization to operate this device.

Note: The manufacturer is not responsible for any radio or tv interference caused by unauthorized modifications to this equipment. Such modifications could void the user's authority to operate the equipment.