

CANSONIC

Full HD
1080

FCCID: 2AA2K-UDV888



ULTRADV
Mini but Unlimited

Available on the
App Store

ANDROID APP ON
Google play

Warning notice

The Federal Communication Commission Statement

This equipment has been tested and found to comply with the limits for a Class B Digital Device, pursuant to Part 15 of the FCC rules. These limits are designed to provide reasonable protection against harmful interference in a residential. This equipment generates, uses and can radiate radio frequency energy and, if not installed and used in accordance with the instruction, may cause harmful interference to radio communication. However, there is no guarantee that interference to radio or television reception, which can be determined by turning the equipment off and on, the user is encouraged to try to correct the interference by one of more of the following measures:

- * Reorient or relocate the receiving antenna.
- * Increase the separation between the equipment and receiver.
- * Connect the equipment into an outlet on a circuit different from that to which the receiver is connected.
- * Consult the dealer or an experienced Radio/TV technician for help.

Use only shielded cables to connect I/O devices to this equipment. You are cautioned that change or modifications not expressly approved by the party responsible for compliance could void your authority to operate the equipment.

THIS DEVICE COMPLIES WITH PART 15 OF FCC RULES. OPERATION IS SUBJECT TO THE FOLLOWING TWO CONDITIONS:

1. This device may not cause harmful interference and
2. This device must accept any interference received, including interference that may cause undesired operation.

The antenna used for this transmitter must not be collocated or operation in conjunction with any other antenna or transmitter.

Notice : The changes or modifications not expressly approved by the party responsible for compliance could void the user's authority to operate the equipment.

IMPORTANT NOTE: To comply with the FCC RF exposure compliance requirements, no change to the antenna or the device is permitted. Any change to the antenna or the device could result in the device exceeding the RF exposure requirements and void user's authority to operate the device.

Contents

Features.....	1
Notice.....	3
About this manual.....	4
Know the product.....	5
Canasonic cap installment	6
Car bracket mount	6
Start using this product	7
Battery charging	7
Inserting the microSD card.....	7
Powering ON/OFF.....	8
Basic operation.....	9
Switching between modes.....	9
Video.....	10
Operation of the emergency storage function.....	10
Muting function.....	10
Application of 3G G sensor function.....	10
Application of GPS function(option).....	10
WiFi function.....	11
Time-lapse function.....	11
Real-time surveillance application.....	11
Video settings.....	12
Photo.....	12
photo settings.....	12
Playback mode.....	13
Playback settings.....	13
Usage mode of AP player(option).....	14
TV connection.....	16
AV OUT (option).....	16
HDMI OUT (option).....	16
PC connection.....	17
Reset system.....	17
WiFi manual(Android).....	18
WiFi manual(iOS).....	25
Specification.....	31
Accessories.....	32

Features

- This is the latest product of ultra-small size and powerful FULL HD ULTRA digital video recorder.
- 140 degrees A+ level high resolution extra wide angle lens with high quality and high dynamic photosensitive element. It improves the night vision capability to catch the clear pictures in the dark environment. It also has anti-shock function to prevent the pictures dimming from shaking.
- Our company original and breakthrough parking collision detection function. When your car is vibrated by external vibration under the parking situation, it will automatically start and recording one minute and then automatically turn off. After the UDV-888 turn off, it won't consume the electricity, so the battery can be used longer.
- With the automatic recording function when the car turn on, and automatic turn off for delay of 30 seconds to ensure the record is more completely.
- Automatically delay turn off the screen.
- Built-in 3G-SENSOR function. It can automatically detect the three-dimensional gravity change of X axis, Y axis and Z axis.
- With emergency lock file function, it can automatically detect the abnormal situations and lock the file immediately by the 3G SENSOR function. It also provides manual emergency lock file function, you can lock the file to avoid the file covered by pressing MENU button.
- With the time/date/G-SENSOR/GPS speed watermarking function can ensure the status, time, speeds and positioning coordinate accuracy of the record file. (option)
- Built-in WiFi and support 802.11
- With exclusive APP (Android & iOS), it's easy to connect with smart device and UDV-888 by CANSONIC exclusive APP, Using CANSONIC APP to experience the "WIFI New Generation" Ultradv; While travelling by car, you can always capture the picturesque beauty even without getting out of the car; While the critical moment, UDV-888 will capture the photo automatically and send the photo to the smart device, will retain the evidence to protect oneself.
- Supports high resolution video recording: 1080P (1920X1080/30fps), 720P(1280X720P/60fps), 720P(1280X720P/30fps).
- Using H.264 MOV CODEC mode makes the recorded data clearer and more perfect.

- Support the Wide Dynamic Range (WDR) function, will greatly increase the quality of the night image. Under backlighting situation (intense sunlight or artificial light) won't exposure, and in the dark environment still can record the objects details.
- Support Time-lapse photography function, can setup the difference period of time to take photos. Under the video mode will automatically synthesize the photos into a video. It's not only could save the storage capacity but also could have the special efficacy that the quality is the same as the professional camera.
- With loop recording function, it can automatically delete the old file and record the new one.
- With seamless recording function, it can ensure no missing during the recording.
- Support the motion detection to save more memory space, this is function is adapted to use on hunting cam.
- With the image rotation function, you can conveniently install the product to variety areas with attached brackets, and guarantee the correct direction of the recorded data.
- Support Burst 30FPS.
- With the self-timer function, you can capture the ideal picture by the monitor preview.
- With hot-key function, it's easier to turn on/off mute and zoom in/out.
- With the time/date/G-SENSOR/GPS (OPTIONAL) speed watermarking function can ensure the status, time, speed and positioning coordinates accuracy of the record file. Incident forensics is more powerful.
- Support high capacity SDHC card up to 64GB (at least 4GB, and Class 6 is recommended).
- Support DC12V to DC24V, and plug and play can be realized on heavy trucks, big trucks and buses.
- Supports CVBS/HDMI output; using the special output cable of this product, you can share all kinds of wonderful videos and photos of yourself and your family, and play files on TV screen.
- It can be used as PC camera to bring you an enjoyable network life.
- Built-in microphone/speaker and dual-channel stereo output bring better sound effect.
- This product has passed Taiwan BSMI certification and international safety certification of CE and FCC, and it is manufactured in RoHS lead-free process; let's work together to love the earth and protect the environment.

Notice

- Please do not use or place this product in the dusty, dirty or sandy areas, or the components will be damaged.
- Storage temperature: -20°C to 80°C.
- Operating temperature: -10°C to 60°C.
- Please do not drop or strike the product, because the violent vibration may damage internal components.
Please charge the battery fully before the first use.
Please tear the lens-protector to first use, ensuring the video clear.
- Please keep the camera lens clean and do not use the objects which contain oil or water like fingers to touch the lens, because it will dirty the lens to produce hazy mist or halo effect, and finally lower the quality of videos. We would like to recommend that you regularly wipe the lens with lens cleaning cloth to maintain the high-definition and clear shooting quality. Please don't wipe the lens with toilet paper or general paper to avoid scratching the lens.
- When using a new microSD card, please format the card in the camera to be sure it is set to the correct settings.
- Please use a correct microSD/SDHC card (suggested minimum 4GB card with a class of 6 or above).
- Operating system: windows 7/Windows XP/Windows Vista/.
- Please make sure the product operate properly before using
- Because the battery is the principle of using a chemical reaction, so as the time increase and the battery performance will be reduced even if it is stored for a long time without using. If using conditions such as charging, discharging, the use range of situations and the ambient temperature is not specified, also can reduce battery life or damage products ,and it will not be covered under warranty.

About this manual

Our company continually makes updates and improvements to our devices, thus some functions of the device may vary slightly from what is contained within this manual. CANSONIC shall be entitled to modify the content or software without prior notice and the manufacturer shall be entitled to modify technical specifications without prior notice. The accessories included with your device may differ with what is outlined in this manual.

Without prior written permission by the manufacturer, it will be forbidden, by electronic, mechanical, magnetic, optical, artificial and other ways or forms, to copy, transmit, modify, store this manual in the retrieval system or translate it into any other language or computer language.

Know the product

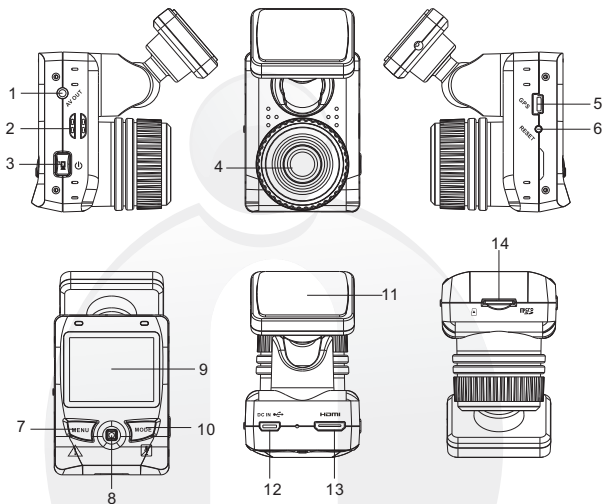

1	AV out	8	Joystick/OK button
2	Microphone	9	Screen
3	Power button	10	Mode/ Mute button
4	Lens	11	Bracket slide
5	GPS connector	12	DC IN/ USB port
6	RESET button	13	HDMI port
7	Menu button/ Emergency event button	14	MicroSD card slot

Cansonic cap installment

Please twirl the CANSONIC cap into the port of the UDV-888, and clockwise twist until your hear a click. On the contrary, please anticlockwise twist the CANSONIC cap to take out.

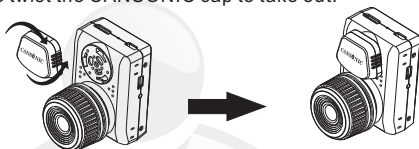

Car bracket mount

Please twirl the mount into the port the UDV-888, and clockwise twist until your hear a click. On the contrary, please anticlockwise twist the mount to take out.

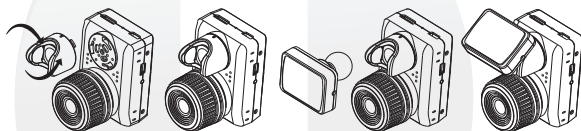

Please properly install and use according to the following diagram, because improper operation may damage the machine.

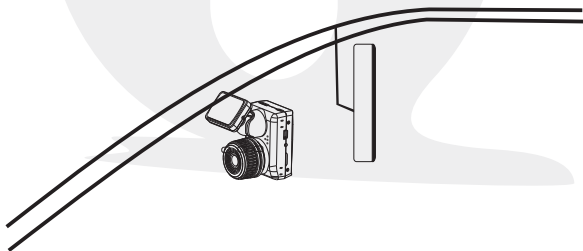

Note: Please tear the protective film of the bracket seat, paste the machine on car windshields.

Start using this product

Battery charging

Before the first use, please choose one of the following three ways for charging this machine.

- 1). Charging by travel charger (optional)
- 2). Charging by USB cable (optional)
- 3). Charging by in vehicle power supply (car charger).

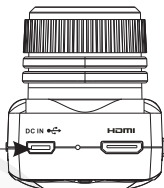

When the camera connection with the vehicle power or the travel charger will automatically start recording, it will record while charging. To save the charging time, it is recommended to press the power button to shut down, and the red charging indicator will illuminate during charging and the red indicator will darken automatically after completion. The charging process will last for about 180 minutes.

Inserting the microSD card

Insert the microSD card into the microSD card slot until you hear a click; the drawing outlined on the camera indicates the correct direction.

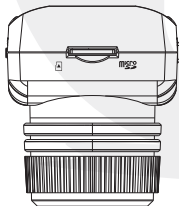

Removing the microSD card: Push the card in, and the card will bounce out.

Powering ON/OFF

Powering On

Press the power button to power on, and the blue indicator light will illuminate, then press the POWER button to start/stop record, and the blue indicator will flick when the camera is recording.

Powering Off

Press the power button for three seconds to power off the camera, and the blue light will go off.

Note: The product will show a prompt and automatically shut down when the power level becomes too low.

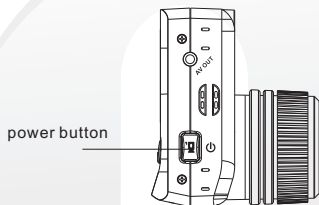

Basic operation

Switching between modes

Press the MODE key to switch between video / photo / playback / system setting modes.

System Settings

Option name	function
Audio	Setup the audio and beep sound
Screen save	Setup time-period to turn down screen
Date & Time	Setup date and time
Language	Select the language
WiFi Password	Setup Password, default 8888 8888
TV	PAL/NTSC
G-sensor	Modify the sensitivity
Frequency	50/60 Hz
GPS function	GNSS On/Off (option)
Water mark	Show the data of G-sensor and time
LOGO mark	On/Off
Stabilizer	On/Off
Invert mode	On/Off 180 degree rotation
Time zones	Select the zone
Collision detect	On/Off for park surveillance
Format	Delete all files in SD card
Timelapse	Select the time-period to shot
System	Some information about device

Video

After inserting the SD card, please press the Power key to power on, and then press record key (power key) to record .

When the product is connected to the car-charger, UDV-888 will automatically start recording. You can press the record key to stop, and then click it again to restart recording.

1. During recording, press the OK button to snap shot.
2. In the video mode, pressing the UP button will turn on the display Screen and enter power-saving mode.
3. During recording, pressing the DOWN button will turn off the display.

Operation of the emergency storage function

While recording, pressing the emergency button  will immediately store the video file being recorded. The video for 60 seconds before and after pressing the button will be captured and stored, and will not be deleted. One third of the device's memory will be set aside for this function, when it indicates full, use the custom media player through your computer to unlock and delete the video.

Muting function

While recording, pressing the MODE button  will turn off/on the camera's microphone. If turn on the microphone and the screen will display this icon; If turn off the microphone and the screen will display this icon.

Application of 3G sensor function

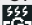
In system settings, the G sensor can be set to ON or OFF; When choosing on, the screen will display this icon ):

1. When an emergency event is sensed (violent shake or abrupt breaking) on the screen will appear the following icon , which indicates that the file will be saved .The video file being recorded will be stored and will not be recorded over.
2. Please select the sport mode in G sensor menu, it can leave the data and not to protect the file.

Application of GPS function(option)

GPS function can be enabled and disabled in the system setting option; when enabled, the icon  will be displayed on the screen.

When GPS signal is normally connected, the icon  will flash.

It can record at any time and place the driving status, driving time, speed, direction, and location, etc. Through the special play software of this product, you can easily access to all running track record.

WiFi function

Under Video mode, press down the joystick, and it will open the WiFi function. Please refer to WiFi manual.

Time-lapse function

1. Open the time-lapse function.

- 1) Setup how much second to take one picture under the time-lapse menu.
- 2) Press the record key to start the time-lapse under the Video mode or Photo mode.

2. Time-lapse settings

After opening the time-lapse function, it will follow the interval that you set to how long to take a photo and edit automatically into a Full HD video finally.

Under the photo mode, it will show separate picture files.

Please setup the photography interval that you prefer e.g., every 10 second or every 1 minute.

If the photography interval is above 1 minute or more, it will power off after shotting for saving the battery life. When the time is up, it will power on automatically and loop.

Real-time surveillance application

UDV-888 can be used in every place to monitor in real-time, it is easy and convenient to setup and operate.

1. Motion detection function

After opening the motion detection, UDV-888 will record automatically 1 minute and power off when the object motion in front of the device, it can save more memory space to help car safety surveillance.

2. Parking collision wake-up function

When some external force impact the car, UDV-888 will automatically power on and wake up to record 1 minute then power off to extend the battery exhaust.

Video settings

Option name	Function
Resolution	1080P/30FPS 720P/60FPS 720P/30FPS
Quality	Super fine/ fine /normal
Seamless	1min/3min/5min/off
Datetime watermark	Show on the top of the video
Exposure	EV+2.0/ +1.0/ 0 /-1.0/ -2.0
White balance	select the right circumstance
Motion detect	On/Off
WDR	Help to get more qualified video in the contrasty condition.

Photo

Under photo mode, press the record/power key to take a photo.

Photo settings

Option name	Function
Resolution	VGA/2M/3M/6M/8M/10M
White balance	select the right circumstance
Exposure	EV+2.0/ +1.0/ 0 /-1.0/ -2.0
Drive mode	self-timer and continuous shoot
Burst	10FPS / 20FPS /30FPS

Playback mode

Press mode key to playback mode, there are three kinds of files.

- 1). Event: All protection videos are in this folder.
- 2). Video: All unprotection videos are in this folder.
- 3). Photo: All photos are in this folder.

Use joystick to find the video to playback.

- a. Press record/power key to play/stop.
- b. Press left or right key to fast-forward and backward.
- c. Press menu key to stop and switch back to submenu.

Playback settings

Option name	Function
Delete	Single/All
Protect	Single/Protect all/ Unprotect all

Usage mode of AP player(option)

Brief introduction

This is special computer end play software which is developed by our company for using with our high definition driving recorder.

System requirements

CPU: At least Pentium 4 3.0G, and dual-core or multi-core CPU is recommended;

Screen: Support resolution of 1280*1024

RAM: At least 1 GB

OS: Support Windows XP, Windows Vista (32/64) & Windows 7 (32/64);

Audio: Audio device needs to be installed correctly in the system;

Software installation

Step 1: Open the attached CD, please copy the CANSONIC Player folder to the local hard drive *: \

Note: If the Cansonic CDV-800 Player folder were not copied to the local hard drive, it wouldn't operate normally.

Step 2: Run the CANSONIC Player.exe (no need to install, just execute it directly). If it's performed in Windows Vista or Windows 7, it need to have the system administrator right, and then it can work normally.

Note: The system of the computer need to install Windows Media Player and Quicktime Play software, after the software installation is completed, and then run the SETUP.BAT in the CANSONIC Player folder to support CANSONIC Player for video playback.

Software interface and use

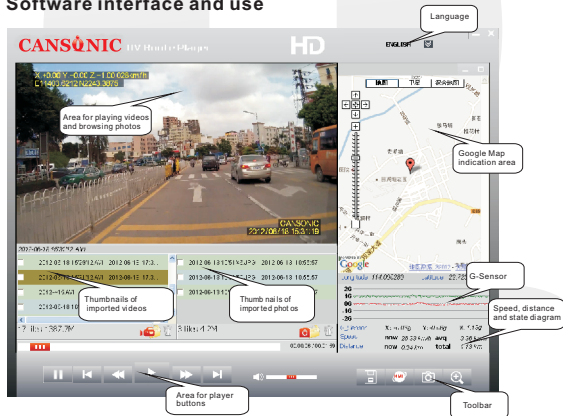

keys function

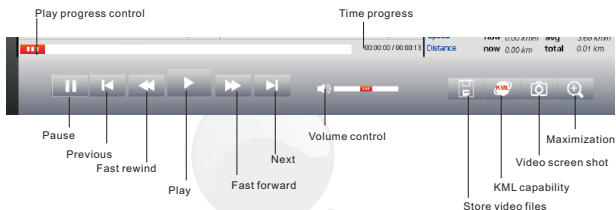

KML (3D stereo streetscape) function instruction

Please make sure your computer's network functions can be used normally and the computer is properly installed GoogleEarth software before using KML function.

1. Open CANSONIC player.
2. Select the video files you want to export KML, and click the KML icon in the lower right corner of the player, and then the system will pop up a dialog box. Please select the path which you want to save the KML file, and the system will pop up a dialog box once again, and select the movie section you need to export or select all the output, and then click the "output KML" in the lower-right corner of the dialog box.
3. Open the Google Earth software, and choose file - open, and then the system will pop up the dialog box to choose KML file. Please find the KML file you just select, select and click "Open" in the lower right corner of the dialog box.
4. Wait a moment, GoogleEarth software will show a car DVR recording file of GPS Driving locus documents.

Function key in thumbnail area

