



User Manual

Function

- A.** Power ON (Press the button for 1.5 seconds or more)
OFF (for 4 seconds or more)
Battery Check (Pushing the key less than 1.5seconds)
- B.** Battery Charger Connector (USB C Type)
- C.** Earphone connector
- D.** Battery Display LED
- E.** Activating operation mode switch (In 2 seconds, Press the button : Mode Change as Vibration, Vibration + Sounds)
- F.** Haptic Device
- G.** Display LED
Blue: only vibration [1] | Green: vibration + sound | Blue LED Blinking: Blinking LED when Bluetooth is not connected [2] | Red: Power Off or Low Battery (1 second interval)
- H.** Vibration level control button
- I.** Lifter

Lifter : If you attach a lifter to the haptic console, the height of your hand goes up, making it easier to use when touching the screen. But, delicate height control is not possible.

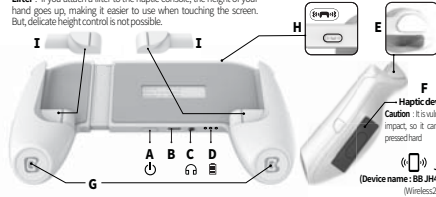

LED color changes with vibration level

The vibration level control button (H) changes the color of the product logo LED (G) according to the vibration level of a total of three stages.

Step 1: Orange / Step 2: Pink / Step 3: Aqua

*Vibration Mode - Blue

*Sound Vibration Mode - Green

*Vibration OFF Mode - White

If you compare the haptic vibration level with the cell phone vibration, it is like this. But, the vibration feature and strength may vary.
Step 1 = Cell phone vibration 1-2 Step 2 = Cell phone vibration 3-4 Step 3 = Cell phone vibration 5

Product Information

In the Box

- (a) Haptic Console 1ea
- (b) Haptic Console Case 1ea
- (c) User Manual 1ea
- (d) Charger Cable 1ea
- (e) Lifter 1Set

Specification

Power	DC 5V
Current Consumption	Operation Max 400mA
Battery	Max 600mAh
Charging Time	About 6 hours for full charging (up to 3hours 30minutes to 4 hours usage)
Weight	160g (Main Body)
Function	Haptic Function ON/OFF Setting button / Built-in Battery
Operating Temperature	10 ~ 40°C
RF Frequency	2402 ~ 2480MHz



Identified term

Product Name	Haptic Console
Model	JH47P
Material	PC/ABS and Electronic Components
Seller	TN8TECH CO., Ltd
Certification Number	Indicated on products

How to assemble and disassemble the device to/from Smart phone

Turn on the product, select BB JH47-BT of Bluetooth from the list of smartphone devices, then establish a Bluetooth connection. Then, attach the smartphone by pulling one side of the JH47P. The JH47P can be extended to 6.85 inches. When mounting a cell phone that exceeds 6.85 inches in length, do not forcefully open the handle.

Warranty Policy and Precautions

We provide a one-year warranty from the date of purchase for all TN8TECH products. However, free A/S is not supported for products that are damaged or arbitrarily disassembled or modified due to their own negligence.

Precautions and Recommendation

1. One-year warranty from the date of purchase.
2. Contact the dealers for replacement if the packaging and contents are different from their descriptions.
3. Avoid strong impact.
4. Appearance and specification of the product may be changed for improvement without prior notice.
5. **Free A/S is not supported for products that are damaged or arbitrarily disassembled or modified due to their own negligence.**
6. Vibration strength can be adjusted. The product is optimized for 40~60% volume.
*We recommend that the device is being used with 70~90% of the volume
7. Prolonged usage may damage the wrist.
8. Do not clean using alcoholic products. It may remove the rubber coating.
9. Headphone (Earphone) can make you absorbed in the game.

How to enjoy the Haptic Console with the best conditions

1. The strength and weakness of vibration can be adjusted by adjusting the vibration intensity of this product and the volume of the smartphone.
▶ If you set the volume to 70-90% based on the **second** level of vibration intensity, you can feel the optimal vibration.
2. For your absorption, using an earphone is highly recommended second.
3. Mute the background sound during playing the game, so that you can feel better your own batting sense and the sound of the enemy.

www.playhaptic.kr 3rd Floor, TN8TECH Co.,Ltd, 92 Dongil-ro, Gwangjin-gu, Seoul, Korea A/S: +82-70-7702-1231 | Tel: +82-2-499-1231

How to set up dual audio when using wireless earphones or headsets

* To minimize signal delay, it is recommended to connect JH47P products first. If you play with sound vibration mode during console play, the sound quality may be slightly lowered, so we recommend wearing earphones. (Samsung Galaxy smartphone Android 10, Bluetooth 5.0 or higher)



- ① Connect the JH47P (Device name : BB JH47-BT) to Bluetooth of smartphone.
- ② Enter the settings by selecting the media menu from the top menu of your smartphone.

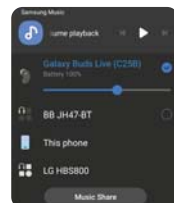

- ③ Of the two products connected through smartphone Bluetooth, the check box is temporarily released for the first one connected.

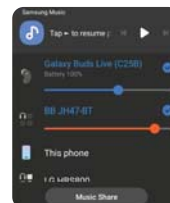

- ④ Press the check box again to connection.
- ⑤ Sound and vibration volume can be adjusted by adjusting the volume of BB JH47-BT model and the volume of wireless earphones.

FCC Compliance Statement

This device complies with part 15 of the FCC Rules. Operation is subject to the following two conditions : (1) This device may not cause harmful interference, and (2) This device must accept any interference received, including interference that may cause undesired operation.

CAUTION: Changes or modifications not expressly approved by the party responsible for compliance could void the user's authority to operate the equipment.

This equipment has been tested and found to comply with the limits for a Class B digital device, pursuant to part 15 of the FCC Rules. These limits are designed to provide reasonable protection against harmful interference in a residential installation. This equipment generates, uses and can radiate radio frequency energy and, if not installed and used in accordance with the instructions, may cause harmful interference to radio communications. However, there is no guarantee that interference will not occur in a particular installation. If this equipment does cause harmful interference to radio or television reception, which can be determined by turning the equipment off and on, the user is encouraged to try to correct the interference by one or more of the following measures:

- Reorient or relocate the receiving antenna.
- Increase the separation between the equipment and receiver.
- Connect the equipment into an outlet on a circuit different from that to which the receiver is connected.
- Consult the dealer or an experienced radio/TV technician for help.



www.playhaptic.kr