

Wireless Microphone

User Manual

JIUOKAY



MADE IN CHINA

Introduction

Thanks for choosing our product.

This product is a smart wireless microphone that provides professional-grade recording output. Plug and play, no app required. Multiple uses: It can be used in online live broadcast, video Vlog shooting, program interview, recording, video teaching and other occasions.

The wireless Microphone consists of two parts, one is Microphone transmitter, the other one is receiver.
(See as below picture)



(Microphone transmitter)

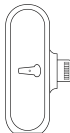

(receiver)

ID Diagram

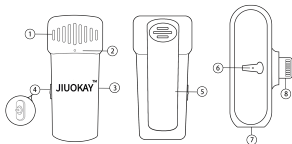

- | | |
|----------------------------|--------------------------|
| ① Windproof net | ⑤ Micorphone clip |
| ② Microphone indicator | ⑥ Receiver indicator |
| ③ Microphone charging port | ⑦ Light port of receiver |
| ④ Switch Key | ⑧ Port to connect phone |

How to use

Step1:Connect the receiver to phone with port.

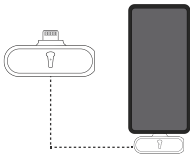

Step2 :

Press switch key of microphone,the indicator lights up,and then power is turned on.

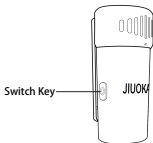

Step3 : The indicator Blue light of receiver keeps always on,then open the phone camera,live App or other Apps,and then to use the microphone to receive sound.

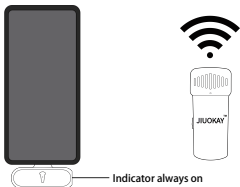

Special Note:

For the use of ⑧ port:there is no battery in receiver,and no need to re charge during live.If the phone is low power during Live,it can be recharged directly through ⑧ port.

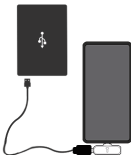

About UI

Microphone Transmitter

Function	How to use	Light
Power on	Press switch key about 2-3 seconds	LED light flashes
Power off	Press switch key about 2-3 seconds	Light off
Pairing		LED light flashes
paired		LED light keeps on
mute	Press switch key one	LED light flashes
Unmute	Press switch key one	LED light keeps on
Reverberation	Double-click	The light don't change
Denoise	Short press the switch	
Charging	Charging with Type-C cable	The red light goes out when it is fully charged
Power is less than 30%		Red light
The power is between 30% and 70%		Blue light
Power is more than 70%		Green light
Automatic shutdown	After 3 minutes without operation	Light off

Warning:

Changes or modifications to this unit not expressly approved by the party responsible for compliance could void the user's authority to operate the equipment.

NOTE:

This device complies with part 15 of the FCC Rules. Operation is subject to the following two conditions: (1) This device may not cause harmful interference, and (2) this device must accept any interference received, including interference that may cause undesired operation.

FCC Statement:

This equipment has been tested and found to comply with the limits for a Class B digital device, pursuant to part 15 of the FCC Rules. These limits are designed to provide reasonable protection against harmful interference in a residential installation. This equipment generates, uses and can radiate radio frequency energy and, if not installed and used in accordance with the instructions, may cause harmful interference to radio communications. However, there is no guarantee that interference will not occur in a particular installation. If this equipment does cause harmful interference to radio or television reception, which can be determined by turning the equipment off and on, the user is encouraged to try to correct the interference by one or more of the following measures:

- Reorient or relocate the receiving antenna.
- Increase the separation between the equipment and receiver.
- Connect the equipment into an outlet on a circuit different from that to which the receiver is connected.
- Consult the dealer or an experienced radio/TV technician for help.

The product is a portable device and meets the exposure assessment requirements for portable devices.