











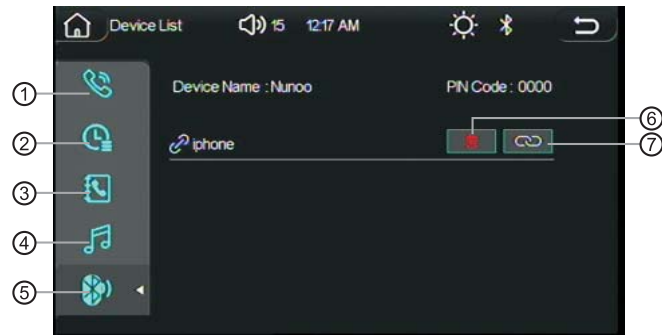

9.  Tap this key to Audio regulation
10.    Tap this key to RDS Function setting

VI. Brief introduction and operation of Bluetooth function

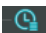
Introduction of Bluetooth Function:

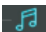
The system is compatible with Bluetooth+BR+EDR+BLE and supports A2DP \ AVCTP \ AVDTP \ AVRCP \ HFP \ SPP \ ATT \ GAP \ GATT \ RFCOMM \ SDP \ L2CAP



1.  Tap this key to enter the Bluetooth extraction interface;
2.  Tap this key to enter the Bluetooth call recording interface;
3.  Tap this key to enter the Bluetooth phone book interface;
4.  Tap this key to enter the Bluetooth music interface;
5.  Tap this key to enter the Bluetooth connection interface;
6.  Tap this key to delete the connected phone's information;
7.  Tap this key to disconnect the connected phone \ reconnect the phone to Bluetooth;









VII. Function introduction and operation of USB flash disk \SD card

1. Introduction and operation of the music playback function.

Introduction to the music playback feature.

Supports playing MP3\WMA\AAC\WAVE\FLAC\APE\OGG\M4A(QT)\RA;

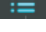

- 1.1.  Tap this key to enter the audio setting interface;
- 1.2.  Tap this key to toggle the single song loop/ folder loop/ all loop function;
- 1.3.  Tap this key to switch to the previous song to play;
- 1.4.  Tap this key to turn on random play function ;
- 1.5.  Tap this key to toggle on the pause/play function;
- 1.6.  Tap this key to turn on the \ Off numeric keyboard function;
- 1.7.  Tap this key to switch to the next song;
- 1.8.  Tap this key to turn on\ off the song list function;
- 1.9.  Tap this key to enter \exit file list screen;

2. Introduction and operation of the video playback function

Video playback function overview:

Support playing MP4\MP5\DIVX\AVI\MKV\QT\MPG\ASF\FLV\RMVB\TS;

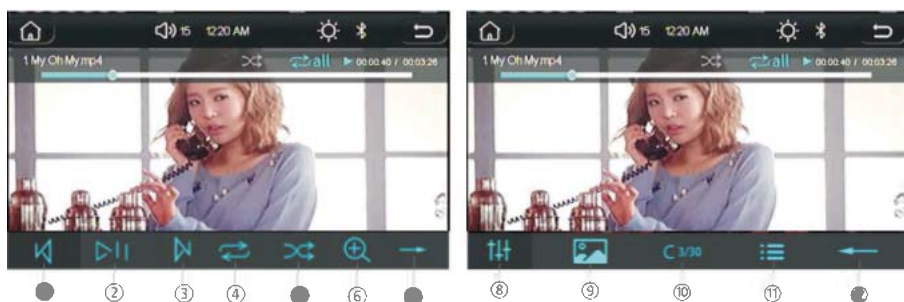

- 2.1. Tap this key to switch to the previous video;
- 2.2. Tap this key to toggle the pause/play function;
- 2.3. Tap this key to switch to the next video;
- 2.4. Tap this key to toggle between single loop/ folder loop/ all loop function;
- 2.5. Tap this key to turn on random play;
- 2.6. Tap this key to zoom in on the video;
- 2.7. Tap this key to switch to the next Function menu;
- 2.8. Tap this key to enter the audio setting interface;
- 2.9. Tap this key to enter the interface of display settings;
- 2.10. Tap this key to turn on/off the numeric keypad function;
- 2.11. Tap this key to turn on/off the song list function;
- 2.12. Tap this key to switch to the previous page of Function menu;

3. Introduction and operation of picture playback function

Picture playback function description: support playing JPG\BMP\PNG;



- 3.1. Tap this key to switch to the previous picture;
- 3.2. Tap this key to toggle the pause/play function;
- 3.3. Tap this key to switch to the next picture to be played;
- 3.4. Tap this key to turn on/off the numeric keypad function;
- 3.5. Tap this key to switch to the next Function menu;
- 3.6. Tap this key to zoom in on a picture;
- 3.7. Tap this key to rotate the picture;
- 3.8. Tap this key to toggle between single song loop/ folder loop/ all loop functions;
- 3.9. Tap this key to turn on the random play function;
- 3.10. Tap it to switch to the previous page of the Function menu;

VIII.Function introduction and operation of Phone link

Note: In order to use the cell phone connection function, you need to select the connection method on the vehicle side first.

Introduction to Phone link's functions: When using an Android phone for wired phone interconnection, the phone needs to turn on "USB Debugging" in "Developer Options".

When using the Iphone connection, you need to keep the phone unlocked, then connect the phone with the USB cable and click "Trust" to complete the Mirror Link.



1. Tap this key to enter the interface of Android device wired phone interconnection function;
2. Tap this key to enter the interface of wired mobile interconnection for Apple devices;
3. Tap this key to enter the wired CAR PLAY interface;
4. Tap this key to enter the Android auto interface;

Common problems when using the cell phone interconnect function:



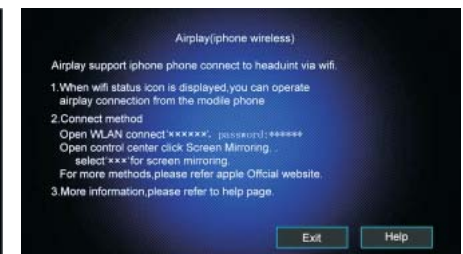
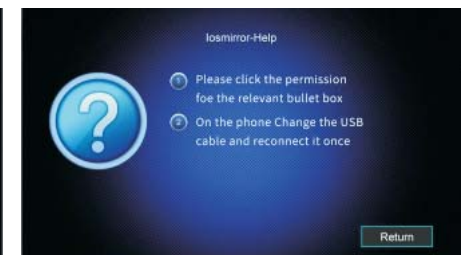
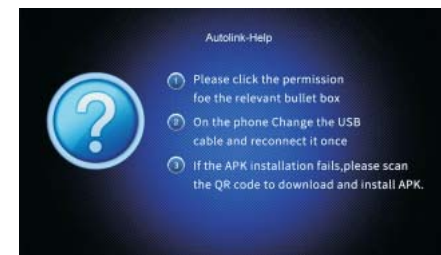

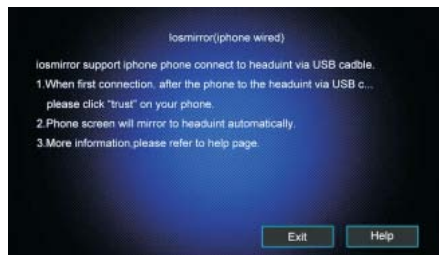
1. When using the wired phone interconnect back control function, you need to connect Bluetooth to use;
2. Some Android phones need to be touched in Mobile>Application Management > Autot link > Open "Force full screen display";



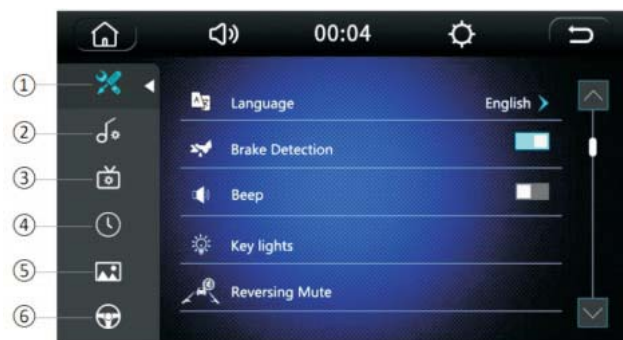

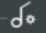

IX . Introduction and operation of setting menu function

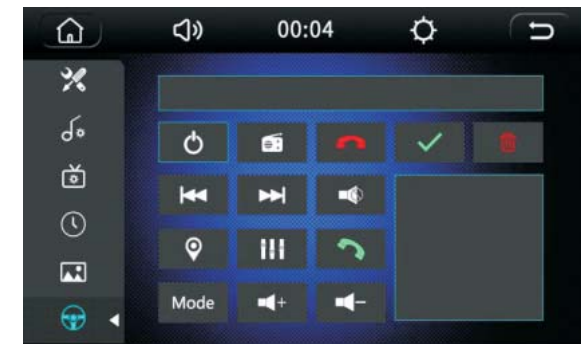

1.  Tap this key to enter the function setting interface, which can be slid up and down by touching it;
2.  Tap this key to enter the audio setting interface;
3.  Tap this key to enter the display settings interface;
4.  Tap this key to enter the time setting interface;
5.  Tap this key to enter the wallpaper setting interface;
6.  Tap this key to enter the direction control setting interface;

X . Brief introduction and operation of learning function of direction control



1. Press and hold the steering wheel key, then click on the key icon on the steering wheel interface, the icon will change color;
2. After pressing all keys, tap , and learning is complete.

XI. Brief introduction and operation of remote control function

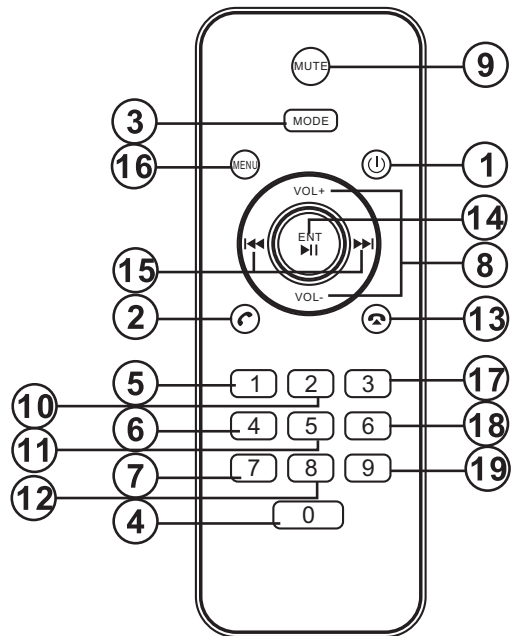

Number	ICON	Features	Features	ICON	Number
01		press into off	short press into Bluetooth or receive phone		02
03	MODE	Switch between radio, Bluetooth, music and other modes.	short press number 0 :When playing audio video,optional song,BT can dial.	0	04
05	1	short press number 1 :When playing audio video,optional song,BT can dial.Long press into AUDIO	short press number 4 :When playing audio video,optional song,BT can dial.Long press into AUDIO	4	06

Number	ICON	Features	Features	ICON	Number
07	7	short press number 4 :When playing audio video,optional song,BT can dial.	Volume adjustment	VOL +/-	08
09	MUTE	short press into play, after play, short press for Mute	short press number 2 :When playing audio video,optional song,BT can dial.	2	10
11	5	short press number 5 :When playing audio video,optional song,BT can dial.	short press number 8 :When playing audio video,optional song,BT can dial.	8	12
13		short press for hung up phone	Play/Pause		14
15		short press into last and next song selection,long press into fast forward/backward	Return main menu	MENU	16
17	3	short press number 3 :When playing audio video,optional song,BT can dial.	short press number 6 :When playing audio video,optional song,BT can dial.	6	18
19	9	short press number 9 :When playing audio video,optional song,BT can dial.			

XII. FCC statement

This equipment has been tested and found to comply with the limits for a Class B digital device, pursuant to Part 15 of the FCC Rules. These limits are designed to provide reasonable protection against harmful interference in a residential installation. This equipment generates uses and can radiate radio frequency energy and, if not installed and used in accordance with the instructions, may cause harmful interference to radio communications. However, there is no guarantee that interference will not occur in a particular installation. If this equipment does cause harmful interference to radio or television reception, which can be determined by turning the equipment off and on, the user is encouraged to try to correct the interference by one or more of the following measures:

- Reorient or relocate the receiving antenna.
- Increase the separation between the equipment and receiver.
- Connect the equipment into an outlet on a circuit different from that to which the receiver is connected.
- Consult the dealer or an experienced radio/TV technician for help.

This device complies with part 15 of the FCC Rules. Operation is subject to the following two conditions:

(1) This device may not cause harmful interference, and (2) this device must accept any interference received, including interference that may cause undesired operation.

Changes or modifications not expressly approved by the party responsible for compliance could void the user's authority to operate the equipment.

FAQ

Question1:

Is there a detailed installation and trouble shooting guide available for this car stereo?

Answer:

There is a QR code for your reference in the package. Please scan the code and watch the video. Any other questions, please feel free to contact us. We are here to help you. Thank you.

Question2:

What should I do when I encounter the problem that the firmware is required to be updated?

Answer:

You can mail us and state your problems you have encountered, and we will provide you with the corresponding updated software according to your problems.

Question3:

Why does the time and date keep resetting?

Answer:

Please check the car battery, it is usually caused by low on battery.

Question4:

What to do when the machine is not working?

Answer:

You can reset the car radio by inserting a pin into the RST hole on the exterior of the machine. If previous operation is not working, please contact our technical customer service staff to provide you with an upgraded software.

Question5:

When connecting Car play and mirror link functions, it keeps disconnecting and reconnecting.

Answer:

It is usually caused by the loose data cable. You need to use a new phone data cable. Note: the original charging cable is the best choice.

Question6:

How do I change the start-up screen's logo to my own car's logo?

Answer:

Enter the setting surface, find "LOGO" and enter the password "0000" to select different car logos.